

NEW MEXICO OIL CONSERVATION COMMISSION
Santa Fe, New Mexico

NOTICE OF INTENTION TO DRILL OR RECOMPLETE

Notice must be given to the District Office of the Oil Conservation Commission and approval obtained before drilling or recompletion begins. If changes in the proposed plan are considered advisable, a copy of this notice showing such changes will be returned to the sender. Submit this notice in QUINTuplicate. One copy will be returned following approval. See additional instructions in Rules and Regulations of the Commission.

Roswell, New Mexico

(Place)

January 10, 1958

(Date)

OIL CONSERVATION COMMISSION
SANTA FE, NEW MEXICO

Gentlemen:

You are hereby notified that it is our intention to commence the (Drilling) ~~Recompletion~~ of a well to be known as

Shell Oil Company

(Company or Operator)

Allen Estate A

(Lease)

1

H

located 1980 feet from the north line and 660 feet from the east line of Section 27, T-19-S, R-35-E, NMPM.

(GIVE LOCATION FROM SECTION LINE)

Pearl-Queen

Pool,

Lea

County

R-35-E

If State Land the Oil and Gas Lease is No.

If patented land the owner is Allen Estate

Address

We propose to drill well with drilling equipment as follows: Rotary Tools

The status of plugging bond is Blanket

Drilling Contractor Moran Drilling Company

We intend to complete this well in the Queen formation at an approximate depth of 4940 feet.

CASING PROGRAM

We propose to use the following strings of Casing and to cement them as indicated:

Size of Hole	Size of Casing	Weight per Foot	New or Second Hand	Depth	Sacks Cement
12 1/4"	9 5/8"	40#	new	300	300
7 7/8"	5 1/2"	15.5#	new	4940	800

If changes in the above plans become advisable we will notify you immediately.

ADDITIONAL INFORMATION (If recompletion give full details of proposed plan of work.)

Approved....., 19.....
Except as follows:

OIL CONSERVATION COMMISSION

By.....

Title.....

Sincerely yours,

Shell Oil Company

(Company or Operator)

By Rex C. Cabaniss Original Signed By Rex C. Cabaniss

Position District Exploitation Engineer

Send Communications regarding well to

Name Shell Oil Company

Address Box 845
Roswell, New Mexico

NEW MEXICO OIL CONSERVATION COMMISSION

Well Location and Acreage Dedication Plat

Section A.

Date January 10, 1958

Operator Shell Oil Company Lease Allen Estate A
Well No. 1 Unit Letter H Section 27 Township -19-S Range -35-E NMPM
Located 1980 Feet From north Line, 660 Feet From east Line
County Lea G. L. Elevation not available Dedicated Acreage 40 Acres
Name of Producing Formation Queen Pool Pearl Queen

1. Is the Operator the only owner* in the dedicated acreage outlined on the plat below?
Yes X No .
2. If the answer to question one is "no," have the interests of all the owners been consolidated by communitization agreement or otherwise? Yes No . If answer is "yes," Type of Consolidation
3. If the answer to question two is "no," list all the owners and their respective interests below:

Owner

Land Description

Section B

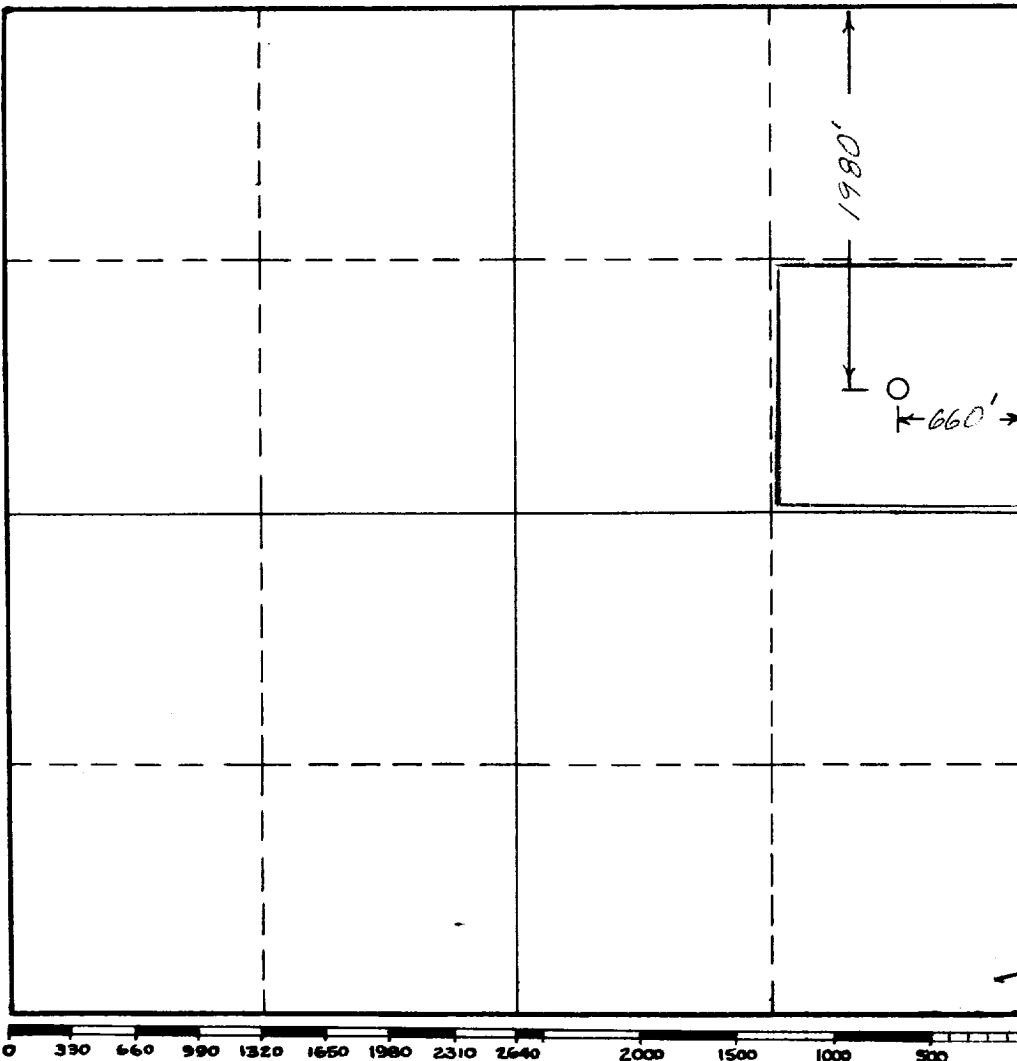

This is to certify that the information in Section A above is true and complete to the best of my knowledge and belief.

Shell Oil Company

(Operator)

Rex C. Cabaniss Original Signed By
(Representative) Rex C. Cabaniss

Box 845, Roswell, New Mexico
Address

This is to certify that the well location shown on the plat in Section B was plotted from field notes of actual surveys ~~witnessed~~ by me or under my supervision and that the same is true and correct to the best of my knowledge and belief.

Date Surveyed 1-8-58

Neal D. Shepard
Registered Professional
Engineer and/or Land Surveyor.

Certificate No. 1467

(See instructions for completing this form on the reverse side)

INSTRUCTIONS FOR COMPLETION:

1. Operator shall furnish and certify to the information called for in Section A.
2. Operator shall outline the dedicated acreage for both oil and gas wells on the plat in Section B.
3. A registered professional engineer or land surveyor registered in the State of New Mexico or approved by the Commission shall show on the plat the location of the well and certify this information in the space provided.
4. All distances shown on the plat must be from the outer boundaries of Section.
5. If additional space is needed for listing owners and their respective interests as required in question 3, Section A, please use space below

* "Owner" means the person who has the right to drill into and to produce from any pool and to appropriate the production either for himself or for himself and another. (65-3-29 (e) NMSA 1953 Comp.)