

NEW MEXICO OIL CONSERVATION COMMISSION
 Santa Fe, New Mexico
NOTICE OF INTENTION TO DRILL

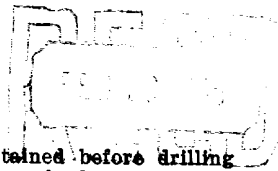

Notice must be given to the Oil Conservation Commission or its proper agent and approval obtained before drilling begins. If changes in the proposed plan are considered advisable, a copy of this notice showing such changes will be returned to the sender. Submit this notice in triplicate. One copy will be returned following approval. See additional instructions in Rules and Regulations of the Commission.

Dallas, Texas February 5, 1945
Place Date

OIL CONSERVATION COMMISSION,
 Santa Fe, New Mexico.
 Gentlemen:

You are hereby notified that it is our intention to commence the drilling of a well to be known as State "R"

Magnolia Petroleum Co. State "R" Well No. 9 in C. NW SE
Company or Operator Lease
 of Sec. 5, T. 17S, R. 36E, N. M. P.M., S.N. Lovington Field, Lee County.

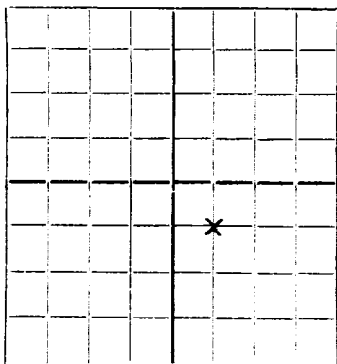

The well is 660 feet ~~600~~ (S.) of the N line and 660 feet (E.) ~~600~~ of the W line of Quarter Section

(Give location from section or other legal subdivision lines. Cross out wrong directions.)

If state land the oil and gas lease is No. D-3009, Assignment No. Original

If patented land the owner is _____

Address _____

If government land the permittee is _____

Address _____

The lessee is Magnolia Petroleum Company

Address Dallas 1, Texas

AREA 640 ACRES
 LOCATE WELL CORRECTLY

We propose to drill well with drilling equipment as follows: Rotary Tools

The status of a bond for this well in conformance with Rule 39 of the General Rules and Regulations of the Commission is as follows: Financial statement of Magnolia Petroleum Company filed with Commission and in First Judicial District of New Mexico.

We propose to use the following strings of casing and to land or cement them as indicated:

Size of Hole	Size of Casing	Weight Per Foot	New or Second Hand	Depth	Landed or Cemented	Sacks Cement
17"	13 5/8"	48#	New	330'	Cemented	200
11"	8 1/4"	28#	New	2000'	Cemented	200
7 7/8"	5 1/2"	14#	New	4680'	Cemented	200

If changes in the above plan become advisable we will notify you before cementing or landing casing. We estimate that the first productive oil or gas sand should occur at a depth of about 4700' feet.

Additional information:

FEB 15 1945

Approved _____, 19____
 except as follows:

Sincerely yours,

MAGNOLIA PETROLEUM COMPANY
Company or Operator

By K. Bullock

Position Clerk

Send communication regarding well to

Name K. Bullock

Address Box 900 - Dallas 1, Texas

OIL CONSERVATION COMMISSION,
 By W. J. Parkrough
 Title _____

Magnolia Petroleum Company

PRODUCING DEPARTMENT

Location made February 5 1945

State "R" Well No. 9

Lea District

Lease NM-614 acres 717.78 Sec. 5, T17S, R 36 E District Township

Lea County, New Mexico

Scale 1" = 500'

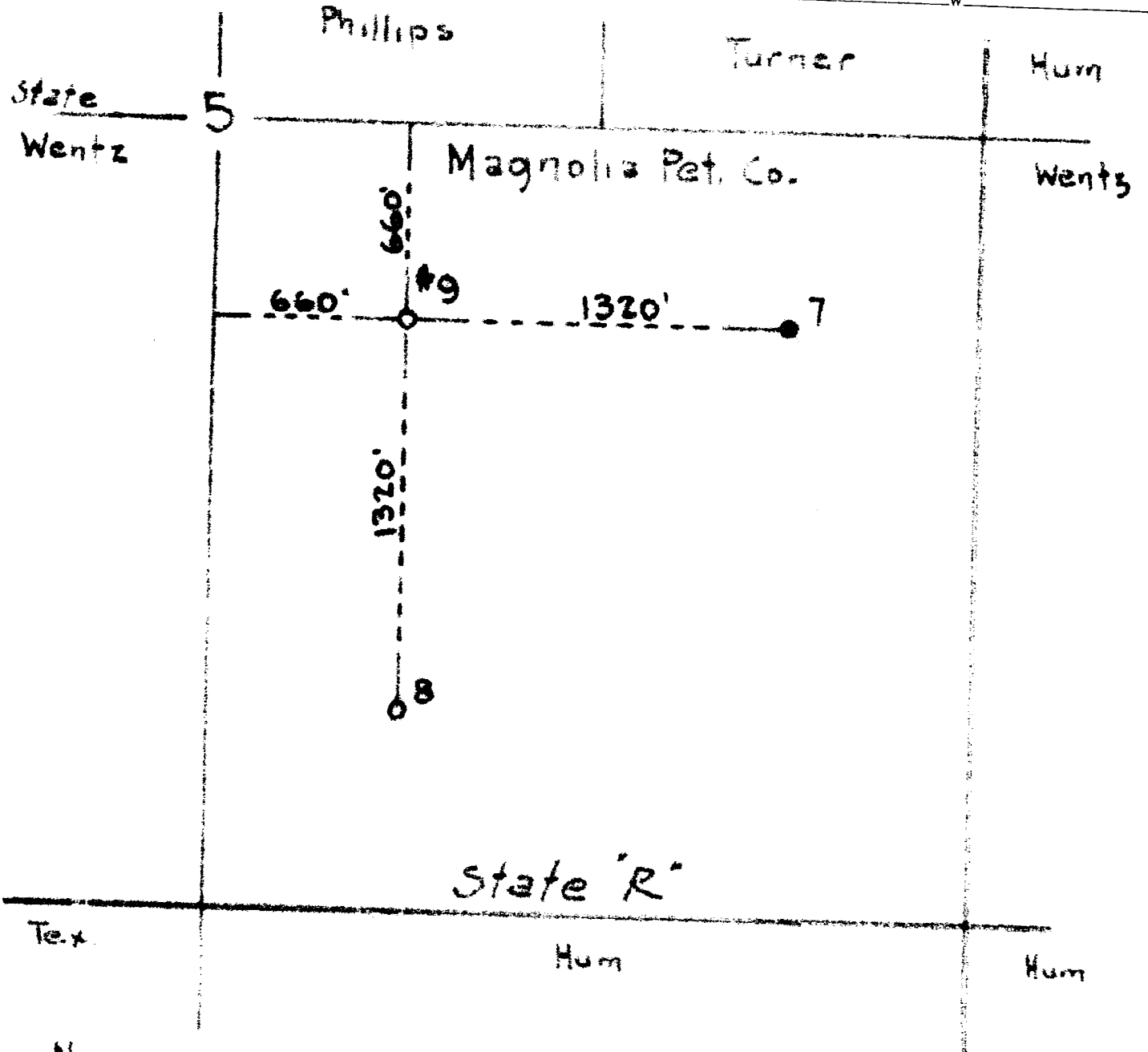

Reserve None

Special instructions

Location changed on account of

Date work is commenced _____ 194_____

Location approved by _____ Plat made by Ben C. Johnson

E. E. Taylor Supt.

Magnolia Petroleum Company
PRODUCING DEPARTMENT

Location for Well No. _____

File No. _____