

All distances must be from the outer boundaries of the Section.

Operator HAMON OPERATING COMPANY			Lease Fannye M. Holloway		Well No. 2
Unit Letter 0	Section 13	Township 17 S	Range 38 E	County Lea	
Actual Footage Location of Well: 1980 feet from the EAST line and 660 feet from the SOUTH line SEC 13					
Ground Level Elev. 3681'	Producing Formation DEVONIAN	Pool KNOWLES DEVONIAN S.	Dedicated Acreage: 80 Acres		

1. Outline the acreage dedicated to the subject well by colored pencil or hachure marks on the plat below.
2. If more than one lease is dedicated to the well, outline each and identify the ownership thereof (both as to working interest and royalty).
3. If more than one lease of different ownership is dedicated to the well, have the interests of all owners been consolidated by communitization, unitization, force-pooling, etc?

☐ Yes ☒ No If answer is "yes," type of consolidation _____

If answer is "no," list the owners and tract descriptions which have actually been consolidated. (Use reverse side of this form if necessary.) NONE

No allowable will be assigned to the well until all interests have been consolidated (by communitization, unitization, forced-pooling, or otherwise) or until a non-standard unit, eliminating such interests, has been approved by the Division.

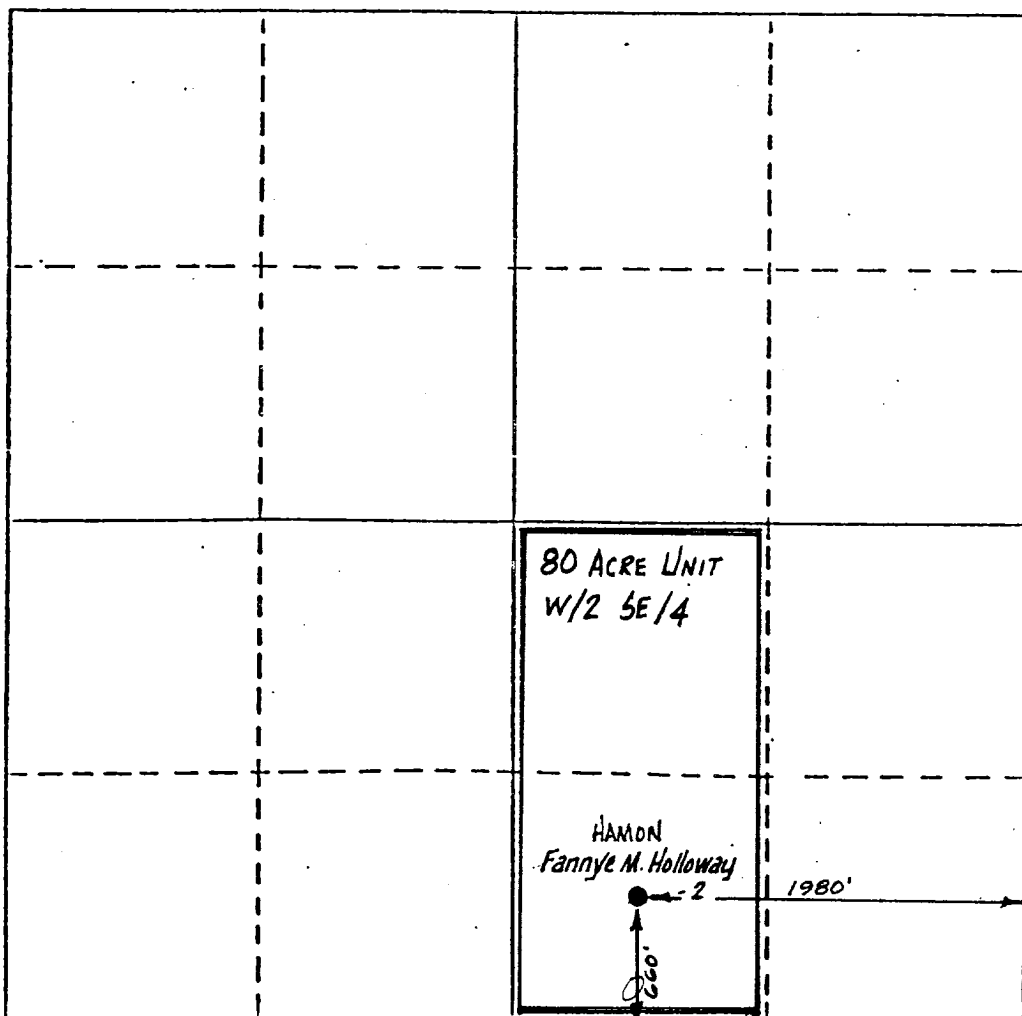

CERTIFICATION

I hereby certify that the information contained herein is true and complete to the best of my knowledge and belief.

James F. Massey
Name
James F. Massey

Position
President

Company
Hamon Operating Company

Date
March 24, 1986

I hereby certify that the well location shown on this plat was plotted from field notes of actual surveys made by me or under my supervision, and that the same is true and correct to the best of my knowledge and belief.

Date Surveyed

Registered Professional Engineer and/or Land Surveyor

Certificate No.

0 330 660 990 1320 1650 1980 2310 2640 2000 1500 1000 500 0