

(SUBMIT IN TRIPLICATE)

UNITED STATES 000  
DEPARTMENT OF THE INTERIOR  
GEOLOGICAL SURVEY  
MAY 23 1962

Land Office  
Lease No.  
Unit  
RECEIVED

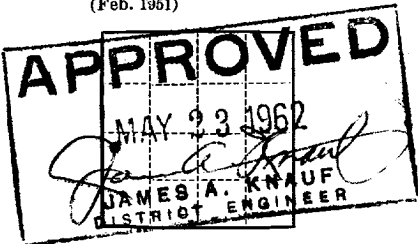

SUNDRY NOTICES AND REPORTS ON WELLS

MAY 25 1962

ARTESIA, OFFICE

NOTICE OF INTENTION TO DRILL		SUBSEQUENT REPORT OF WATER SHUT-OFF	
NOTICE OF INTENTION TO CHANGE PLANS		SUBSEQUENT REPORT OF SHOOTING OR ACIDIZING	
NOTICE OF INTENTION TO TEST WATER SHUT-OFF		SUBSEQUENT REPORT OF ALTERING CASING	
NOTICE OF INTENTION TO RE-DRILL OR REPAIR WELL		SUBSEQUENT REPORT OF RE-DRILLING OR REPAIR	
NOTICE OF INTENTION TO SHOOT OR ACIDIZE		SUBSEQUENT REPORT OF ABANDONMENT	
NOTICE OF INTENTION TO PULL OR ALTER CASING		SUPPLEMENTARY WELL HISTORY	
NOTICE OF INTENTION TO ABANDON WELL			

(INDICATE ABOVE BY CHECK MARK NATURE OF REPORT, NOTICE, OR OTHER DATA)

3-22, 1962

Well No. **1** is located **1900** ft. from **N** line and **660** ft. from **W** line of sec. **14**  
**NW SW 14** **185** **32E** **NMPN**  
(1/4 Sec. and Sec. No.) (Twp.) (Range) (Meridian)  
**S Maljamar** **Los** **New Mexico**  
(Field) (County or Subdivision) (State or Territory)

The elevation of the derrick floor above sea level is **3780** ft.

DETAILS OF WORK

(State names of and expected depths to objective sands; show sizes, weights, and lengths of proposed casings; indicate mudlogging jobs, cementing points, and all other important proposed work)

I propose to set 10-3/4" casing at 600' to 650' if needed for Cave string. Set 8-5/8" casing at top of amy. at 800' to 900' and mud came to shut off surface water. Drill 8" hole and run 3 1/2" or 4 1/2" casing for oil string to 4600' to 4700', not to exceed 5000', and cement oil string with enough cement to come to top of salt at approximately 1250', or cement with enough cement to get 600' fill up, and fill hole to top of salt with mud and spot 50 sack cement at top of salt and pull 8-5/8" casing. Will perf. oil string and complete well.

RECEIVED

MAY 23 1962

U. S. GEOLOGICAL SURVEY  
ARTESIA, NEW MEXICO

I understand that this plan of work must receive approval in writing by the Geological Survey before operations may be commenced.

Company **Tom Boyd**  
Address **510 West Texas Avenue**  
**Artesia, New Mexico**

By **Tom Boyd**  
Title **Operator**

NUMBER OF COPIES RECEIVED	
DISTRIBUTION	
SANTA FE	
FILE	
U.S.G.S.	
LAND OFFICE	
TRANSPORTER	OIL
	GAS
PRORATOR OFFICE	
OPERATOR	

NEW MEXICO OIL CONSERVATION COMMISSION  
WELL LOCATION AND ACREAGE DEDICATION PLAT  
SEE INSTRUCTIONS FOR COMPLETING THIS FORM ON THE REVERSE SIDE

FORM C-128  
Revised 5/1/57

SECTION A

Operator Tom Boyd		Lease Abel Federal		Well No. 1 00
Unit Letter H	Section 14	Township 16	Range 32	County LOS
Actual Footage Location of Well: 1980 feet from the 5 line and 600 feet from the 6 line				
Ground Level Elev. 3780	Producing Formation Guen	Pool Abel Federal	Dedicated Acreage: 40 Acres	

1. Is the Operator the only owner in the dedicated acreage outlined on the plat below? YES   A   NO       . ("Owner" means the person who has the right to drill into and to produce from any pool and to appropriate the production either for himself or for himself and another. (65-3-29 (e) NMSA 1935 Comp.)
2. If the answer to question one is "no," have the interests of all the owners been consolidated by communitization agreement or otherwise? YES        NO       . If answer is "yes," Type of Consolidation
3. If the answer to question two is "no," list all the owners and their respective interests below:

Owner	Land Description

SECTION B

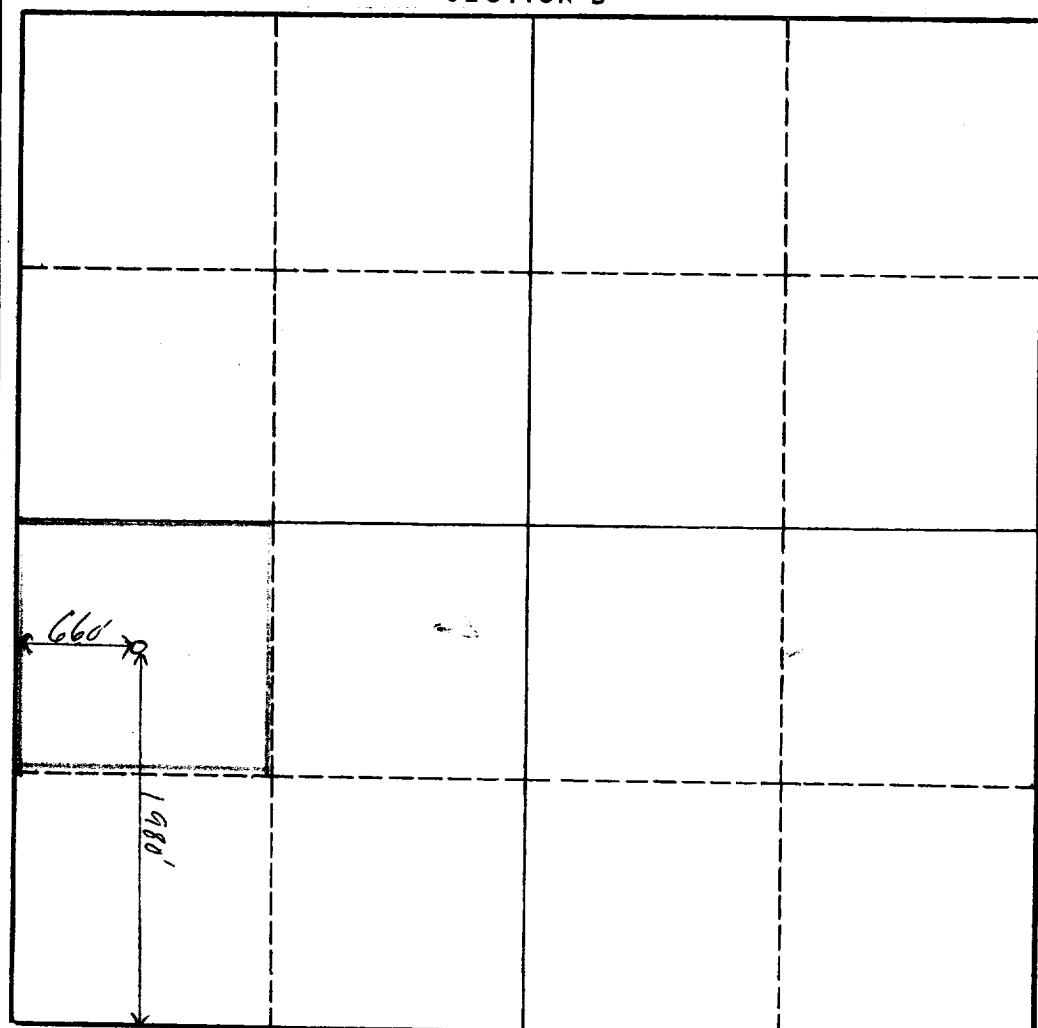

CERTIFICATION

I hereby certify that the information in SECTION A above is true and complete to the best of my knowledge and belief.

Tom Boyd  
Name

Position

Company

Date

I hereby certify that the well location shown on the plat in SECTION B was plotted from field notes of actual surveys made by me or under my supervision, and that the same is true and correct to the best of my knowledge and belief.

Date Surveyed  
5/14/52

Registered Professional Engineer  
and/or Land Surveyor

[Signature]  
Certificate No.

## INSTRUCTIONS FOR COMPLETION OF FORM C-128

1. Operator shall furnish and certify to the information called for in Section A.
2. Operator shall outline the dedicated acreage for *both* oil and gas wells on the plat in Section B.
3. A registered professional engineer or land surveyor registered in the State of New Mexico or approved by the Commission shall show on the plat the location of the well and certify this information in the space provided.
4. All distances shown on the plat must be from the outer boundaries of the Section.
5. If additional space is needed for listing owners and their respective interests as required in question 3 of Section A, please use space below.