

NEW MEXICO OIL CONSERVATION COMMISSION

Well Location and Acreage Dedication

1957 NOV 13 AM 10:47 PM 2:39
Date 10-10-57

Operator Pan American Pet. Corp. Lease State of New Mexico
Well No. 1 Well Letter L Section 16 Township 18 S Range 32 E NMEC
Elev. 2310 Feet from South Line, 330 Feet from West Line
County Lea U. S. Elevation furnish later Dedicated Acreage 40 Acres
Name of Producing Formation Queen Pool Young

1. Is the Operator the only owner* in the dedicated acreage outlined on the plat below?
Yes ☒ No ☐
2. If the answer to question one is "no," have the interests of all the owners been consolidated by communitization agreement or otherwise? Yes ☐ No ☐ If answer is "yes," Type of Consolidation _____
3. If the answer to question two is "no," list all the owners and their respective interests below:

Owner

Land Description

Section B

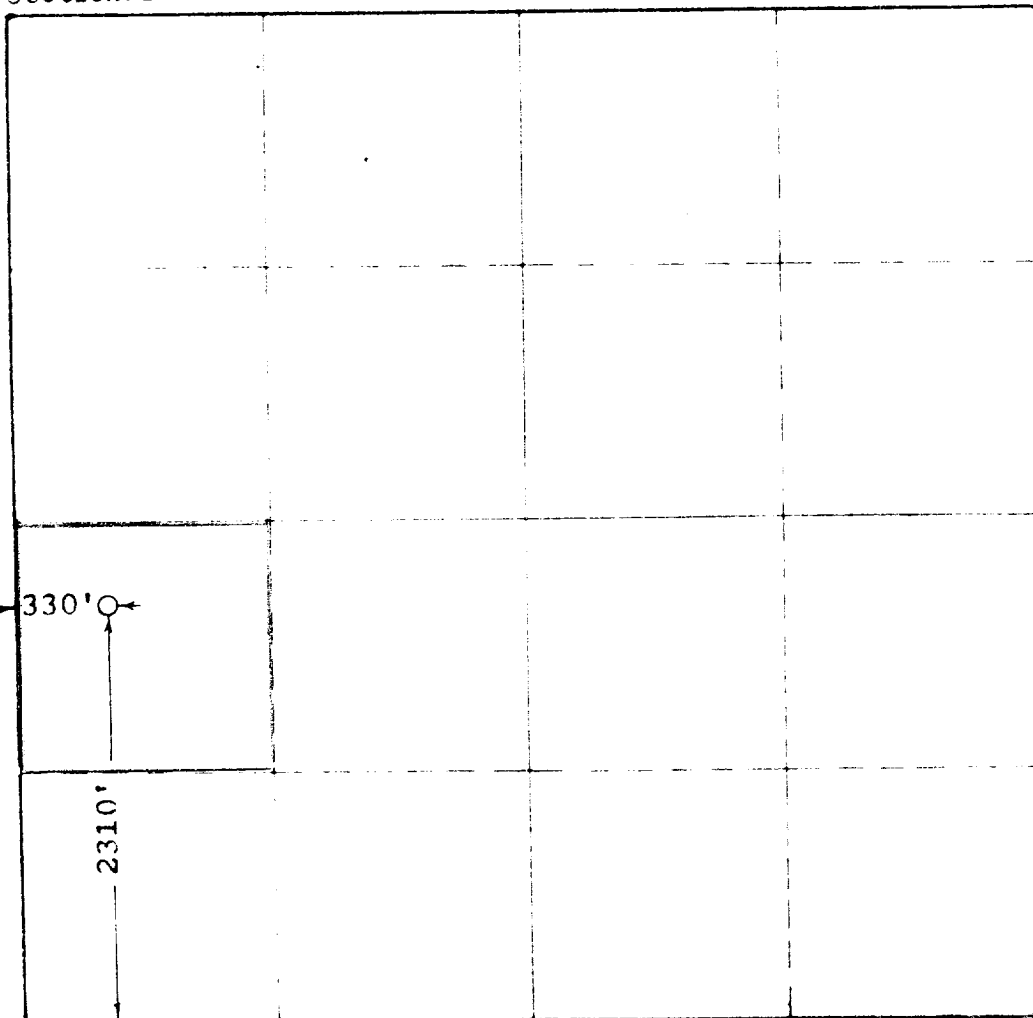

This is to certify that the information in Section A above is true and complete to the best of my knowledge and belief.

Pan American Petroleum Corporation
(Operator)

Ralph Henderson
(Representative) Field Supt.

Box 68, Hobbs, New Mexico
Address

This is to certify that the well location shown on the plat in Section B was plotted from field notes of actual surveys made by me or under my supervision and that the same is true and correct to the best of my knowledge and belief.

Date Surveyed 10-10-57

John W. West
Registered Professional
Engineer and/or Land Surveyor.

0 330 660 990 1320 1650 1980 2310 2640 2970 3300 3630 3960 4290 4620 4950 5280 5610 5940 6270 6600

JOHN W. WEST ENGINEERING COMPANY

412 NORTH DAL PASO

HOBBS, NEW MEXICO

1957 NOV 13

OCC
10:07
October 11, 1957

Pan American Pet. Corp.
Hobbs, New Mexico

Gentlemen:

On Oct. 10, 1957 a survey was made to locate your State of New Mexico AP Well No. 1 located 2310 feet from the South line and 330 feet from the West line of Sec. 16, Township 18 South, Range 32 East, N.M.P.M., Lea County, New Mexico.

The Transit was set up at the USGLO Section corner marker common to Sections 16, 17, 8 and 9 and a flag was set on the Northwest corner marker to Sec. 9, thence chaining S0°02'E 2970 feet, (at 1980 feet we found wooden stake used for staking Gulf well), thence chaining S89°46'E 330 feet to the location. As a check we retraced our survey checking in with a minimum of error.

I hereby certify that the foregoing survey was made in the field under my supervision and that the same is true and correct to the best of my knowledge and belief.

Respectfully submitted,

John W. West
John W. West