

**DUPLICATE**

NEW MEXICO OIL CONSERVATION COMMISSION  
Santa Fe, New Mexico

HOBBS OFFICE OCC  
1954 JUN 2 AM 10:03

**NOTICE OF INTENTION TO DRILL OR RECOMPLETION**

Notice must be given to the District Office of the Oil Conservation Commission and approval obtained before drilling or recompletion begins. If changes in the proposed plan are considered advisable, a copy of this notice showing the changes will be returned to the sender. Submit this notice in **QUINTUPPLICATE**. One copy will be returned following approval. See additional instructions in Rules and Regulations of the Commission.

**Hobbs, New Mexico**  
(Place)

**June 1, 1954**  
(Date)

OIL CONSERVATION COMMISSION  
SANTA FE, NEW MEXICO

Gentlemen:

You are hereby notified that it is our intention to commence the (Drilling) (~~Recompletion~~) of a well to be known as

**Shell Oil Company**  
(Company or Operator)

**G. H. Hooper**  
(Lease)

, Well No. **1**, in **G** (Unit) The well is

located **1980** feet from the **north** line and **1980** feet from the

**east** line of Section **27**, T. **19N**, R. **35E**, NMPM.

(GIVE LOCATION FROM SECTION LINE) **Wildcat** Pool, **Lee** County

**R-35-E**

D	C	B	A
E	F	G	H
L	K	J	I
M	N	O	P

**Section 27**

If State Land the Oil and Gas Lease is No. **-**

If patented land the owner is **G. H. Hooper**

Address **-**

We propose to drill well with drilling equipment as follows:

**Conventional Rotary Rig**

The status of plugging bond is **Blanket Bond**

Drilling Contractor **Guy Mabey Drig. Co.**  
**Odessa, Texas**

We intend to complete this well in the **Devonian** formation at an approximate depth of **13,100** feet.

**CASING PROGRAM**

We propose to use the following strings of Casing and to cement them as indicated:

Size of Hole	Size of Casing	Weight per Foot	New or Second Hand	Depth	Sacks Cement
<b>17"</b>	<b>13 3/8"</b>	<b>48#</b>	<b>New</b>	<b>350</b>	<b>350</b>
<b>11"</b>	<b>8 5/8"</b>	<b>32#</b>	<b>New</b>	<b>4000</b>	<b>3000</b>
<b>7 7/8"</b>	<b>5 1/2"</b>	<b>17# 15.5#</b>	<b>New</b>	<b>13,100</b>	<b>2200</b>

If changes in the above plans become advisable we will notify you immediately.

ADDITIONAL INFORMATION (If recompletion give full details of proposed plan of work.)

Approved **JUN 2 1954**, 19.....  
Except as follows:

Sincerely yours,

**Shell Oil Company**  
(Company or Operator)

By **D. Nevill**

Position **Division Exploitation Engineer**

Send Communications regarding well to

Name **Shell Oil Company**

Address **Box 1957**

**Hobbs, New Mexico**

OIL CONSERVATION COMMISSION

By **S. G. Stanley**

Title **Assistant District Engineer**

# Shell G. H. Hooper 1

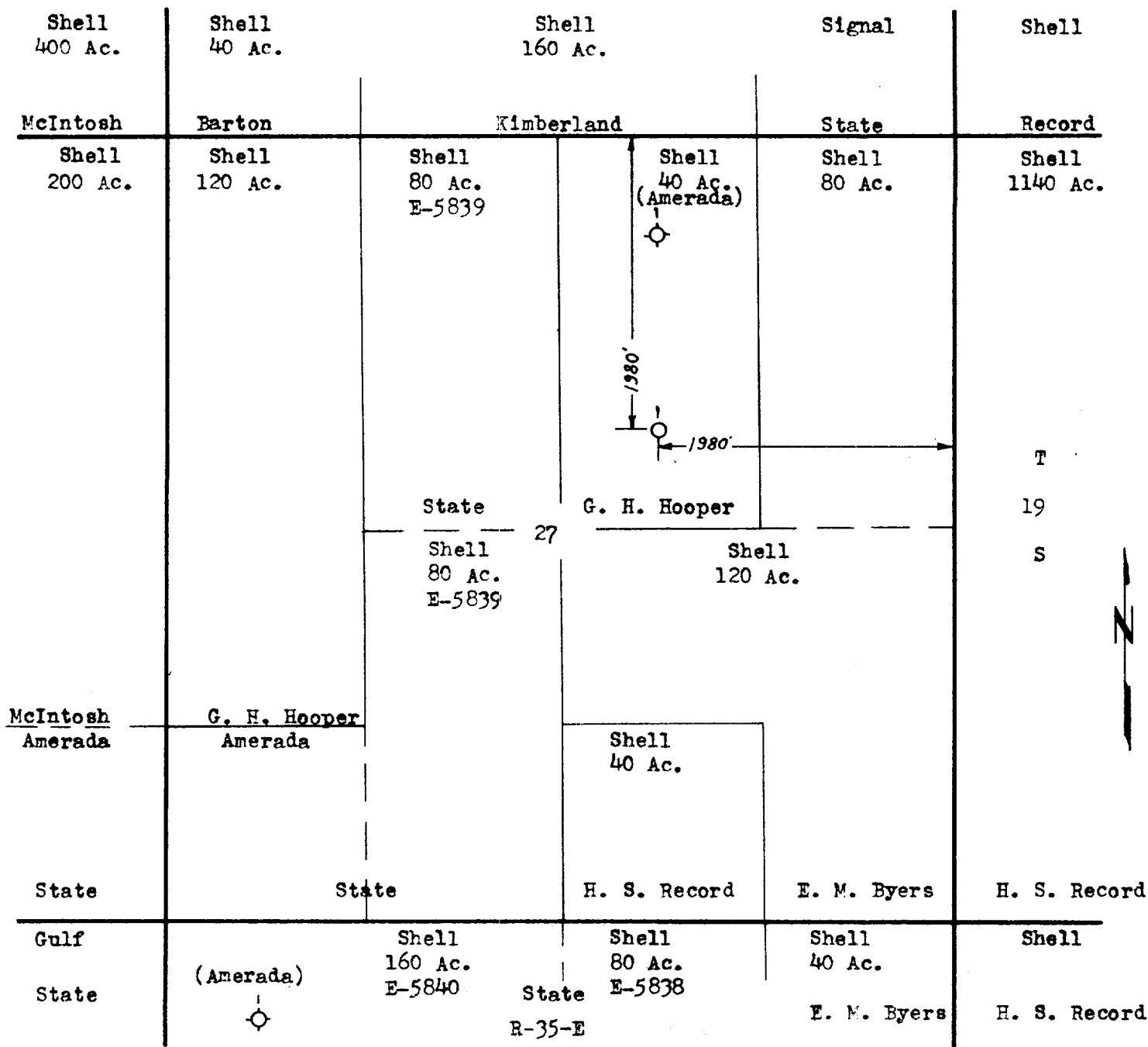

I, B. Nevill, do hereby certify that the foregoing plat is true and correct.

*B. Nevill*  
 B. Nevill  
 Division Exploitation Engineer  
 Shell Oil Company  
 Hobbs, New Mexico

Subscribed and sworn to before me this 1st day of June 1954.

*James E. Davis*

Notary Public  
 Lea County, New Mexico

OPERATOR: Shell Oil Company  
 FIELD: Pearl Area (Undesignated)  
 LOCATION: SW/4 NE/4 of Section 27-19S-35E  
 NMPM Survey, Lea County, New Mexico  
 SCALE: 1" = 1000'