

NEW MEXICO OIL CONSERVATION COMMISSION  
WELL LOCATION AND ACREAGE DEDICATION PLAT

FORM C-128  
Revised 5/1/57

SEE INSTRUCTIONS FOR COMPLETING THIS FORM ON THE REVERSE SIDE

SECTION A

Operator <b>MARATHON OIL CO.</b>		Lease <b>STATE MCCALLISTER</b>		Well No. <b>7</b>
Unit Letter <b>N</b>	Section <b>25</b>	Township <b>17 SOUTH</b>	Range <b>34 EAST</b>	County <b>LEA</b>
Actual Footage Location of Well: <b>660</b> feet from the <b>SOUTH</b> line and <b>1780</b> feet from the <b>WEST</b> line				
Ground Level Elev.	Producing Formation <b>Devonian</b>		Pool <b>Vacuum-Devonian</b>	Dedicated Acreage: <b>80</b> Acres

1. Is the Operator the only owner in the dedicated acreage outlined on the plat below? YES ☒ NO \_\_\_\_ ("Owner" means the person who has the right to drill into and to produce from any pool and to appropriate the production either for himself or for himself and another. (65-3-29 (e) NMSA 1935 Comp.)
2. If the answer to question one is "no," have the interests of all the owners been consolidated by communitization agreement or otherwise? YES \_\_\_\_ NO \_\_\_\_ . If answer is "yes," Type of Consolidation \_\_\_\_
3. If the answer to question two is "no," list all the owners and their respective interests below:

Owner	Land Description

SECTION B

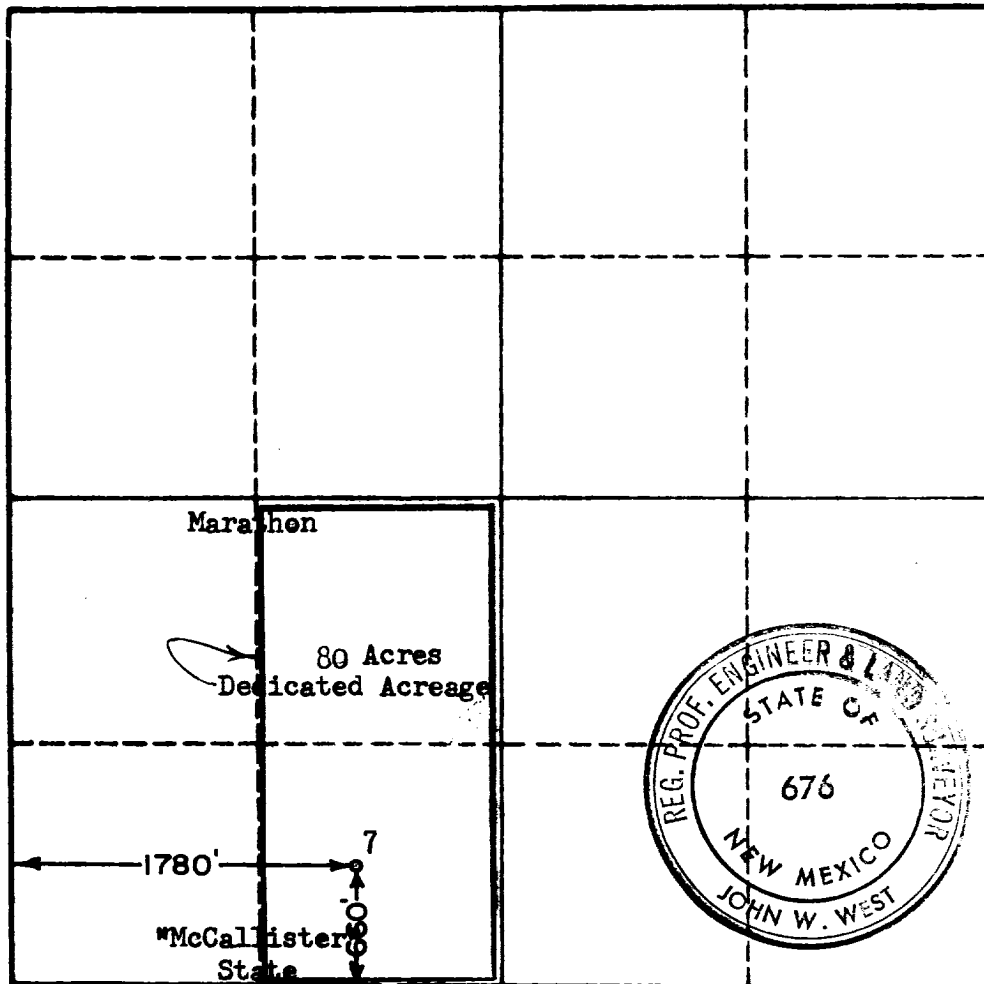

CERTIFICATION

I hereby certify that the information in SECTION A above is true and complete to the best of my knowledge and belief.

*John R. Barber*  
Name  
J. R. Barber  
Position  
Area Petroleum Engineer  
Company  
Marathon Oil Company  
Date  
3-29-63

I hereby certify that the well location shown on the plat in SECTION B was plotted from field notes of actual surveys made by me or under my supervision, and that the same is true and correct to the best of my knowledge and belief.

Date Surveyed  
3-28-63  
Registered Professional Engineer and/or Land Surveyor, JOHN W. WEST  
*John W. West*  
Certificate No.  
N. M. - P. E. & L. S. NO. 676

0 330 660 990 1320 1650 1980 2310 2640 2000 1500 1000 500 0