

NEW MEXICO OIL CONSERVATION COMMISSION

WELL LOCATION AND ACREAGE DEDICATION PLAT

FORM C-128
Revised 5/1/57

SEE INSTRUCTIONS FOR COMPLETING THIS FORM ON THE REVERSE SIDE

SECTION A

Operator Marathon Oil Company			Lease State McCallister		Well No. 50 00
Unit Letter M	Section 25	Township 17 S	Range 34 E	County Lea	
Actual Footage Location of Well: 660 feet from the South line and 560 feet from the West line					
Ground Level Elev. 4007	Producing Formation Wolfcamp		Pool Vacuum Wolfcamp		Dedicated Acreage: 80 Acres

1. Is the Operator the only owner in the dedicated acreage outlined on the plat below? YES X NO ____ . ("Owner" means the person who has the right to drill into and to produce from any pool and to appropriate the production either for himself or for himself and another. (65-3-29 (e) NMSA 1935 Comp.)
2. If the answer to question one is "no," have the interests of all the owners been consolidated by communitization agreement or otherwise? YES ____ NO ____ . If answer is "yes," Type of Consolidation _____
3. If the answer to question two is "no," list all the owners and their respective interests below:

Owner	Land Description

SECTION B

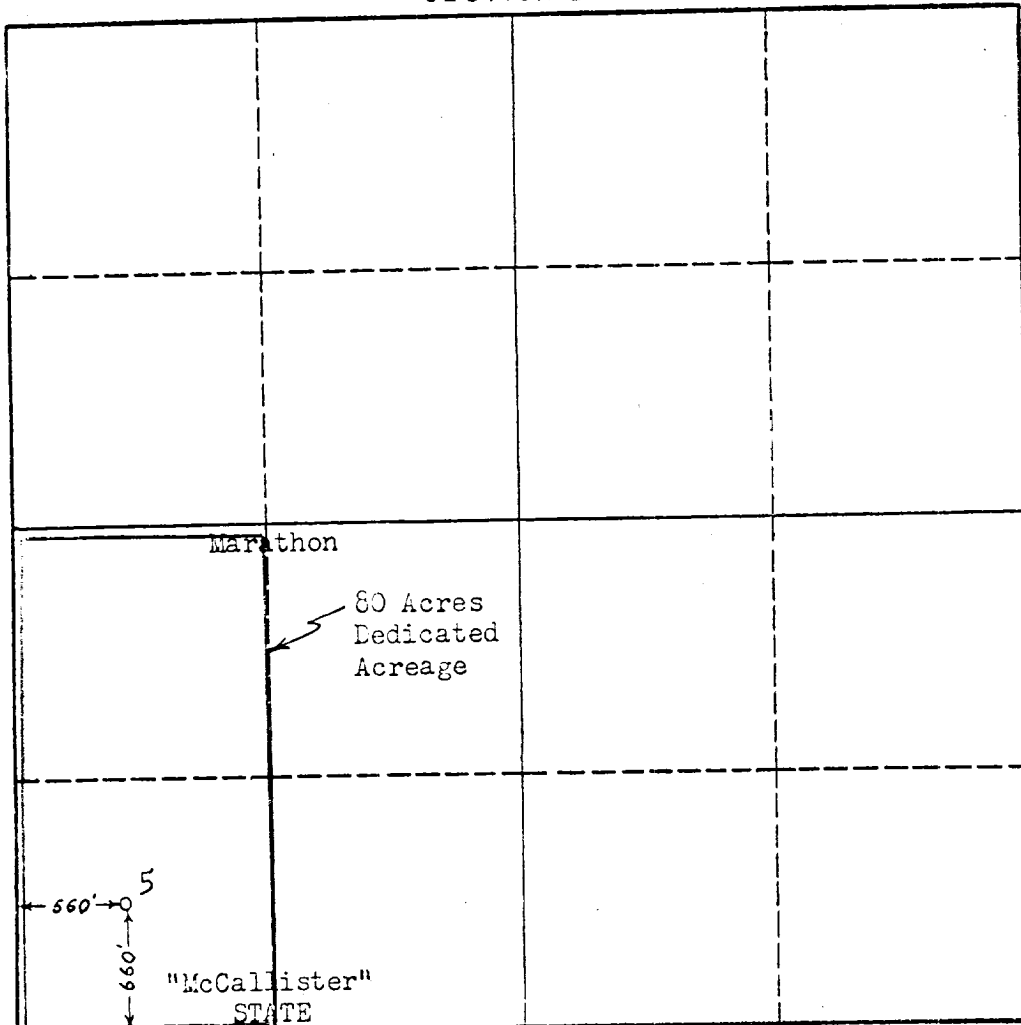

CERTIFICATION

I hereby certify that the information in SECTION A above is true and complete to the best of my knowledge and belief.

Name
John R. Barber

Position
Area Petroleum Engineer

Company
Marathon Oil Company

Date
April 2, 1963

I hereby certify that the well location shown on the plat in SECTION B was plotted from field notes of actual surveys made by me or under my supervision, and that the same is true and correct to the best of my knowledge and belief.

Date Surveyed
12-7-62

Registered Professional Engineer and/or Land Surveyor

/s/ **John W. West**

Certificate No.

0 330 660 990 1320 1650 1980 2310 2640 2000 1500 1000 500 0