

Submit to Appropriate
District Office
State Lease - 6 copies
Fee Lease - 5 copies

State of New Mexico
Energy, Minerals and Natural Resources Department

Form C-101
Revised 1-1-89

DISTRICT I
P.O. Box 1980, Hobbs, NM 88240

DISTRICT II
P.O. Drawer DD, Artesia, NM 88210

DISTRICT III
1000 Rio Brazos Rd., Aztec, NM 87410

OIL CONSERVATION DIVISION
P.O. Box 2088
Santa Fe, New Mexico 87504-2088

API NO. (assigned by OCD on New Wells) 30-025-20201
5. Indicate Type of Lease STATE <input checked="" type="checkbox"/> FEE <input type="checkbox"/>
6. State Oil & Gas Lease No. B1482

APPLICATION FOR PERMIT TO DRILL, DEEPEN, OR PLUG BACK

1a. Type of Work: DRILL <input type="checkbox"/> RE-ENTER <input checked="" type="checkbox"/> DEEPEN <input type="checkbox"/> PLUG BACK <input type="checkbox"/>		7. Lease Name or Unit Agreement Name State K			
b. Type of Well: OIL WELL <input checked="" type="checkbox"/> GAS WELL <input type="checkbox"/> OTHER <input type="checkbox"/> SINGLE ZONE <input checked="" type="checkbox"/> MULTIPLE ZONE <input type="checkbox"/>		8. Well No. 5			
2. Name of Operator OXY USA Inc.		9. Pool name or Wildcat Vacuum Yates			
3. Address of Operator P.O. Box 50250 Midland, TX. 79710					
4. Well Location Unit Letter <u>H</u> : <u>2310</u> Feet From The <u>North</u> Line and <u>330</u> Feet From The <u>East</u> Line Section <u>27</u> Township <u>17S</u> Range <u>35E</u> NMPM Lea County					
10. Proposed Depth 3150'		11. Formation Yates			
12. Rotary or C.T. Compl Ut.					
13. Elevations (Show whether DF, RT, GR, etc.) 3922'		14. Kind & Status Plug. Bond Required/Approved			
15. Drilling Contractor Unknown		16. Approx. Date Work will start ASAP			
17. PROPOSED CASING AND CEMENT PROGRAM					
SIZE OF HOLE	SIZE OF CASING	WEIGHT PER FOOT	SETTING DEPTH	SACKS OF CEMENT	EST. TOP
17 1/2"	13 3/8"	48#	351'	360	Circulated
12 1/4"	8 5/8"	24-32#	3200'	1800	Circulated
7 7/8"	5 1/2"	15.5-17#	T-3485'B-8954'	926	TS-3675'

OTD-9000' It is proposed to Re-enter and test the Yates Formation as follows:

See other side

IN ABOVE SPACE DESCRIBE PROPOSED PROGRAM: IF PROPOSAL IS TO DEEPEN OR PLUG BACK, GIVE DATA ON PRESENT PRODUCTIVE ZONE AND PROPOSED NEW PRODUCTIVE ZONE. GIVE BLOWOUT PREVENTER PROGRAM, IF ANY.

I hereby certify that the information above is true and complete to the best of my knowledge and belief.

SIGNATURE David Stewart TITLE Production Accountant DATE 10/22/91

TYPE OR PRINT NAME David Stewart TELEPHONE NO. 156855717

(This space for State Use)

ORIGINAL SIGNED BY JERRY SEXTON

APPROVED BY DISTRICT I SUPERVISOR TITLE DATE

CONDITIONS OF APPROVAL, IF ANY:

Permit Expires 6 Months From Approval
Date Unless Drilling Underway.
Re-entry

OCT 24 1991

1. Locate well and prepare for reentry. MIRU PU. Install BOP. RIH w/ 7-7/8" RB and 3 DCs on 2-7/8" workstring. Drill out cmt plugs at 0-100' and 1200-1300'. Tag top of cmt plug reported at 3150'. Dress off plug to 3150' if necessary. If the btm of the plug is above 3150', spot a new 30 sx cmt plug w/ the top @ 3150'. CHC & POOH. RIH w/ RTTS on 2-7/8" tbg to 3020' and set. Test csg to 1000#. POOH.
2. Contact Dave Fowler at 685-5726 to select perfs. RU wireline. Run GR-DSN from 3150-2600' and GR-CCL-CBL from csg shoe (3107' ?) to 2600'. Correlate to Lane Wells Acoustilog dated 8-22-63. Install lubricator. Using a 4" csg gun loaded 2 SPF w/ premium charges, perf Yates.
3. RIH w/ RTTS on 2-7/8" tbg to 3000' & set. Swab test Yates. Rel RTTS & dump sand to 3100'. Check top of sand.
4. RU stimulation co. Spot 380 gal 7-1/2% NEFe HCl 3100-2950'. POOH to 2950' & set RTTS. Pres csg to 1000#. Az Yates w/ 2020 gal 7-1/2% NEFe HCl, dropping 1 ball sealer per hole throughout the treatment. Flush to perfs w/ 2% KCl wtr. Swab back load & test.
5. RU stimulation co. Pres csg to 1000#. Frac the Yates @ 22 BPM w/ 21000 gal 30# gel + 49000# 12/20 sand as follows:
 - a. 10000 gal pad
 - b. 1000 gal + 1 ppg sand
 - c. 1000 gal + 2 ppg sand
 - d. 1000 gal + 3 ppg sand
 - e. 1000 gal + 4 ppg sand
 - f. 3000 gal + 5 ppg sand
 - g. 4000 gal + 6 ppg sand
 - h. Flush tbg w/ slick 2% KCl wtr.SI 8 hrs. Circ out sand to top of cmt plug. Swab back load & test.
6. Rel RTTS & POOH. RIH w/ BHA on 2-3/8" tbg to 3125'. ND BOP. NU WH. RIH w/ pump & rods, after checking with Rebecca for design. Monitor production rate and fluid level.

RECEIVED

OCT 23 1991

MOBBS OFFICE

Submit to Appropriate
District Office
State Lease - 4 copies
Fee Lease - 3 copies

State of New Mexico
Energy, Minerals and Natural Resources Department

Form C-102
Revised 1-1-89

OIL CONSERVATION DIVISION

P.O. Box 2088
Santa Fe, New Mexico 87504-2088

DISTRICT I
P.O. Box 1980, Hobbs, NM 88240

DISTRICT II
P.O. Drawer DD, Artesia, NM 88210

DISTRICT III
1000 Rio Brazos Rd., Aztec, NM 87410

WELL LOCATION AND ACREAGE DEDICATION PLAT

All Distances must be from the outer boundaries of the section

Operator OXY USA Inc.			Lease State K		Well No. 5
Unit Letter H	Section 27	Township 17S	Range 35E	County NMPM	Lea
Actual Footage Location of Well: 2310 feet from the North line and 330 feet from the East line					
Ground level Elev. 3922'	Producing Formation Yates		Pool Vacuum Yates	Dedicated Acreage: 40 Acres	

1. Outline the acreage dedicated to the subject well by colored pencil or hatchure marks on the plat below.
2. If more than one lease is dedicated to the well, outline each and identify the ownership thereof (both as to working interest and royalty).
3. If more than one lease of different ownership is dedicated to the well, have the interest of all owners been consolidated by communitization, unitization, force-pooling, etc?
☐ Yes ☐ No If answer is "yes" type of consolidation _____
If answer is "no" list the owners and tract descriptions which have actually been consolidated. (Use reverse side of this form if necessary). _____
No allowable will be assigned to the well until all interests have been consolidated (by communitization, unitization, forced-pooling, or otherwise) or until a non-standard unit, eliminating such interest, has been approved by the Division.

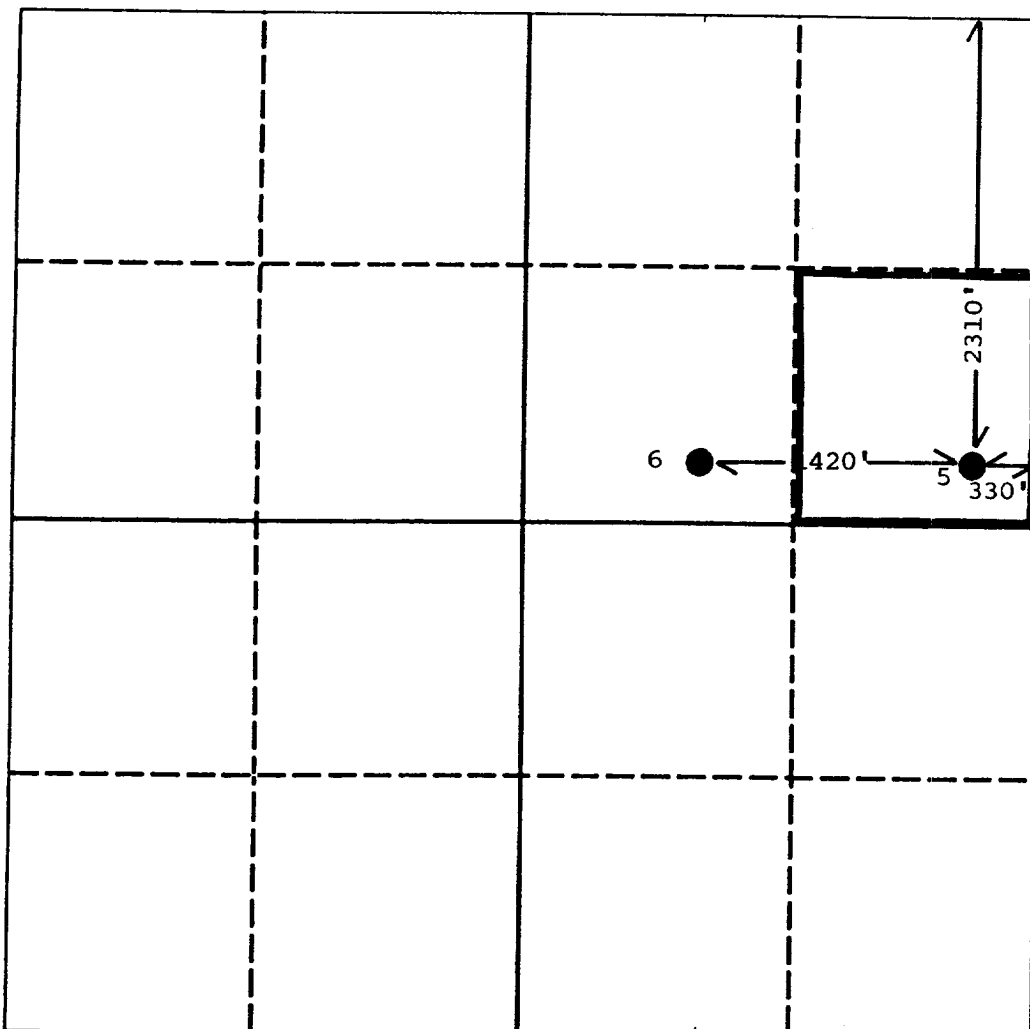

OPERATOR CERTIFICATION

I hereby certify that the information contained herein is true and complete to the best of my knowledge and belief.

Signature

Printed Name

David Stewart

Position

Production Accountant

Company

OXY USA Inc.

Date

10/22/91

SURVEYOR CERTIFICATION

I hereby certify that the well location shown on this plat was plotted from field notes of actual surveys made by me or under my supervision, and that the same is true and correct to the best of my knowledge and belief.

Date Surveyed

Signature & Seal of
Professional Surveyor

Certificate No.

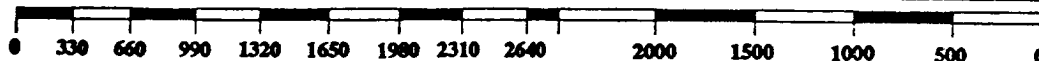

RECEIVED

OCT 23 1991

663

HOBBS OFFICE