

# NOTICE OF INTENTION TO DRILL

Notice must be given to the District Office of the Oil Conservation Commission and approval obtained before drilling or recompletion begins. If changes in the proposed plan are considered advisable, a copy of this notice showing such changes will be returned to the sender. Submit this notice in QUINTUPPLICATE. One copy will be returned following approval. See additional instructions in Rules and Regulations of the Commission. If State Land submit 6 Copies Attach Form C- 128 in triplicate to first 3 copies of form C-101

Hobbs, New Mexico

(Place)

July 12, 1963

(Date)

OIL CONSERVATION COMMISSION  
SANTA FE, NEW MEXICO

Gentlemen:

You are hereby notified that it is our intention to commence the Drilling of a well to be known as

**Cities Service Oil Company**

(Company or Operator)

State K

(Lease)

Well No. 5

H

(Unit)

located 2310 feet from the North line and 330 feet from the East

East

Line of Section 27, T. 17S, R. 35E, NMPM.

(GIVE LOCATION FROM SECTION LINE) **Vacuum-Abe Reef** Pool, Lea County

If State Land the Oil and Gas Lease is No. B-1482

If patented land the owner is -

Address -

We propose to drill well with drilling equipment as follows: Rotary

The status of plugging bond is Approved

Drilling Contractor Unknown at present time.

We intend to complete this well in the Abe Reef formation at an approximate depth of 9000 feet.

## CASING PROGRAM

We propose to use the following strings of Casing and to cement them as indicated:

Size of Hole	Size of Casing	Weight per Foot	New or Second Hand	Depth	Sacks Cement
17 1/2"	13 3/8"	48#	New	330'	circulate
11 1/2"	8 5/8"	24 & 32#	New	3500'	circulate
7 7/8"	5 1/2"	15.5 & 17#	New	9000'	*

If changes in the above plans become advisable we will notify you immediately.

ADDITIONAL INFORMATION (If recompletion give full details of proposed plan of work.)

\* Cement will be returned to a point which will cover San Andres Porosity zone.

Approved....., 19.....  
Except as follows:

OIL CONSERVATION COMMISSION

Sincerely yours,

**Cities Service Oil Company**

(Company or Operator)

By

Position **District Superintendent**

Send Communications regarding well to

Name **George M. Geyer**

Address **Box 69 - Hobbs, New Mexico**

**NEW MEXICO OIL CONSERVATION COMMISSION**  
**WELL LOCATION AND ACREAGE DEDICATION PLAT**

OFFICE OCC FORM C-128  
 Revised 5/1/57

SEE INSTRUCTIONS FOR COMPLETING THIS FORM ON THE REVERSE SIDE

**SECTION A**

Operator <b>CITY SERVICE OIL COMPANY</b>			Lease <b>STATE K</b>			Well No. <b>5</b>
Unit Letter <b>H</b>	Section <b>27</b>	Township <b>17 SOUTH</b>	Range <b>35 EAST</b>	County <b>LEA</b>		

Actual Footage Location of Well:  
**2310** feet from the **NORTH** line and **330** feet from the **EAST** line

Ground Level Elev. <b>3936' Elev.</b>	Producing Formation <b>Alto Res.</b>	Pool <b>Vanner-Alto Res.</b>	Dedicated Acreage: <b>10</b> Acres
--	---	---------------------------------	---------------------------------------

1. Is the Operator the only owner in the dedicated acreage outlined on the plat below? YES ☒ NO ☐ ("Owner" means the person who has the right to drill into and to produce from any pool and to appropriate the production either for himself or for himself and another. (65-3-29 (e) NMSA 1955 Comp.)
2. If the answer to question one is "no," have the interests of all the owners been consolidated by communitization agreement or otherwise? YES ☐ NO ☐ . If answer is "yes," Type of Consolidation \_\_\_\_\_
3. If the answer to question two is "no," list all the owners and their respective interests below:

Owner	Land Description

**SECTION B**

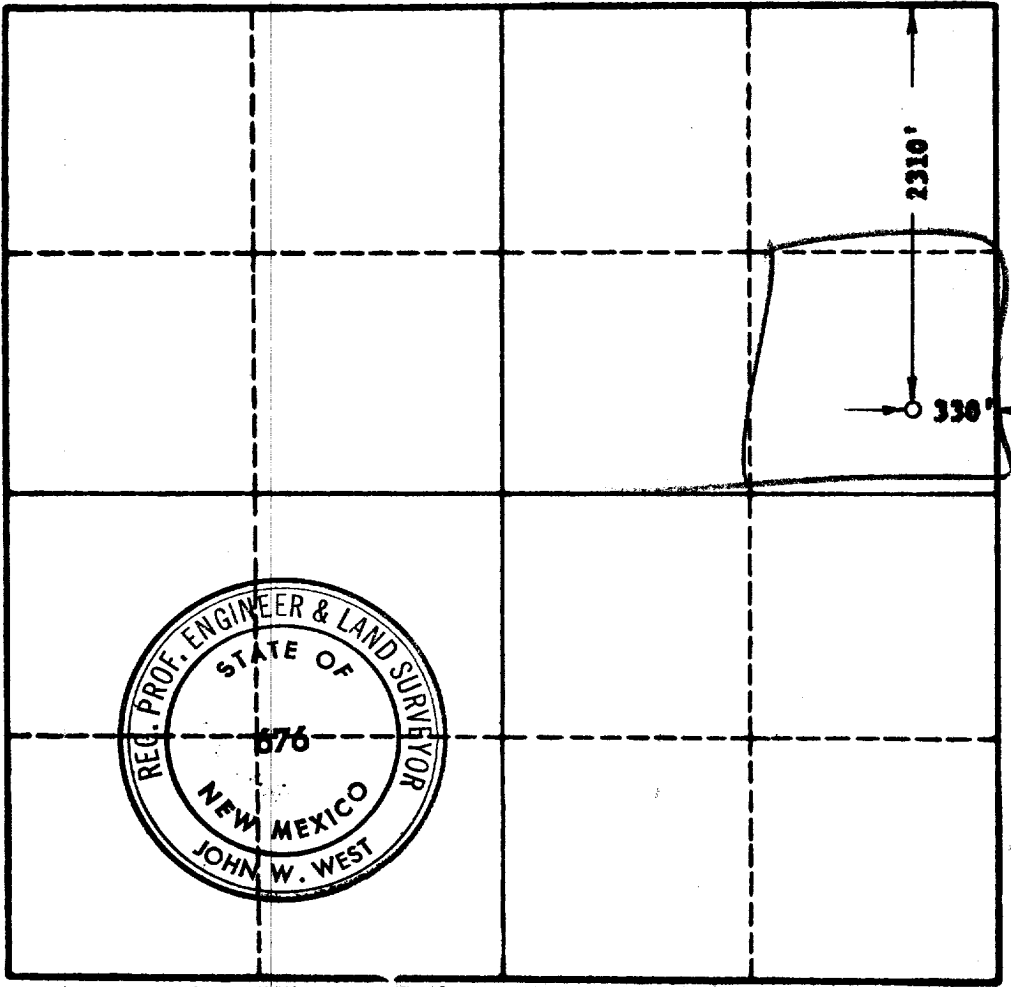

**CERTIFICATION**

I hereby certify that the information in SECTION A above is true and complete to the best of my knowledge and belief.

Name	<i>John W. West</i>
Position	<b>Asst. Supt.</b>
Company	<b>CITY SERVICE OIL Co.</b>
Date	<b>7-12-63</b>

I hereby certify that the well location shown on the plat in SECTION B was plotted from field notes of actual surveys made by me or under my supervision, and that the same is true and correct to the best of my knowledge and belief.

Date Surveyed	<b>JULY 11, 1963</b>
Registered Professional Engineer and/or Land Surveyor,	<b>JOHN W. WEST</b>
Certificate No.	<i>John W. West</i>
N.M. - P.E. & L.S. NO. 676	

