



IN REPLY REFER TO:

UNITED STATES
DEPARTMENT OF THE INTERIOR

GEOLOGICAL SURVEY

P. O. Drawer U
Artesia, New Mexico

RECEIVED

DEC 21 1962

December 20, 1962
OFFICE

E. J. McGurdy, Jr., Etal
1813 Clayton
Artesia, New Mexico

Re: New Mexico 04371-B

Gentlemen:

Your Notice of Intention to Drill well No. 1 Edwards (copy attached) in the NE 1/4, sec. 21, T. 18 S., R. 32 E., N.P.M., Lea County, New Mexico to a depth of 4,000 feet to test the Queen formation is hereby approved subject to compliance with the provisions of the Oil and Gas Operating Regulations and subject to the following conditions:

1. Drilling operations so authorized are subject to the attached sheet for general conditions of approval.
2. A daily progress report is to be furnished in duplicate from spud date until completion of the well.
3. Drilling rig must not be moved from well without prior approval from the Survey (30 CFR 221.35c).

Very truly yours,

(Orig. Sgd.) ARTHUR R. BROWN
Arthur R. Brown
Acting District Engineer

P.S. You are reminded that the right to continue operations under oil and gas lease New Mexico 04371-B after December 31, 1962, is contingent upon one of the following conditions:

1. Completion of a well prior to such date capable of producing in paying quantities.
2. Drilling operations being conducted on said date provided that the lease rental has been timely paid.



UNITED STATES
DEPARTMENT OF THE INTERIOR
GEOLOGICAL SURVEY

WATER RESOURCES DIVISION
WASHINGTON, D. C.

June 10, 1917

Mr. J. H. ...
Washington, D. C.

Dear Sir:

I have the honor to acknowledge the receipt of your letter of June 8, 1917, in relation to the matter of the ...

Very respectfully,
J. H. ...

Very truly yours,
J. H. ...

Very truly yours,
J. H. ...

Very truly yours,
J. H. ...

Very truly yours,
J. H. ...

Very truly yours,
J. H. ...

Very truly yours,
J. H. ...

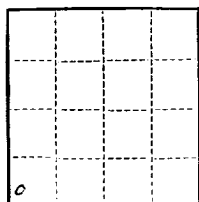

(SUBMIT IN TRIPLICATE)

UNITED STATES
DEPARTMENT OF THE INTERIOR
GEOLOGICAL SURVEY

Land Office New Mexico

Lease No. 0-371-B

Unit _____

SUNDRY NOTICES AND REPORTS ON WELLS

| | | | |
|-----------------------------------------------------|-------------------------------------|-------------------------------------------------|--|
| NOTICE OF INTENTION TO DRILL..... | <input checked="" type="checkbox"/> | SUBSEQUENT REPORT OF WATER SHUT-OFF..... | |
| NOTICE OF INTENTION TO CHANGE PLANS..... | | SUBSEQUENT REPORT OF SHOOTING OR ACIDIZING..... | |
| NOTICE OF INTENTION TO TEST WATER SHUT-OFF..... | | SUBSEQUENT REPORT OF ALTERING CASING..... | |
| NOTICE OF INTENTION TO RE-DRILL OR REPAIR WELL..... | | SUBSEQUENT REPORT OF RE-DRILLING OR REPAIR..... | |
| NOTICE OF INTENTION TO SHOOT OR ACIDIZE..... | | SUBSEQUENT REPORT OF ABANDONMENT..... | |
| NOTICE OF INTENTION TO PULL OR ALTER CASING..... | | SUPPLEMENTARY WELL HISTORY..... | |
| NOTICE OF INTENTION TO ABANDON WELL..... | | | |

(INDICATE ABOVE BY CHECK MARK NATURE OF REPORT, NOTICE, OR OTHER DATA)

Edwards Dec, 19 62
Well No. 1 is located 330 ft. from N line and 330 ft. from W line of sec. 21
S W 1/4 S W 1/4 Sec 21-T15 R-32E N.M.P.
(1/4 Sec. and Sec. No.) (Twp.) (Range) (Meridian)
Young Lee New Mexico
(Field) (County or Subdivision) (State or Territory)

The elevation of the derrick floor above sea level is 2741 ft.

DETAILS OF WORK

(State names of and expected depths to objective sands; show sizes, weights, and lengths of proposed casings; indicate mudding jobs, cementing points, and all other important proposed work)

Intend to drill to approx 4000' to test the Quaterns.
Propose to set approx 1100' 3-5/8" surface casing and cement with 50 sz.
Propose to set approx. 4000' 3-1/2" casing and cement with approx 300 sz.
If production is indicated will frack.

RECEIVED
DEC 19 1962
U.S. GEOLOGICAL SURVEY
ARTESIA, NEW MEXICO

I understand that this plan of work must receive approval in writing by the Geological Survey before operations may be commenced.

Company W. J. Mc Garry Jr. Inc.
Address 1015 Clayton
Artesia New Mexico
By Floyd D. Turner
Title Prod. Supt.

NEW MEXICO OIL CONSERVATION COMMISSION
WELL LOCATION AND ACREAGE DEDICATION PLAT

FORM C-128
Revised 5/1/57

SEE INSTRUCTIONS FOR COMPLETING THIS FORM ON THE REVERSE SIDE

SECTION A

| | | | | | |
|------------------------------------------------------------------------------------------------------------------------------|-------------------------------------|-----------------------------|-------------------------|----------------------|---------------------------------------------------------------------------------------------|
| Operator MCCURDY-TRAMMELL-JOINT ACCOUNT | | | Lease EDWARDS | | Well No. 1 |
| Unit Letter M | Section 21 | Township 18 SOUTH | Range 32 EAST | County LEA | |
| Actual Footage Location of Well: 330 feet from the SOUTH line and 330 feet from the WEST line | | | | | |
| Ground Level Elev. 3741 | Producing Formation QUEEN | | Pool YOUNG | | Dedicated Acreage: 40 (SW$\frac{1}{4}$SW$\frac{1}{4}$ Acres |

1. Is the Operator the only owner in the dedicated acreage outlined on the plat below? YES ☒ NO ☐ ("Owner" means the person who has the right to drill into and to produce from any pool and to appropriate the production either for himself or for himself and another. (65-3-29 (e) NMSA 1935 Comp.)
2. If the answer to question one is "no," have the interests of all the owners been consolidated by communitization agreement or otherwise? YES ☐ NO ☐ If answer is "yes," Type of Consolidation _____
3. If the answer to question two is "no," list all the owners and their respective interests below:

| Owner | Land Description |
|-------|------------------|
| | |
| | |

SECTION B

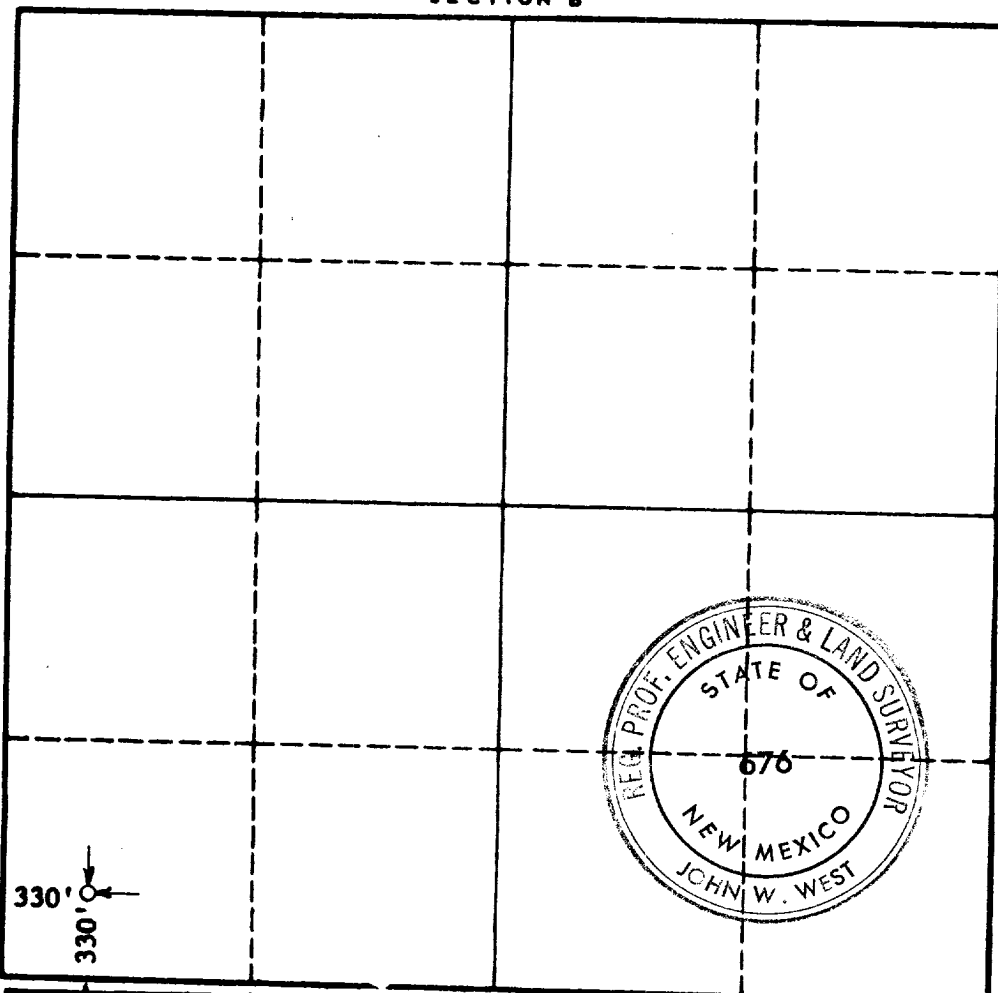

RECEIVED
DEC 19 1962
U.S. GEOLOGICAL SURVEY
WASHINGTON, NEW MEXICO

I hereby certify that the information in SECTION A above is true and complete to the best of my knowledge and belief.

| |
|------------------------------------|
| Name <i>Alley R. Turner</i> |
| Position PROD. SUPT. |
| Company MCCURDY-TRAMMELL |
| Date 12-19-1962 |

I hereby certify that the well location shown on the plat in SECTION B was plotted from field notes of actual surveys made by me or under my supervision, and that the same is true and correct to the best of my knowledge and belief.

| |
|---------------------------------------------------------------------------------|
| Date Surveyed 12-19-1962 |
| Registered Professional Engineer and/or Land Surveyor, JOHN W. WEST |
| Certificate No. <i>John W. West</i> N.M. - P.E. & L.S. NO. 676 |