

NEW MEXICO OIL CONSERVATION COMMISSION
WELL LOCATION AND ACREAGE DEDICATION PLAT

FORM C-128
 Revised 5/1/57

SEE INSTRUCTIONS FOR COMPLETING THIS FORM ON THE REVERSE SIDE

SECTION A

Operator GULF OIL CORPORATION			Lease LEA STATE "EM"		Well No. 1
Unit Letter O	Section 9	Township 17 SOUTH	Range 37 EAST	County LEA	

Actual Footage Location of Well:
660 feet from the **SOUTH** line and **1980** feet from the **EAST** line

Ground Level Elev.	Producing Formation	Pool	Dedicated Acreage: 10 Acres
	the	Undesignated	

1. Is the Operator the only owner in the dedicated acreage outlined on the plat below? YES ☒ NO ____ . ("Owner" means the person who has the right to drill into and to produce from any pool and to appropriate the production either for himself or for himself and another. (65-3-29 (a) NMSA 1955 Comp.)
2. If the answer to question one is "no," have the interests of all the owners been consolidated by communization agreement or otherwise? YES ____ NO ____ . If answer is "yes," Type of Consolidation _____
3. If the answer to question two is "no," list all the owners and their respective interests below:

Owner	Land Description

SECTION B

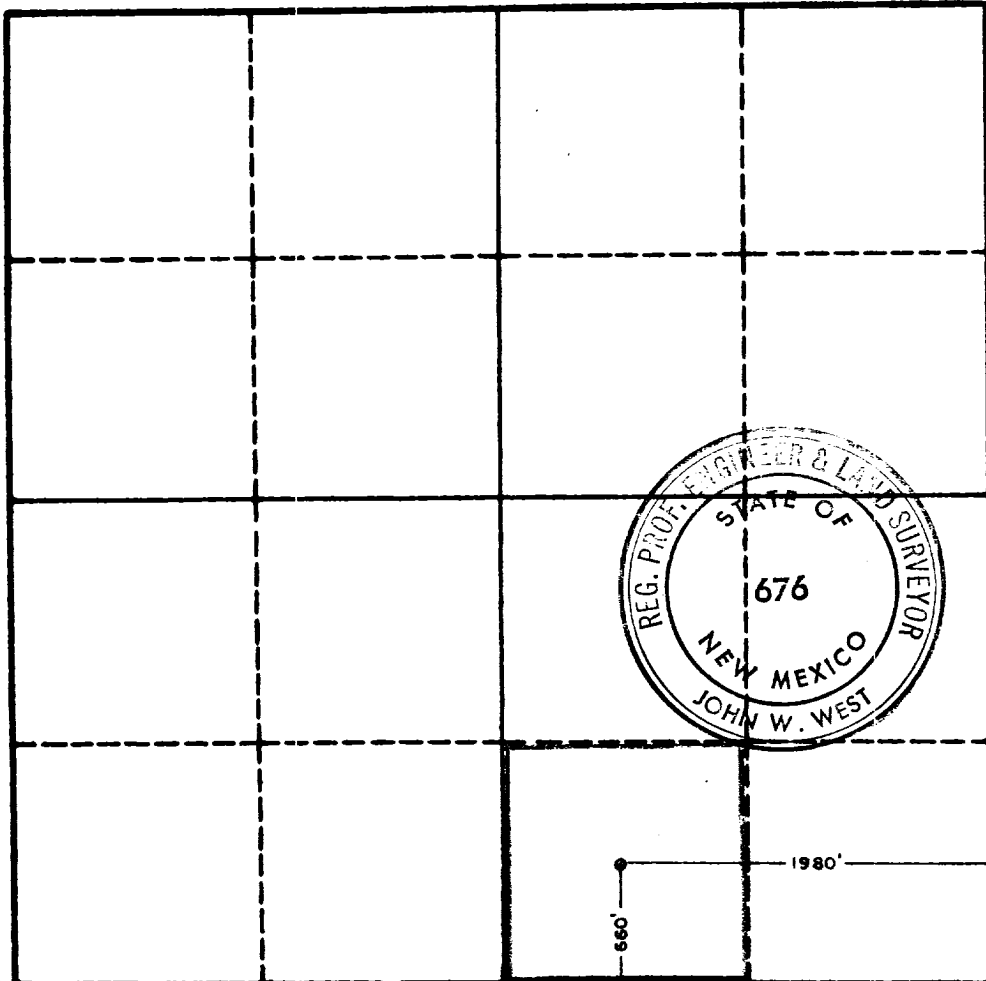

CERTIFICATION

I hereby certify that the information in SECTION A above is true and complete to the best of my knowledge and belief.

Name *W. B. Ballard*
 Position *Asst. Production Manager*
Gulf Oil Corporation
 Date *March 18, 1963*

I hereby certify that the well location shown on the plat in SECTION B was plotted from field notes of actual surveys made by me or under my supervision, and that the same is true and correct to the best of my knowledge and belief.

Date Surveyed *3-14-63*
 Registered Professional Engineer and/or Land Surveyor, *JOHN W. WEST*
John W. West
 Certificate No.
 N.M. - P.E. & L.S. NO. 676

0 330 660 990 1320 1650 1980 2310 2640 2970 3300 0