

RECORD OF DEEDS RECEIVED	
DISTRIBUTION	
SANTA FE	
FILE	
U.S.C.	
LAND OFFICE	
TRANSPORTER	OIL GAS
PRODUCTION OFFICE	
OPERATOR	

**NEW MEXICO OIL CONSERVATION COMMISSION**  
**WELL LOCATION AND ACREAGE DEDICATION PLAT**

FORM C-128  
Revised 5/1/57

OFFICE OF THE COMMISSIONER  
 NOV 9 10 18 AM '63

**SECTION A**

Operator <b>THE ATLANTIC REFINING COMPANY</b>			Lease <b>Ora L. Jackson</b>		Well No. <b>1</b>
Unit Letter <b>K</b>	Section <b>5</b>	Township <b>19 South</b>	Range <b>35 East</b>	County <b>Lea</b>	
Actual Footage Location of Well: 1980 feet from the South line and 1980 feet from the West line					
Ground Level Elev.	Producing Formation <b>Bone Springs</b>	Pool <b>Scharb</b>	Dedicated Acreage: <b>80 Acres</b>		

1. Is the Operator the only owner in the dedicated acreage outlined on the plat below? YES ☒ NO ☐ ("Owner" means the person who has the right to drill into and to produce from any pool and to appropriate the production either for himself or for himself and another. (65-3-29 (e) NMSA 1935 Comp.)
2. If the answer to question one is "no," have the interests of all the owners been consolidated by communitization agreement or otherwise? YES ☐ NO ☐ If answer is "yes," Type of Consolidation \_\_\_\_\_
3. If the answer to question two is "no," list all the owners and their respective interests below:

Owner	Land Description

**SECTION B**

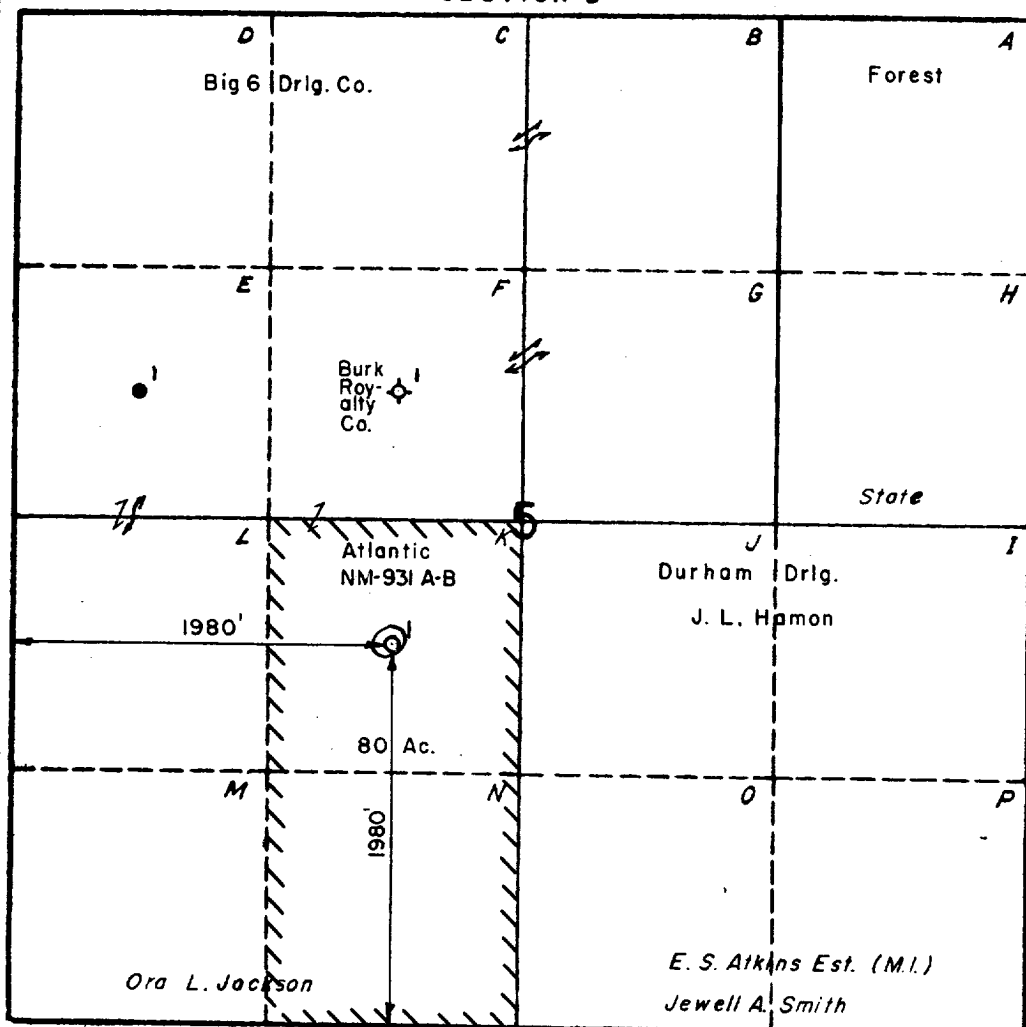

**CERTIFICATION**

I hereby certify that the information in SECTION A above is true and complete to the best of my knowledge and belief.

Name <i>A. O. Keapin</i>
Position Dist. Drlg. & Prod. Supt.
Company The Atlantic Refining Co.
Date November 7, 1963

I hereby certify that the well location shown on the plat in SECTION B was plotted from field notes of actual surveys made by me or under my supervision, and that the same is true and correct to the best of my knowledge and belief.

<i>W. J. Burkart</i>
W. J. BURKART Surveyor The Atlantic Refining Company
Date Surveyed: 11-6-63

PA10-1168