

HUMBLE LEASE NO. 604847 NEW MEXICO OIL CONSERVATION COMMISSIONSTATE LEASE NO.  
FEDERAL LEASE NO.Well Location and Acreage Dedication PlatForm C-128  
Revised 5/1/57

## Section A.

Date Sept. 13, 1963

Operator Humble Oil & Refining Co Lease Charles S. Alves  
Well No. 1 Unit Letter "B" Section 7 Township 19-South Range 35-East NMPH  
Located 660 Feet From North Line, 1980 Feet From East Line  
County Lea G. L. Elevation Later Dedicated Acreage 80 1/2 Acres  
Name of Producing Formation Bone Spring Pool Scharb

1. Is the Operator the only owner\* in the dedicated acreage outlined on the plat below?  
Yes ☒ No ☐
2. If the answer to question one is "no", have the interests of all the owners been consolidated by communitization agreement or otherwise? Yes ☐ No ☐ If answer is "yes," Type of Consolidation \_\_\_\_\_
3. If the answer to question two is "no," list all the owners and their respective interests below:

OwnerLand Description

## Section B

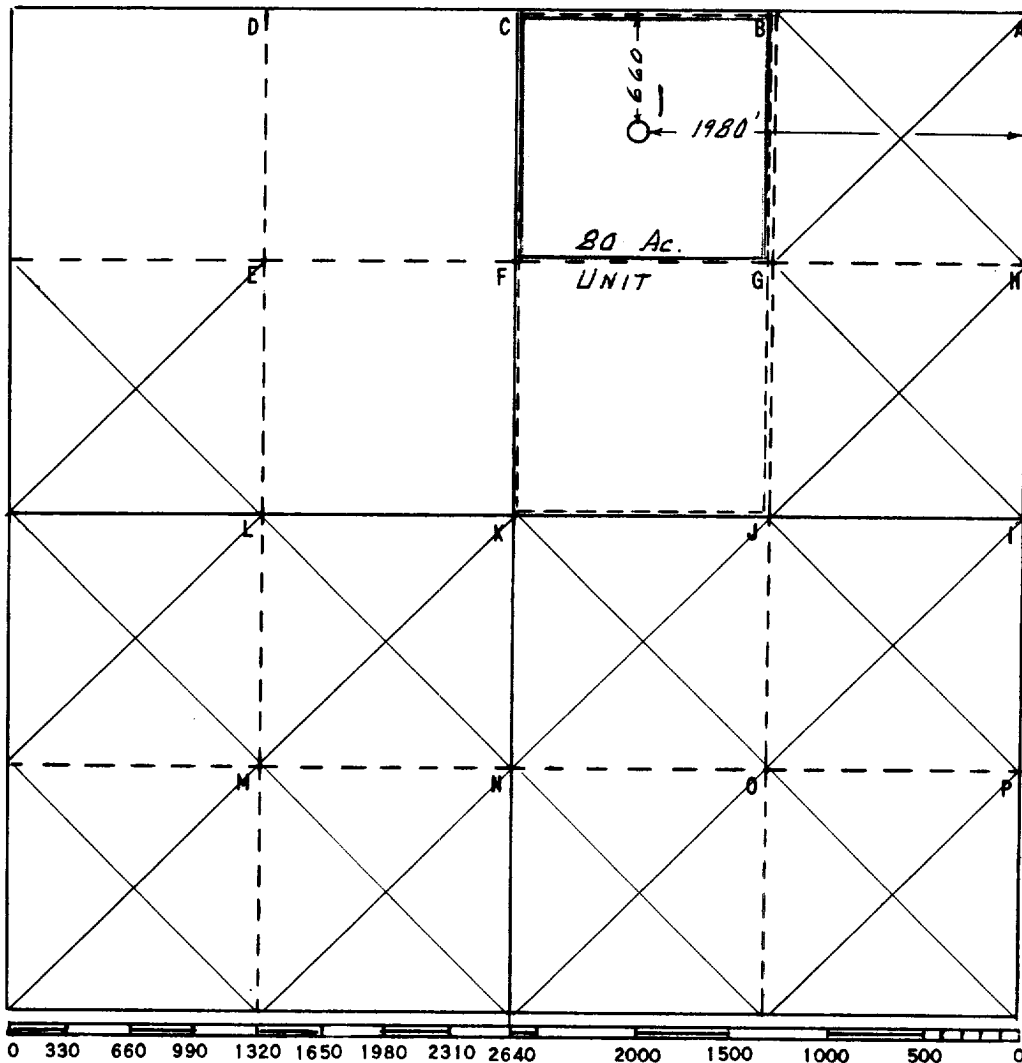

This is to certify that the information in Section A above is true and complete to the best of my knowledge and belief

HUMBLE OIL & REFG. CO.

(Operator)

H. P. Hensley  
(Representative)Box 1600 Midland, Texas  
Address

This is to certify that the well location shown on the plat in Section B was plotted from field notes of actual surveys made by me or under my supervision and that the same is true and correct to the best of my knowledge and belief.

Date Surveyed 9-13-63H. S. Hunterfield  
Registered Professional  
Engineer and/or Land SurveyorCertificate No. 1382

FILE NO. W-A-3506