

HUMBLE LEASE NO. 604847

## NEW MEXICO OIL CONSERVATION COMMISSION

HOBBS OFFICE O.C.C. Form C-128

STATE LEASE NO.

FEDERAL LEASE NO.

Well Location and Acreage Dedication Plat

Revised 5/1/57

Nov 15 10 13 AM '63

Section A.

Date November 13, 1963

Operator Humble Oil & Refining Co Lease Charles S. Alves  
 Well No. 2 Unit Letter "C" Section 7 Township 19 South Range 35 East NMPM  
 Located 520 Feet From North Line, 2120 Feet From West Line  
 County Lea G. L. Elevation Later Dedicated Acreage 80.87 Acres  
 Name of Producing Formation Bone Spring Pool Scharb

1. Is the Operator the only owner\* in the dedicated acreage outlined on the plat below?  
 Yes ☒ No ☐
2. If the answer to question one is "no", have the interests of all the owners been consolidated by communitization agreement or otherwise? Yes ☐ No ☐ If answer is "yes," Type of Consolidation \_\_\_\_\_
3. If the answer to question two is "no," list all the owners and their respective interests below:

OwnerLand Description

Section B

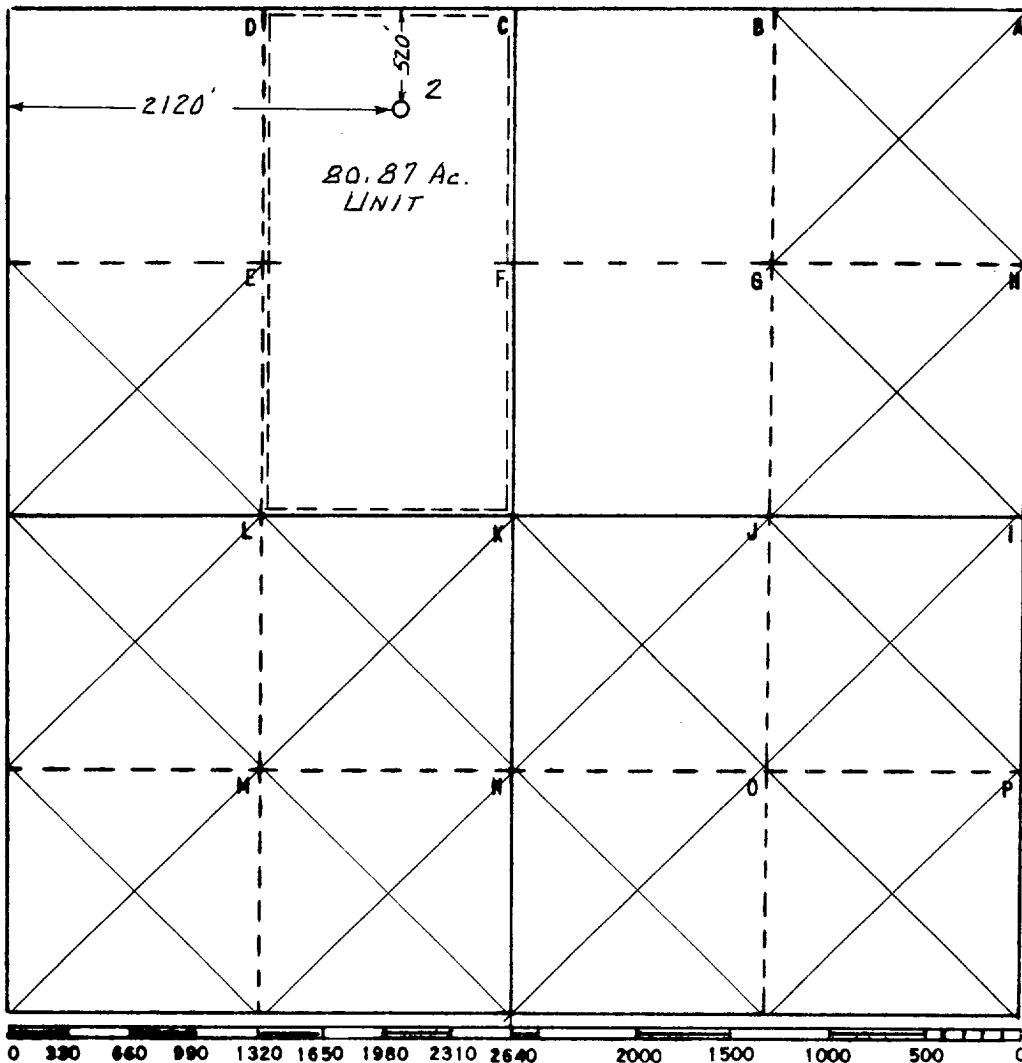

This is to certify that the information in Section A above is true and complete to the best of my knowledge and belief

HUMBLE OIL & REFG. CO.

(Operator)

H. R. Henoley  
 (Representative)

Box 1600 Midland, Texas  
 Address

This is to certify that the well location shown on the plat in Section B was plotted from field notes of actual surveys made by me or under my supervision and that the same is true and correct to the best of my knowledge and belief.

Date Surveyed Nov. 12, 1963

R. A. Everts  
 Registered Professional  
 Engineer and/or Land Surveyor

Certificate No. 554

FILE NO. W-A-3506