

HUMBLE LEASE NO. 24241 NEW MEXICO OIL CONSERVATION COMMISSION

STATE LEASE NO. A-1320

FEDERAL LEASE NO.

Well Location and Acreage Dedication Plat

Form C-128
HOBBS OFFICE 6/6/57

Section A.

Date Apr 8/10/63 AM '64

Operator Humble Oil & Refining Co. Lease New Mexico State "K"
Well No. 22 Unit Letter J Section 32 Township 17 South Range 35 East NMPM
Located 1980 Feet From South Line, 2307 Feet From East Line
County Lea G. L. Elevation Later Dedicated Acreage 40 Acres
Name of Producing Formation Glorieta Pool Vacuum

1. Is the Operator the only owner* in the dedicated acreage outlined on the plat below?
Yes ☒ No ☐
2. If the answer to question one is "no", have the interests of all the owners been consolidated by communitization agreement or otherwise? Yes ☐ No ☐ If answer is "yes," Type of Consolidation _____
3. If the answer to question two is "no," list all the owners and thier respective interests below:

Owner

Land Description

Section B

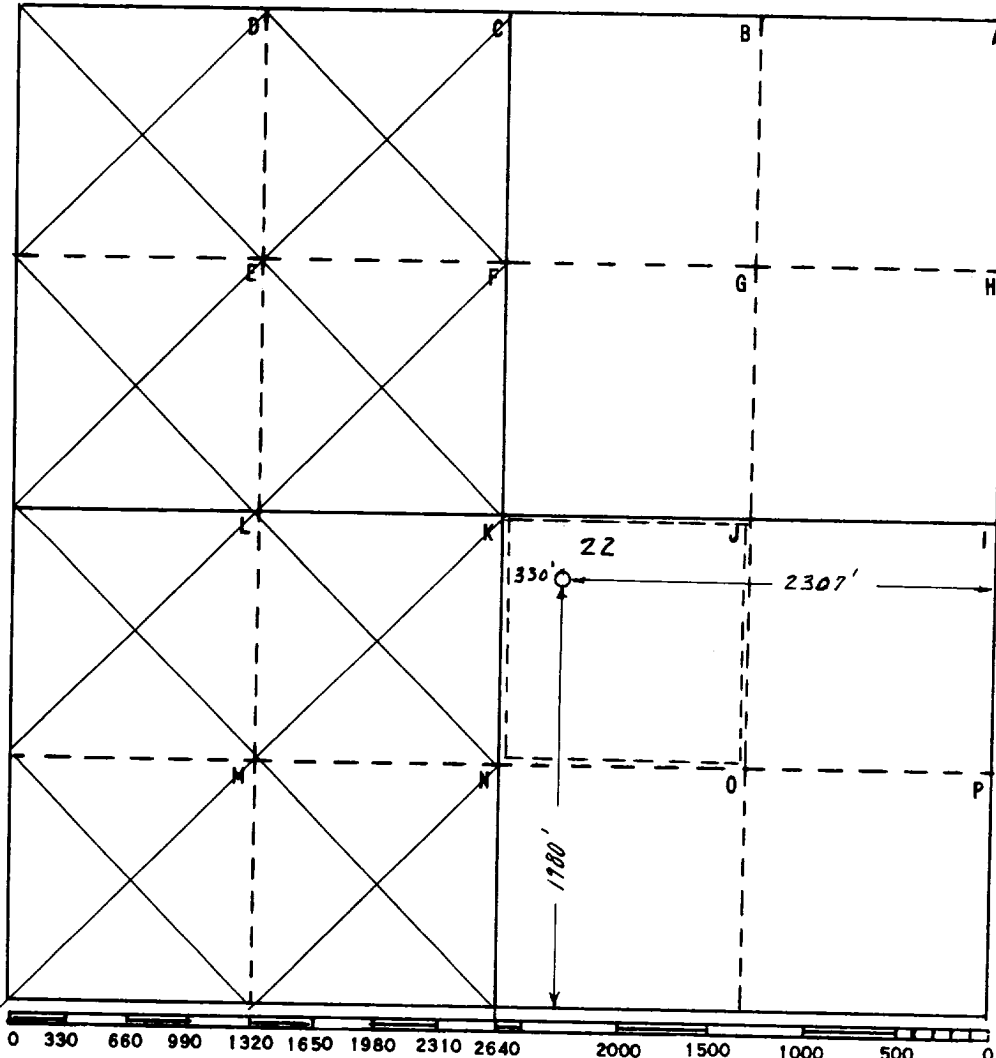

This is to certify that the information in Section A above is true and complete to the best of my knowledge and belief

HUMBLE OIL & REFG. CO.

(Operator)

H. P. Henderson
(Representative)

Box 1600 Midland, Texas
Address

This is to certify that the well location shown on the plat in Section B was plotted from field notes of actual surveys made by me or under my supervision and that the same is true and correct to the best of my knowledge and belief.

Date Surveyed 3-25-64

H. S. Winterfeld
Registered Professional
Engineer and/or Land Surveyor

Certificate No. 1832

FILE NO. W-A-3106