

NUMBER OF COPIES RECEIVED	
DISTRIBUTION	
SANTA FE	
FILE	
U.S.G.S.	
LAND OFFICE	
TRANSPORTER	OIL GAS
PRODUCTION OFFICE	
OPERATOR	

NEW MEXICO OIL CONSERVATION COMMISSION
Santa Fe, New Mexico

Form C-101
Revised (12/1/55)

NOTICE OF INTENTION TO DRILL

Notice must be given to the District Office of the Oil Conservation Commission and approval obtained before drilling or recompletion begins. If changes in the proposed plan are considered advisable, a copy of this notice showing such changes will be returned to the sender. Submit this notice in **QUINTUPPLICATE**. One copy will be returned following approval. See additional instructions in Rules and Regulations of the Commission.

If State Land submit 6 Copies Attach Form C-128 in triplicate to first 3 copies of form C-101

Hobbs, New Mexico

(Place)

September 2, 1964

(Date)

OIL CONSERVATION COMMISSION
SANTA FE, NEW MEXICO

Gentlemen:

You are hereby notified that it is our intention to commence the Drilling of a well to be known as

Phillips Petroleum Company

(Company, or Operator)

Santa Fe

(Lease)

106

H

(Unit)

located **2320 2323** feet from the **north** line and **660** feet from the

east

line of Section **29**, T. **17S**, R. **35E**, NMPM.

(GIVE LOCATION FROM SECTION LINE)

Vacuum Glorieta

Pool,

Lea

County

If State Land the Oil and Gas Lease is No. **B-2131**

If patented land the owner is

Address

We propose to drill well with drilling equipment as follows: **Rotary**

The status of plugging bond is **blanket**

Drilling Contractor **Phillips Petroleum Company Rig No. 30**

We intend to complete this well in the **Glorieta**

formation at an approximate depth of **6400'** feet.

CASING PROGRAM

We propose to use the following strings of Casing and to cement them as indicated:

Size of Hole	Size of Casing	Weight per Foot	New or Second Hand	Depth	Sacks Cement
12-1/4"	8-5/8"	24#	New	1625'	Cire to surface
7-7/8"	4-1/2"	9.5 & 10.5#	New	6400'	1750 cu. ft.

If changes in the above plans become advisable we will notify you immediately.

ADDITIONAL INFORMATION (If recompletion give full details of proposed plan of work.)

Approved *[Signature]*, 19 *[Signature]*
Except as follows:

Sincerely yours,

Phillips Petroleum Company

(Company or Operator)

By *[Signature]*

Position **Office Manager**

Send Communications regarding well to

Name **Phillips Petroleum Company**

Address **Box 2130 - Hobbs, New Mexico**

OIL CONSERVATION COMMISSION

By *[Signature]*

NUMBER OF COPIES RECEIVED	
DISTRIBUTION	
SANTA FE	
FILE	
U.S.G.S.	
LAND OFFICE	
TRANSPORTER	OIL GAS
PRODUCTION OFFICE	
OPERATOR	

NEW MEXICO OIL CONSERVATION COMMISSION WELL LOCATION AND ACREAGE DEDICATION PLAT

FORM C-128
Revised 5/1/57

SEE INSTRUCTIONS FOR COMPLETING THIS FORM ON THE REVERSE SIDE OF C.

SEP 3 11 10 AM '64

SECTION A

Operator Phillips Petroleum Company		Lease Santa Fe		Well No. 106	
Unit Letter H	Section 29	Township 17S	Range 35E	County Lea	
Actual Footage Location of Well: 2323 feet from the north line and 660 feet from the east line					
Ground Level Elev. (later)	Producing Formation Glorieta	Pool Vacuum Glorieta	Dedicated Acreage: 40 Acres		

1. Is the Operator the only owner in the dedicated acreage outlined on the plat below? YES ☒ NO ____ . ("Owner" means the person who has the right to drill into and to produce from any pool and to appropriate the production either for himself or for himself and another. (65-3-29 (e) NMSA 1935 Comp.)
2. If the answer to question one is "no," have the interests of all the owners been consolidated by communitization agreement or otherwise? YES ____ NO ____ . If answer is "yes," Type of Consolidation ____
3. If the answer to question two is "no," list all the owners and their respective interests below:

Owner	Land Description

SECTION B

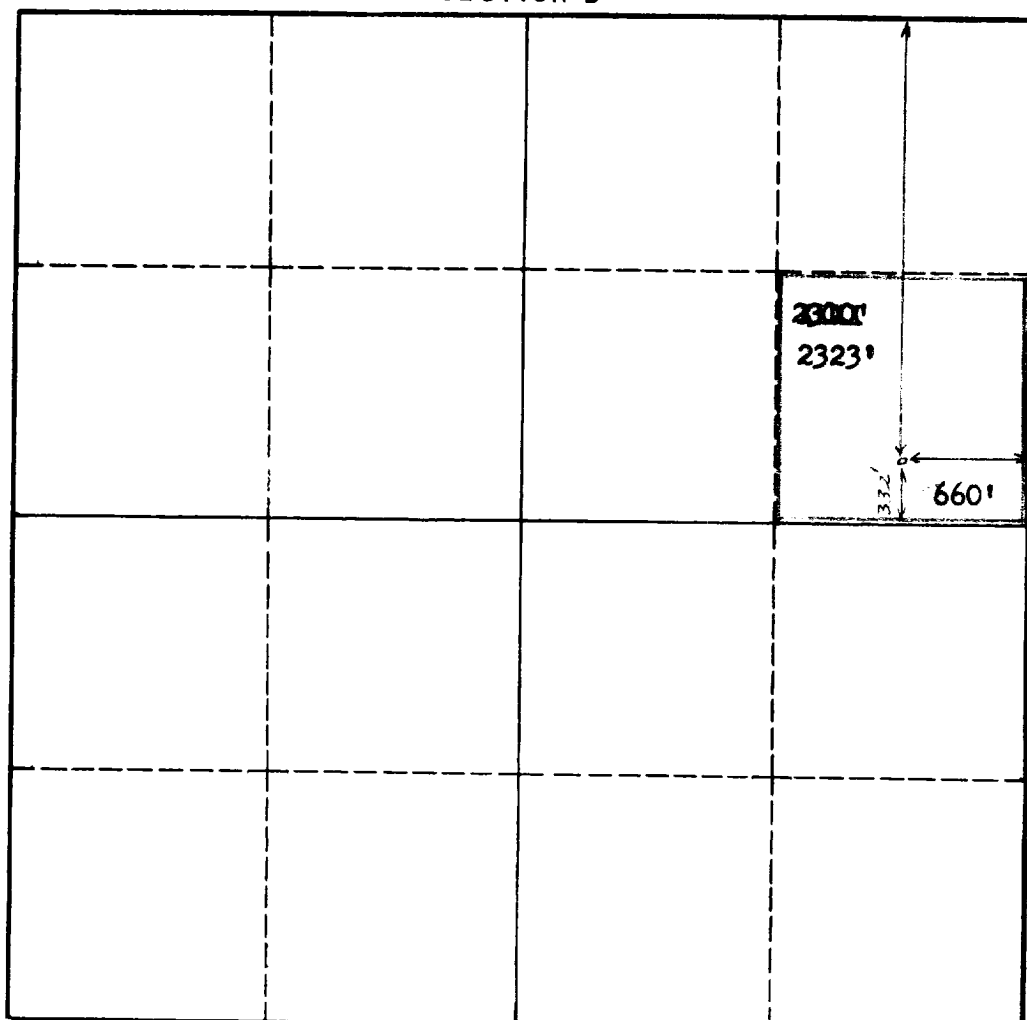

CERTIFICATION

I hereby certify that the information in SECTION A above is true and complete to the best of my knowledge and belief.

Name W. E. Spry
Position Office Manager
Company Phillips Petroleum Co.
Date September 2, 1964

I hereby certify that the well location shown on the plat in SECTION B was plotted from field notes of actual surveys made by me or under my supervision, and that the same is true and correct to the best of my knowledge and belief.

Date Surveyed August 14, 1964
Registered Professional Engineer and/or Land Surveyor W. E. Spry
Certificate No. 679

0 330 660 990 1320 1650 1980 2310 2640 2000 1500 1000 500 0

INSTRUCTIONS FOR COMPLETION OF FORM C-128

1. Operator shall furnish and certify to the information called for in Section A.
2. Operator shall outline the dedicated acreage for *both* oil and gas wells on the plat in Section B.
3. A registered professional engineer or land surveyor registered in the State of New Mexico or approved by the Commission shall show on the plat the location of the well and certify this information in the space provided.
4. All distances shown on the plat must be from the outer boundaries of the Section.
5. If additional space is needed for listing owners and their respective interests as required in question 3 of Section A, please use space below.