

Submit to Appropriate  
District Office  
State Lease - 6 copies  
Fee Lease - 5 copies

State of New Mexico  
Energy Minerals and Natural Resources Department

Form C-101  
Revised 1-1-89

**OIL CONSERVATION DIVISION**  
P.O. Box 2088  
Santa Fe, New Mexico 87504-2088

**DISTRICT I**  
P.O. Box 1980, Hobbs, NM 88240

**DISTRICT II**  
P.O. Drawer DD, Artesia, NM 88210

**DISTRICT III**  
1000 Rio Brazos Rd., Aztec, NM 87410

API NO. (assigned by OCD on New Wells)

3D-025-20823

5. Indicate Type of Lease

STATE ☒ FEE ☐

6. State Oil & Gas Lease No.

**APPLICATION FOR PERMIT TO DRILL, DEEPEN, OR PLUG BACK**

1a. Type of Work:

DRILL ☐ RE-ENTER ☐ DEEPEN ☒ PLUG BACK ☐

b. Type of Well:

OIL WELL ☒ GAS WELL ☐ OTHER ☐ SINGLE ZONE ☒ MULTIPLE ZONE ☐

2. Name of Operator

SHELL WESTERN E&P INC.

3. Address of Operator

P. O. BOX 576, HOUSTON, TX 77001 (WCK 4465)

7. Lease Name or Unit Agreement Name

STATE E

8. Well No.

2

9. Pool name or Wildcat

VACUUM DRINKARD

4. Well Location

Unit Letter N : 660 Feet From The SOUTH Line and 1700 Feet From The WEST Line

Section 31 Township 17S Range 35E NMPM LEA County

10. Proposed Depth

10,406' (TD)

11. Formation

DRINKARD

12. Rotary or C.T.

ROTARY

13. Elevations (Show whether DF, RT, GR, etc.)

3996' DF

14. Kind & Status Plug. Bond

BLANKET

15. Drilling Contractor

WORKOVER RIG

16. Approx. Date Work will start

UPON APPROVAL

17.

**PROPOSED CASING AND CEMENT PROGRAM**

SIZE OF HOLE	SIZE OF CASING	WEIGHT PER FOOT	SETTING DEPTH	SACKS OF CEMENT	EST. TOP
17-1/2"	13-3/8"	48#	332'	300	*
12-1/4"	9-5/8"	36#	3285'	475	**
8-3/4"	7"	20,23,26#	9505'	1800***	SURF***

\*HAD FULL RETURNS, BUT CMT DID NOT CIRC. FILLED IN AROUND CSG W/PEA GRVL.

\*\*12/75: PMPD 500 SX CMT DWN 13-3/8 X 9-5/8" ANN TO STOP WTR FLW. DISPL CMT 50' BELOW SURF.

\*\*\*4/80: RAN GR/CBL/CCL. TOC @ 3360'. SHOT 4 HOLES @ 3320' & SQZD W/1260 SX CMT. CIRC CMT TO SURF.

WE WISH TO SQZ VACUUM GLORIETA AND RECOMP TO VACUUM DRINKARD AS FOLLOWS:

1. POH W/PROD EQMT.
2. SET CIRC @ 5800'.
3. SQZ GLORIETA PERFS 5999' - 6223' W/150 SX CLS C NEAT CMT.
4. DO CIRC @ 5800' & CO TO CIBP @ 6296'. PT CSG TO 1500#.
5. DRILL UP CIBP @ 6296'. PUSH REMNANTS TO 8100. CIRC CLN.
6. RUN GR/CBL FROM 8100' - 6500'.

(CONT'D ON REVERSE SIDE)

IN ABOVE SPACE DESCRIBE PROPOSED PROGRAM: IF PROPOSAL IS TO DEEPEN OR PLUG BACK, GIVE DATA ON PRESENT PRODUCTIVE ZONE AND PROPOSED NEW PRODUCTIVE ZONE. GIVE BLOWOUT PREVENTER PROGRAM, IF ANY.

I hereby certify that the information above is true and complete to the best of my knowledge and belief.

SIGNATURE J. L. Morris TITLE TECH. MANAGER - ASSET ADMIN DATE 9/21/93

TYPE OR PRINT NAME J. L. MORRIS

(713) 544-3797

TELEPHONE NO.

(This space for State Use)

**ORIGINAL SIGNED BY JERRY SEXTON**  
**DISTRICT I SUPERVISOR**

APPROVED BY \_\_\_\_\_ TITLE \_\_\_\_\_ DATE SEP 23 1993

CONDITIONS OF APPROVAL, IF ANY:

7. SET CIBP @ 8100'. PT CSG TO 1500#.
8. PERF DRINKARD 7718' - 7904' (2 SPF).
9. SET RBP @ 8075'. AT PERFS 7718'-7904' W/28,000 GAL NE 20% HCL.
10. SI WELL 2 HRS PRIOR TO FLW BACK. SWB WELL IF DOES NOT FLW.
11. REL RBP & RESET @ 7700'.
12. PERF DRINKARD 7618' - 7688' (2 SPF).
13. AT PERFS 7618-88' W/22,500 GAL NE 20% HCL.
14. SI WELL 2 HRS PRIOR TO FLW BACK. SWB WELL IF DOES NOT FLW.
15. REL RBP & RESET @ 7600'.
16. PERF DRINKARD 7534-91' (2 SPF).
17. AT PERFS 7534-91' W/12,000 GAL NE 20% HCL.
18. SI WELL 2 HRS PRIOR TO FLW BACK. SWB WELL IF DOES NOT FLW.
19. REL RBP & POH.
20. SET PROD PKR @ 7450'.
21. SWB WELL & THEN TURN TO FL.

RECEIVED

SEP 22 1993

OFFICE

Submit to Appropriate  
District Office  
State Lease - 4 copies  
Fee Lease - 3 copies

State of New Mexico  
Energy, Minerals and Natural Resources Department

Form C-102  
Revised 1-1-89

OIL CONSERVATION DIVISION

P.O. Box 2088  
Santa Fe, New Mexico 87504-2088

DISTRICT I  
P.O. Box 1980, Hobbs, NM 88240

DISTRICT II  
P.O. Drawer DD, Artesia, NM 88210

DISTRICT III  
1000 Rio Brazos Rd., Aztec, NM 87410

WELL LOCATION AND ACREAGE DEDICATION PLAT

All Distances must be from the outer boundaries of the section

Operator Shell Western E&P Inc.			Lease STATE E		Well No. 2
Unit Letter N	Section 31	Township 17S	Range 35E	County NMPM LEA	
Actual Footage Location of Well: 660 feet from the SOUTH line and 1700 feet from the WEST line					
Ground level Elev. 3996' DF	Producing Formation DRINKARD		Pool VACUUM DRINKARD	Dedicated Acreage: 40 Acres	

1. Outline the acreage dedicated to the subject well by colored pencil or hatchure marks on the plat below.
2. If more than one lease is dedicated to the well, outline each and identify the ownership thereof (both as to working interest and royalty).
3. If more than one lease of different ownership is dedicated to the well, have the interest of all owners been consolidated by communitization, unitization, force-pooling, etc?  
☐ Yes ☐ No If answer is "yes" type of consolidation \_\_\_\_\_  
If answer is "no" list the owners and tract descriptions which have actually been consolidated. (Use reverse side of this form if necessary.)  
No allowable will be assigned to the well until all interests have been consolidated (by communitization, unitization, forced-pooling, or otherwise) or until a non-standard unit, eliminating such interest, has been approved by the Division.

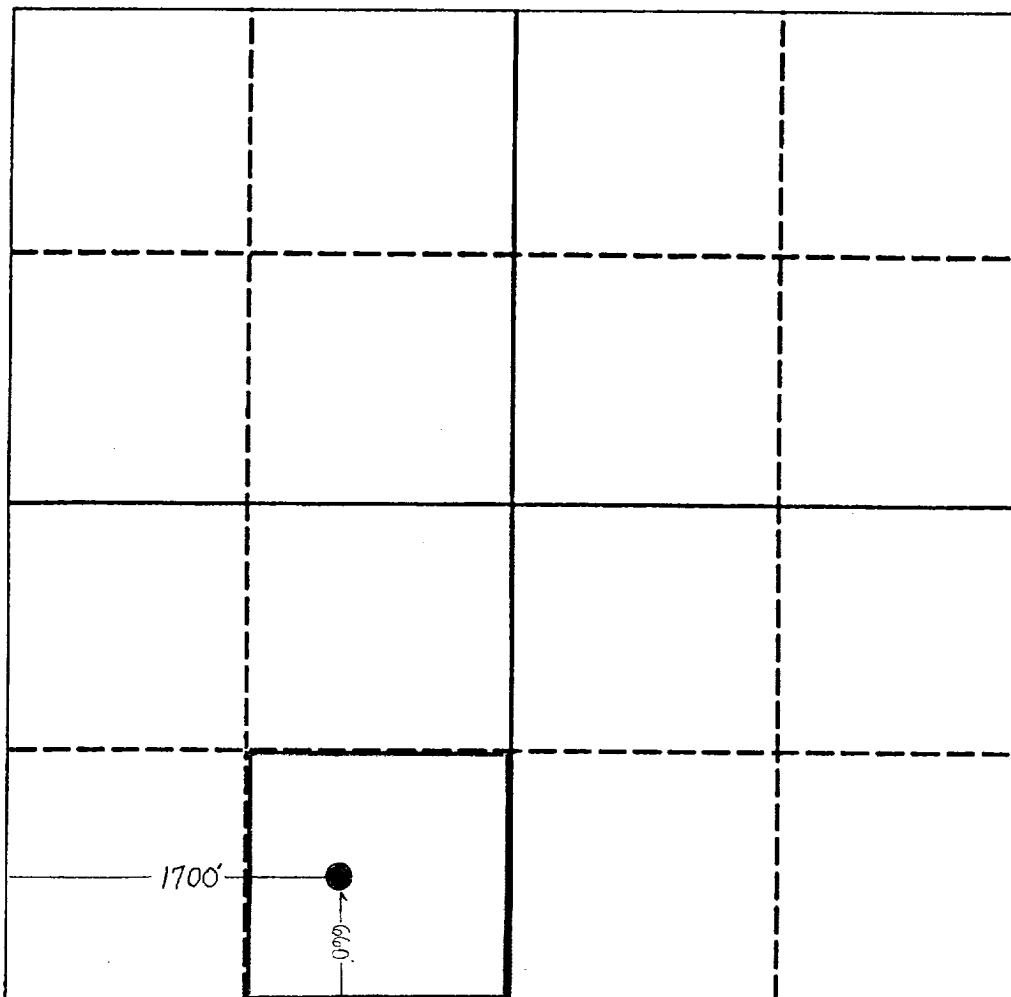

OPERATOR CERTIFICATION

I hereby certify that the information contained herein is true and complete to the best of my knowledge and belief.

Signature  
*J. L. Morris*  
Printed Name  
J. L. MORRIS  
Position  
TECH. MANAGER - ASSET ADMIN.  
Company  
SHELL WESTERN E&P INC.  
Date  
9/22/93

SURVEYOR CERTIFICATION

I hereby certify that the well location shown on this plat was plotted from field notes of actual surveys made by me or under my supervision, and that the same is true and correct to the best of my knowledge and belief.

Date Surveyed  
Signature & Seal of Professional Surveyor  
Certificate No.

**RECEIVED**

**SEP 22 1993**

**ODD ROADS  
OFFICE**