

NEW MEXICO OIL CONSERVATION COMMISSION
Santa Fe, New Mexico

Form G-101
Revised (12/1/55)

NOTICE OF INTENTION TO DRILL

Notice must be given to the District Office of the Oil Conservation Commission and approval obtained before drilling or recompletion begins. If changes in the proposed plan are considered advisable, a copy of this notice showing such changes will be returned to the sender. Submit this notice in QUINTUPLICATE. One copy will be returned following approval. See additional instructions in Rules and Regulations of the Commission. If State Land submit 6 Copies Attach Form G-128 in triplicate to first 3 copies of form G-101

Muskogee, Texas

(Place)

June 22, 1964

(Date)

OIL CONSERVATION COMMISSION
SANTA FE, NEW MEXICO

Gentlemen:

You are hereby notified that it is our intention to commence the Drilling of a well to be known as
Standard Oil Company of Texas, A Division of California Oil Company

(Company or Operator)

State 5-27

(Lease)

Well No. 8, in D (Unit) The well is

located 990 feet from the North line and 330 feet from the West line of Section 27, T. 17 South, R. 35 East, NMPM.

(GIVE LOCATION FROM SECTION LINE) Vacuum (Glorieta) Pool, Lea County

990' WEL. & 330' WEL.

D	C	B	A
E	F	G	H
L	K	J	I
M	N	O	P

Section 27

If State Land the Oil and Gas Lease is No. B-1839

If patented land the owner is --

Address --

We propose to drill well with drilling equipment as follows: Rotary tools

The status of plugging bond is Blanket

Drilling Contractor Noble Drilling Corp., Box 550, Midland, Texas

We intend to complete this well in the Glorieta formation at an approximate depth of 6350 feet.

CASING PROGRAM

We propose to use the following strings of Casing and to cement them as indicated:

Size of Hole	Size of Casing	Weight per Foot	New or Second Hand	Depth	Sacks Cement
12-1/4"	8-5/8"	24 & 32	New	1600	Cement to Surface
7-7/8"	4-1/2"	9.5	New	6350	600 sbl. **

If changes in the above plans become advisable we will notify you immediately.

ADDITIONAL INFORMATION (If recompletion give full details of proposed plan of work.)

** Oil string cemented at approximately 6350 feet with sufficient cement to tie into salt section.

Approved: _____, 19_____
Except as follows:

OIL CONSERVATION COMMISSION

By: _____

Sincerely yours,
Standard Oil Company of Texas,
A Division of California Oil Company
(Company or Operator)

By: G. G. Koenig

Position: Lead Engineer

Send Communications regarding well to

Name: A Division of California Oil Company

Address: Drawer "S", Muskogee, Texas

NEW MEXICO OIL CONSERVATION COMMISSION

WELL LOCATION AND ACREAGE DEDICATION

HOBBBS OFFICE, O. C. C.
FORM C-128
Revised 2/1/57

SEE INSTRUCTIONS FOR COMPLETING THIS FORM ON THE REVERSE SIDE

SECTION A

Operator STANDARD OIL COMPANY				Lease		Well No.	
Unit Letter D	Section 27	Township 17 SOUTH	Range 35 EAST	County LEA		State STATE 5-27	
Actual Passage Location of Well: 990 feet from the NORTH line and 330 feet from the WEST line							
Ground Level Elev. 990		Producing Formation Glorieta		Pool Vacuum (Glorieta)		Dedicated Acreage: 80 Acres	

1. Is the Operator the only owner in the dedicated acreage outlined on the plat below? YES ☒ NO ☐ ("Owner" means the person who has the right to drill into and to produce from any pool and to appropriate the production either for himself or for himself and another. (63-3-29 (v) NMSA 1935 Comp.)
2. If the answer to question one is "no," have the interests of all the owners been consolidated by communication agreement or otherwise? YES ☐ NO ☐ If answer is "yes," Type of Consolidation _____
3. If the answer to question two is "no," list all the owners and their respective interests below:

Owner	Land Description

SECTION B

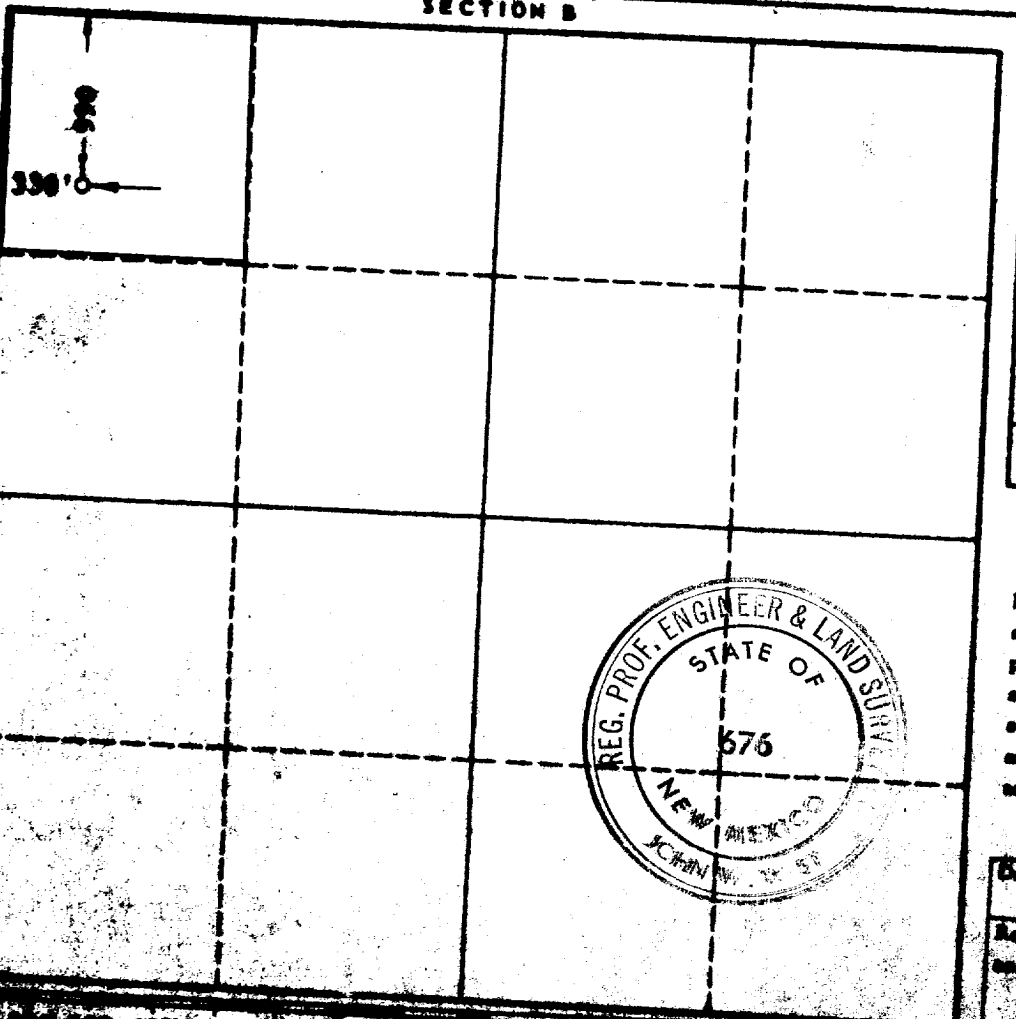

CERTIFICATION

I hereby certify that the information in SECTION A above is true and complete to the best of my knowledge and belief.

Name G. G. Hennig
Position Lead Engineer
Company STANDARD OIL COMPANY, A DIV. OF CALIF. OIL COMPANY
Date June 22, 1964

I hereby certify that the well location shown on the plat in SECTION B was plotted from field notes of actual surveys made by me or under my supervision, and that the same is true and correct to the best of my knowledge and belief.

Date Surveyed MAY 22, 1964
Signature and Printed Name of Engineer John A. Schmitt