

NO. OF COPIES RECEIVED	
DISTRIBUTION	
SANTA FE	
FILE	
U.S.G.S.	
LAND OFFICE	
OPERATOR	

NEW MEXICO OIL CONSERVATION COMMISSION

Form C-101
Revised 1-1-65

APPLICATION FOR PERMIT TO DRILL, DEEPEN, OR PLUG BACK

a. Type of Work		DRILL <input checked="" type="checkbox"/> DEEPEN <input type="checkbox"/> PLUG BACK <input type="checkbox"/>		5A. Indicate Type of Lease STATE <input checked="" type="checkbox"/> FEE <input type="checkbox"/>
b. Type of Well		OIL WELL <input checked="" type="checkbox"/> GAS WELL <input type="checkbox"/> OTHER <input type="checkbox"/>		5. State Oil & Gas Lease No. B-1527
c. Name of Operator		Socony Mobil Oil Company, Inc.		7. Unit Agreement Name
d. Address of Operator		P. O. Box 1800, Hobbs, New Mexico		8. Farm or Lease Name State "K"
e. Location of Well		UNIT LETTER J LOCATED 1980 FEET FROM THE East LINE		9. Well No. 9
f. Location of Well		2110 FEET FROM THE South LINE OF SEC. 31 TWP. 17S RGE. 35E NMPM		10. Field and Pool, or Wildcat Vacuum Glorieta
g. Location of Well		2110 FEET FROM THE South LINE OF SEC. 31 TWP. 17S RGE. 35E NMPM		12. County Lea
h. Location of Well		2110 FEET FROM THE South LINE OF SEC. 31 TWP. 17S RGE. 35E NMPM		19. Proposed Depth 6350
i. Location of Well		2110 FEET FROM THE South LINE OF SEC. 31 TWP. 17S RGE. 35E NMPM		19A. Formation Glorieta
j. Location of Well		2110 FEET FROM THE South LINE OF SEC. 31 TWP. 17S RGE. 35E NMPM		20. Rotary or C.T. Rotary
k. Location of Well		2110 FEET FROM THE South LINE OF SEC. 31 TWP. 17S RGE. 35E NMPM		21. Elevations (Show whether DF, RT, etc.) 3975' GR
l. Location of Well		2110 FEET FROM THE South LINE OF SEC. 31 TWP. 17S RGE. 35E NMPM		21A. Kind & Status Plug. Bond On File
m. Location of Well		2110 FEET FROM THE South LINE OF SEC. 31 TWP. 17S RGE. 35E NMPM		21B. Drilling Contractor Notify on C-103
n. Location of Well		2110 FEET FROM THE South LINE OF SEC. 31 TWP. 17S RGE. 35E NMPM		22. Approx. Date Work will start Feb. 22, 1965

23. PROPOSED CASING AND CEMENT PROGRAM

SIZE OF HOLE	SIZE OF CASING	WEIGHT PER FOOT	SETTING DEPTH	SACKS OF CEMENT	EST. TOP
12 1/4"	8 5/8"	24#	1550'	900	Circ.
7 7/8"	4 1/2"	9.5#	6350	1600	Circ.

IN ABOVE SPACE DESCRIBE PROPOSED PROGRAM: IF PROPOSAL IS TO DEEPEN OR PLUG BACK, GIVE DATA ON PRESENT PRODUCTIVE ZONE AND PROPOSED NEW PRODUCTIVE ZONE, GIVE BLOWOUT PREVENTER PROGRAM, IF ANY.

I hereby certify that the information above is true and complete to the best of my knowledge and belief.

Signed [Signature] Title Group Supervisor Date 2-12-65

(This space for State Use)

APPROVED BY _____ TITLE _____ DATE _____

CONDITIONS OF APPROVAL, IF ANY:

NEW I CO OIL CONSERVATION COMMISSION
WELL LOCATION AND ACREAGE DEDICATION PLAT

Form C-102
Supersedes C-128
Effective 1-1-65

All distances must be from the outer boundaries of the Section.

Operator Socony Mobil Oil Company, Inc.		Lease State "K"		Well No. 9
Unit Letter J	Section 31	Township 17 S	Range 35 E	County Lea
Actual Footage Location of Well: 1980 feet from the East line and 2110 feet from the South line				
Ground Level Elev: 3975'	Producing Formation Glorieta	Pool Vacuum Glorieta	Dedicated Acreage: 40 Acres	

1. Outline the acreage dedicated to the subject well by colored pencil or hachure marks on the plat below.
2. If more than one lease is dedicated to the well, outline each and identify the ownership thereof (both as to working interest and royalty).
3. If more than one lease of different ownership is dedicated to the well, have the interests of all owners been consolidated by communitization, unitization, force-pooling, etc?

☐ Yes ☐ No If answer is "yes," type of consolidation _____

If answer is "no," list the owners and tract descriptions which have actually been consolidated. (Use reverse side of this form if necessary.) _____

No allowable will be assigned to the well until all interests have been consolidated (by communitization, unitization, forced-pooling, or otherwise) or until a non-standard unit, eliminating such interests, has been approved by the Commission.

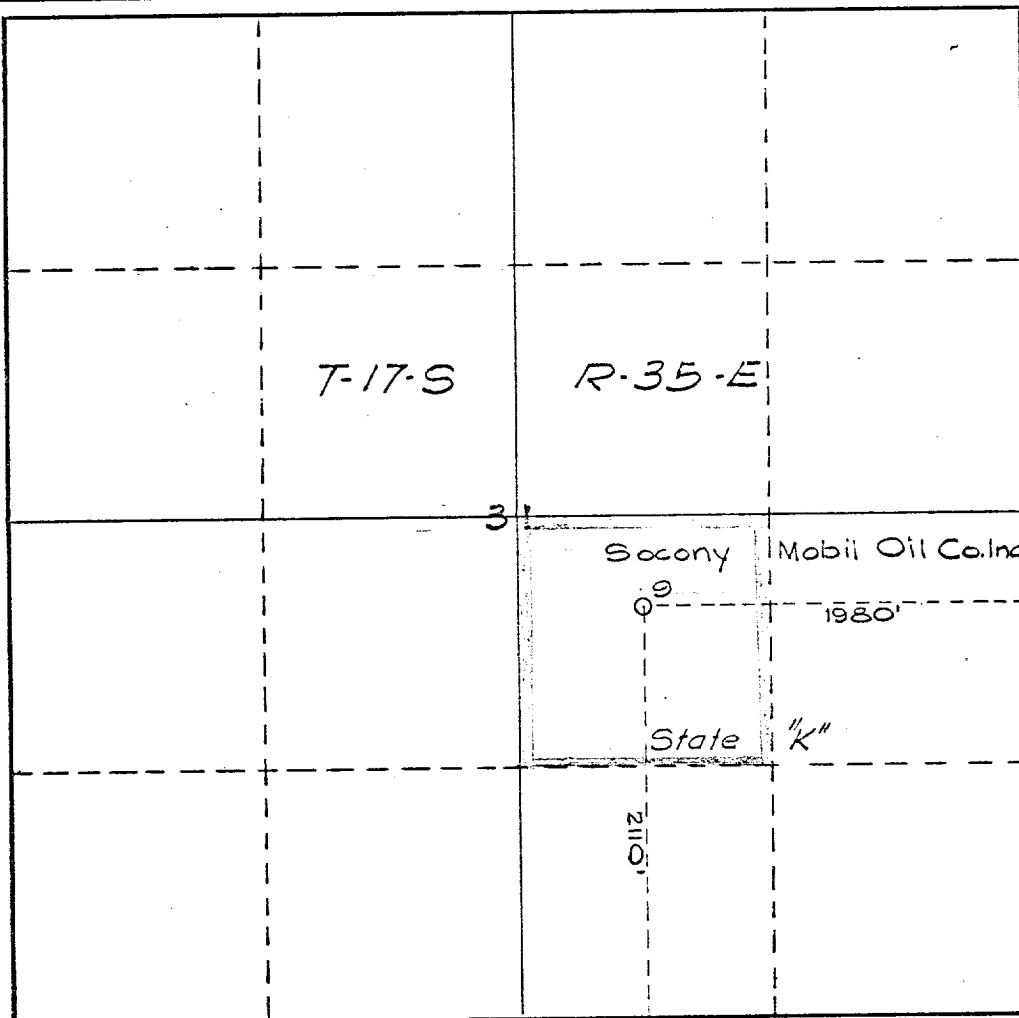

CERTIFICATION

I hereby certify that the information contained herein is true and complete to the best of my knowledge and belief.

Name
J. J. McDaniel
Position
Group Supervisor
Company
Socony Mobil Oil Company, Inc.
Date
February 12, 1965

I hereby certify that the well location shown on this plat was plotted from field notes of actual surveys made by me or under my supervision, and that the same is true and correct to the best of my knowledge and belief.

Date Surveyed
February 10, 1965
Registered Professional Engineer and/or Land Surveyor
No. 3572
Certificate No. SEEREX
3572

