

N

EXICO OIL CONSERVATION COMMISSION

Form C-101
Revised 1-1-65

NO. OF COPIES RECEIVED	
DISTRIBUTION	
SANTA FE	
FILE	
U.S.G.S.	
LAND OFFICE	
OPERATOR	

5A. Indicate Type of Lease STATE <input checked="" type="checkbox"/> FEE <input type="checkbox"/>
5. State Oil & Gas Lease No. B-1845

APPLICATION FOR PERMIT TO DRILL, DEEPEN, OR PLUG BACK

1a. Type of Work DRILL <input checked="" type="checkbox"/> DEEPEN <input type="checkbox"/> PLUG BACK <input type="checkbox"/>		7. Unit Agreement Name	
b. Type of Well OIL WELL <input checked="" type="checkbox"/> GAS WELL <input type="checkbox"/> OTHER <input type="checkbox"/> SINGLE ZONE <input type="checkbox"/> MULTIPLE ZONE <input type="checkbox"/>		8. Farm or Lease Name State 6-34	
2. Name of Operator Standard Oil Company of Texas A Division of California Oil Company		9. Well No. 11	
3. Address of Operator 3610 Avenue S - Snyder, Texas		10. Field and Pool, or Wildcat Vacuum (Glorieta)	
4. Location of Well UNIT LETTER L LOCATED 2310' FEET FROM THE South LINE AND 330 FEET FROM THE West LINE OF SEC. 34 TWP. 17S RGE. 35E NMPM		12. County Lea	
19. Proposed Depth 6300'		19A. Formation Glorieta	
20. Rotary or C.T. Rotary		21. Elevations (Show whether DF, RT, etc.) GL 3922'	
21A. Kind & Status Plug. Bond Blanket		21B. Drilling Contractor Unknown	
22. Approx. Date Work will start 5-2-65		23.	

PROPOSED CASING AND CEMENT PROGRAM

SIZE OF HOLE	SIZE OF CASING	WEIGHT PER FOOT	SETTING DEPTH	SACKS OF CEMENT	EST. TOP
11	8-5/8	20	1650'	1200	Circ to surface
7-7/8	4-1/2	9.5	6300'	500	2000

1. Move in and rig up rotary rig.
2. Drill 11" hole to 1650' and land 8-5/8" casing at 1650' and circulate cement to surface: After WOC 18 hours nipple up double preventor (Series 900) and pressure test casing and preventor to 700 psi for 30 minutes. If pressure less than 50 psi proceed. Drill surface to 1650' with fresh water.
3. Drill ahead in 7-7/8" hole to total depth 6300' using brine. Run 4 1/2" casing to 6300' and cement with 500 sxs. Formations will be evaluated by coring and electric logs.
4. Completion will be as follows: Set 4 1/2" casing through Glorieta, perforate and treat if required.

IN ABOVE SPACE DESCRIBE PROPOSED PROGRAM: IF PROPOSAL IS TO DEEPEN OR PLUG BACK, GIVE DATA ON PRESENT PRODUCTIVE ZONE AND PROPOSED NEW PRODUCTIVE ZONE. GIVE BLOWOUT PREVENTER PROGRAM, IF ANY.

hereby certify that the information above is true and complete to the best of my knowledge and belief.

Signed R. E. Rigby Title Lead Drilling Engineer Date April 28, 1965
(This space for State Use)

APPROVED BY _____ TITLE _____ DATE _____
CONDITIONS OF APPROVAL, IF ANY:

NEW MEXICO OIL CONSERVATION COMMISSION

WELL LOCATION AND ACREAGE DEDICATION PLAT

 FORM C-128
 Revised 5/1/57

SEE INSTRUCTIONS FOR COMPLETING THIS FORM ON THE REVERSE SIDE

SECTION A

Operator Standard Oil Company of Texas A Division of California Oil Co.			Lease State 6-34		Well No. 11
Unit Letter L	Section 34	Township T-17S	Range R-35E	County Lea	
Actual Footage Location of Well: 2310' feet from the South line and 330 feet from the West line					
Ground Level Elev. 3922'	Producing Formation Glorieta		Pool Vacuum (Glorieta)		Dedicated Acreage: 40 Acres

1. Is the Operator the only owner in the dedicated acreage outlined on the plat below? YES _____ NO _____. ("Owner" means the person who has the right to drill into and to produce from any pool and to appropriate the production either for himself or for himself and another. (65-3-29 (e) NMSA 1935 Comp.)
2. If the answer to question one is "no," have the interests of all the owners been consolidated by communitization agreement or otherwise? YES _____ NO _____. If answer is "yes," Type of Consolidation _____
3. If the answer to question two is "no," list all the owners and their respective interests below:

Owner	Land Description

SECTION B

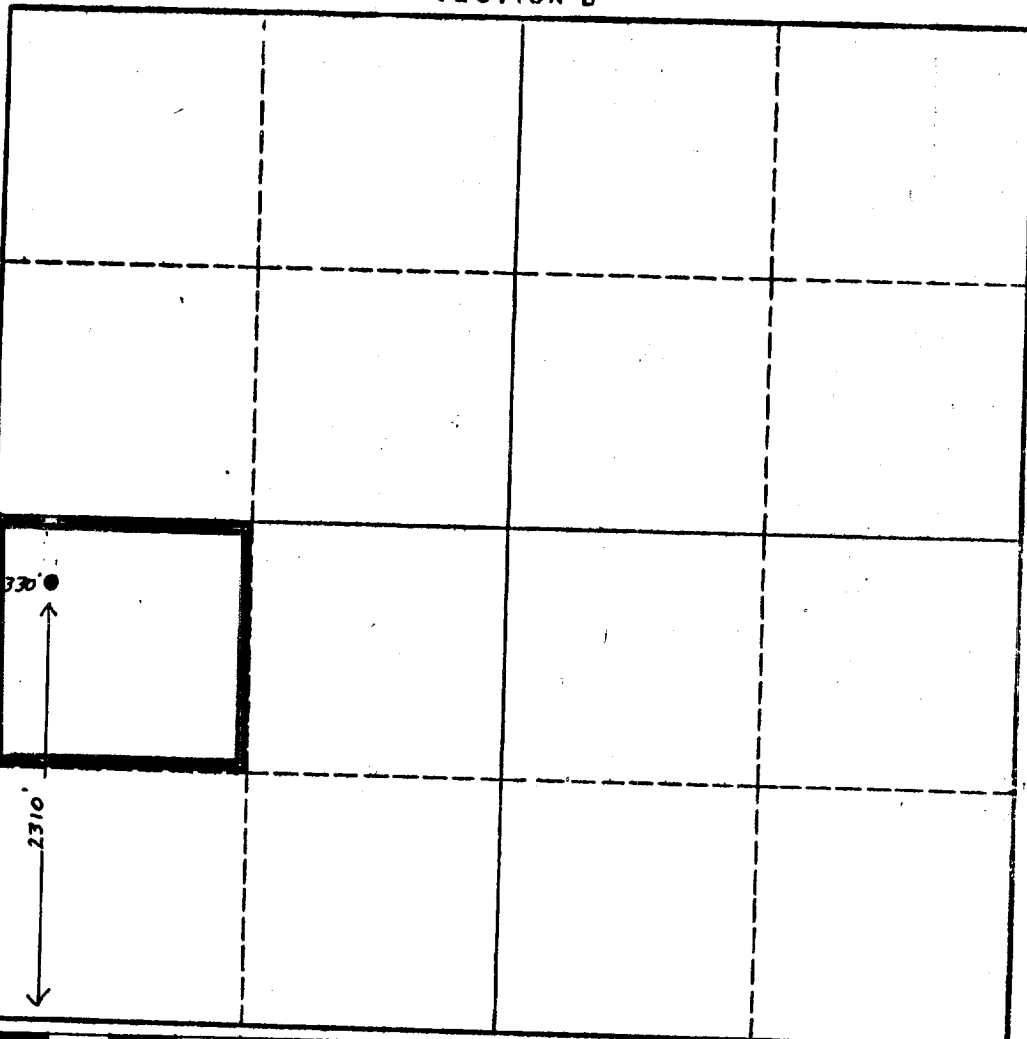

CERTIFICATION

I hereby certify that the information in SECTION A above is true and complete to the best of my knowledge and belief.

Name
R. E. Rigsby *R. E. Rigsby*
 Position
Lead Drilling Engineer
Standard Oil Co. of Texas
A Div. of Calif. Oil Co.
 Date
April 28, 1965

I hereby certify that the well location shown on the plat in SECTION B was plotted from field notes of actual surveys made by me or under my supervision, and that the same is true and correct to the best of my knowledge and belief.

Date Surveyed
April 12, 1965
 Registered Professional Engineer
 and/or Land Surveyor
James W. Daniel
 Certificate No. _____

0 330 660 990 1320 1650 1980 2310 2640 2000 1500 1000 500 0