

UNITED STATES
DEPARTMENT OF THE INTERIOR
GEOLOGICAL SURVEY

OFFICE OF O. C. G.

APPLICATION FOR PERMIT TO DRILL, DEEPEN OR PLUG BACK

5. LEASE DESIGNATION AND SERIAL NO.

N.M. 052

6. IF INDIAN, ALLOTTEE OR TRIBE NAME

7. UNIT AGREEMENT NAME

Mescalero Ridge

8. FARM OR LEASE NAME

Mescalero Ridge Unit 3

9. WELL NO.

14

10. FIELD AND POOL, OR WILDCAT

Pearl Queen

11. SEC., T., R., M., OR BLK.
AND SURVEY OR AREA

Sec. 35 - 19S - 34E

12. COUNTY OR PARISH

Lea

13. STATE

N. Mex.

1a. TYPE OF WORK

DRILL ☒DEEPEN ☐PLUG BACK ☐

b. TYPE OF WELL

OIL
WELL ☒GAS
WELL ☐

OTHER

SINGLE
ZONE ☒MULTIPLE
ZONE ☐

2. NAME OF OPERATOR

Ernest A. Hanson

3. ADDRESS OF OPERATOR

P. O. Box 1515, Roswell, New Mexico

4. LOCATION OF WELL (Report location clearly and in accordance with any State requirements.)*

At surface

660' FNL & 990' FWL

At proposed prod. zone

Sec. 35, T. 19 S., R. 34 E., NMPM
Lea County, New Mexico

14. DISTANCE IN MILES AND DIRECTION FROM NEAREST TOWN OR POST OFFICE*

25 miles west of Hobbs, New Mexico

16. DISTANCE FROM PROPOSED*

LOCATION TO NEAREST

PROPERTY OR LEASE LINE, FT.

(Also to nearest drlg. unit line, if any)

660'

16. NO. OF ACRES IN LEASE

640

17. NO. OF ACRES ASSIGNED
TO THIS WELL

40

18. DISTANCE FROM PROPOSED LOCATION*
TO NEAREST WELL, DRILLING, COMPLETED,
OR APPLIED FOR, ON THIS LEASE, FT.

990'

19. PROPOSED DEPTH

5200'

20. ROTARY OR CABLE TOOLS

Rotary

21. ELEVATIONS (Show whether DF, RT, GR, etc.)

22. APPROX. DATE WORK WILL START*

Dec. 5, 1965

23.

PROPOSED CASING AND CEMENTING PROGRAM

SIZE OF HOLE	SIZE OF CASING	WEIGHT PER FOOT	SETTING DEPTH	QUANTITY OF CEMENT
12-1/2"	8-5/8"	24#	200'	Circulate to surface
7-7/8"	5-1/2"	15-1/2#	5200'	250 sx.

It is proposed that the captioned well be drilled with rotary to a total depth of 5200 feet in the Queen Formation and that if commercial oil or gas is encountered that the proposed casing program be followed and that the well be perforated and fractured with lease oil.

IN ABOVE SPACE DESCRIBE PROPOSED PROGRAM: If proposal is to deepen or plug back, give data on present productive zone and proposed new productive zone. If proposal is to drill or deepen directionally, give pertinent data on subsurface locations and measured and true vertical depths. Give blowout preventer program, if any.

24.

SIGNED

TITLE

Geologist

DATE

Nov. 24, 1965

(This space for Federal or State office use)

PERMIT NO.

APPROVAL DATE

APPROVED BY

TITLE

CONDITIONS OF APPROVAL, IF ANY:

*See Instructions On Reverse Side

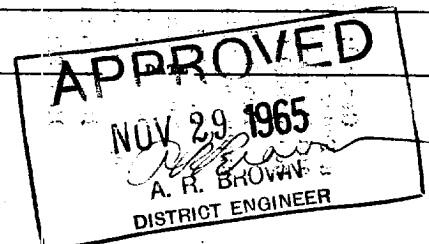

NEW MEXICO OIL CONSERVATION COMMISSION
WELL LOCATION AND ACREAGE DEDICATION PLAT

Form C-102
Supersedes C-128
Effective 1-1-65

All distances must be from the outer boundary of the Section. **NOV 30 11 12 AM '65**

Operator ERNEST A. HANSON		Lease MESCALERO RIDGE UNIT 35		Well No. 14
Unit Letter D	Section 35	Township 19 SOUTH	Range 34 EAST	County LEA
Actual Footage Location of Well: 660 feet from the NORTH line and 990 feet from the WEST line				
Ground Level Elev.	Producing Formation Queen Formation	Pool Pearl Queen	Dedicated Acreage: 40 Acres	

1. Outline the acreage dedicated to the subject well by colored pencil or hatchure marks on the plat below.
2. If more than one lease is dedicated to the well, outline each and identify the ownership thereof (both as to working interest and royalty).
3. If more than one lease of different ownership is dedicated to the well, have the interests of all owners been consolidated by communitization, unitization, force-pooling, etc?

☐ Yes ☐ No If answer is "yes," type of consolidation _____

If answer is "no," list the owners and tract descriptions which have actually been consolidated. (Use reverse side of this form if necessary.) _____

No allowable will be assigned to the well until all interests have been consolidated (by communitization, unitization, forced-pooling, or otherwise) or until a non-standard unit, eliminating such interests, has been approved by the Commission.

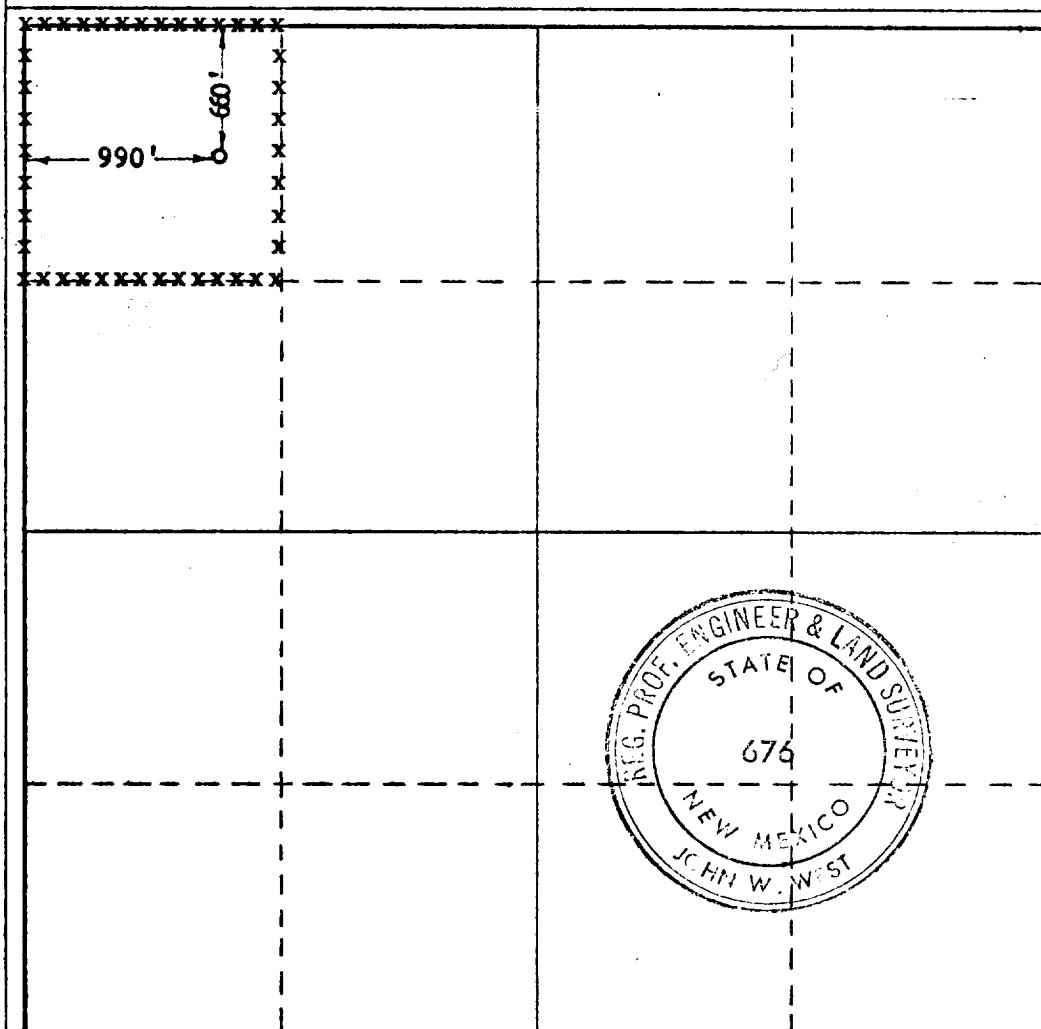

CERTIFICATION

I hereby certify that the information contained herein is true and complete to the best of my knowledge and belief.

Name *Ernest A. Hanson*
Position Geologist
Company Ernest A. Hanson
Date Nov. 26, 1965

I hereby certify that the well location shown on this plat was plotted from field notes of actual surveys made by me or under my supervision, and that the same is true and correct to the best of my knowledge and belief.

Date Surveyed 11-26-65
Registered Professional Engineer and/or Land Surveyor

John W. West
Certificate No. NM PE & LS No. 676

