

NO. OF COPIES RECEIVED	
DISTRIBUTION	
SANTA FE	
FILE	
U.S.G.S.	
LAND OFFICE	
OPERATOR	

NEW MEXICO OIL CONSERVATION COMMISSION

Form C-101
Revised 1-1-65

5A. Indicate Type of Lease	
STATE <input checked="" type="checkbox"/>	FEE <input type="checkbox"/>
5. State Oil & Gas Lease No.	
B-1404	
7. Unit Agreement Name	
-	
8. Farm or Lease Name	
State C	
9. Well No.	
2	
10. Field and Pool, or Wildcat	
UNDERSIGNED Penn.	
12. County	
Lea	
19. Proposed Depth	19A. Formation
10,300	Pennsylvanian
20. Rotary or C.T.	
Rotary	
21. Elevations (Show whether DF, RT, etc.)	21A. Kind & Status Plug. Bond
Not available	Blanket
21B. Drilling Contractor	22. Approx. Date Work will start
Undetermined	January 6, 1968

APPLICATION FOR PERMIT TO DRILL, DEEPEN, OR PLUG BACK	
1a. Type of Work	
b. Type of Well DRILL <input checked="" type="checkbox"/> DEEPEN <input type="checkbox"/> PLUG BACK <input type="checkbox"/>	
OIL WELL <input checked="" type="checkbox"/> GAS WELL <input type="checkbox"/> OTHER <input type="checkbox"/> SINGLE ZONE <input type="checkbox"/> MULTIPLE ZONE <input checked="" type="checkbox"/>	
2. Name of Operator	
Shell Oil Company (Western Division)	
3. Address of Operator	
P. O. Box 1509, Midland, Texas 79701	
4. Location of Well	
UNIT LETTER P	LOCATED 795 FEET FROM THE south LINE
AND 795 FEET FROM THE east LINE OF SEC. 24 TWP. 17-S RGE. 34-E NMPM	
19. Proposed Depth	
10,300	
19A. Formation	
Pennsylvanian	
20. Rotary or C.T.	
Rotary	
21. Elevations (Show whether DF, RT, etc.)	
Not available	
21A. Kind & Status Plug. Bond	
Blanket	
21B. Drilling Contractor	
Undetermined	
22. Approx. Date Work will start	
January 6, 1968	

23.

PROPOSED CASING AND CEMENT PROGRAM

SIZE OF HOLE	SIZE OF CASING	WEIGHT PER FOOT	SETTING DEPTH	SACKS OF CEMENT	EST. TOP
17 1/2"	13 3/8"	48#	350'	--	Circ.
12 1/4"	9 5/8"	36#	5000'	--	Circ.
	7"	23#, 26#	10300'	--	TOC 5000'

Proposed Vacuum Upper Penn and Vacuum, North Abo Dual.

IN ABOVE SPACE DESCRIBE PROPOSED PROGRAM: IF PROPOSAL IS TO DEEPEN OR PLUG BACK, GIVE DATA ON PRESENT PRODUCTIVE ZONE AND PROPOSED NEW PRODUCTIVE ZONE. GIVE BLOWOUT PREVENTER PROGRAM, IF ANY.

I hereby certify that the information above is true and complete to the best of my knowledge and belief.

Signed J. D. Duren Title Staff Petrophysical Engineer Date December 28, 1967
(This space for State Use)

APPROVED BY _____ TITLE _____ DATE _____

CONDITIONS OF APPROVAL, IF ANY:

**NEW MICO OIL CONSERVATION COMMISSION
WELL LOCATION AND ACREAGE DEDICATION PLAT**

Form C-102
Supersedes C-128
Effective 1-1-65

All distances must be from the outer boundaries of the Section.

Operator Shell Oil Company (Western Division)			Lease State C		Well No. 2
Unit Letter P	Section 24	Township 17-S	Range 34-E	County Lea	
Actual Footage Location of Well: 795 feet from the south line and 795 feet from the east line					
Ground Level Elev. Not available	Producing Formation Pennsylvanian		Pool Vacuum (Upper Penn)		Dedicated Acreage: 80 Acres

1. Outline the acreage dedicated to the subject well by colored pencil or hachure marks on the plat below.
2. If more than one lease is dedicated to the well, outline each and identify the ownership thereof (both as to working interest and royalty).
3. If more than one lease of different ownership is dedicated to the well, have the interests of all owners been consolidated by communitization, unitization, force-pooling, etc?

☐ Yes ☐ No If answer is "yes," type of consolidation _____

If answer is "no," list the owners and tract descriptions which have actually been consolidated. (Use reverse side of this form if necessary.) _____

No allowable will be assigned to the well until all interests have been consolidated (by communitization, unitization, forced-pooling, or otherwise) or until a non-standard unit, eliminating such interests, has been approved by the Commission.

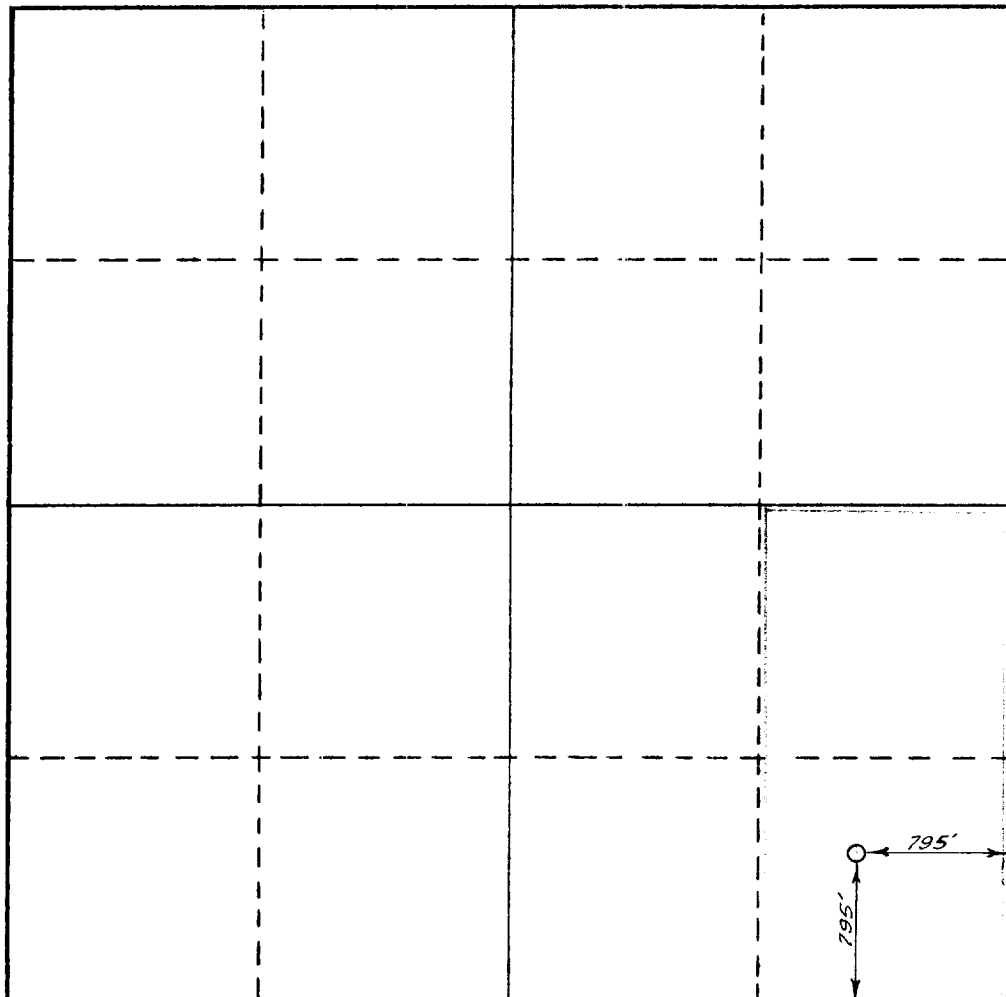

CERTIFICATION

I hereby certify that the information contained herein is true and complete to the best of my knowledge and belief.

Name J. D. Duren
 Position Staff Petrophysical Engineer
 Company Shell Oil Company
 Date January 2, 1968

I hereby certify that the well location shown on this plat was plotted from field notes of actual surveys made by me or under my supervision, and that the same is true and correct to the best of my knowledge and belief.

Date Surveyed December 24, 1967
T. J. Chapman, Jr., Chief Surveyor
Shell Oil Company
T. J. Chapman, Jr.

0 330 660 990 1320 1650 1980 2310 2640 2000 1500 1000 500 0

Opinion Profile 12-23-88

ELF