

NO. OF COPIES RECEIVED	
DISTRIBUTION	
SANTA FE	
FILE	
U.S.G.S.	
LAND OFFICE	
OPERATOR	

# NEW MEXICO OIL CONSERVATION COMMISSION

Form C-101  
Revised 1-1-65

4. Indicate Type of Lease  
STATE ☒ FEE ☐

5. State Oil & Gas Lease No.  
8 - 1106

## APPLICATION FOR PERMIT TO DRILL, DEEPEN, OR PLUG BACK

1a. Type of Work DRILL <input checked="" type="checkbox"/> DEEPEN <input type="checkbox"/> PLUG BACK <input type="checkbox"/>		7. Unit Agreement Name
b. Type of Well OIL WELL <input checked="" type="checkbox"/> GAS WELL <input type="checkbox"/> OTHER <input type="checkbox"/> SINGLE ZONE <input checked="" type="checkbox"/> MULTIPLE ZONE <input type="checkbox"/>		8. Farm or Lease Name Mobil "24" State
2. Name of Operator Pennzoil United, Inc.		9. Well No. 1
3. Address of Operator P. O. Drawer 1828 - Midland, Texas 79701		10. Field and Pool, or Wildcat Vacuum (Abo)
4. Location of Well UNIT LETTER H LOCATED 2121 FEET FROM THE North LINE AND 301 FEET FROM THE East LINE OF SEC. 24 TWP. 17-S RGE. 34-E NMPM		12. County Lea
19. Proposed Depth 9,000		19A. Formation Abo
20. Rotary or C.T. Rotary		
21. Elevations (Show whether DF, RT, etc.) 4014 GL	21A. Kind & Status Plug. Bond Blanket	22. Approx. Date Work will start On approval

## PROPOSED CASING AND CEMENT PROGRAM

SIZE OF HOLE	SIZE OF CASING	WEIGHT PER FOOT	SETTING DEPTH	SACKS OF CEMENT	EST. TOP
17 1/2	13 3/8	48#	400	500	Circulate
11	8 5/8	24# & 32#	4000	700	2000
7 7/8	4 1/2	11.5# & 10.5#	9000	300	7500 *

\* A DV tool will be run at the base of the San Andres and cement will cover the zone from that point up into the intermediate casing

IN ABOVE SPACE DESCRIBE PROPOSED PROGRAM: IF PROPOSAL IS TO DEEPEN OR PLUG BACK, GIVE DATA ON PRESENT PRODUCTIVE ZONE AND PROPOSED NEW PRODUCTIVE ZONE. GIVE BLOWOUT PREVENTER PROGRAM, IF ANY.

I hereby certify that the information above is true and complete to the best of my knowledge and belief.

Signed W. P. L. L. L. Title Drilling Superintendent Date 9-10-68

(This space for State Use)

APPROVED BY [Signature] TITLE SECRETARY DATE 9-10-68

CONDITIONS OF APPROVAL, IF ANY:

**NEW MEXICO OIL CONSERVATION COMMISSION**  
**WELL LOCATION AND ACREAGE DEDICATION PLAT**

Form C-102  
 Supersedes C-128  
 Effective 1-1-65

All distances must be from the outer boundaries of the Section

PENNZOIL UNITED INC.			Lease		MOBILE 24 STATE 168		Well No. 1
Section	Township	Range	County				
H	24	17 SOUTH	34 EAST	LEA			
A. Location of the Location of Well: 2121 feet from the NORTH line and 801 feet from the EAST line							
Surface Elev.	Producing Formation	Pool	Dedicated Acreage				
4014.1	Abo	9) Vacuum (Abo)	E/2 NE/4	80	Acres		

1. Outline the acreage dedicated to the subject well by colored pencil or hachure marks on the plat below.
2. If more than one lease is dedicated to the well, outline each and identify the ownership thereof (both as to working interest and royalty).
3. If more than one lease of different ownership is dedicated to the well, have the interests of all owners been consolidated by communitization, unitization, force-pooling, etc?  
☒ Yes    ☐ No    If answer is "yes," type of consolidation Communitize Pennzoil's #E-5765 (NE/4 NE/4)

If answer is "no," list the owners and tract descriptions which have actually been consolidated. (Use reverse side of this form if necessary.) \_\_\_\_\_

No allowable will be assigned to the well until all interests have been consolidated (by communitization, unitization, forced-pooling, or otherwise) or until a non-standard unit, eliminating such interests, has been approved by the Commission.

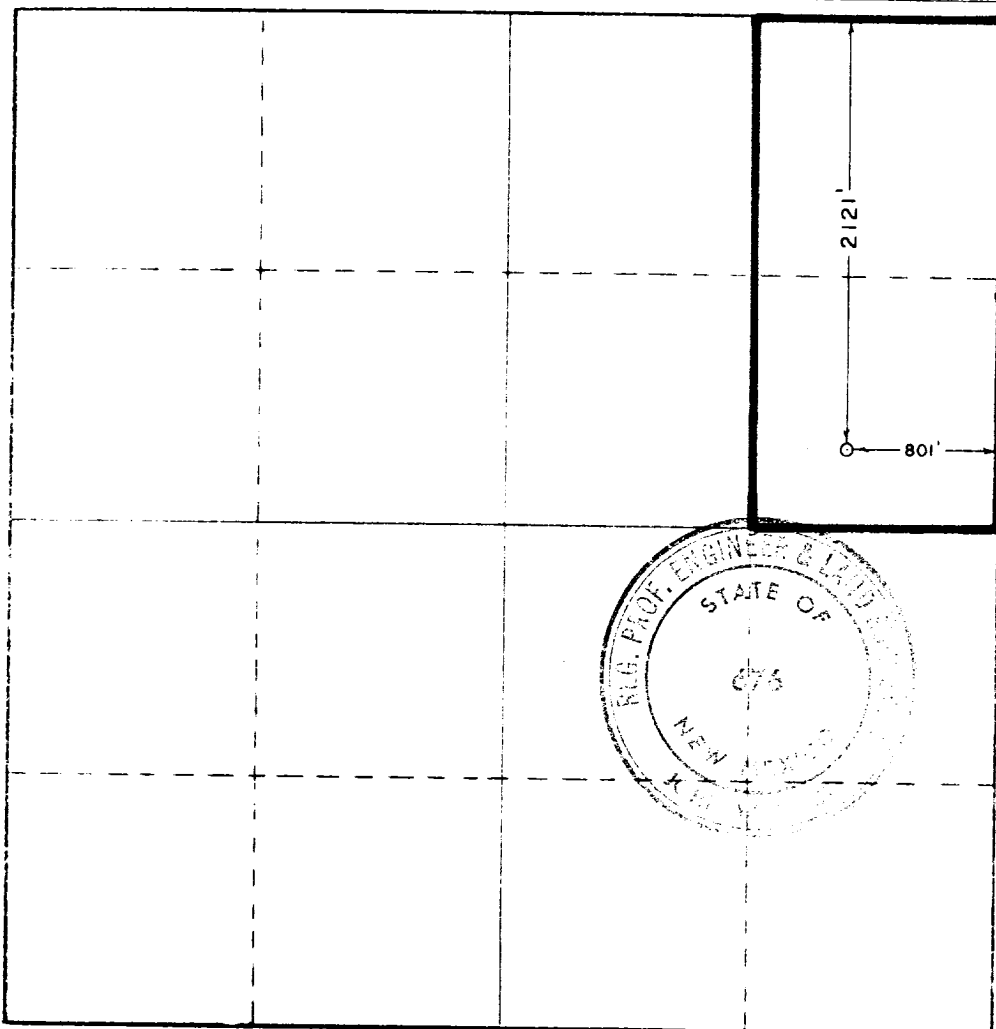

**CERTIFICATION**

I hereby certify that the information contained herein is true and complete to the best of my knowledge and belief.

*[Signature]*  
 \_\_\_\_\_

**Drilling Superintendent**

Company  
**Pennzoil United, Inc.**

Date  
**September 16, 1968**

I hereby certify that the well location shown on this plat was plotted from field notes of actual surveys made by me or under my supervision, and that the same is true and correct to the best of my knowledge and belief.

Date Surveyed  
**SEPTEMBER 12, 1968**

Registered Professional Engineer  
 and/or Land Surveyor

*[Signature]*  
 \_\_\_\_\_

Certificate No. **676**

