

NO. OF COPIES RECEIVED	
DISTRIBUTION	
SANTA FE	
FILE	
U.S.G.S.	
LAND OFFICE	
OPERATOR	

# NEW MEXICO OIL CONSERVATION COMMISSION

Form C-101  
Revised 1-1-65

5A. Indicate Type of Lease	
STATE <input checked="" type="checkbox"/>	FEE <input type="checkbox"/>
5. State Oil & Gas Lease No.	
B-1520	

## APPLICATION FOR PERMIT TO DRILL, DEEPEN, OR PLUG BACK

1a. Type of Work		7. Unit Agreement Name	
b. Type of Well OIL WELL <input type="checkbox"/> GAS WELL <input type="checkbox"/> OTHER <input checked="" type="checkbox"/> Injection		North Vacuum Abo Unit	
2. Name of Operator Mobil Oil Corporation		8. Farm or Lease Name	
3. Address of Operator P. O. Box 633, Midland, Texas 79701		9. Well No. 130	
4. Location of Well UNIT LETTER H LOCATED 1980 FEET FROM THE North LINE AND 660 FEET FROM THE East LINE OF SEC. 15 TWP. 17-S RGE. 34-E NMPM		10. Field and Pool, or Wildcat North Vacuum Abo	
12. County Lea			
19. Proposed Depth 8750'		19A. Formation Abo	
20. Rotary or C.T. Rotary			
21. Elevations (Show whether DF, KT, etc.) 4052.9 Ground		21A. Kind & Status Plug. Bond On File	
21B. Drilling Contractor -		22. Approx. Date Work will start 11-26-73	

## PROPOSED CASING AND CEMENT PROGRAM

SIZE OF HOLE	SIZE OF CASING	WEIGHT PER FOOT	SETTING DEPTH	SACKS OF CEMENT	EST. TOP

This well is presently completed as a gas well in the North Vacuum (Morrow) Pool and known as Mobil's Bridges-State #130. Permission is requested to plug and abandon the Morrow, plug back and complete as an injection well in the Abo formation. Application to use this well for injection purposes is being filed through the Commission's Santa Fe office.

APPROVED BY  
FILED IN DAYS WITHOUT  
SUSPENDING COMMENCED,  
EXPIRES 2-26-74

IN ABOVE SPACE DESCRIBE PROPOSED PROGRAM: IF PROPOSAL IS TO DEEPEN OR PLUG BACK, GIVE DATA ON PRESENT PRODUCTIVE ZONE AND PROPOSED NEW PRODUCTIVE ZONE. GIVE BLOWOUT PREVENTER PROGRAM, IF ANY.

I hereby certify that the information above is true and complete to the best of my knowledge and belief.

Signed A. D. Bond A. D. Bond Title Proration Staff Assistant Date November 20, 1973

(This space for State Use)

APPROVED BY [Signature] TITLE  DATE

CONDITIONS OF APPROVAL, IF ANY:

**NEW XICO OIL CONSERVATION COMMISSION  
WELL LOCATION AND ACREAGE DEDICATION PLAT**

Form C-102  
Supersedes C-128  
Effective 1-1-65

All distances must be from the outer boundaries of the Section.

Operator <b>Mobil Oil Corporation</b>			Lease <b>North Vacuum Abo Unit</b>		Well No. <b>130</b>
Unit Letter <b>H</b>	Section <b>15</b>	Township <b>17-S</b>	Range <b>34-E</b>	County <b>Lea</b>	
Actual Footage Location of Well: <b>1980'</b> feet from the <b>North</b> line and <b>660'</b> feet from the <b>East</b> line					
Ground Level Elev. <b>4052.9</b>	Producing Formation <b>Abo</b>		Pool <b>North Vacuum</b>		Dedicated Acreage: <b>80</b> Acres

1. Outline the acreage dedicated to the subject well by colored pencil or hachure marks on the plat below.
2. If more than one lease is dedicated to the well, outline each and identify the ownership thereof (both as to working interest and royalty).
3. If more than one lease of different ownership is dedicated to the well, have the interests of all owners been consolidated by communitization, unitization, force-pooling, etc?

☐ Yes   ☐ No   If answer is "yes," type of consolidation \_\_\_\_\_

If answer is "no," list the owners and tract descriptions which have actually been consolidated. (Use reverse side of this form if necessary.) \_\_\_\_\_

No allowable will be assigned to the well until all interests have been consolidated (by communitization, unitization, forced-pooling, or otherwise) or until a non-standard unit, eliminating such interests, has been approved by the Commission.

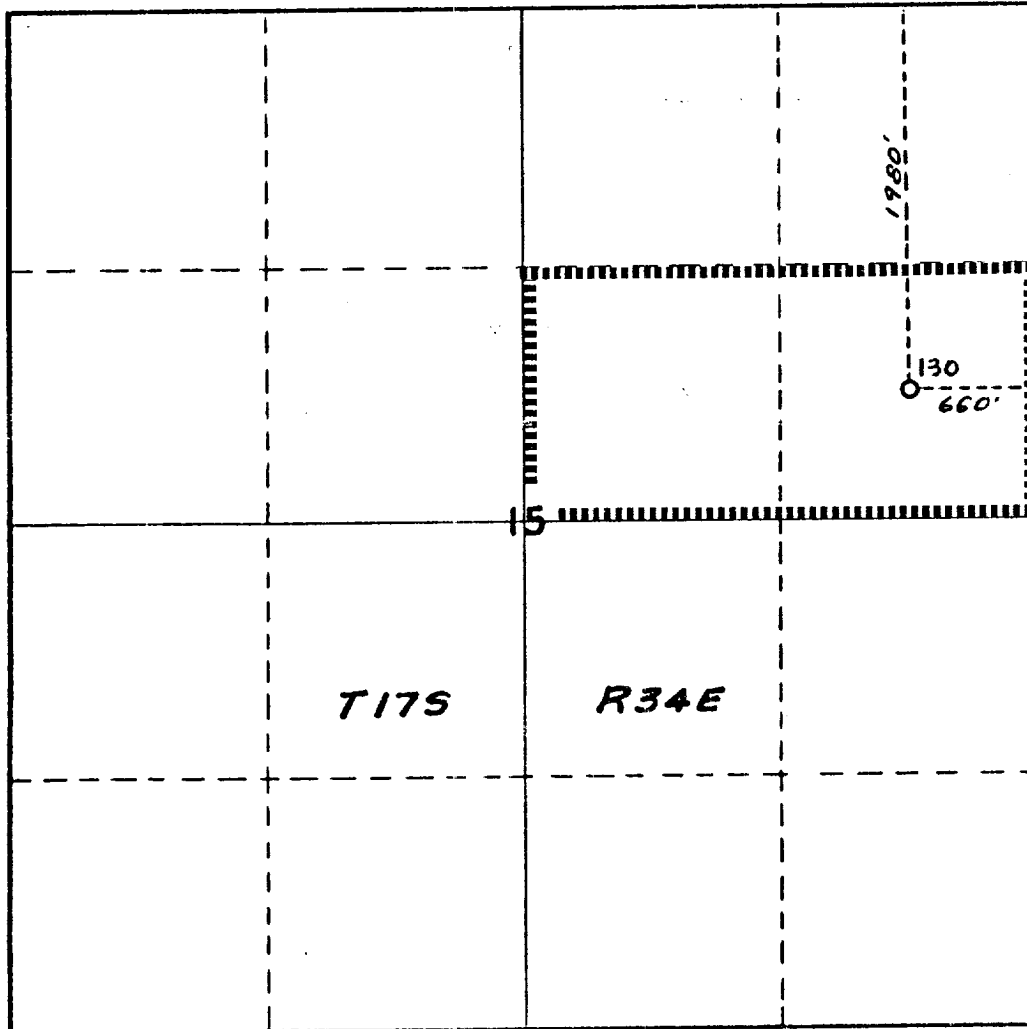

**CERTIFICATION**

I hereby certify that the information contained herein is true and complete to the best of my knowledge and belief.

*A. D. Bond*

Name  
**A. D. Bond**

Position  
**Proration Staff Assistant**

Company  
**Mobil Oil Corporation**

Date  
**November 20, 1973**

I hereby certify that the well location shown on this plat was plotted from field notes of actual surveys made by me or under my supervision, and that the same is true and correct to the best of my knowledge and belief.

Date Surveyed

Registered Professional Engineer and/or Land Surveyor

Certificate No.

