

COUNTY	LEA	FIELD	Wildcat	STATE	NM 30-025-23
OPR	PUBCO PET. CORP.			MAP	
1 Shipp					
Sec 11, T-17-S, R-37-E					
2310' FSL, 2030' FWL of Sec					
Spd 10-22-70					
CLASS					
EL 3763E					
Cmp 11-21-70		FORMATION	DATUM	FORMATION	DATUM
CSG & SX - TUBING					
13 3/8" at 432' w/500 sx					
9 5/8" at 4767' w/1100 sx					
LOGS EL GR RA IND HC A					
		TD 9162'			
PLUGGED & ABANDONED					

Distribution limited and publication prohibited by subscribers' agreement.
Reproduction rights reserved by Williams & Lee Scouting Service, Inc.

CONT.	McVay	PROP DEPTH	9300'	TYPE	RT
DATE					

F.R. 9-29-70; Opr's Elev. 3749' GL, 3766' KB
PD 9300' RT (Yeso)
Contractor - McVay
10-26-70 Drlg. 3645'
11-3-70 Drlg. 5790'; Tight
11-8-70 Drlg. 7148'; Tight
11-16-70 Drlg. 8998'; Tight
11-23-70 TD 9162'; P&A (Tight)
11-14-70 TD 9162'; P&A (Tight)
12-28-70 TD 9162'; PLUGGED & ABANDONED
DST 5290-5370', open 1 hr 30 mins, rec 90'
GMDP + 20' oil (Grav 29) + 170' HO&GCM
+ 170' oil, G& salt WCM + 85' G& salt WCM
+ 180' salt wtr, 1 hr ISIP 1899#, FP 88-334#.

LEA
PUBCO PET. CORP.

Wildcat
1 Shipp

Sec 11, T17S, R37E
Page #2

12-28-70

Continued

4 hr FSIP 1886#, HP 2585-2584#

DST 8880-9050', open 1 hr 45 mins, rec 150'

GIDP + 5' oil + 200' O&GCM, 1 hr ISIP

3204#, FP 139-201#, 3 hr FSIP 3224#, HP 4417-4417#

Well Drilled Tight

LOG TOPS: San Andres 5260', Glorieta 6902',

Yeso 7045', Tubb 8366', Yeso Bank 8890',

Third Bone Spring Sand 9068'

12-31-70

COMPLETION REPORTED

NEW MEXICO OIL CONSERVATION COMMISSION
WELL LOCATION AND ACREAGE DEDICATION PLAT

Form No. 1-100
Revised 1-100
May 14-65

All distances must be from the outer boundaries of the Section.

Harding Oil Company			Lease		Shipp		Well No. 1	
Section	Township	Range	County					
K	11	17 South	37 East		Lea			
Actual Well Location of Well:								
2310 feet from the south line and			2080 feet from the west line					
Ground Level Elev.	Producing Formation		Pool			Dedicated Acreage		
3749.0	Strawn		Humble City Strawn			80 Acres		

1. Outline the acreage dedicated to the subject well by colored pencil or hatchure marks on the plat below.
2. If more than one lease is dedicated to the well, outline each and identify the ownership thereof (both as to working interest and royalty).
3. If more than one lease of different ownership is dedicated to the well, have the interests of all owners been consolidated by communitization, unitization, force-pooling, etc?

☐ Yes ☐ No If answer is "yes," type of consolidation NA

If answer is "no," list the owners and tract descriptions which have actually been consolidated. (Use reverse side of this form if necessary.) NA

No allowable will be assigned to the well until all interests have been consolidated (by communitization, unitization, forced-pooling, or otherwise) or until a non-standard unit, eliminating such interests, has been approved by the Commission.

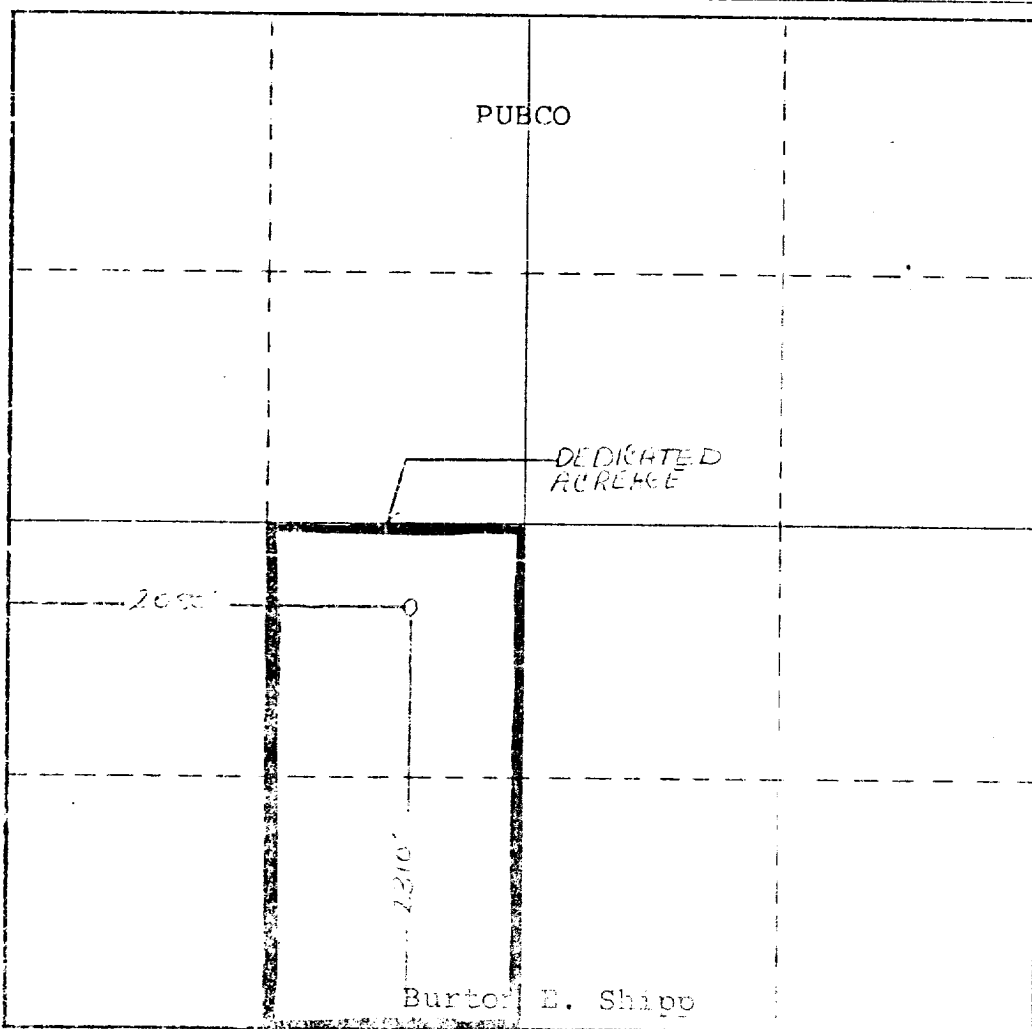

CERTIFICATION

I hereby certify that the information contained herein is true and complete to the best of my knowledge and belief.

Charles F. Harding
Name

Vice President

Position

Harding Oil Company

Company

7-19-72

Date

I hereby certify that the well location shown on this plat was plotted from field notes of actual surveys made by me or under my supervision, and that the same is true and correct to the best of my knowledge and belief.

Date Surveyed

Registered Professional Engineer
and/or Land Surveyor

Burton E. Shipp

RECEIVED

JUL 21 1972

OIL CONSERVATION COMM.
HOBBS, N. M.