

NO. OF COPIES RECEIVED	
DISTRIBUTION	
SANTA FE	
FILE	
U.S.G.S.	
LAND OFFICE	
OPERATOR	

NEW MEXICO OIL CONSERVATION COMMISSION

Form C-101
Revised 1-1-65

5A. Indicate Type of Lease	
STATE <input checked="" type="checkbox"/>	FEE <input type="checkbox"/>
5. State Oil & Gas Lease No.	
B-1497	

APPLICATION FOR PERMIT TO DRILL, DEEPEN, OR PLUG BACK

1a. Type of Work		7. Unit Agreement Name	
b. Type of Well OIL WELL <input checked="" type="checkbox"/> GAS WELL <input type="checkbox"/> OTHER <input type="checkbox"/>		8. Farm or Lease Name	
DRILL <input checked="" type="checkbox"/> DEEPEN <input type="checkbox"/> PLUG BACK <input type="checkbox"/>		Santa Fe	
2. Name of Operator		9. Well No.	
Phillips Petroleum Company		117	
3. Address of Operator		10. Field and Pool, or Wildcat	
Room B-2, Phillips Bldg., Odessa, Texas 79760		Vacuum Glorieta	
4. Location of Well		12. County	
UNIT LETTER N LOCATED 990 FEET FROM THE south LINE		Lea	
AND 1650 FEET FROM THE west LINE OF SEC. 27 TWP. 17-S RGE. 35-E NMPM			
		19. Proposed Depth	
		6200'	
		19A. Formation	
		Glorieta	
		20. Rotary or C.T.	
		Rotary	
21. Elevations (Show whether DE, RT, etc.)		21B. Drilling Contractor	
Later		Later	
21A. Kind & Status Plug. Bond		22. Approx. Date Work will start	
Blanket		Upon approval	

23.

PROPOSED CASING AND CEMENT PROGRAM

SIZE OF HOLE	SIZE OF CASING	WEIGHT PER FOOT	SETTING DEPTH	SACKS OF CEMENT	EST. TOP
12-1/4"	8-5/8"	24#	1660' (200sx	Incor SR w/20%DD, 1#Tufplug/sx)	Circ. to surface
			(250sx	Incor SR w/20%DD)	
			(200 sx	Incor SR w/2% CaCl2)	
7-7/8"	4-1/2"	(9.5#, 10.5#, 11.6#)	6200'	300sx Trinity LWN/20%DD)	-sufficient to cover all producing intervals.
				500sx Class H w/10% DD	
				200sx Class H neat	

Use Series 900 hydraulically operated blowout equipment.
This well will be in the same proration unit as well No. 80.

CASING.

IN ABOVE SPACE DESCRIBE PROPOSED PROGRAM: IF PROPOSAL IS TO DEEPEN OR PLUG BACK, GIVE DATA ON PRESENT PRODUCTIVE ZONE AND PROPOSED NEW PRODUCTIVE ZONE. GIVE BLOWOUT PREVENTER PROGRAM, IF ANY.

I hereby certify that the information above is true and complete to the best of my knowledge and belief.

Signed J.J. Mueller Title Associate Reservoir Engineer Date 2-4-71

(This space for Stamp Use)

APPROVED BY [Signature] TITLE SUPERVISOR DISTRICT DATE FEB 8 1971

CONDITIONS OF APPROVAL, IF ANY:

RECEIVED

FEB 10 1971

**OIL CONSERVATION COMM.
HOBBS, N. M.**

NEW MEXICO OIL CONSERVATION COMMISSION
WELL LOCATION AND ACREAGE DEDICATION PLAT

Form C-102
Supersedes C-128
Effective 1-1-65

All distances must be from the outer boundaries of the Section.

Operator Phillips Petroleum Company			Lease Santa Fe		Well No. 117
Unit Letter N	Section 27	Township 17-S	Range 35-E	County Lea	
Actual Footage Location of Well: 990 feet from the south line and 1650 feet from the west line					
Ground Level Elev. later	Producing Formation Glorieta		Pool Vacuum Glorieta	Dedicated Acreage: 40 Acres	

1. Outline the acreage dedicated to the subject well by colored pencil or hatchure marks on the plat below.
2. If more than one lease is dedicated to the well, outline each and identify the ownership thereof (both as to working interest and royalty).
3. If more than one lease of different ownership is dedicated to the well, have the interests of all owners been consolidated by communitization, unitization, force-pooling, etc?

☐ Yes ☐ No If answer is "yes," type of consolidation _____

If answer is "no," list the owners and tract descriptions which have actually been consolidated. (Use reverse side of this form if necessary.) _____

No allowable will be assigned to the well until all interests have been consolidated (by communitization, unitization, forced-pooling, or otherwise) or until a non-standard unit, eliminating such interests, has been approved by the Commission.

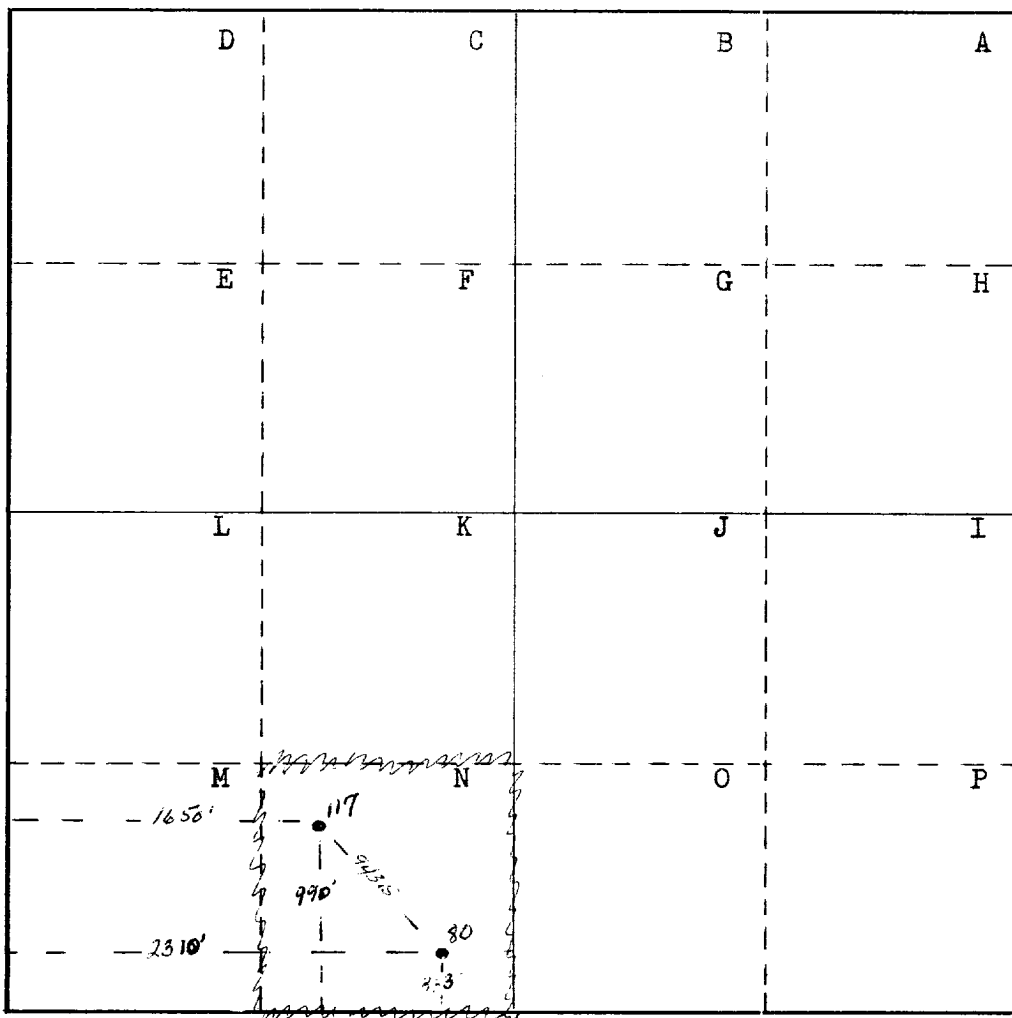

CERTIFICATION

I hereby certify that the information contained herein is true and complete to the best of my knowledge and belief.

Name *W. J. Mueller*
W. J. Mueller

Position
Associate Reservoir Engr.

Company
Phillips Petroleum Company

Date
February 4, 1971

I hereby certify that the well location shown on this plat was plotted from field notes of actual surveys made by me or under my supervision, and that the same is true and correct to the best of my knowledge and belief.

Date Surveyed
February 3, 1971

Registered Professional Engineer and/or Land Surveyor
Roger L. Leffler
Roger Leffler

Certificate No.
4357

RECEIVED

FEB 8 1971

OIL CONSERVATION COMMISSION
WASHINGTON, D. C.

FILE