

NO. OF COPIES RECEIVED	
DISTRIBUTION	
SANTA FE	
FILE	
U.S.G.S.	
LAND OFFICE	
OPERATOR	

NEW MEXICO OIL CONSERVATION COMMISSION

Form C-101
Revised 1-1-65
2 025-23013

5A. Indicate Type of Lease	
STATE <input type="checkbox"/>	FEE <input type="checkbox"/>
5. State Oil & Gas Lease No.	
B-161-2	
7. Unit Agreement Name	
8. Farm or Lease Name	
New Mexico "DJ" State	
10. Field and Pool, or Wildcat	
UNDESIGNATED	
12. County	
Lea	
19. Proposed Depth	19A. Formation
8800	Abo, North (Upper) Rotary
20. Rotary or C.T.	22. Approx. Date work will start
	At Once

APPLICATION FOR PERMIT TO DRILL, DEEPEN, OR PLUG BACK	
1a. Type of Work	
DRILL <input type="checkbox"/> DEEPEN <input type="checkbox"/> PLUG BACK <input type="checkbox"/>	
b. Type of Well	
OIL WELL <input checked="" type="checkbox"/> GAS WELL <input type="checkbox"/> OTHER <input type="checkbox"/>	
SINGLE ZONE <input type="checkbox"/> MULTIPLE ZONE <input type="checkbox"/>	
2. Name of Operator	
TEXACO, INC. & Darrell Smith	
3. Address of Operator	
P. O. Box 3109, Midland, Texas 79701	
4. Location of Well	
UNIT LETTER D LOCATED 660 FEET FROM THE North LINE	
AND 660 FEET FROM THE West LINE OF SEC. 18 TWP. 17-S RGE. 35-E NMPM	
11. Field and Pool, or Wildcat	
UNDESIGNATED	
12. County	
Lea	
19. Proposed Depth	
8800	
19A. Formation	
Abo, North (Upper) Rotary	
20. Rotary or C.T.	
21. Elevations (Show whether DF, RT, etc.)	
Gr. 4002, DF. 4012	
21A. Kind & Status Plug. Bond	
\$10,000 Blanket	
21B. Drilling Contractor	
Unknown	
22. Approx. Date work will start	
At Once	

SIZE OF HOLE	SIZE OF CASING	WEIGHT PER FOOT	SETTING DEPTH	SACKS OF CEMENT	EST. TOP
16	13 3/8	48	40'	* 20	250% to Circulate
11	8 5/8	24	1800'	**750	250% to Circulate
7 7/8	5 1/2	14,15,5,17	8800'	***900	150% to bring Cnt. top to 3500'

* 20 ~~ex~~ Redinix Cement (250% to circulate)
** 500 ~~ex~~ TLW + 4% Gal mixed at 11.9 PPG followed by 250 ~~ex~~ class C + 1% CaCl
14.8 ppg. (250% to circulate)
***600 ~~ex~~ TLW 12 ppg followed by 300 ~~ex~~ Class C + 10#/sk salt 16.8 ppg (150% to bring
cement top to 3500')

FORMATION TOPS EXPECTED

THE COMMISSION MUST BE NOTIFIED
24 HOURS PRIOR TO RUNNING
CASING.

San Andres 4700'
Glorieta 6075'
Abo Pay Marker 8570'
Abo Pay 8600'
Total Depth 8800'

APPROVAL VALID
FOR 90 DAYS UNLESS
DRILLING COMMENCED,
EXPIRES 12-10-71

IN ABOVE SPACE DESCRIBE PROPOSED PROGRAM: IF PROPOSAL IS TO DEEPEN OR PLUG BACK, GIVE DATA ON PRESENT PRODUCTIVE ZONE AND PROPOSED NEW PRODUCTIVE ZONE. GIVE BLOWOUT PREVENTER PROGRAM, IF ANY.

I hereby certify that the information above is true and complete to the best of my knowledge and belief.

Signed J. A. Valton Title Division Civil Engineer Date September 7, 1971

APPROVED BY [Signature] TITLE SUPERVISOR DISTRICT 1 DATE SEP 10 1971

CONDITIONS OF APPROVAL, IF ANY:

RECEIVED

SEP - 9 1971

OIL CONSERVATION COMM.
HOBBS, N. M.

NEW MEXICO OIL CONSERVATION COMMISSION
WELL LOCATION AND ACREAGE DEDICATION PLAT

Form C-102
Supersedes C-128
Effective 1-1-65

All distances must be from the outer boundaries of the Section.

Operator TEXACO Inc.		Lease New Mexico "DJ" State		Well No. 1
Unit Letter D	Section 18	Township 17-South	Range 35-East	County Lea
Actual Footage Location of Well: 660' feet from the North line and 660' feet from the West line Sec. 18				
Ground Level Elev. 4002'	Producing Formation Abo, North (Upper)	Pool Vacuum Abo, North	Dedicated Acreage: 77.62 Acres	

1. Outline the acreage dedicated to the subject well by colored pencil or hachure marks on the plat below.
2. If more than one lease is dedicated to the well, outline each and identify the ownership thereof (both as to working interest and royalty).
3. If more than one lease of different ownership is dedicated to the well, have the interests of all owners been consolidated by communitization, unitization, force-pooling, etc?
- ☐ Yes ☐ No If answer is "yes," type of consolidation _____

If answer is "no," list the owners and tract descriptions which have actually been consolidated. (Use reverse side of this form if necessary.) _____

No allowable will be assigned to the well until all interests have been consolidated (by communitization, unitization, forced-pooling, or otherwise) or until a non-standard unit, eliminating such interests, has been approved by the Commission.

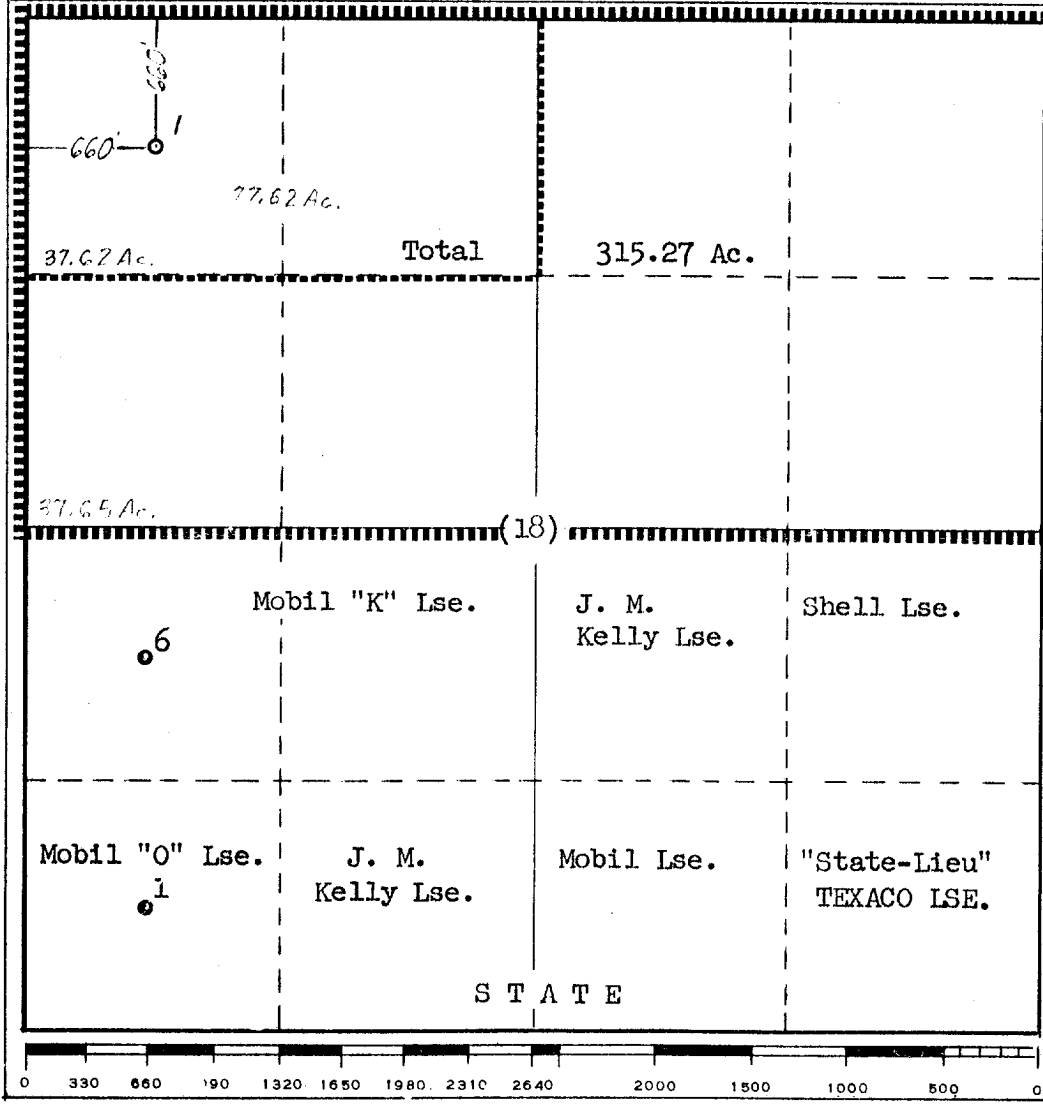

CERTIFICATION	
I hereby certify that the information contained herein is true and complete to the best of my knowledge and belief.	
Name	J. J. Velten
Position	Division Civil Engineer
Company	TEXACO Inc.
Date	9/7/71
I hereby certify that the well location shown on this plat was plotted from field notes of actual surveys made by me or under my supervision, and that the same is true and correct to the best of my knowledge and belief.	
Date Surveyed	9/7/71
Registered Professional Engineer and/or Land Surveyor	J. J. Velten
Certificate No.	8174

RECEIVED

SEP 9 1971

OIL CONSERVATION COMM.
HOBBS, N. M.

Accepted Profile 12-12-88