

STATE OF NEW MEXICO
ENERGY AND MINERALS DEPARTMENT

OIL CONSERVATION DIVISION
P. O. BOX 2088
SANTA FE, NEW MEXICO 87501

20-025-23948
Form C-101
Revised 10-1-78

NO. OF COPIES RECEIVED	
DISTRIBUTION	
SANTA FE	
FILE	
U.S.G.S.	
LAND OFFICE	
OPERATOR	

5A. Indicate Type of Lease
STATE ☒ FEE ☐
5. State Oil & Gas Lease No.

APPLICATION FOR PERMIT TO DRILL, DEEPEN, OR PLUG BACK

Type of Work
Type of Well
OIL WELL ☐ GAS WELL ☒ OTHER Re-entry
Name of Operator
Address of Operator
Location of Well

7. Unit Agreement Name
8. Farm or Lease Name
9. Well No.
10. Field and Pool, or Wildcat

DRILL ☐ DEEPEN ☐ PLUG BACK ☐
SINGLE ZONE ☐ MULTIPLE ZONE ☐
Mid-America Petroleum, Inc.
P. O. Box 3023, Midland, Texas 79702
UNIT LETTER M LOCATED 660 FEET FROM THE West LINE
660 FEET FROM THE South LINE OF SEC. 2 TWP. 19-S RGE. 34-E NMPM

Scharb "2" State
1
Scharb
East of Rio Grande

11. Proposed Depth
12. County
13. Elevation (Show whether D.F., H.I., etc.)
14. Kind & Status Plug. Bond
15. Drilling Contractor
16. Approx. Date Work will Start

12. County
Lea
19. Proposed Depth
13,750'
19A. Formation
Morrow
20. Rotary or C.T.
Rotary
3983 GR
Blanket
Ram Well Service Unit
November 1, 1981

PROPOSED CASING AND CEMENT PROGRAM

SIZE OF HOLE	SIZE OF CASING	WEIGHT PER FOOT	SETTING DEPTH	SACKS OF CEMENT	EST. TOP
13-3/8"	11-3/4"	38#	550	550	Surface
12-1/4"	8-5/8"	24#	4050	530	550
7-7/8"	5-1/2"	26#	13,750	600	9550

Nipple up on 11-3/4" casing and drill out surface plug with 9-1/2" bit. Drill out 40 sx. plug @ 420'. Clean out to top of 8-5/8" stub @ 550', dress off top of 8-5/8" csg. Run casing bowl and tie-back 8-5/8" casing. Defer cement until it is determined we can get into 5-1/2" casing. Pick up 7-7/8" bit and clean out plug inside 8-5/8" csg. 45 sx plug @ 4126' (170'). Clean out in open hole and drill out cement plugs 40 sx @ 5100' (120') and 40 sx @ 6935' (120'). Clean out to top of 5-1/2" stub @ 9550', dress off top of 5-1/2" stub. Pick up 2500' of 2-7/8" D.P. and 4-3/4" bit and clean out inside 5-1/2" csg. B.P. @ 10,950' with 350' of cement on top. Clean out to 10,600' and squeeze Bone Springs perfs 10,506' to 10,582'. Drill and clean out to 13,750'. Run 5-1/2" casing bowl and ±9500' of 5-1/2" 20# casing back to surface. Cement 8-5/8" casing with 250 sx or required amount to circulate cement.

ABOVE SPACE DESCRIBE PROPOSED PROGRAM; IF PROPOSAL IS TO DEEPEN OR PLUG BACK, GIVE DATA ON PRESENT PRODUCTIVE ZONE AND PROPOSED NEW PRODUCTION ZONE. GIVE BLOWOUT PREVENTER PROGRAM, IF ANY.

I hereby certify that the information above is true and complete to the best of my knowledge and belief.

Signed Charles J. Love Title Production Manager Date October 14, 1981

(This space for State Use)

Orig. Signed by

PROVED BY Jerry Sexton TITLE State Engineer DATE 1981

CONDITIONS OF APPROVAL, IF ANY

N. MEXICO OIL CONSERVATION COMMISS
WELL LOCATION AND ACREAGE DEDICATION PLAT

Form C-102
Supersedes C-128
Effective 1-1-65

All distances must be from the outer boundaries of the Section.

Operator Mid-America Petroleum, Inc.			Lease Scharb "2" State		Well No. 1
Unit Letter M	Section 2	Township 19-S	Range 34-E	County Lea	
Actual Footage Location of Well: 660' feet from the West line and 660 feet from the South line					
Ground Level Elev. 3983'	Producing Formation Morrow	Pool East La Rica - Morrow Scharb		Dedicated Acreage: 320 Acres	

1. Outline the acreage dedicated to the subject well by colored pencil or hatchure marks on the plat below.
2. If more than one lease is dedicated to the well, outline each and identify the ownership thereof (both as to working interest and royalty).
3. If more than one lease of different ownership is dedicated to the well, have the interests of all owners been consolidated by communitization, unitization, force-pooling, etc?

☐ Yes ☐ No If answer is "yes," type of consolidation _____

If answer is "no," list the owners and tract descriptions which have actually been consolidated. (Use reverse side of this form if necessary.) _____

No allowable will be assigned to the well until all interests have been consolidated (by communitization, unitization, forced-pooling, or otherwise) or until a non-standard unit, eliminating such interests, has been approved by the Commission.

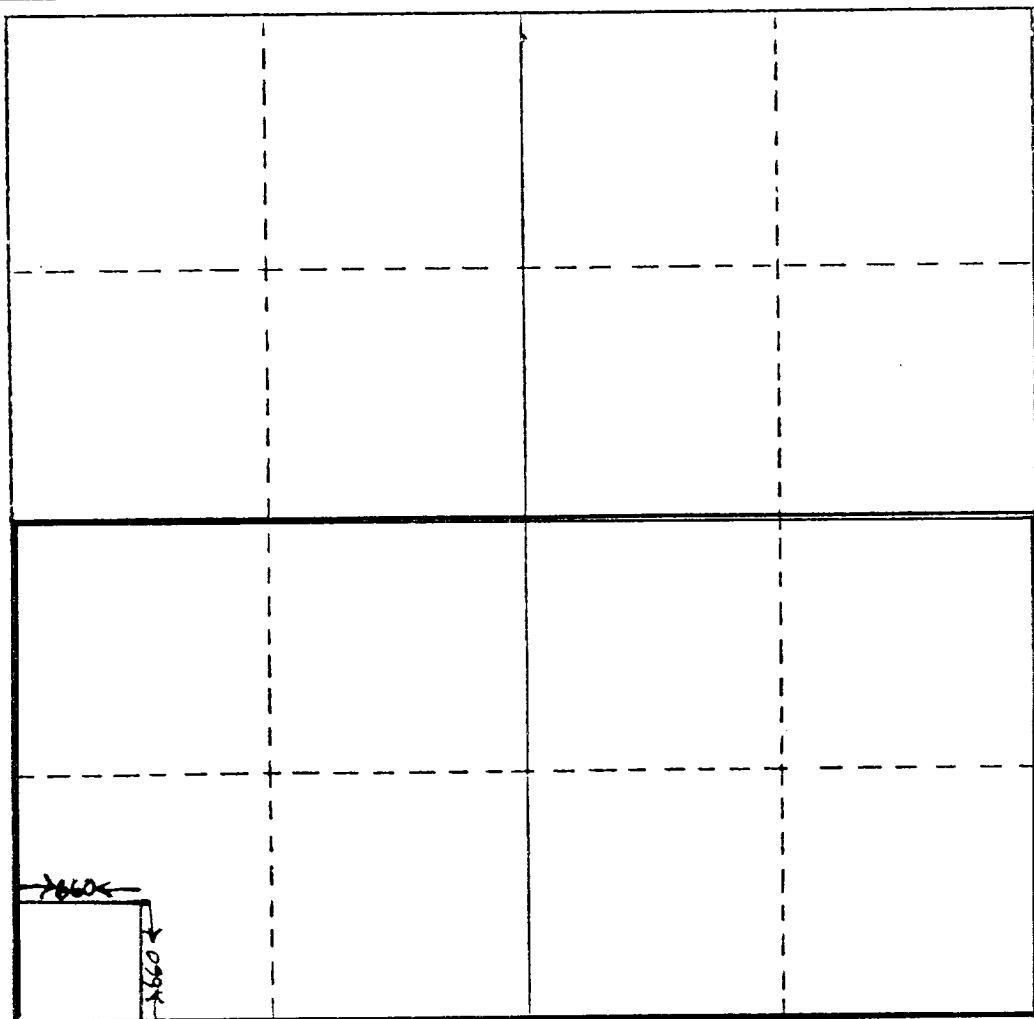

CERTIFICATION

I hereby certify that the information contained herein is true and complete to the best of my knowledge and belief.

Name
Charles J. Lowe
Position
Production Manager
Company
Mid-America Petroleum, Inc.
Date
October 14, 1981

I hereby certify that the well location shown on this plat was plotted from field notes of actual surveys made by me or under my supervision, and that the same is true and correct to the best of my knowledge and belief.

Date Surveyed

Registered Professional Engineer
or a Land Surveyor

Certificate No.

330 140 90 1320 1660 1980 2310 2640 2000 1500 1000 500 0