

UNITED STATES  
DEPARTMENT OF THE INTERIOR  
GEOLOGICAL SURVEY

## APPLICATION FOR PERMIT TO DRILL, DEEPEN, OR PLUG BACK

## 1a. TYPE OF WORK

DRILL ☒DEEPEN ☐PLUG BACK ☐

## b. TYPE OF WELL

OIL  
WELL ☒GAS  
WELL ☐

OTHER

SINGLE  
ZONE ☐MULTIPLE  
ZONE ☐

## 2. NAME OF OPERATOR

The Superior Oil Company

## 3. ADDRESS OF OPERATOR

P. O. Box 1900, Midland, Texas 79701

## 4. LOCATION OF WELL (Report location clearly and in accordance with any State requirements.\*)

At surface 760' FNL &amp; 760' FEL, Section 25, T-19-S, R-34-E

At proposed prod. zone

Bone Springs

## 14. DISTANCE IN MILES AND DIRECTION FROM NEAREST TOWN OR POST OFFICE\*

11 miles south of Buckeye, New Mexico

## 15. DISTANCE FROM PROPOSED\*

LOCATION TO NEAREST  
PROPERTY OR LEASE LINE, FT.  
(Also to nearest drlg. line, if any)

760'

## 16. NO. OF ACRES IN LEASE

640

17. NO. OF ACRES ASSIGNED  
TO THIS WELL

80

18. DISTANCE FROM PROPOSED LOCATION\*  
TO NEAREST WELL, DRILLING, COMPLETED,  
OR APPLIED FOR, ON THIS LEASE, FT.

1650' - Shallow

## 19. PROPOSED DEPTH

10,300'

## 20. ROTARY OR CABLE TOOLS

Rotary

## 21. ELEVATIONS (Show whether DF, RT, GR, etc.)

GR: 3,775'

## 22. APPROX. DATE WORK WILL START\*

March 20, 1972

## 23.

## PROPOSED CASING AND CEMENTING PROGRAM

SIZE OF HOLE	SIZE OF CASING	WEIGHT PER FOOT	SETTING DEPTH	QUANTITY OF CEMENT
15"	11-3/4"	42 $\frac{1}{2}$	400'	450 sacks circ. to surface
11"	8-5/8"	32 $\frac{1}{2}$ & 24 $\frac{1}{2}$	3,800'	775 sacks
* 7-7/8"	5-1/2"	17 $\frac{1}{2}$	10,300'	910 sacks

The above well will be drilled in accordance with the above listed program, except that 5-1/2" casing will be run only if the Bone Springs Zone or other formations contain commercial production as determined from open hole electric logs and drill stem tests. The Government "E" No. 2 Well will be drilled in accordance with safe drilling practices known to industry utilizing blowout preventer and Hydrill equipment for proper well control. Blowout preventer equipment: Blowout preventers with blind and pipe rams plus Hydrill will be installed and tested prior to drilling 11" and 7-7/8" holes.

\* Productive 5-1/2" casing will be cemented using DV tool at approximately 6000'. The 1st stage cement will be approximately 360 sacks, and 2nd stage cement will be approximately 550 sacks. This program will be followed if all Zones are productive as expected.

IN ABOVE SPACE DESCRIBE PROPOSED PROGRAM: If proposal is to deepen or plug back give data on present productive zone and proposed new productive zone. If proposal is to drill or deepen directionally, give pertinent data on subsurface locations and measured and true vertical depths. Give blowout preventer program, if any.

24.

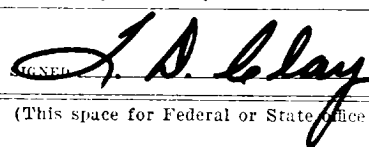

T. D. Clay TITLE Petroleum Engineer

DATE March 13, 1972

(This space for Federal or State office use)

PERMIT NO.

APPROVAL TITLE

APPROVED BY

TITLE

CONDITIONS OF APPROVAL, IF ANY:

DATE

\*See Instructions On Reverse Side

RECEIVED

MAY 1 1964

OIL CONSERVATION  
60368 10-5

**NEW MEXICO OIL CONSERVATION COMMISSION  
WELL LOCATION AND ACREAGE DEDICATION PLAT**

Form C-102  
Supersedes C-128  
Effective 1-1-65

All distances must be from the outer boundaries of the Section.

Operator <b>THE SUPERIOR OIL COMPANY</b>			Lease <b>GOVERNMENT E</b>		Well No. <b>2</b>
Unit Letter <b>A</b>	Section <b>25</b>	Township <b>19 SOUTH</b>	Range <b>34 EAST</b>	County <b>LEA</b>	
Actual Footage Location of Well: <div style="display: flex; justify-content: space-between;"> <span><b>760</b> feet from the <b>NORTH</b> line and</span> <span><b>760</b> feet from the <b>EAST</b> line</span> </div>					
Ground Level Elev. <b>3775.0</b>	Producing Formation <b>Bone Springs</b>	Pool <b>Undesignated</b>		Dedicated Acreage: <b>80</b> Acres	

1. Outline the acreage dedicated to the subject well by colored pencil or hachure marks on the plat below.
2. If more than one lease is dedicated to the well, outline each and identify the ownership thereof (both as to working interest and royalty).
3. If more than one lease of different ownership is dedicated to the well, have the interests of all owners been consolidated by communitization, unitization, force-pooling, etc?

☒ Yes    ☐ No    If answer is "yes," type of consolidation Government Lease No. NM-086 covers 640 acres in Sect. 25, T19S, R34E and no communitization required.

If answer is "no," list the owners and tract descriptions which have actually been consolidated. (Use reverse side of this form if necessary.) \_\_\_\_\_

No allowable will be assigned to the well until all interests have been consolidated (by communitization, unitization, forced-pooling, or otherwise) or until a non-standard unit, eliminating such interests, has been approved by the Commission.

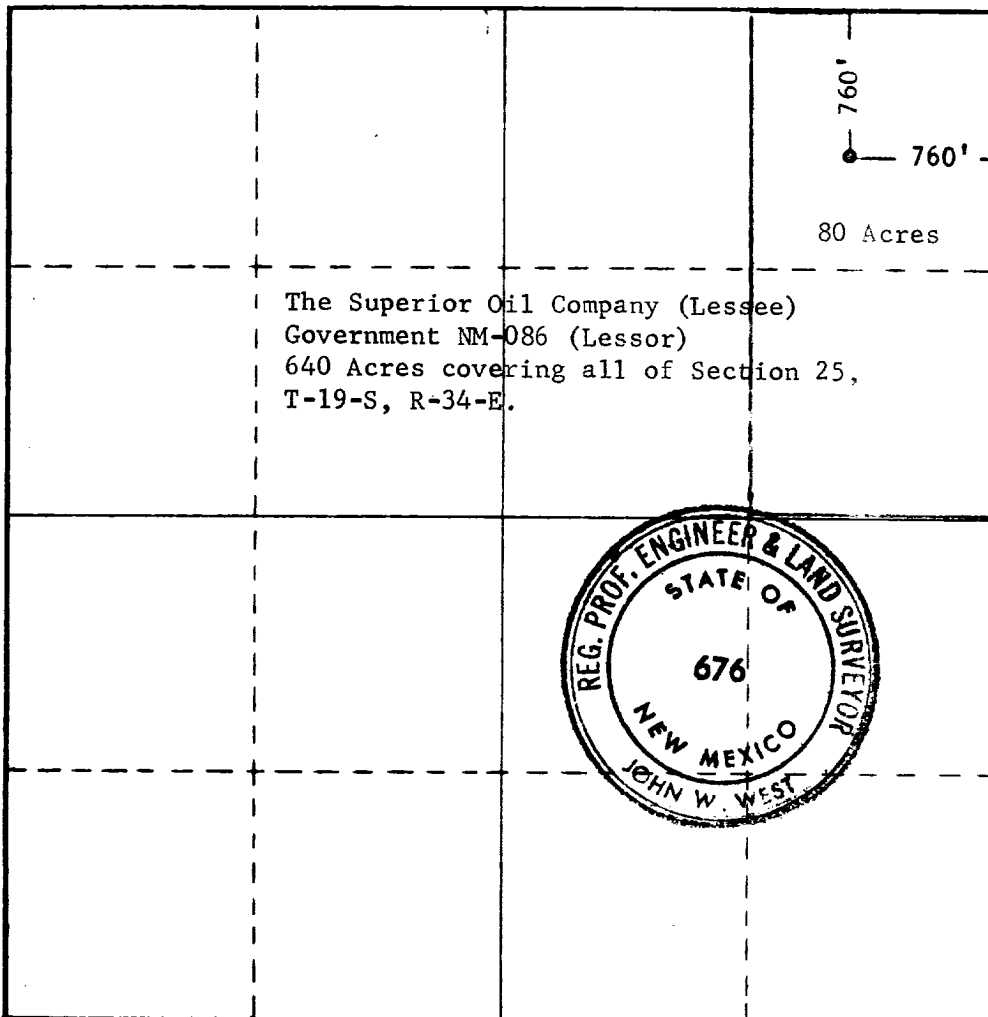

**CERTIFICATION**

I hereby certify that the information contained herein is true and complete to the best of my knowledge and belief.

*T. D. Clay*  
Name  
**T. D. Clay**

Position  
**Petroleum Engineer**

Company  
**The Superior Oil Company**

Date  
**March 13, 1972**

I hereby certify that the well location shown on this plat was plotted from field notes of actual surveys made by me or under my supervision, and that the same is true and correct to the best of my knowledge and belief.

Date Surveyed  
**3-8-1972**

Registered Professional Engineer and/or Land Surveyor

*John W. West*  
Certificate No. **676**



RECEIVED

MAR 21 1977

OIL CONSERVATION COMIA.  
HOBBS, N. M.