

**NEW MEXICO OIL CONSERVATION COMMISSION  
WELL LOCATION AND ACREAGE DEDICATION PLAT**

Form O-112  
Supersedes O-128  
1-15-65

All distances must be from the outer boundaries of the Section

Operator <b>PUBCO PETROLEUM CORP.</b>			Lease <b>SHIPP</b>		Acct. No. <b>2</b>
Section <b>J</b>	Range <b>11</b>	Meridian <b>17 SOUTH</b>	Range <b>37 EAST</b>	County <b>LEA</b>	
Year of Dedication <b>1980</b>		Feet from the <b>SOUTH</b>	Feet from the <b>2130</b>	Feet from the <b>EAST</b>	
Ground Level Elev. <b>3744.7'</b>	For the use of <b>STRAWN</b>	For the use of <b>UNNAMED</b>		For the use of <b>40</b>	

1. Outline the acreage dedicated to the subject well by colored pencil or hatchure marks on the plat below.
2. If more than one lease is dedicated to the well, outline each and identify the ownership thereon (as to working interest and royalty).
3. If more than one lease of different ownership is dedicated to the well, have the interests of all owners been consolidated by communitization, unitization, force-pooling, etc?

☐ Yes ☐ No If answer is "Yes," type of consolidation NA

If answer is "no," list the owners and tract descriptions which have actually been consolidated (on reverse side of this form if necessary.) NA

No allowable will be assigned to the well until all interests have been consolidated (by communitization, unitization, forced-pooling, or otherwise) or until a non-standard unit, eliminating such interests, has been approved by the Commission.

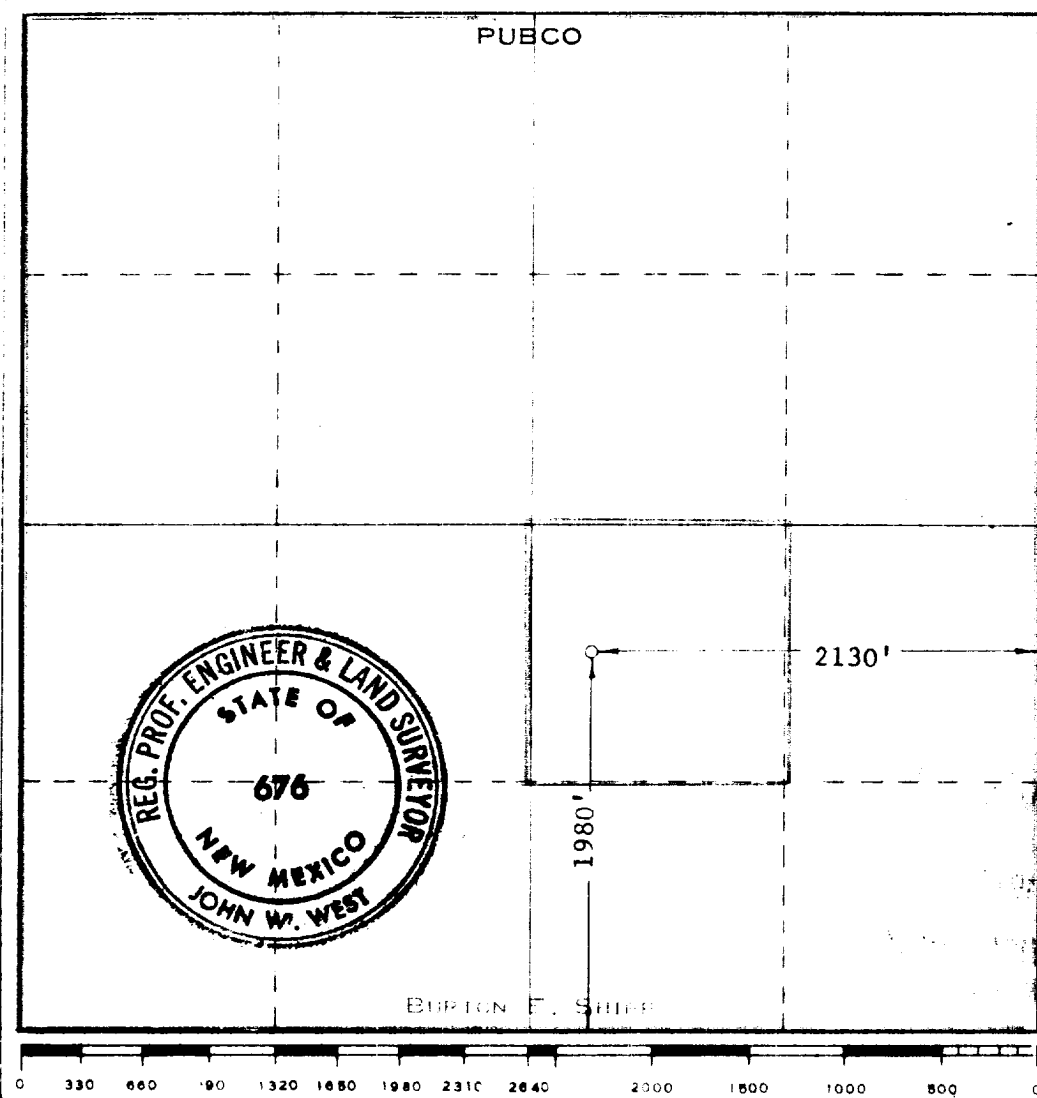

<b>CERTIFICATION</b>	
I hereby certify that the information contained herein is true and complete, to the best of my knowledge and belief.	
<i>[Signature]</i>	
Name	<b>CHARLES W. SANDERS</b>
Position	<b>AREA MANAGER</b>
Company	<b>PUBCO PETROLEUM CORP.</b>
Date	<b>APRIL 10, 1972</b>
I hereby certify that the well location shown on this plat was plotted from field notes of actual surveys made by me or under my supervision, and that the same is true and correct to the best of my knowledge and belief.	
Date Surveyed	<b>APRIL 8, 1972</b>
Registered Professional Engineer and/or Land Surveyor	
<i>[Signature]</i>	
Certificate No.	<b>676</b>

**RECEIVED**

**APR 11 1972**

**OIL CONSERVATION COMM.  
HOBBS, N. M.**

**113**