

**NEW MEXICO OIL CONSERVATION COMMISSION
WELL LOCATION AND ACREAGE DEDICATION PLAT**

Form C-102
Supersedes C-128
Effective 1-1-65

All distances must be from the outer boundaries of the Section.

Operator PUBCO PETROLEUM CORP.			Lease SHIPP		Well No. 3
Unit Letter F	Section 11	Township 17 SOUTH	Range 37 EAST	County LEA	
Actual Footage Location of Well: 2130 feet from the NORTH line and 1980 feet from the WEST line					
Ground Level Elev. 3744.9'	Producing Formation STRAWN	Pool UNNAMED	Dedicated Acreage: 40 Acres		

1. Outline the acreage dedicated to the subject well by colored pencil or hachure marks on the plat below.
2. If more than one lease is dedicated to the well, outline each and identify the ownership thereof (both as to working interest and royalty).
3. If more than one lease of different ownership is dedicated to the well, have the interests of all owners been consolidated by communitization, unitization, force-pooling, etc?

☐ Yes ☐ No If answer is "yes," type of consolidation N A

If answer is "no," list the owners and tract descriptions which have actually been consolidated. (Use reverse side of this form if necessary.) NA

No allowable will be assigned to the well until all interests have been consolidated (by communitization, unitization, forced-pooling, or otherwise) or until a non-standard unit, eliminating such interests, has been approved by the Commission.

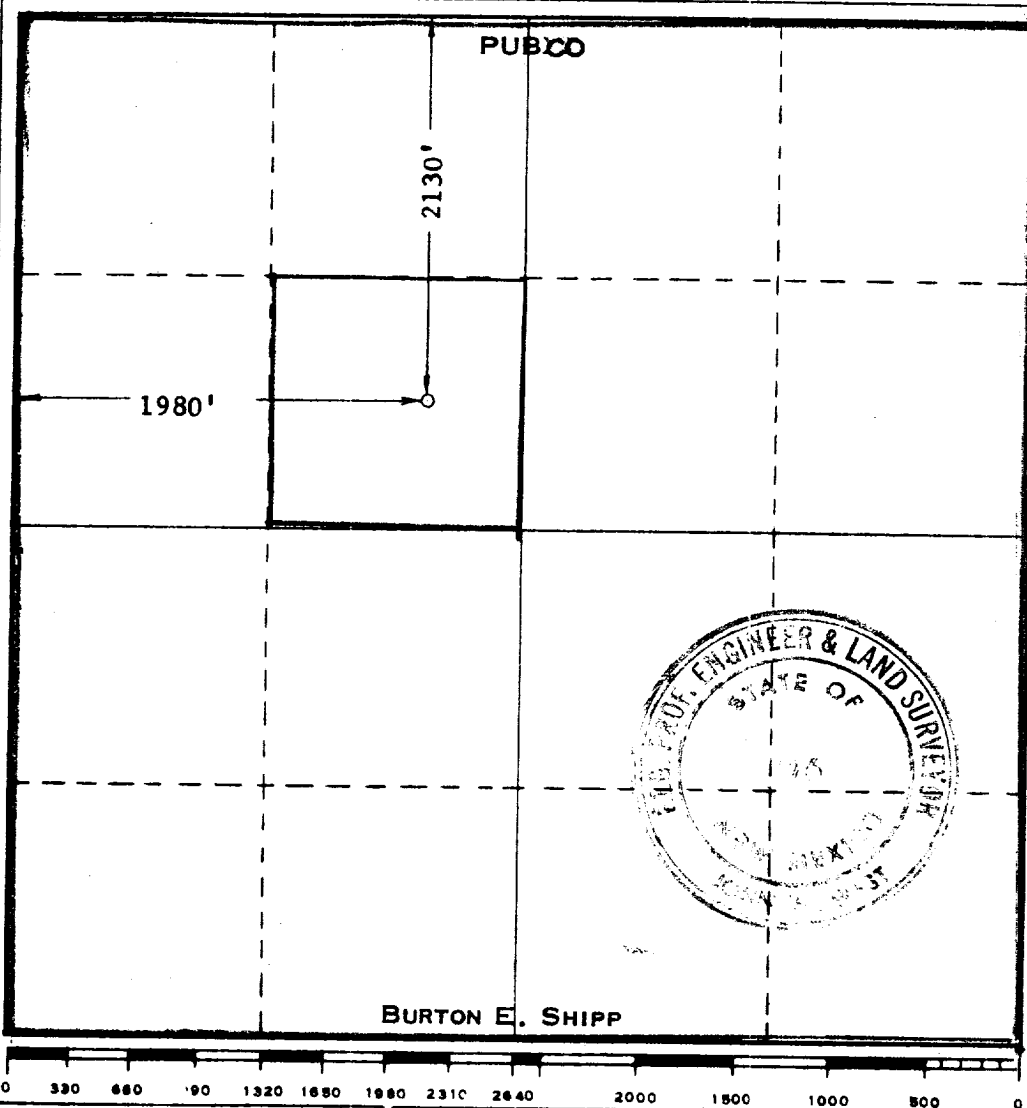

CERTIFICATION

I hereby certify that the information contained herein is true and complete to the best of my knowledge and belief.

Charles W. Sanders

Name
CHARLES W. SANDERS

Position
AREA MANAGER

Company
PUBCO PETROLEUM CORP.

Date
APRIL 10, 1972

I hereby certify that the well location shown on this plat was plotted from field notes of actual surveys made by me or under my supervision, and that the same is true and correct to the best of my knowledge and belief.

Date Surveyed
APRIL 8, 1972

Registered Professional Engineer and/or Land Surveyor

John W. West

Certificate No. **676**

47

RECEIVED

MAY 3 - 1972

OIL CONSERVATION COMM.
HOBBS, N. M.

COUNTY	LEA	FIELD	Undesignated	STATE	NM 30-025-24142
OPR	PUBCO PET. CORP.			MAP	
	3 Shipp				
	Sec 11, T-17-S, R-37-E			CO-ORD	
	2130' FNL, 1980' FWL of Sec				
	Spd 6-5-72			CLASS	EL
	Cmp 7-14-72	FORMATION	DATUM	FORMATION	DATUM
CSG & SX - TUBING					
13 3/8" at 415' w/350 sx					
9 5/8" at 4800' w/675 sx					
LOGS EL GR RA IND HC A					
	TD 11,711'				
PLUGGED & ABANDONED					

Distribution limited and publication prohibited by subscribers' agreement.
Reproduction rights reserved by Williams & Lee Scouting Service, Inc.

CONT.	MGF	PROP DEPTH	11,900'	TYPE	RT
DATE					

	F.R. 5-29-72; Opr's Elev. 3745' GL, 3757' KB
	PD 11,900' RT (Strawn)
	Contractor - MGF
6-5-72	TD 415'; WOC
6-12-72	TD 4446'; Trip
6-19-72	Drlg. 6644' (Tight)
	DST (Tight)
6-27-72	Drlg. 8756' 1m (Tight)
7-10-72	Drlg. 11,137' (Tight)
7-17-72	TD 11,711' (Tight)
7-24-72	TD 11,711' "Tight"
8-7-72	TD 11,711' "Tight"
8-14-72	TD 11,711'; PLUGGED & ABANDONED

LEA
PUBCO PET. CORP.

Undesignated
3 Shipp

NM Sec 11, T17S,R37E
Page #2

8-14-72

Continued

DST 5285-5327', open 1 hr 45 mins, rec 20' OCW +
527' sli OCW + 270' sulf wtr, 1 hr ISIP 1948#, FP
114-379#, 3 hr FSIP 1879#, HP 2285-2264#
DST 5546-5667', open 55 mins, rec 3485' Drlg Wc +
820' sulf wtr, 1 hr ISIP 1902#, FP 1669-1902#,
1 hr 20 min FSIP 1924#, HP 2456-2435#
DST 8882-9184', open 2 hrs, rec 795' DM + 315'
sli GCM + 90' sli O&GCM + 90' HO&GCM, 2 hr ISIP
1368#, FP 488-517#, 3 hr 20 min FSIP 1595#,
HP 4364-4364#
DST 11,498-11,640', open 50 mins (1500' WB), rec
WB + 15' DM, 1 hr 30 min ISIP 1074#, FP 732-732#,
1 hr FSIP 846#, HP 5347-5347#

8-14-72

Continued

LOG TOPS: Queen 4364', San Andres 5250', Glorieta
6854', Tubb 8125', Wolfcamp 9448', Strawn 11,483',
Atoka 11,612'

8-19-72

COMPLETION REPORTED