

NO. OF COPIES RECEIVED	
DISTRIBUTION	
SANTA FE	
FILE	
U.S.G.S.	
LAND OFFICE	
OPERATOR	

# NEW MEXICO OIL CONSERVATION COMMISSION

Form C-101  
Revised 1-1-65

5A. Indicate Type of Lease	
STATE <input checked="" type="checkbox"/>	FEE <input type="checkbox"/>
5. State Oil & Gas Lease No.	
B-2388	

## APPLICATION FOR PERMIT TO DRILL, DEEPEN, OR PLUG BACK

1a. Type of Work		7. Unit Agreement Name	
b. Type of Well		8. Farm or Lease Name	
DRILL <input type="checkbox"/> DEEPEN <input type="checkbox"/> PLUG BACK <input checked="" type="checkbox"/> OIL WELL <input checked="" type="checkbox"/> GAS WELL <input type="checkbox"/> OTHER <input type="checkbox"/> SINGLE ZONE <input type="checkbox"/> MULTIPLE ZONE <input type="checkbox"/>		Santa Fe	
2. Name of Operator		9. Well No.	
Phillips Petroleum Company		125	
3. Address of Operator		10. Field and Pool, or Wildcat	
Room 711, Phillips Building, Odessa, Texas 79761		Undesignated	
4. Location of Well		12. County	
UNIT LETTER <u>N</u> LOCATED <u>600</u> FEET FROM THE <u>south</u> LINE AND <u>1820</u> FEET FROM THE <u>west</u> LINE OF SEC. <u>20</u> TWP. <u>17-S</u> RGE <u>35-E</u> NMPM		Lea	
19. Proposed Depth		20. Rotary or C.T.	
8900'		Workover	
21. Elevations (Show whether DF, RT, etc.)		22. Approx. Date Work will start	
3972' Gr., 3984' DF		Upon approval	
21A. Kind & Status Plug. Bond		21B. Drilling Contractor	
blanket		Workover rig	

### PROPOSED CASING AND CEMENT PROGRAM

SIZE OF HOLE	SIZE OF CASING	WEIGHT PER FOOT	SETTING DEPTH	SACKS OF CEMENT	EST. TOP
17-1/2"	13-3/8"	48#	365'	425 sx Class H. Circ 40sx at sur.	
11"	8-5/8"	24#, 32#	4355'	(300 sx Trin.LW, 250) Temp surv TOC	
7-7/8"	5-1/2"	15.5#, 17#	10,450'	(sx Incor SR. ) at 2750'. 350sx Tr.LW&600sxClassH. DV collar at 6518'.TOC outside csg at 8590'. Perf csg w/2 shots @ 8560', cmtd w/675sx Tr.LW&200sx Incor SR. Temp survey TOC at 4300'.	

Propose setting CIBP at approx. 8900' w/2 sx cmt on top. Perforate Abo interval approx. 8700-8800', attempt Abo completion.

Note: Perforated Wolfcamp zone w/2 jet shots/ft at 10188-92', 10226-36', 10316-20', total 18', 32 holes. Tested zone, non-productive; perforated Wolfcamp zone w/2 jet shots/ft at 9692-95', 9790-92', 9854-60', 10032-37', 10132-35', total 17', 34 holes. Tested zone, non-productive. Wolfcamp zone to be abandoned with completion to be made in Abo zone.

IN ABOVE SPACE DESCRIBE PROPOSED PROGRAM: IF PROPOSAL IS TO DEEPEN OR PLUG BACK, GIVE DATA ON PRESENT PRODUCTIVE ZONE AND PROPOSED NEW PRODUCTIVE ZONE. GIVE BLOWOUT PREVENTER PROGRAM, IF ANY.

I hereby certify that the information above is true and complete to the best of my knowledge and belief.

Signed W. J. Mueller Title Senior Reservoir Engineer Date 9-29-72

(This space for State Use)

APPROVED BY [Signature] TITLE SUPERVISOR DISTRICT I DATE OCT 2 1972

CONDITIONS OF APPROVAL, IF ANY:

RECEIVED

Oct 2 1972

OIL CONSERVATION COMM.  
HOUSTON, TEX.

**NEW MEXICO OIL CONSERVATION COMMISSION  
WELL LOCATION AND ACREAGE DEDICATION PLAT**

Form C-102  
Supersedes C-128  
Effective 1-1-65

All distances must be from the outer boundaries of the Section.

Operator <b>Phillips Petroleum Company</b>			Lease <b>Santa Fe</b>		Well No. <b>125</b>
Unit Letter <b>N</b>	Section <b>20</b>	Township <b>17-S</b>	Range <b>35-E</b>	County <b>Lea</b>	
Actual Footage Location of Well: <b>600</b> feet from the <b>south</b> line and <b>1820</b> feet from the <b>west</b> line					
Ground Level Elev. <b>3972'</b>	Producing Formation <b>Abo</b>	Pool <b>Undesignated</b>		Dedicated Acreage: <b>80</b> Acres	

1. Outline the acreage dedicated to the subject well by colored pencil or hachure marks on the plat below.
2. If more than one lease is dedicated to the well, outline each and identify the ownership thereof (both as to working interest and royalty).
3. If more than one lease of different ownership is dedicated to the well, have the interests of all owners been consolidated by communitization, unitization, force-pooling, etc?

☐ Yes    ☐ No    If answer is "yes," type of consolidation ---

If answer is "no," list the owners and tract descriptions which have actually been consolidated. (Use reverse side of this form if necessary.) ---

No allowable will be assigned to the well until all interests have been consolidated (by communitization, unitization, forced-pooling, or otherwise) or until a non-standard unit, eliminating such interests, has been approved by the Commission.

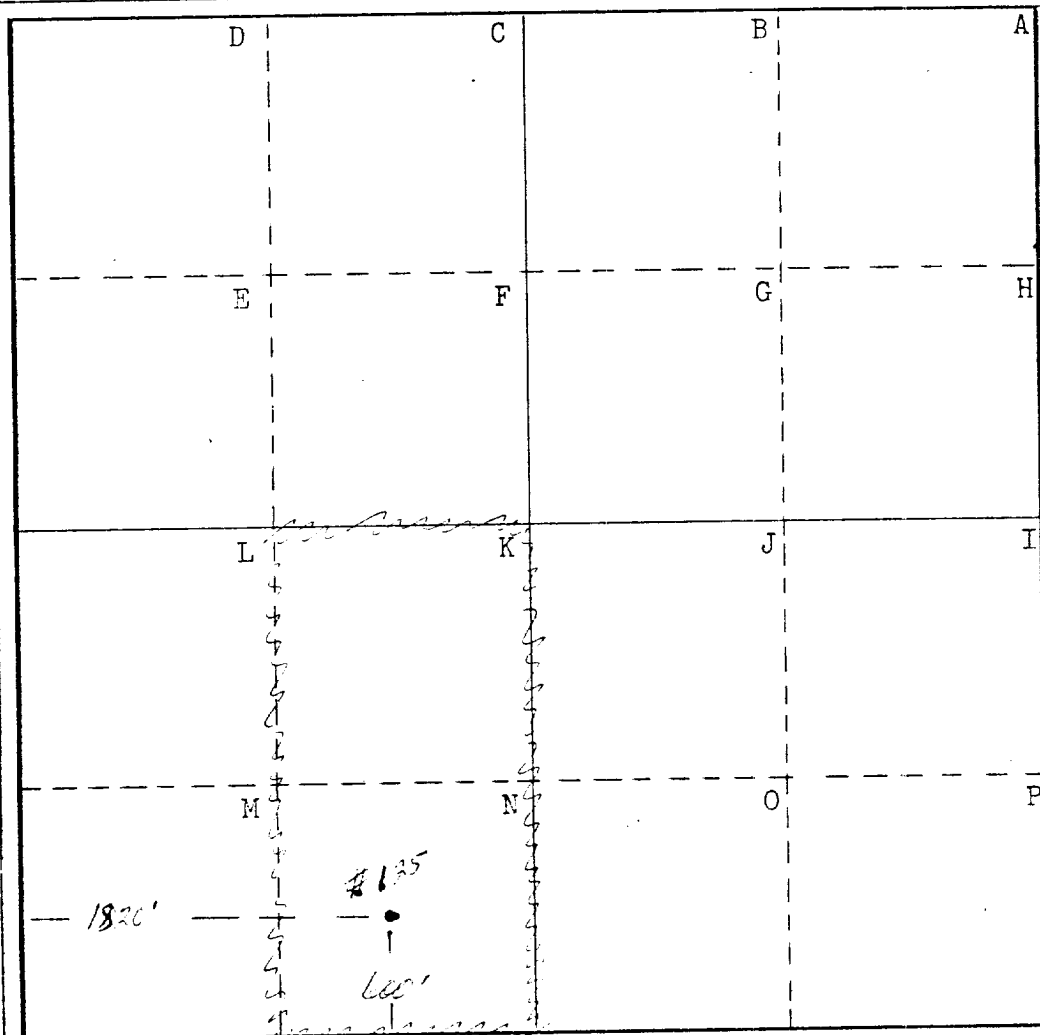

**CERTIFICATION**

I hereby certify that the information contained herein is true and complete to the best of my knowledge and belief.

Name W. J. Mueller

Position  
**Senior Reservoir Engineer**

Company  
**Phillips Petroleum Company**

Date  
**September 29, 1972**

I hereby certify that the well location shown on this plat was plotted from field notes of actual surveys made by me or under my supervision, and that the same is true and correct to the best of my knowledge and belief.

Date Surveyed  
**7-19-72**

Registered Professional Engineer and/or Land Surveyor

**John W. West**

Certificate No.  
**676**

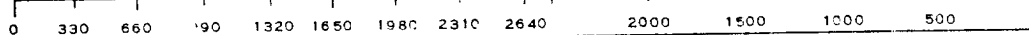

RECEIVED

GM 2/172

OIL CONSERVATION COMM.  
HULLS, W. M.