

| | |
|------------------------|--|
| NO. OF COPIES RECEIVED | |
| DISTRIBUTION | |
| SANTA FE | |
| FILE | |
| U.S.G.S. | |
| LAND OFFICE | |
| OPERATOR | |

NEW MEXICO OIL CONSERVATION COMMISSION

Form C-101
Revised 1-1-65

| | |
|---|------------------------------|
| 5A. Indicate Type of Lease | |
| STATE <input checked="" type="checkbox"/> | FEE <input type="checkbox"/> |
| 5. State Oil & Gas Lease No. | |
| K-4549 | |

APPLICATION FOR PERMIT TO DRILL, DEEPEN, OR PLUG BACK

| | | | |
|--|--|----------------------------------|--|
| 1a. Type of Work | | 7. Unit Agreement Name | |
| b. Type of Well OIL WELL <input checked="" type="checkbox"/> GAS WELL <input type="checkbox"/> OTHER <input type="checkbox"/> | | 8. Farm or Lease Name | |
| DRILL <input checked="" type="checkbox"/> DEEPEN <input type="checkbox"/> PLUG BACK <input type="checkbox"/> | | Buckeye-State | |
| 2. Name of Operator | | 9. Well No. | |
| Penroc Oil Corporation | | 1 | |
| 3. Address of Operator | | 10. Field and Pool, or Wildcat | |
| P. O. Drawer 831, Midland, Texas 79701 | | Vacuum Abo, N, Und | |
| 4. Location of Well | | 12. County | |
| UNIT LETTER H LOCATED 2100 FEET FROM THE North LINE | | Lea | |
| AND 700 FEET FROM THE East LINE OF SEC. 20 TWP. 17 S RGE. 35 E NMPM | | | |
| | | 19. Proposed Depth | |
| | | 9100' | |
| | | 19A. Formation | |
| | | Abo | |
| | | 20. Rotary or C.T. | |
| | | Rotary | |
| 21. Elevations (Show whether DP, RT, etc.) | | 22. Approx. Date Work will start | |
| 3967' GR | | October 1, 1972 | |
| 21A. Kind & Status Plug. Bond | | 21B. Drilling Contractor | |
| Statewide, active | | | |

23.

PROPOSED CASING AND CEMENT PROGRAM

| SIZE OF HOLE | SIZE OF CASING | WEIGHT PER FOOT | SETTING DEPTH | SACKS OF CEMENT | EST. TOP |
|--------------|----------------|-----------------|---------------|-----------------|----------|
| 17" | 12-3/4" | 43# | 300' | Circulate | Surface |
| 11" | 8-5/8" | 28# | 3200' | 100 sx | 2850' |
| 7-3/4" | 4-1/2" | 10.5 & 11.6# | TD-9100' | 250 sx | 7800' |

EX-110 11-30-72

IN ABOVE SPACE DESCRIBE PROPOSED PROGRAM: IF PROPOSAL IS TO DEEPEN OR PLUG BACK, GIVE DATA ON PRESENT PRODUCTIVE ZONE AND PROPOSED NEW PRODUCTIVE ZONE. GIVE BLOWOUT PREVENTER PROGRAM, IF ANY.

I hereby certify that the information above is true and complete to the best of my knowledge and belief.

Signed [Signature] Title Vice-President Date August 28, 1972
(This space for State Use)

APPROVED BY [Signature] TITLE SUPERVISOR DISTRICT I DATE AUG 30 1972

CONDITIONS OF APPROVAL, IF ANY:

No allowable will be assigned until either a standard Unit is formed or a non-standard proration order is issued.

RECEIVED

AUG 20 1972

OIL CONSERVATION COMM.
HOUSTON, TEX.

**NEW MEXICO OIL CONSERVATION COMMISSION
WELL LOCATION AND ACREAGE DEDICATION PLAT**

Form C-102
Supersedes C-128
Effective 1-1-65

All distances must be from the outer boundaries of the Section

| | | | | | |
|---|-----------------------------------|-----------------------------|------------------------------------|----------------------|---------------------------------|
| Operator PENROC OIL CORPORATION | | | Lease BUCKEYE STATE | | Well No. 1 |
| Unit Letter H | Section 20 | Township 17 SOUTH | Range 35 EAST | County LEA | |
| Actual Footage Location of Well: 2100 feet from the NORTH line and 700 feet from the EAST line | | | | | |
| Ground Level Elev. 3967 | Producing Formation ABO | | Pool No. vacuum ABO UND. | | Dedicated Acreage: 40 |

1. Outline the acreage dedicated to the subject well by colored pencil or hachure marks on the plat below.
2. If more than one lease is dedicated to the well, outline each and identify the ownership thereof (both as to working interest and royalty).
3. If more than one lease of different ownership is dedicated to the well, have the interests of all owners been consolidated by communitization, unitization, force-pooling, etc?

☐ Yes ☐ No If answer is "yes," type of consolidation _____

If answer is "no," list the owners and tract descriptions which have actually been consolidated. (Use reverse side of this form if necessary.) _____

No allowable will be assigned to the well until all interests have been consolidated (by communitization, unitization, forced-pooling, or otherwise) or until a non-standard unit, eliminating such interests, has been approved by the Commission.

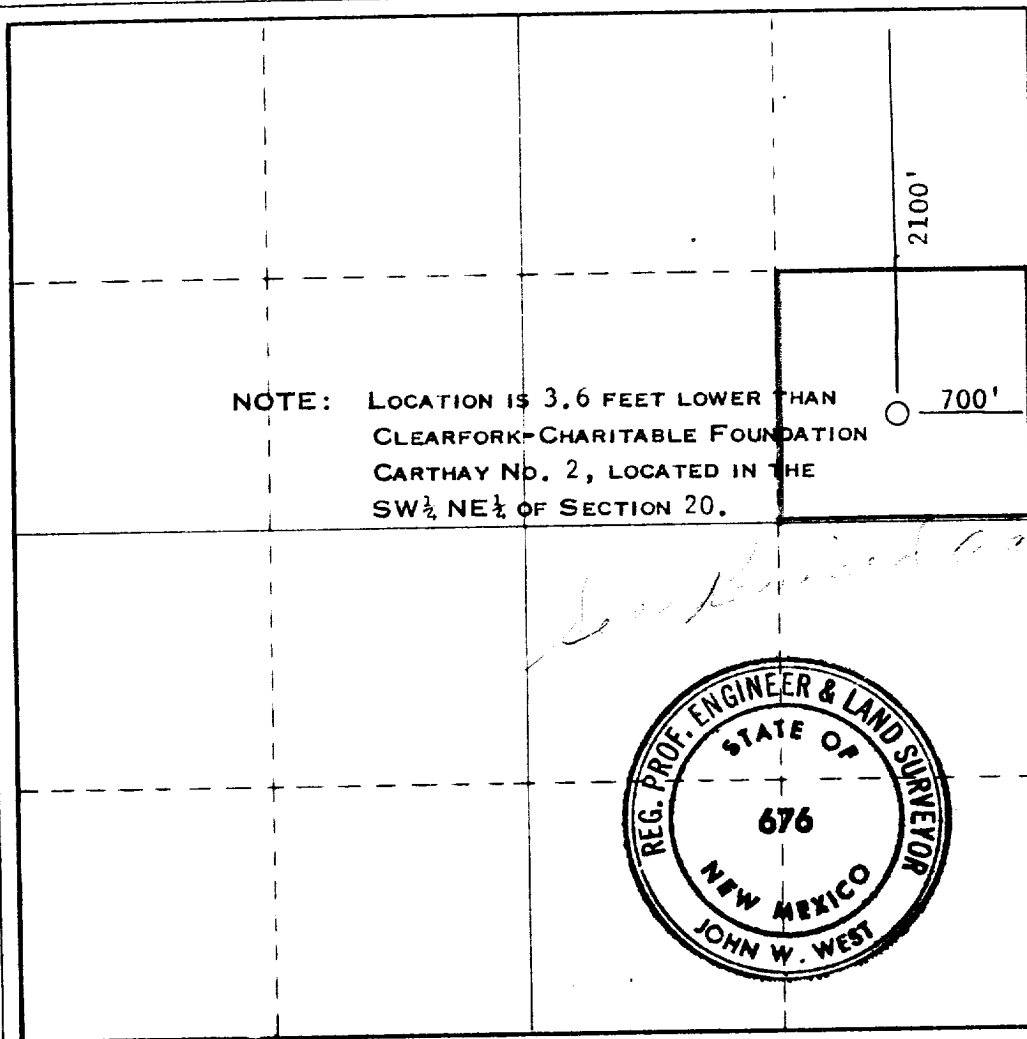

CERTIFICATION

I hereby certify that the information contained herein is true and complete to the best of my knowledge and belief.

B. J. Valley
Name

Vice-President
Position

Penroc Oil Corporation
Company

8/25/72
Date

I hereby certify that the well location shown on this plat was plotted from field notes of actual surveys made by me or under my supervision, and that the same is true and correct to the best of my knowledge and belief.

Date Surveyed

AUGUST 23, 1972

Registered Professional Engineer
and/or Land Surveyor

John W. West
Certificate No.

676

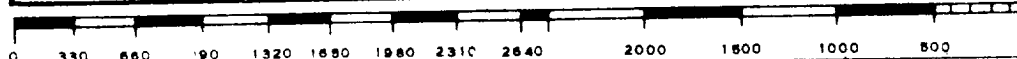

RECEIVED

APR 20 1972

OIL CONSERVATION, CC 414,
HOBBBS, N. H.