

IP (Abo) Perfs 8864-8954' P 98 BOPD + 5 BW. Pot based on  
24 hr test. GOR 612; Grav 39.1

FR 11-6-72  
(Morrow)  
11-6-72 TD 320'; WOC  
11-13-72 Drlg 3990' anhy & 1m  
11-27-72 Drlg 6545' 1m  
12-4-72 Drlg 8321' 1m  
12-11-72 Drlg 10,176' 1m & sh  
12-18-72 Drlg 11,122' 1m  
1-2-73 Drlg 11,883' 1m & sh  
1-8-73 TD 12,425'; Rng Logs  
1-15-73 TD 12,425'; MORT  
1-22-73 TD 12,425'; PBD 12,373'; Prep Perf

1-29-73

TD 12,425'; PBD 12,373'; Prep PB  
Perf (Morrow) 12,323-334' w/2 SPF  
Swbd 14 BLO & Swbd dry (12,323-334')  
Acid (12,323-334') 1500 gals  
Swbd 130 BFW in 7 hrs

2-5-73

TD 12,425'; PBD 12,290'; Prep Perf  
PB to 12,290'

2-12-73

TD 12,425'; PBD 12,290'; Prep Swab  
Perf (Atoka) 11,868-872', 11,932-38', 12,014-22',  
12,058-065', 12,114-122' w/2 SPF  
Acid (11,868-12,122') 5000 gals (7½%)

2-16-73

TD 12,425'; PBD 11,520'; Prep Drill Cmt  
Flwd 5 BAW in 5 hrs thru 48/64" chk, TP 150#  
PB to 11,820'

2-26-73

TD 12,425'; PBD 10,794'; Swbg  
Perf (Pennsylvanian) 10,895', 10,897', 10,899',  
10,904', 10,909', 10,911', 10,913', 10,991',  
10,993', 10,995', 11,000', 11,001', 11,002'  
w/1 SPI

Acid (10,895-11,002') 500 gals (15% NE)

Swbd 11 BLO + 178 BFW in 11 hrs

PB to 10,794'

Perf (Abo) 8864-68', 8895-8900', 8916-22',  
8944-54' w/2 SPF

Acid (8864-8954') 500 gals (15% NE)

Swbd dry (8864-8954')

Acid (8864-8954') 10,000 gals (15% NE)

Swbd 61 BNO + 55 BLO + 123 BAW in 14 hrs

LEA

Vacuum, N.

NM Sec 8, T17S, R35E

MOBIL OIL CORP.

1 State "NN" Com

Page #3

3-5-73 TD 12,425'; PBD 10,794'; WO Elec  
Swbd 29 BO + 20 BLW in 4 hrs (8864-8954')  
3-12-73 TD 12,425'; PBD 10,794'; TO Pmp  
Ppd 241 BLO + 80 BNO + 28 BLW in 72 hrs  
3-19-73 TD 12,425'; PBD 10,794'; WO OCC Pot  
Ppd 98 BO + 5 B salt wtr in 24 hrs  
GOR 612; Grav 39.1  
3-26-73 TD 12,425'; PBD 10,794'; COMPLETE  
LOG TOPS: Anhydriete 1870', Yates 3150', Queen  
4095', San Andres 4824', Glorieta 6270', Tubb  
7636', Abo 8356', Wolfcamp 9800', Strawn 11,592',  
Morrow 12,165'  
3-31-73 COMPLETION REPORTED

**NEW MEXICO OIL CONSERVATION COMMISSION  
WELL LOCATION AND ACREAGE DEDICATION PLAT**

Fb: 7-102  
Sup. Order C-128  
Effective 1-1-65

All distances must be from the outer boundaries of the Section.

Operator <b>Mobil Oil Corporation</b>			Lease <b>State NN Com</b>		Well No. <b>1</b>
Unit Letter <b>L</b>	Section <b>8</b>	Township <b>17S</b>	Range <b>35E</b>	County <b>Lea</b>	
Actual Footage Location of Well: <div style="display: flex; justify-content: space-between;"> <span><b>660</b> feet from the <b>west</b> line and</span> <span><b>1980</b> feet from the <b>south</b> line</span> </div>					
Ground Level Elev. <b>3984'</b>	Producing Formation <b>Morrow</b>	Pool <b>Undesignated (Morrow)</b>		Dedicated Acreage: <b>320</b> Acres	

1. Outline the acreage dedicated to the subject well by colored pencil or hatchure marks on the plat below.
2. If more than one lease is dedicated to the well, outline each and identify the ownership thereof (both as to working interest and royalty).
3. If more than one lease of different ownership is dedicated to the well, have the interests of all owners been consolidated by communitization, unitization, force-pooling, etc?

☒ Yes    ☐ No    If answer is "yes," type of consolidation Communitization pending

If answer is "no," list the owners and tract descriptions which have actually been consolidated. (Use reverse side of this form if necessary.) \_\_\_\_\_

No allowable will be assigned to the well until all interests have been consolidated (by communitization, unitization, forced-pooling, or otherwise) or until a non-standard unit, eliminating such interests, has been approved by the Commission.

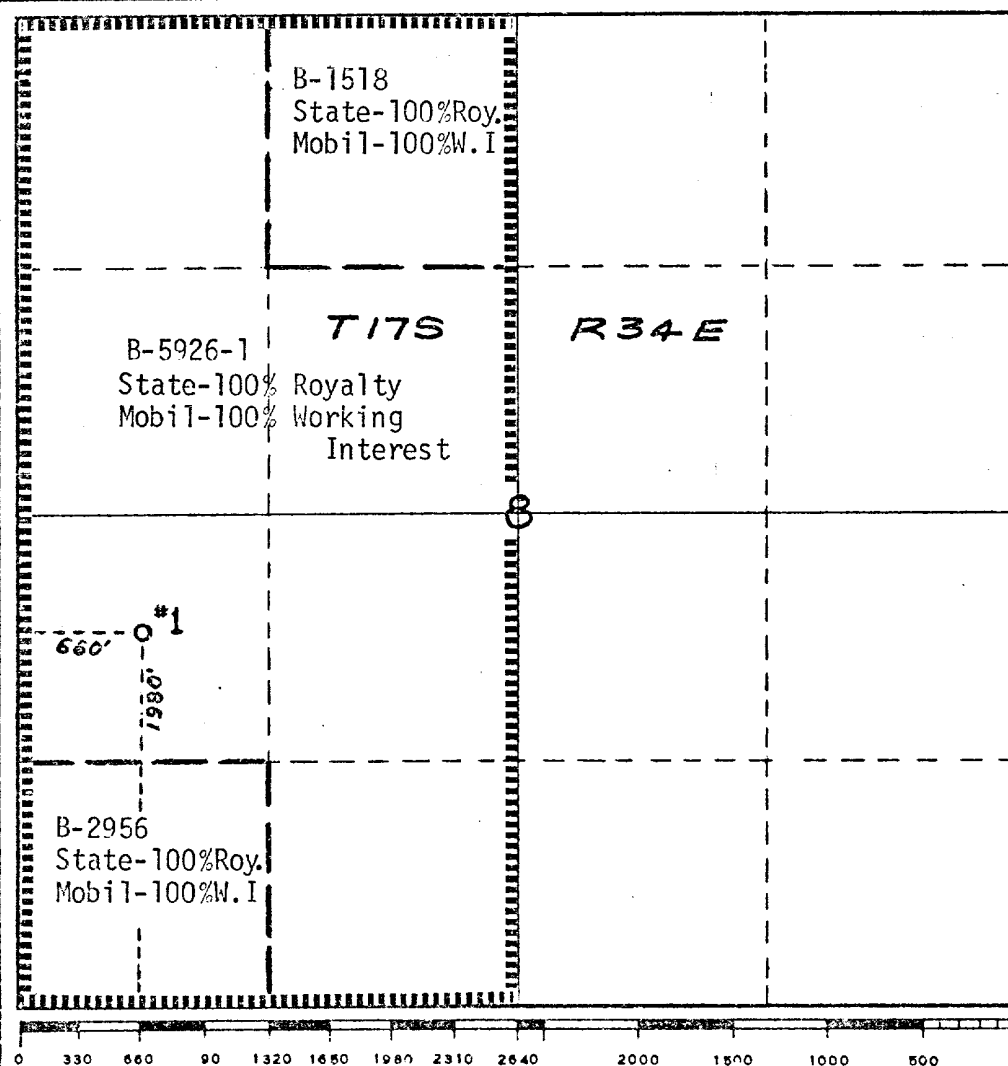

**CERTIFICATION**

I hereby certify that the information contained herein is true and complete to the best of my knowledge and belief.

*A. D. Bond*  
Name

**A. D. Bond**

Position  
**Proration Staff Assistant**

Company  
**Mobil Oil Corporation**

Date  
**June 7, 1976**

I hereby certify that the well location shown on this plat was plotted from field notes of actual surveys made by me or under my supervision, and that the same is true and correct to the best of my knowledge and belief.

Date Surveyed

Registered Professional Engineer  
and/or Land Surveyor

Certificate No.

RECEIVED

JUN 8 1976

OIL CONSERVATION COMM.  
HOBBS, N. M.