

UNITED STATES
DEPARTMENT OF THE INTERIOR
GEOLOGICAL SURVEY

APPLICATION FOR PERMIT TO DRILL, DEEPEN, OR PLUG BACK

1a. TYPE OF WORK

DRILL ☒

DEEPEN ☐

PLUG BACK ☐

b. TYPE OF WELL

OIL
WELL ☐

GAS
WELL ☒

OTHER

SINGLE
ZONE ☒

MULTIPLE
ZONE ☐

2. NAME OF OPERATOR

C. W. Trainer, Marvin Gross & Miller Oil Co.

3. ADDRESS OF OPERATOR

c/o Oil Reports & Gas Services, Inc., Box 763, Hobbs, N.M. 88240

4. LOCATION OF WELL (Report location clearly and in accordance with any State requirements.)*

At surface

1980' FML & 1980' FML of Sec. 13

At proposed prod. zone

14. DISTANCE IN MILES AND DIRECTION FROM NEAREST TOWN OR POST OFFICE*

25 miles West Monument

15. DISTANCE FROM PROPOSED*

LOCATION TO NEAREST
PROPERTY OR LEASE LINE, FT.
(Also to nearest drlg. unit line, if any)

1980'

16. NO. OF ACRES IN LEASE

17. NO. OF ACRES ASSIGNED
TO THIS WELL

320

18. DISTANCE FROM PROPOSED LOCATION*

TO NEAREST WELL, DRILLING, COMPLETED,
OR APPLIED FOR, ON THIS LEASE, FT.

19. PROPOSED DEPTH

13,600

20. ROTARY OR CABLE TOOLS

Combination

21. ELEVATIONS (Show whether DF, RT, GR, etc.)

3722.1 GR

22. APPROX. DATE WORK WILL START*

Upon Approval

23.

PROPOSED CASING AND CEMENTING PROGRAM

SIZE OF HOLE	SIZE OF CASING	WEIGHT PER FOOT	SETTING DEPTH	QUANTITY OF CEMENT
12 1/2	11 3/4	42# H-47	300	300 (1
11	8 5/8	24# & 32# K-55	4000	400 (2
7 5/8	4 1/2	11.6# H-80, P-110	13,600	375 (3

1) 300 sx Class H, 2% calcium chloride

2) 200 sx Class C, 4% gel, 7# salt per sack, 200 sx regular, 2% calcium chloride

3) 375 sx Class H, 1# KCL per sack, 0.8% Haled 9

MUD: 0 to 300' Spud mud, fresh water, gel & paper if needed; 300' to 4000' salt base & starch mud with paper if needed; 4000' to 13,600' fresh water & low solids muds as required. Anticipated mud characteristics at 13,000 to 13,600 are 8 WL, 10 ppg wt, 40 to 45 viscosity.

BLOWOUT PREVENTER: To 8 5/8" casing point 2 M Rd or 2M RR Hydraulic with 2M choke manifold as shown in Fig 12 API Bul. D-13, 2-66. Below 8 5/8" casing 5M RSRA or 5M RSRA Hydraulic with 5M choke manifold as shown in Fig. 12 API Bul. D-13, 2-66.

IN ABOVE SPACE DESCRIBE PROPOSED PROGRAM: If proposal is to deepen or plug back, give data on present productive zone and proposed new productive zone. If proposal is to drill or deepen directionally, give pertinent data on subsurface locations and measured and true vertical depths. Give blowout preventer program, if any.

24.

SIGNED Wanna Heller

TITLE Agent

(This space for Federal or State office use)

PERMIT NO. _____

APPROVAL DATE

APPROVED BY _____

TITLE

CONDITIONS OF APPROVAL, IF ANY:

APPROVED

12/19/72

DEC 29 1972

ARTHUR R. BROWN
DISTRICT ENGINEER

Instructions

General: This form is designed for submitting proposals to perform certain well operations, as indicated, on all types of lands and leases for appropriate action by either a Federal or a State agency, or both, pursuant to applicable Federal and/or State laws and regulations. Any necessary special instructions concerning the use of this form and the number of copies to be submitted, particularly with regard to local, area, or regional procedures and practices, either are shown below or will be issued by, or may be obtained from, the local Federal and/or State office.

Item 1: If the proposal is to redrill to the same reservoir at a different subsurface location or to a new reservoir, use this form with appropriate notations. Consult applicable State or Federal regulations concerning subsequent work proposals or reports on the well.

Item 4: If there are no applicable State requirements, locations on Federal or Indian land should be described in accordance with Federal requirements. Consult local State or Federal office for specific instructions.

Item 14: Needed only when location of well cannot readily be found by road from the land or lease description. A plat, or plats, separate or on this reverse side, showing the roads to, and the surveyed location of, the well, and any other required information, should be furnished when required by Federal or State agency offices.

Items 15 and 18: If well is to be, or has been directionally drilled, give distances for subsurface location of hole in any present or objective production zone.

Item 22: Consult applicable Federal or State regulations, or appropriate officials, concerning approval of the proposal before operations are started.

RECEIVED

JAN 10 1973

U.S. CONSERVATION COMM.
WASH. D. C.

NEW MEXICO OIL CONSERVATION COMMISSION
WELL LOCATION AND ACREAGE DEDICATION PLAT

Form C-102
Supersedes C-128
Effective 1-1-65

All distances must be from the outer boundaries of the Section

Operator C. W. TRAINER, MILLER CO., MARVIN GROSS			Lease La Rica West		Well No. 1
Unit Letter F	Section 13	Township 19 South	Range 33 East	County Lea	
Actual Footage Location of Well: 1980 feet from the north line and 1980 feet from the west line					
Ground Level Elev. 3722.1	Producing Formation Morrow		Pool Wildcat	Dedicated Acreage: 320 Acres	

1. Outline the acreage dedicated to the subject well by colored pencil or hachure marks on the plat below.
2. If more than one lease is dedicated to the well, outline each and identify the ownership thereof (both as to working interest and royalty).
3. If more than one lease of different ownership is dedicated to the well, have the interests of all owners been consolidated by communitization, unitization, force-pooling, etc?

☐ Yes ☐ No If answer is "yes," type of consolidation _____

If answer is "no," list the owners and tract descriptions which have actually been consolidated. (Use reverse side of this form if necessary.) _____

No allowable will be assigned to the well until all interests have been consolidated (by communitization, unitization, forced-pooling, or otherwise) or until a non-standard unit, eliminating such interests, has been approved by the Commission.

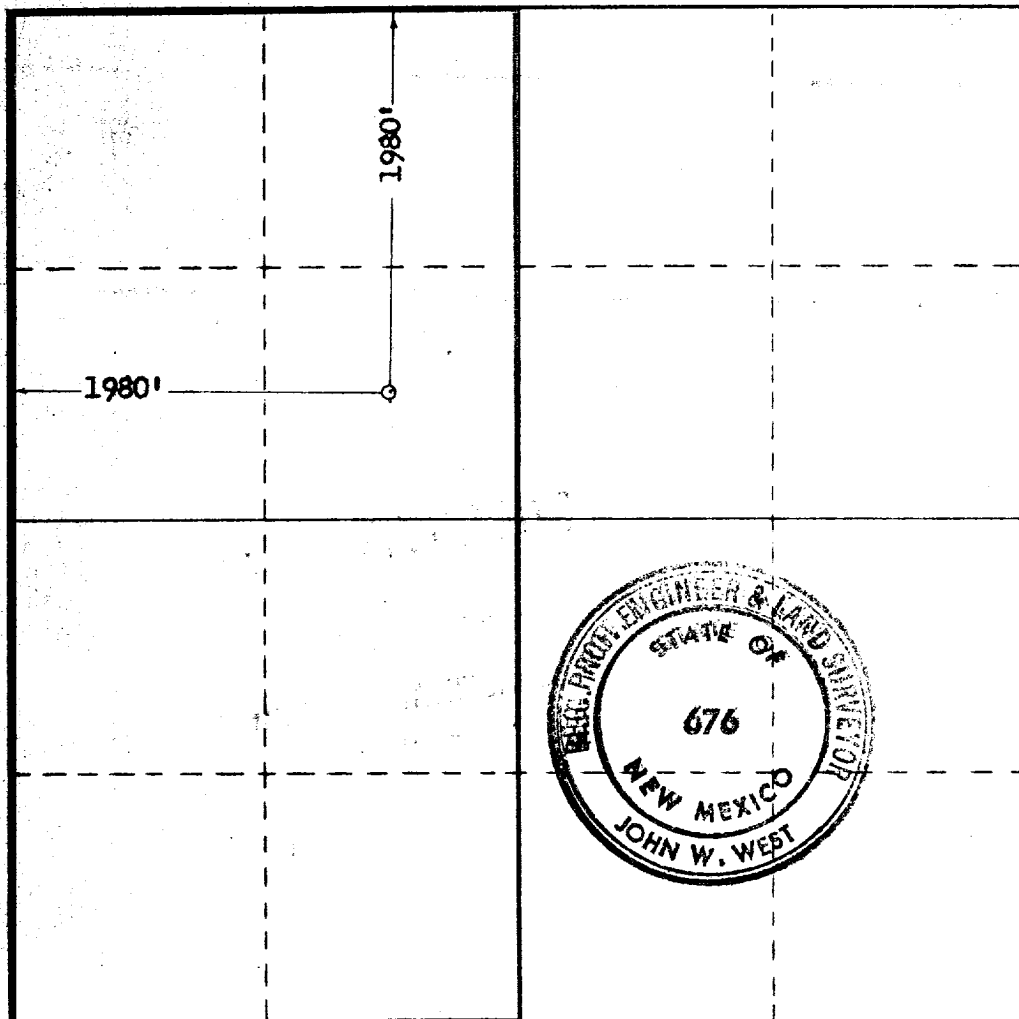

CERTIFICATION

I hereby certify that the information contained herein is true and complete to the best of my knowledge and belief.

Name
Donna Holko
Position
Agent
Company
C. W. Trainer, Marvin Gross & Miller Oil Co.
Date

December 19, 1972

I hereby certify that the well location shown on this plat was plotted from field notes of actual surveys made by me or under my supervision, and that the same is true and correct to the best of my knowledge and belief.

Date Surveyed
Dec. 16, 1972

Registered Professional Engineer and/or Land Surveyor

John W. West
Certificate No. **676**

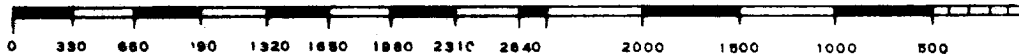

RECEIVED

JAN 1 1973

OIL CONSERVATION COMM.
HOBBS, N. M.