

NO. OF COPIES RECEIVED  
DISTRIBUTION  
SANTA FE  
FILE  
U.S.G.S.  
LAND OFFICE  
OPERATOR

NEW MEXICO OIL CONSERVATION COMMISSION

Form C-101  
Revised 1-1-65

API #30-025-24643

APPLICATION FOR PERMIT TO DRILL, DEEPEN, OR PLUG BACK

1. Name of Well  
2. Type of Well  
a. OIL WELL ☒ GAS WELL ☐ OTHER ☐  
b. DRILL ☐ DEEPEN ☐ PLUG BACK ☒  
3. Name of Operator  
Phillips Petroleum Company  
4. Address of Operator  
Room 711, Phillips Building, Odessa, Texas 79761  
5. Location of Well  
UNIT: G 1650 north  
2310 east 34 17-S 35-E  
6. Depth of Well  
3920' DF  
7. Unit Agreement Name  
--  
8. Name of Lease  
Santa Fe  
9. Well No.  
127  
10. Field and Pool, or Wildcat  
Vacuum Yates  
11. County  
Lea  
12. Duration  
4475' PBTD Yates  
13. Rotary or Casing  
--  
14. Approx. Date Work will start  
Upon approval

SIZE OF Casing	SIZE OF Casing	W. & G. HOLE	DEPTH OF WELL	SALES OF CEMENT	EST. TOP
12-1/4"	8-5/8"	28.56#	410' (200 sx Class H w/2% CaO12 & 2# Floccle/ex. Circ to surface.)		--
7-7/8"	5-1/2"	14#, 15.5#	4703' (150 sx Class H w/40% DD, 50sx Class H w/2# Gilsomite/ex. Temp surv TOC at (2950'.))		--

Well originally drilled to total depth of 4703', perforated and tested Grayburg/San Andres zone 4544-92', non-commercial.

Propose setting CI BP at approximately 4400' w/2 sx cnt on top of BP. Perforate Yates zone approximately 3082-3182', test, and attempt completion in Vacuum Yates Pool.

APPROVAL VALID  
FOR 90 DAYS UNLESS  
DRILLING COMMENCED,  
EXPIRES 7-24-74

APPROVED BY: W. J. Mueller Senior Reservoir Engineer Date: 4-22-74  
APPROVED BY: [Signature] DATE: [Blank]  
CONDITIONS OF APPROVAL: [Blank]

NEW MEXICO OIL CONSERVATION COMMISSION  
WELL LOCATION AND ACREAGE DEDICATION PLAT

Form C-102  
Supersedes C-128  
Effective 1-1-65

All distances must be from the outer boundaries of the Section.

Operator <b>Phillips Petroleum Company</b>			Lease <b>Santa Fe</b>		Well No. <b>127</b>
Unit Letter <b>G</b>	Section <b>34</b>	Township <b>17-S</b>	Range <b>35E</b>	County <b>Lea</b>	
Actual Footage Location of Well: <b>1650</b> feet from the <b>north</b> line and <b>2310</b> feet from the <b>east</b> line					
Ground Level Elev. <b>3920' DF</b>	Producing Formation <b>Yates</b>		Pool <b>Vacuum Yates</b>		Dedicated Acreage: <b>40</b> Acres

1. Outline the acreage dedicated to the subject well by colored pencil or hachure marks on the plat below.
2. If more than one lease is dedicated to the well, outline each and identify the ownership thereof (both as to working interest and royalty).
3. If more than one lease of different ownership is dedicated to the well, have the interests of all owners been consolidated by communitization, unitization, force-pooling, etc?

☐ Yes ☐ No If answer is "yes," type of consolidation \_\_\_\_\_

If answer is "no," list the owners and tract descriptions which have actually been consolidated. (Use reverse side of this form if necessary.) \_\_\_\_\_

No allowable will be assigned to the well until all interests have been consolidated (by communitization, unitization, forced-pooling, or otherwise) or until a non-standard unit, eliminating such interests, has been approved by the Commission.

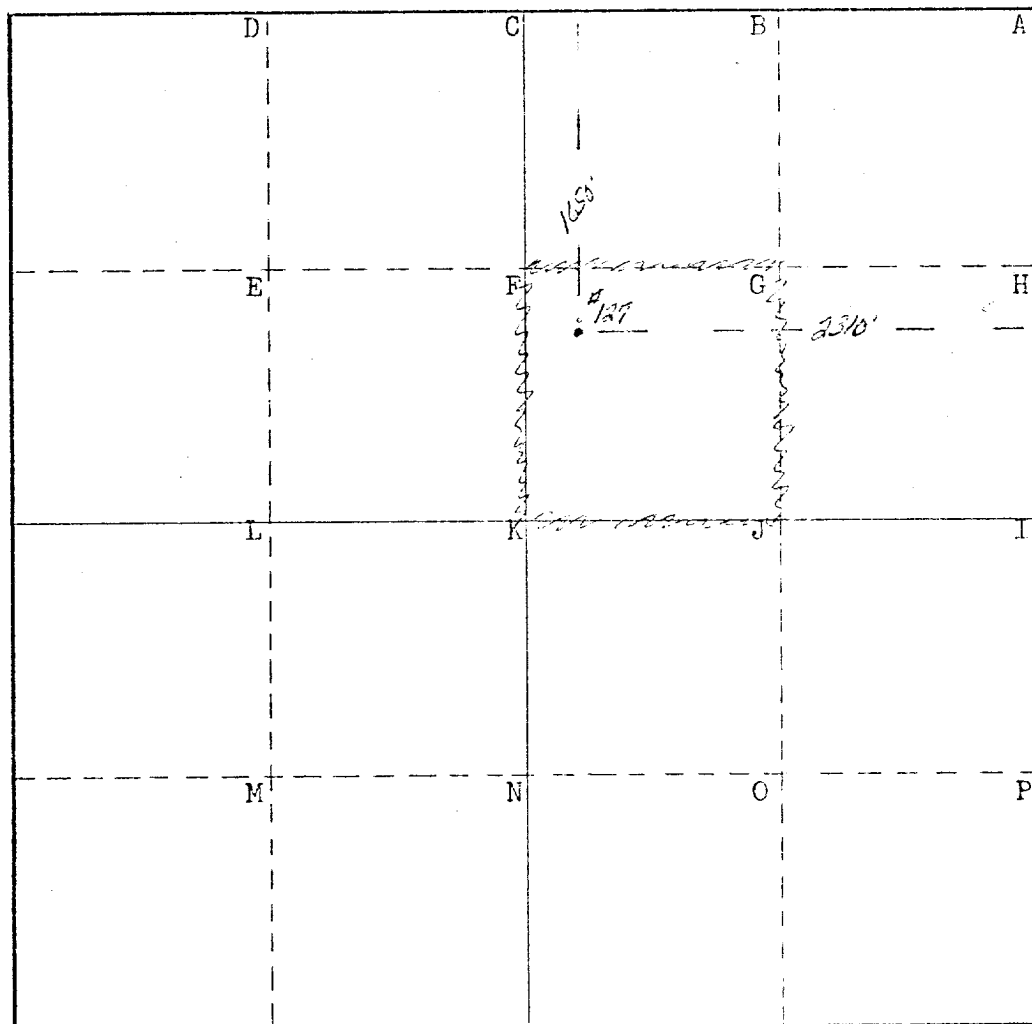

CERTIFICATION

I hereby certify that the information contained herein is true and complete to the best of my knowledge and belief.

Name  
**W. J. Mueller**  
Position  
**Senior Reservoir Engineer**  
Company  
**Phillips Petroleum Co.**  
Date  
**April 19, 1974**

I hereby certify that the well location shown on this plat was plotted from field notes of actual surveys made by me or under my supervision, and that the same is true and correct to the best of my knowledge and belief.

Date Surveyed  
**12-28-73**  
Registered Professional Engineer and/or Land Surveyor

**John W. West**

Certificate No.  
**676**

