

NO. OF COPIES RECEIVED	
DISTRIBUTION	
SANTA FE	
FILE	
U.S.G.S.	
LAND OFFICE	
OPERATOR	

NEW MEXICO OIL CONSERVATION COMMISSION

Form C-101
Revised 1-4-65

5A. Indicate Type of Lease STATE <input checked="" type="checkbox"/> FEE <input type="checkbox"/>
5. State Oil & Gas Lease No. B-1713
7. Unit Agreement Name -
8. Farm or Lease Name Warn State A/C 3
9. Well No. 8
10. Field and Pool, or Wildcat Vacuum (Glorieta)
12. County Lea
19. Proposed Depth 6300
19A. Formation Glorieta
20. Rotary or C.T. Rotary
21. Elevations (Show whether DF, RT, etc.) 3939 GL
21A. Kind & Status Plug. Bond current
21B. Drilling Contractor unknown
22. Approx. Date Well will start 9-30-74

APPLICATION FOR PERMIT TO DRILL, DEEPEN, OR PLUG BACK

1a. Type of Work DRILL <input checked="" type="checkbox"/> DEEPEN <input type="checkbox"/> PLUG BACK <input type="checkbox"/>
b. Type of Well OIL WELL <input checked="" type="checkbox"/> GAS WELL <input type="checkbox"/> OTHER <input type="checkbox"/> SINGLE ZONE <input checked="" type="checkbox"/> MULTIPLE ZONE <input type="checkbox"/>
2. Name of Operator Marathon Oil Company
3. Address of Operator P. O. Box 2409, Hobbs, New Mexico 88240
4. Location of Well UNIT LETTER H LOCATED 1650 FEET FROM THE North LINE AND 990 FEET FROM THE East LINE OF SEC. 33 TWP. 17-S RGE. 35-E NMPM
23. PROPOSED CASING AND CEMENT PROGRAM

SIZE OF HOLE	SIZE OF CASING	WEIGHT PER FOOT	SETTING DEPTH	SACKS OF CEMENT	EST. TOP
13-3/4"	10-3/4"	40.5#	1500'	925	Surface
7-7/8"	5"	15#	6300'	1200	1400

Plan to drill to a depth of approximately 6300'. All casing will be cemented and tested by approved methods.

Blowout equipment to be used is: 900 Series Cameron pipe rams and blind rams. Remote controls will be located on derrick floor with closing unit located a minimum of 75' from wellhead.

APPROVAL VALID
FOR 90 DAYS UNLESS
DRILLING COMMENCED,

EXPIRES 10-10-74

IN ABOVE SPACE DESCRIBE PROPOSED PROGRAM: IF PROPOSAL IS TO DEEPEN OR PLUG BACK, GIVE DATA ON PRESENT PRODUCTIVE ZONE AND PROPOSED NEW PRODUCTIVE ZONE. GIVE BLOWOUT PREVENTER PROGRAM, IF ANY.

I hereby certify that the information above is true and complete to the best of my knowledge and belief.

Signed C. L. Niles Title Operations Superintendent Date July 8, 1974

(This space for State Use)

SUPERVISOR

APPROVED BY [Signature] TITLE DATE

CONDITIONS OF APPROVAL, IF ANY:

NEW MEXICO OIL CONSERVATION COMMISSION
WELL LOCATION AND ACREAGE DEDICATION PLAT

Form C-102
Supersedes C-128
Effective 1-1-65

All distances must be from the outer boundaries of the Section

Operator Marathon Oil Company			Lease Warn State Acc. 3		Well No. 8
Section H	Section 33	Township 17 South	Range 35 East	County Lea	
Actual Surface Location of Well: 1650 feet from the North line and 990 feet from the East line					
Ground Level Elev. 3939	Producing Formation Glorieta		Pool Vacuum Glorieta		Dedicated Acreage: 40 Acres

- Outline the acreage dedicated to the subject well by colored pencil or hatchure marks on the plat below.
- If more than one lease is dedicated to the well, outline each and identify the ownership thereof (both as to working interest and royalty).
- If more than one lease of different ownership is dedicated to the well, have the interests of all owners been consolidated by communitization, unitization, force-pooling, etc?

☐ Yes ☐ No If answer is "yes," type of consolidation _____

If answer is "no," list the owners and tract descriptions which have actually been consolidated. (Use reverse side of this form if necessary.) _____

No allowable will be assigned to the well until all interests have been consolidated (by communitization, unitization, forced-pooling, or otherwise) or until a non-standard unit, eliminating such interests, has been approved by the Commission.

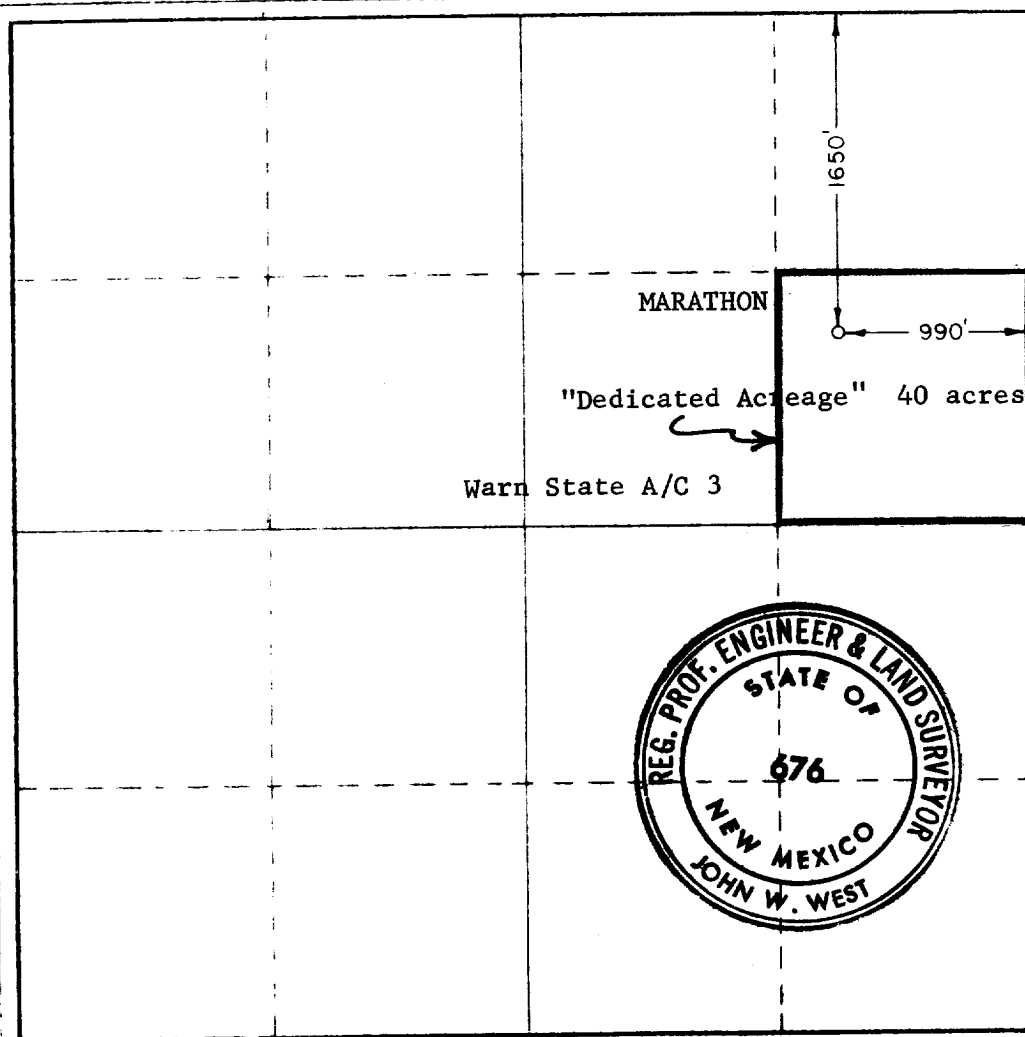

CERTIFICATION

I hereby certify that the information contained herein is true and complete to the best of my knowledge and belief.

[Signature]
Name

Operations Superintendent

Position

Marathon Oil Company

Company

July 8, 1974

Date

I hereby certify that the well location shown on this plat was plotted from field notes of actual surveys made by me or under my supervision, and that the same is true and correct to the best of my knowledge and belief.

Date Surveyed

July 2, 1974

Registered Professional Engineer and/or Land Surveyor

[Signature]
Certificate No.

676



173