

UNITED STATES
DEPARTMENT OF THE INTERIOR
GEOLOGICAL SURVEY

APPLICATION FOR PERMIT TO DRILL, DEEPEN, OR PLUG BACK

1a. TYPE OF WORK

DRILL ☒DEEPEN ☐PLUG BACK ☐

b. TYPE OF WELL

OIL
WELL ☒GAS
WELL ☐

OTHER

SINGLE
ZONE ☒MULTIPLE
ZONE ☐

2. NAME OF OPERATOR

The Superior Oil Company

3. ADDRESS OF OPERATOR

P. O. Box 1900, Midland, Texas 79701

4. LOCATION OF WELL (Report location clearly and in accordance with any State requirements.*)

At surface

990' FNL & 1980' FEL Section 25, T-19-S, R-34-E

At proposed prod. zone

Same as above

14. DISTANCE IN MILES AND DIRECTION FROM NEAREST TOWN OR POST OFFICE*

8 miles southwest of Arkansas Junction

15. DISTANCE FROM PROPOSED* LOCATION TO NEAREST PROPERTY OR LEASE LINE, FT. 990' - Property Line 330' - Drlg Unit (Also to nearest drlg. unit line, if any.)

16. NO. OF ACRES IN LEASE

640

17. NO. OF ACRES ASSIGNED TO THIS WELL

40

18. DISTANCE FROM PROPOSED LOCATION* TO NEAREST WELL, DRILLING, COMPLETED, APPROXIMATELY OR APPLIED FOR, ON THIS LEASE, FT. 1200'

19. PROPOSED DEPTH

6,000

20. ROTARY OR CABLE TOOLS

Rotary from surface to 6000'

21. ELEVATIONS (Show whether DF, RT, GR, etc.)

GR-3772

22. APPROX. DATE WORK WILL START*

October 15, 1974

23.

PROPOSED CASING AND CEMENTING PROGRAM

SIZE OF HOLE	SIZE OF CASING	WEIGHT PER FOOT	SETTING DEPTH	QUANTITY OF CEMENT
11"	8-5/8"	24#	400	300 sx
7-7/8"	5-1/2"	15.5#	6,000	700 sx

The above well will be drilled in accordance with safe practices known to industry using blowout preventers for proper well control. The above casing program will be used except that 5-1/2" casing will be run only if zones are determined to be commercial.

Blowout preventers will be used after setting 8-5/8" surface casing and until total depth is reached. The preventer equipment will be pneumatic controlled and contain hand wheels for manual operation. The preventer equipment will be tested at regular intervals during drilling operations to insure proper working conditions.

IN ABOVE SPACE DESCRIBE PROPOSED PROGRAM: If proposal is to deepen or plug back, give data on present productive zone and proposed new productive zone. If proposal is to drill or deepen directionally, give pertinent data on subsurface locations and measured and true vertical depths. Give blowout preventer program, if any.

24.

SIGNED T. D. Clay T. D. ClayTITLE Petroleum EngineerDATE 9-6-74

(This space for Federal or State office use)

PERMIT NO. _____

APPROVED DATE

APPROVED BY _____

TITLE _____

DATE _____

CONDITIONS OF APPROVAL, IF ANY:

APPROVED
SEP 26 1974
ARTHUR R. BROWN
DISTRICT ENGINEER

*See Instructions On Reverse Side

NEW MEXICO OIL CONSERVATION COMMISSION
WELL LOCATION AND ACREAGE DEDICATION PLAT

All distances must be from the outer boundary of the Section

THE SUPERIOR OIL COMPANY

GOVERNMENT "E"

3

B

25

19 SOUTH

34 EAST

LEA

990

NORTH

1980

EAST

3771.5'

San Andres

Lea

40

1. Indicate the acreage dedicated to the subject well by colored pencil or hatchure marks on the plat below.
2. If more than one lease is dedicated to the well, outline each and identify the ownership thereof (both as to leasehold interest and royalty).
3. If more than one lease of different ownership is dedicated to the well, have the interests of all owners listed and state whether communitization, unitization, force pooling, etc?

Government Lease NM-086

X Yes No If answer is "yes" specify consolidation. Includes 640 acres and no communitization required.

If answer is "no" list the owners and tract descriptions which have actually been consolidated (if same reverse side of this form is necessary).

If no water will be assigned to the well until all interests have been consolidated (by communitization, unitization, force pooling, etc.) otherwise for until a non-standard unit, eliminating such interests, has been approved by the Commission.

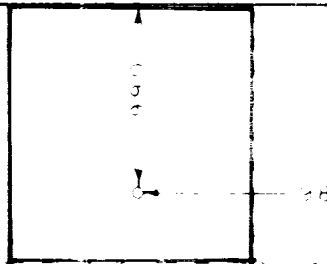

The Superior Oil Company (Lessee)
U. S. Government NM-086 (Lessor)
640 Acres in Section 25, T-19-S, R-34-E
that is HBP.

CERTIFICATION

I hereby certify that the information furnished hereon is true and correct to the best of my knowledge and belief.

T. D. Clay

T. D. Clay

Petroleum Engineer

The Superior Oil Company

9-9-74

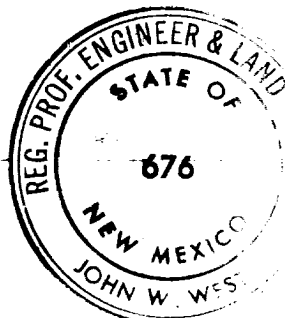

AUGUST 31, 1974

John W. Wess

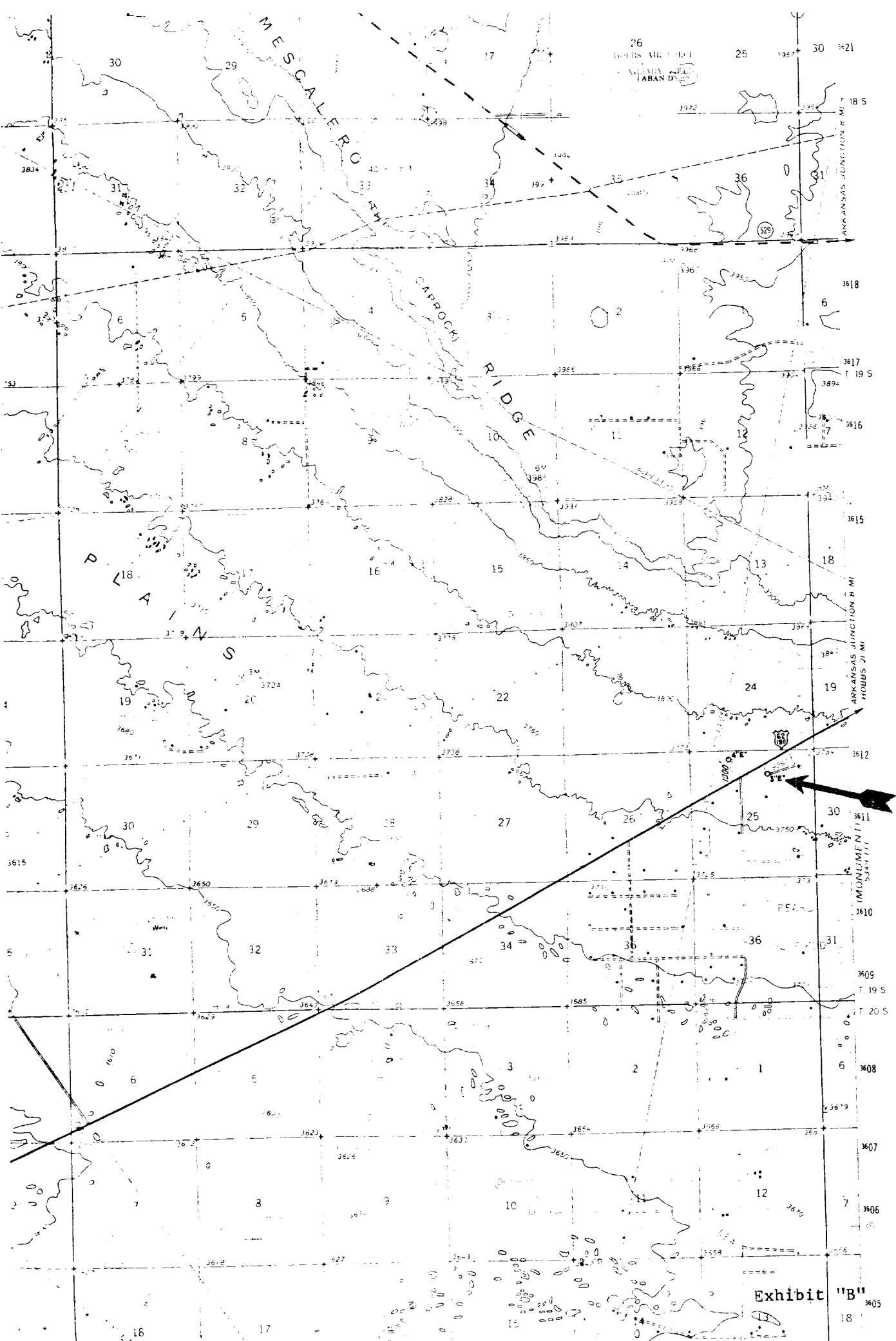

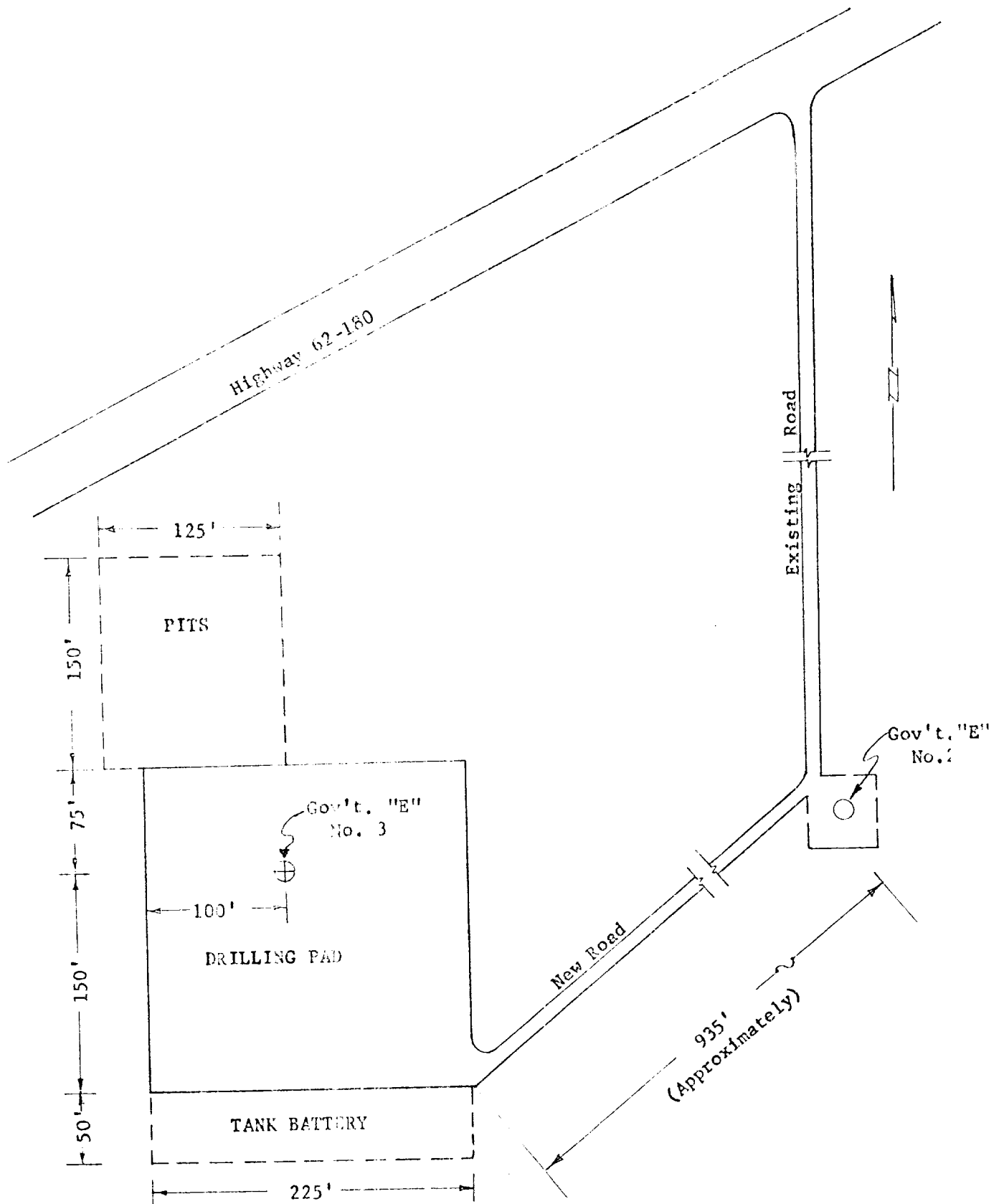

The Superior Oil Co.
GOVERNMENT "E" No. 3
 990' FNL & 1980' FEL
 Sec. 25, T-19-S, R-34-E
 Lea County, New Mexico

Exhibit "A"

SUPERIOR GOVERNMENT "E" NO. 3 WELL
990' FNL & 1950' FEL Section 25, T-19-S, R-34-E
Lea (San Andres) Field
Lea County, New Mexico

0 to 400' or 8-5/8" Casing Shoe:

Drill 11" hole with fresh water with gel and lime added along with fiber and cottonseed hulls for possible fluid loss.

400' to 6000' or 5-1/2" Casing Shoe:

Drill with brine water to prevent abnormal leaching of salt and anhydrite section. Maintain viscosity at 30-35 cp for cleaning hole and water loss at 10-12 cc when drilling thru potential pay zones.

TDC/wcm
9-18-74

THE SUPERIOR OIL COMPANY

P. O. BOX 1900
MIDLAND, TEXAS 79701

September 18, 1974

Mr. A. R. Brown
U.S.G.S.
P. O. Box 1157
Hobbs, New Mexico

Re: Government "E" No. 3
990' FNL & 1980' FEL
Section 25, T-19-S, R-34-E
Lea (San Andres) Field
Lea County, New Mexico

Dear Sir:

Regarding the above captioned proposed 6000' well, we plan to operate and oversee this operation and abide by environmental guidelines as follows:

1. Proposed road into drilling pad is shown on Exhibit "A" and existing highways and roads are shown on Exhibit "B".
2. Size of drilling pad and pits relative to roads are shown on Exhibit "A".
3. Proposed Government "E" No. 3 Well is located approximately 1200 feet from nearest tank battery located in the NE NE Section 25, T-19-S, R-34-E and serves Superior Government "E" No. 2 Well.
4. Source of water supply for drilling: Water will be hauled by truck.
5. Trash on location will be put in reserve pit and covered with dirt.
6. If well is plugged and abandoned, earth pits will be filled with dirt and location restored to original contour.
7. If well is completed as a producer, earth pits will be filled with dirt and location restored. Tank battery will be located as shown on Exhibit "A" and any produced water will be stored in tank until hauled to an approved disposal well.
8. Development plans: Government "E" No. 3 Well will be drilled first and followed by Government "E" No. 4 Well in NE NW Section 25.
9. Regarding oil or gas that may be produced during drilling or completion operations, this hydrocarbon will be piped a safe distance from drilling rig and burned or contained in storage. Blowout preventers consisting of blind and pipe rams will be used during drilling operations to provide safety and prevent spillage.

Very truly yours,

THE SUPERIOR OIL COMPANY

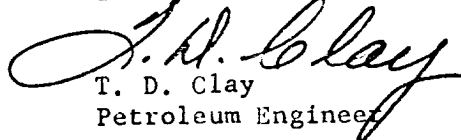
T. D. Clay
Petroleum Engineer

TDC/wcm
Attachments