

UNITED STATES
DEPARTMENT OF THE INTERIOR
GEOLOGICAL SURVEY

APPLICATION FOR PERMIT TO DRILL, DEEPEN, OR PLUG BACK

1a. TYPE OF WORK DRILL <input checked="" type="checkbox"/> DEEPEN <input type="checkbox"/> PLUG BACK <input type="checkbox"/>		5. LEASE DESIGNATION AND SERIAL NO. NM-086
b. TYPE OF WELL OIL WELL <input checked="" type="checkbox"/> GAS WELL <input type="checkbox"/> OTHER <input type="checkbox"/>		6. IF INDIAN, ALLOTTEE OR TRIBE NAME
2. NAME OF OPERATOR The Superior Oil Company		7. UNIT AGREEMENT NAME
3. ADDRESS OF OPERATOR P. O. Box 1900, Midland, Texas 79701		8. FARM OR LEASE NAME Government "E"
4. LOCATION OF WELL (Report location clearly and in accordance with any State requirements.)* At surface 1650' FNL and 2310' FEL, Section 25, T-19-S, R-34-E At proposed prod. zone Same as above		9. WELL NO. 5
14. DISTANCE IN MILES AND DIRECTION FROM NEAREST TOWN OR POST OFFICE* 8 miles Southwest of Arkansas Junction		10. FIELD AND POOL, OR WILDCAT Undesignated Lea (San Andres)
15. DISTANCE FROM PROPOSED* LOCATION TO NEAREST PROPERTY OR LEASE LINE, FT. (Also to nearest drlg. unit line, if any) unit 330' from dedicated 40 acre proration	16. NO. OF ACRES IN LEASE 640	11. SEC., T., R., M., OR BLK. AND SURVEY OR AREA Section 25, T-19-S, R34E
18. DISTANCE FROM PROPOSED LOCATION* TO NEAREST WELL, DRILLING, COMPLETED, OR APPLIED FOR, ON THIS LEASE, FT. Approx 738'	19. PROPOSED DEPTH 6200	12. COUNTY OR PARISH Lea
21. ELEVATIONS (Show whether DF, RT, GR, etc.) 3767' GR		13. STATE New Mexico
22. APPROX. DATE WORK WILL START* August 5, 1975		

PROPOSED CASING AND CEMENTING PROGRAM

SIZE OF HOLE	SIZE OF CASING	WEIGHT PER FOOT	SETTING DEPTH	QUANTITY OF CEMENT
11"	8 5/8"	24#	400'	300 sx circulated
7 7/8"	5 1/2"	15.5#	6200'	700 sx

The above well will be drilled using safe practices known to industry using blowout preventers for proper well control. The above casing program will be used except that 5 1/2" casing will be run only if Zones are determined to be commercial.

Blowout preventers will be used after setting 8 5/8" surface casing and until total depth is reached. The preventer equipment will be pneumatic controlled and contain hand wheels for manual operation. The preventer equipment will be tested at regular intervals during drilling operations to insure proper working conditions. Preventer equipment will be same as current drilling Government "E" No. 4 well.

IN ABOVE SPACE DESCRIBE PROPOSED PROGRAM: If proposal is to deepen or plug back, give data on present productive zone and proposed new productive zone. If proposal is to drill or deepen directionally, give pertinent data on subsurface locations and measured and true vertical depths. Give blowout preventer program, if any.

24. T. D. Clay T. D. Clay TITLE Petroleum Engineer DATE July 25, 1975
(This space for Federal or State office use)

PERMIT NO. _____ APPROVAL DATE APPROVED
APPROVED BY _____ TITLE _____
CONDITIONS OF APPROVAL, IF ANY: _____

*See Instructions On Reverse Side

NEW MEXICO OIL CONSERVATION COMMISSION
WELL LOCATION AND ACREAGE DEDICATION PLAT

Form O-102
Supersedes O-128
Effective 1-1-65

All distances must be from the outer boundaries of the Section

The Superior Oil Company		Government E		Well No. 5	
G	25	19 South	34 East	Lea	
1650	feet from line	North	2310	feet from line	East
3767.4	San Andres	Lea	40		

- Outline the acreage dedicated to the subject well by colored pencil or hatchure marks on the plat below
- If more than one lease is dedicated to the well, outline each and identify the ownership thereof (both as to working interest and royalty)
- If more than one lease of different ownership is dedicated to the well, have the interests of all owners been consolidated by communitization, unitization, forced-pooling, etc?

Government Lease NM-086 includes 640

Yes ☐ No ☐ If answer is "yes" type of consolidation acres and no communitization required.

If answer is "no," list the owners and tract descriptions which have actually been consolidated. (Use reverse side of this form if necessary.)

No allowable will be assigned to the well until all interests have been consolidated (by communitization, unitization, forced-pooling, or otherwise) or until a non-standard unit, eliminating such interests, has been approved by the Commission.

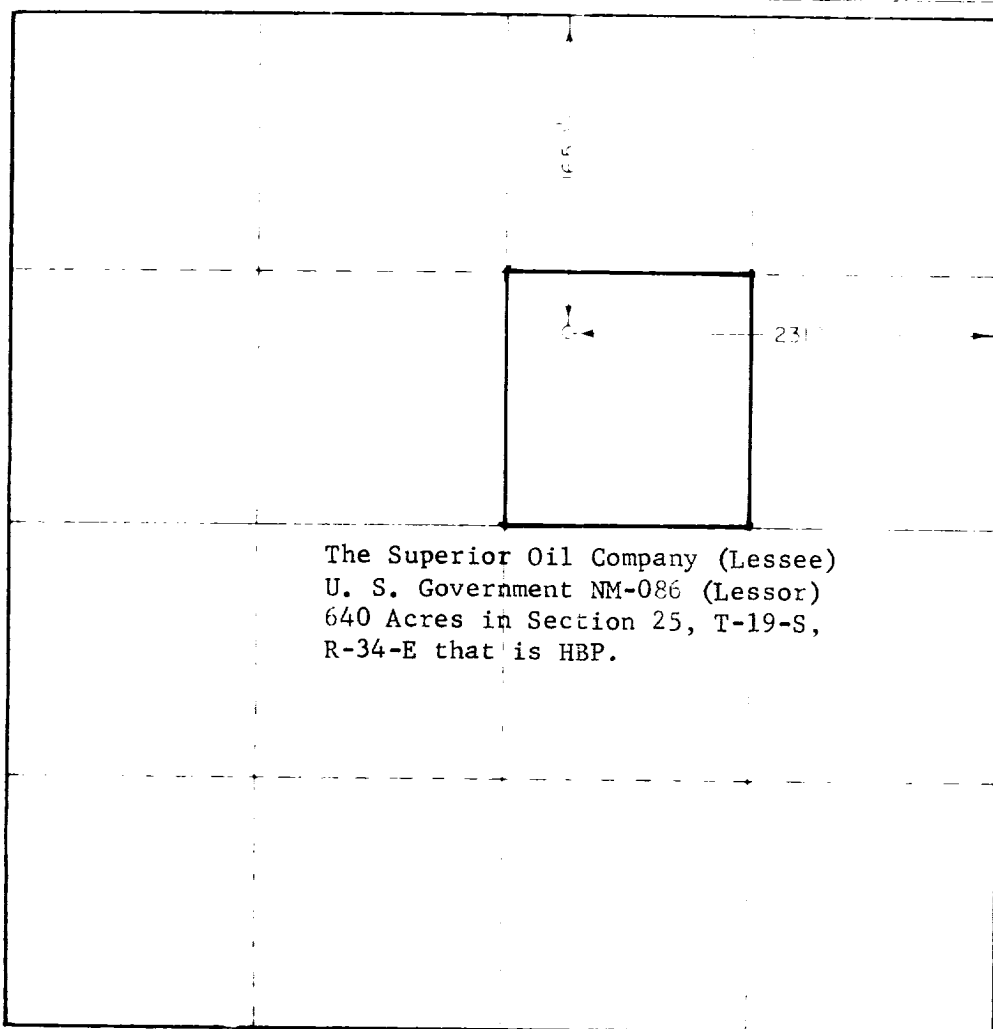

CERTIFICATION

I hereby certify that the information contained herein is true and complete to the best of my knowledge and belief.

D. H. Collins, Jr.

D. H. Collins, Jr.

District Engineer

The Superior Oil Company

July 28, 1975

I hereby certify that the well location shown on this plat was plotted from field notes of actual surveys made by me or under my supervision, and that the same is true and correct to the best of my knowledge and belief.

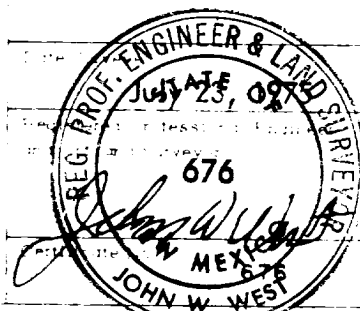

330 560 900 1200 1600 1900 2310 2640 2000 1500 1000 500

THE SUPERIOR OIL COMPANY

P. O. BOX 1900
MIDLAND, TEXAS 79701

July 25, 1975

U.S.G.S.
P. O. Box 1157
Hobbs, New Mexico 88240

Attention: Mr. A. R. Brown

Re: Government "E" No. 5
1650' FNL & 2310' FEL
Section 25, T-19-S, R-34-E
Lea (San Andres) Field
Lea County, New Mexico

Gentlemen:

Regarding the above captioned proposed 6200' well, we plan to operate and oversee this operation and abide by environmental guidelines as follows:

1. Proposed road into drilling pad is shown on Exhibit "A" and existing highways and roads are shown on Exhibit "B".
2. Size of drilling pad and pits relative to roads are shown on Exhibit "A".
3. Proposed Government "E" No. 5 Well is located approximately 738 feet from nearest well located in the NW NE Section 25, T-19-S, R-34-E. Nearest tank battery under Superior's operations is at Government "E" No. 2 Well or some 1700' from proposed Government "E" No. 5 Well. A salt water collection tank is located some 500' southeast of proposed well.
4. Source of water supply for drilling: Water will be hauled by truck.
5. Trash on location will be put in reserve pit and covered with dirt.
6. If well is plugged and abandoned, earth pits will be filled with dirt and location restored to original contour.
7. If well is completed as a producer, earth pits will be filled with dirt and location restored. Tank battery will be located as shown on Exhibit "A" or production will be commingled at Government "E" No. 2 tank battery. Produced water will be stored in tank until hauled to an approved disposal well.
8. Development plans: Government "E" No. 5 Well will be drilled and possibly next well will be drilled in SE NW Section 25.

9. Regarding oil or gas that may be produced during drilling or completion operations, this hydrocarbon will be piped a safe distance from drilling rig and burned or contained in storage. Blowout preventers consisting of blind and pipe rams will be used during drilling operations to provide safety and prevent spillage.

Very truly yours,

THE SUPERIOR OIL COMPANY

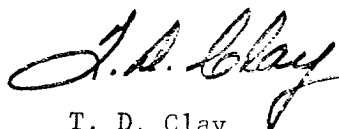
A handwritten signature in cursive script, appearing to read "T. D. Clay".

T. D. Clay
Petroleum Engineer

TDC/jf

THE SUPERIOR OIL COMPANY

GOVERNMENT "E" NO. 5 WELL

1650' FNL & 2310' FEL SECTION 25, T-19-S, R-34-E
LEA (SAN ANDRES) FIELD
LEA COUNTY, NEW MEXICO

0 to 400' or 8-5/8" Casing Shoe:

Drill 11" hole with fresh water with gel and lime added along with fiber and cottonseed hulls for possible fluid loss.

400' to 6200' or 5-1/2" Casing Shoe:

Drill with brine water to prevent abnormal leaching of salt and anhydrite section. Maintain viscosity at 30 - 35 cp for cleaning hole and water loss at 10 - 12 cc when drilling thru potential pay zones.

TDC/jf
7-25-75

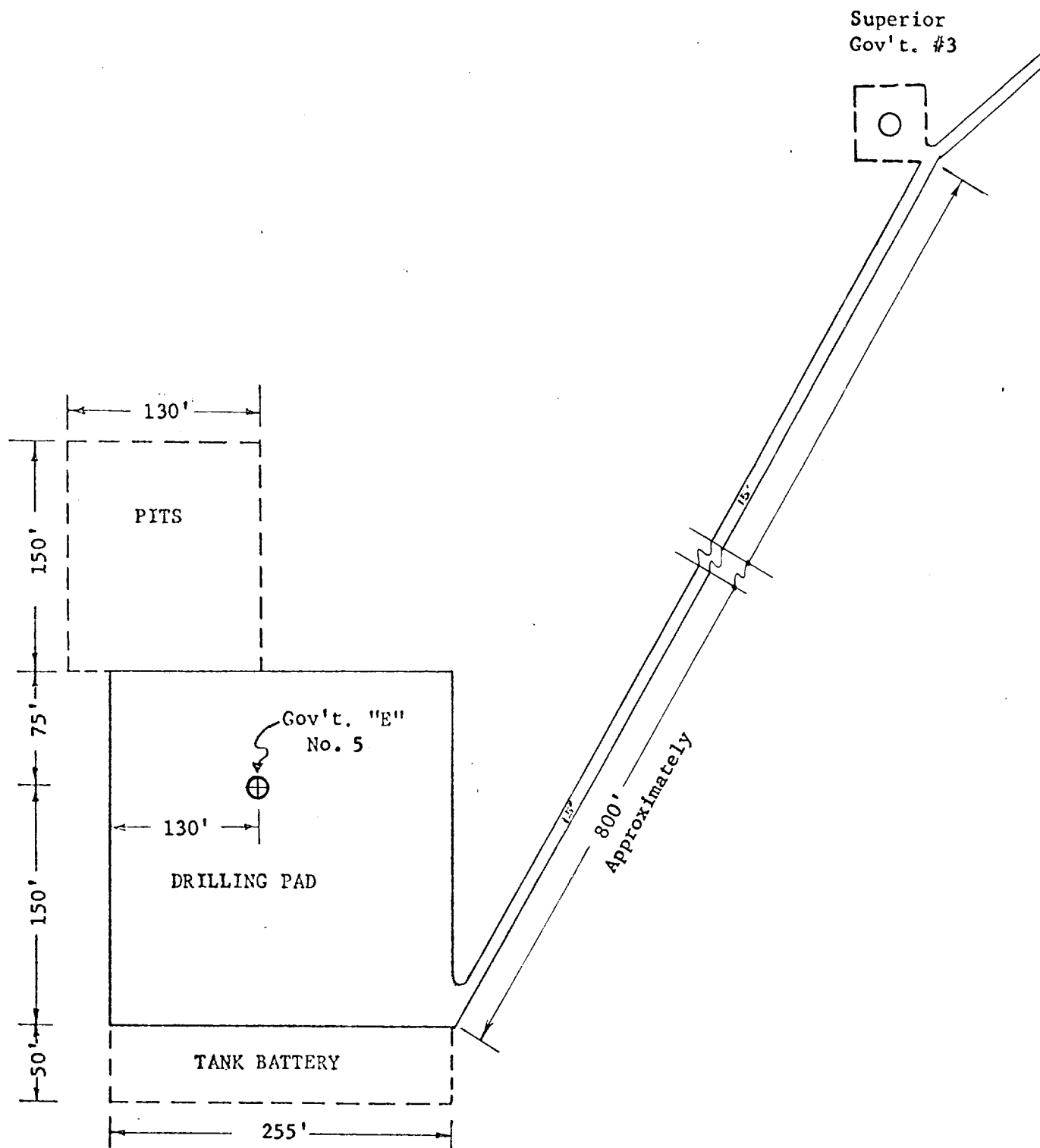

The Superior Oil Co.

GOVERNMENT "E" No. 5

1650' FNL & 2310' FEL

Sec. 25, T-19-S, R-34-E

Lea County, New Mexico

Exhibit "A"

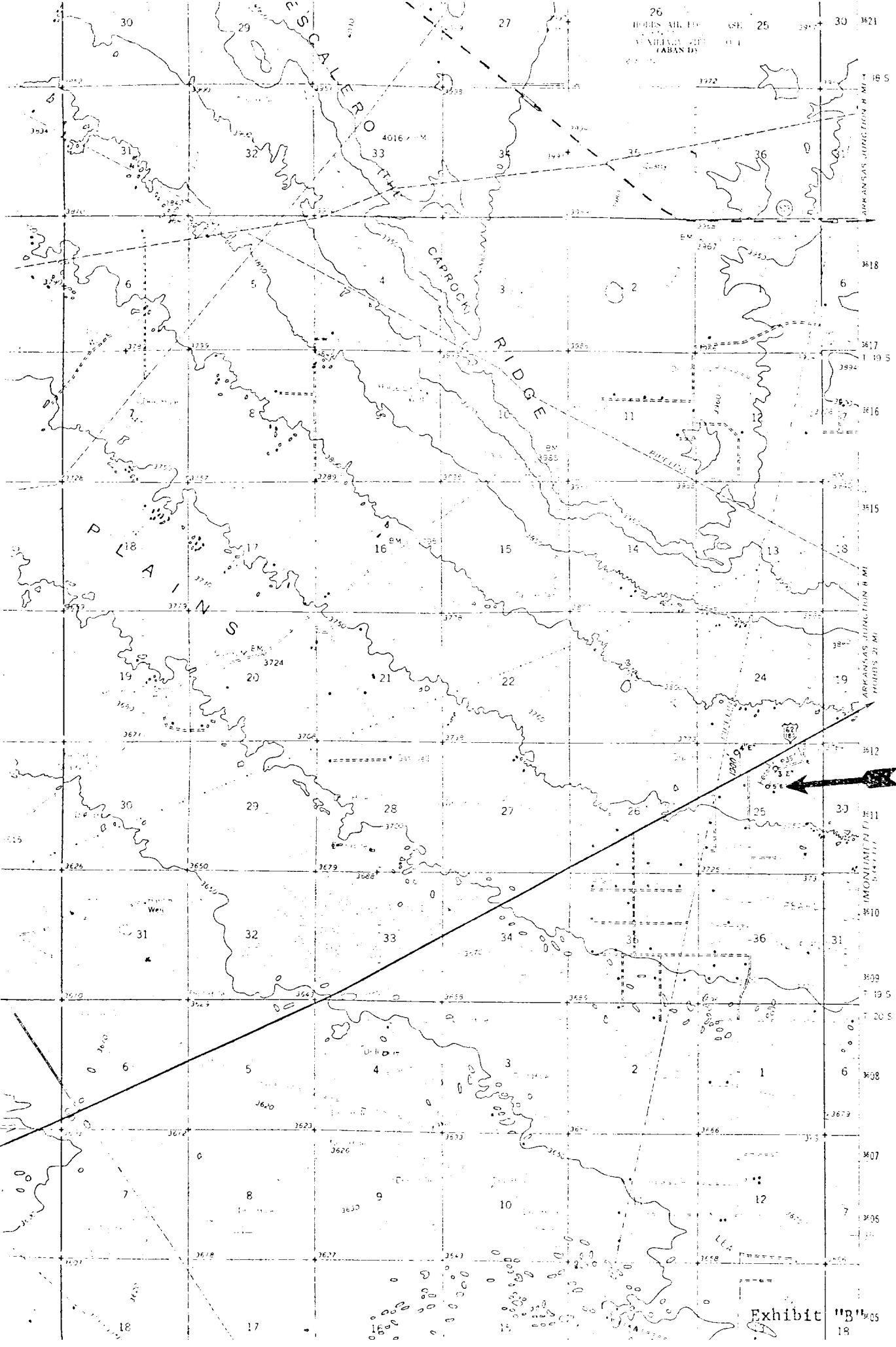

26
HOBBS AIR FLD
VILLAGE
CABANOS
25
30
3621
18 S
19 S
20 S
21 S
26
27
28
29
30
31

Exhibit "B" 05
18