

UNITED STATES
DEPARTMENT OF THE INTERIOR
GEOLOGICAL SURVEY

APPLICATION FOR PERMIT TO DRILL, DEEPEN, OR PLUG BACK

1a. TYPE OF WORK

DRILL ☒DEEPEN ☐PLUG BACK ☐

b. TYPE OF WELL

OIL
WELL ☒GAS
WELL ☐

OTHER

SINGLE
ZONE ☒MULTIPLE
ZONE ☐

2. NAME OF OPERATOR

The Superior Oil Company

3. ADDRESS OF OPERATOR

P. O. Box 1900, Midland, Texas 79701

4. LOCATION OF WELL (Report location clearly and in accordance with any State requirements.*)

At surface

1800' FNL & 990' FEL Sect. 25, T-19-S, R-34-E

At proposed prod. zone

Same as above

14. DISTANCE IN MILES AND DIRECTION FROM NEAREST TOWN OR POST OFFICE*

8 miles southwest of Arkansas Junction

15. DISTANCE FROM PROPOSED* 330' from dedicated
LOCATION TO NEAREST
PROPERTY OR LEASE LINE, FT. 40 acre proration unit
(Also to nearest drlg. unit line, if any)16. NO. OF ACRES IN LEASE
64017. NO. OF ACRES ASSIGNED
TO THIS WELL
4018. DISTANCE FROM PROPOSED LOCATION*
TO NEAREST WELL, DRILLING, COMPLETED,
OR APPLIED FOR, ON THIS LEASE, FT.

Approx 1000'

19. PROPOSED DEPTH
6,20020. ROTARY OR CABLE TOOLS
Rotary 0-6200'

21. ELEVATIONS (Show whether DF, RT, GR, etc.)

GR - 3767

KB - 3779 (Est.)

22. APPROX. DATE WORK WILL START*

Sept. 3, 1975

23.

PROPOSED CASING AND CEMENTING PROGRAM

SIZE OF HOLE	SIZE OF CASING	WEIGHT PER FOOT	SETTING DEPTH	QUANTITY OF CEMENT
11"	8-5/8"	24#	400'	300 sx circulated
7-7/8"	5-1/2"	15.5#	6200'	700 sx

The above well will be drilled using accepted and safe practices known to industry using blowout preventers and Hydril for proper well control. The above casing program will be used except that 5-1/2" casing will be run only if objective zones are determined to be commercial.

Blowout preventers and Hydril will be installed after setting 8-5/8" surface casing and until total depth is reached. The preventer equipment will be pneumatic controlled and contain hand wheels for manual operation. The preventer equipment will be tested at regular intervals during drilling operations to insure proper working conditions. Preventer equipment will be same as current drilling Government "E" No. 5 well.

Cement to be 5 1/2" casing
must fill to 6 mi salt

SEE ATTACHED FOR
CONDITIONS OF APPROVAL

IN ABOVE SPACE DESCRIBE PROPOSED PROGRAM: If proposal is to deepen or plug back, give data on present productive zone and proposed new productive zone. If proposal is to drill or deepen directionally, give pertinent data on subsurface locations and measured and true vertical depths. Give blowout preventer program, if any.

24.

SIGNED T. D. Clay T. D. Clay TITLE Petroleum Engineer

DATE August 28, 1975

(This space for Federal or State office use)

PERMIT NO. _____

APPROVAL DATE _____

APPROVED BY _____

TITLE _____

CONDITIONS OF APPROVAL, IF ANY: _____

*See Instructions On Reverse Side

SEP 15 1975
J. H. Sims
J. H. SIMS
J. H. SIMS

NEW U.S. GEOLOGICAL SURVEY OIL CONSERVATION COMMISSION
WELL LOCATION AND ACREAGE DEDICATION PLAT

Form 7-61-2
Supersedes 6-12-64
Effective 1-1-65

All distances must be from the outer boundaries of the Section

The Superior Oil Company			Government E		6
H	25	19 South	34 East	Lea	
1800	North		990	East	
3766.9	SAN ANDRES		LEA (SAN ANDRES)		40

- Outline the acreage dedicated to the subject well by colored pencil or hatchure marks on the plat below.
- If more than one lease is dedicated to the well, outline each and identify the ownership thereof (both as to working interest and royalty).
- If more than one lease of different ownership is dedicated to the well, have the interests of all owners been consolidated by communitization, unitization, forced pooling, etc?

☒ Yes ☐ No If answer is "yes" specify consolidation **Government Lease NM-086 includes 640 acres and no communitization required**

If answer is "no" list the owners and tract descriptions which have actually been consolidated (Use reverse side of this form if necessary)

No allowable will be assigned to the well until all interests have been consolidated (by communitization, unitization, forced-pooling, or otherwise) or until a non-standard unit, eliminating such interests, has been approved by the Commission.

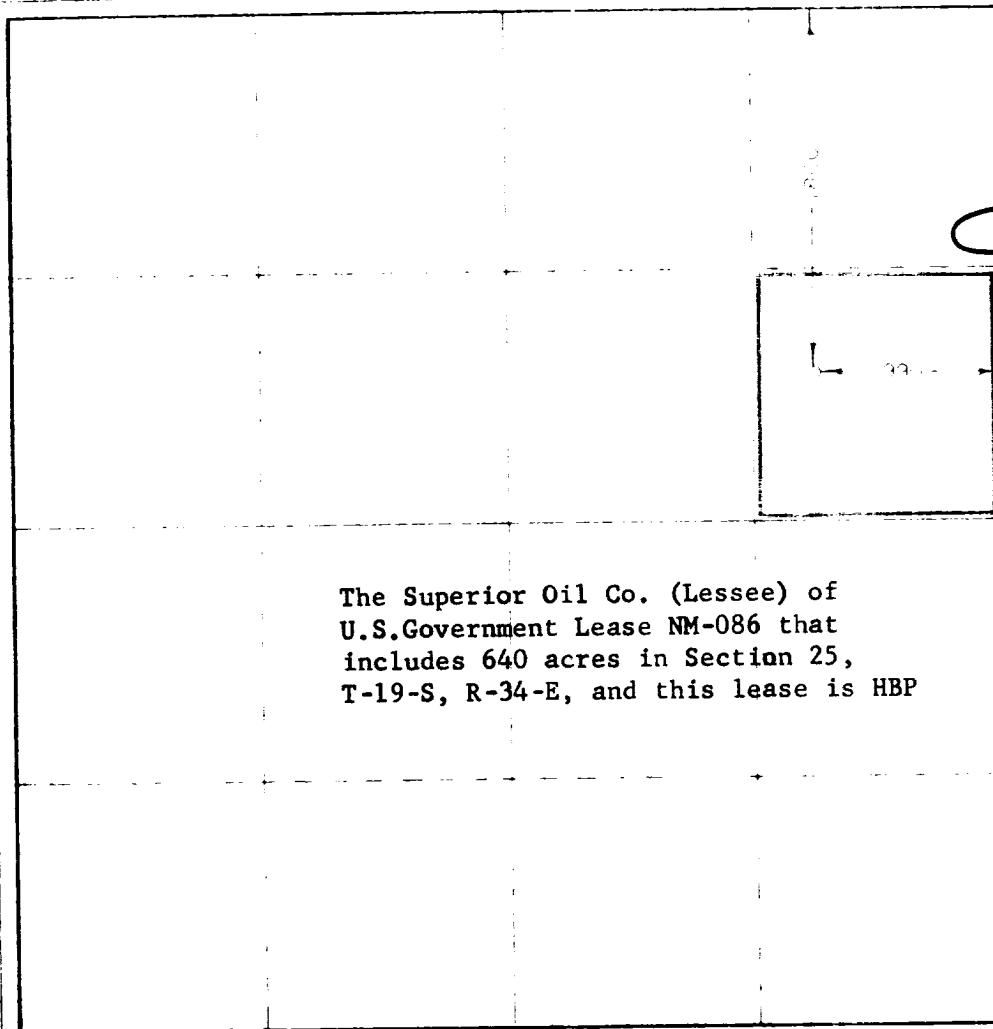

CERTIFICATION

I hereby certify that the information contained herein is true and complete to the best of my knowledge and belief.

T.D. Clay
T.D. Clay
Petroleum Engineer

The Superior Oil Co.

Aug 28, 1975

I hereby certify that the well location shown on this plat was plotted from text notes of actual surveys made by me or under my supervision and that the same is true and correct to the best of my knowledge and belief.

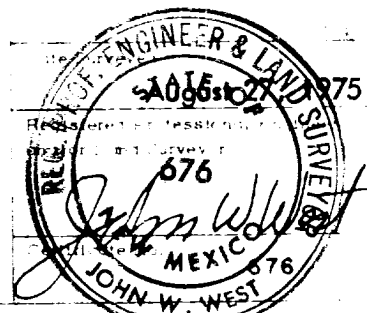

0 330 660 990 1320 1650 1980 2310 2640 2970 3300 3630 3960 4290 4620 4950 5280 5610 5940 6270 6600

THE SUPERIOR OIL COMPANY

P. O. BOX 1900
MIDLAND, TEXAS 79701

August 28, 1975

U.S.G.S.
P. O. Box 1157
Hobbs, New Mexico 88240

Attention: Mr. A. R. Brown

Re: Government "E" No. 6
1800' FNL & 990' FEL
Section 25, T-19-S, R-34-E
Lea (San Andres) Field
Lea County, New Mexico

Gentlemen:

Regarding the above captioned proposed 6200' well, we plan to operate and oversee this operation and abide by environmental guidelines as follows:

1. Proposed road into drilling pad is shown on Exhibit "A" and existing highways and roads are shown on Exhibit "B".
2. Size of drilling pad and pits relative to roads are shown on Exhibit "A".
3. Proposed Government "E" No. 6 Well is located approximately 1,000 feet from nearest Superior Oil Company well located in the NE NE Section 25, T-19-S, R-34-E. Nearest tank battery under Superior's operations is at Government "E" No. 2 Well or some 1,000' from proposed Government "E" No. 6 Well.
4. Source of water supply for drilling: Water will be hauled by truck.
5. Trash on location will be put in reserve pit and covered with dirt. DIRT AND JUNK SHOULD BE
BUNDLED IN A SEPARATE TRASH PIT
6. If well is plugged and abandoned, earth pits will be filled with dirt and location restored to original contour.
7. If well is completed as a producer, earth pits will be filled with dirt and location restored. Tank battery will be located as shown on Exhibit "A" or production will be commingled at Government "E" No. 2 tank battery. Produced water will be stored in tank until hauled or piped to an approved disposal well.
8. Development plans: Government "E" No. 6 Well will be drilled pending the outcome of logs and drilling samples at current drilling Government "E" No. 5 well.

9. Regarding oil or gas that may be produced during drilling or completion operations, this hydrocarbon will be piped a safe distance from drilling rig and burned or contained in storage. Blowout preventers consisting of blind and pipe rams will be used during drilling operations to provide safety and prevent spillage.

Very truly yours,

THE SUPERIOR OIL COMPANY

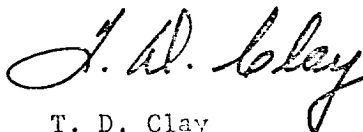
A handwritten signature in cursive script, reading "T. D. Clay".

T. D. Clay
Petroleum Engineer

TDC/pt

1800' FNL & 990' FEL, Sec.25, T-19-S R-34-E
Lea County, New Mexico

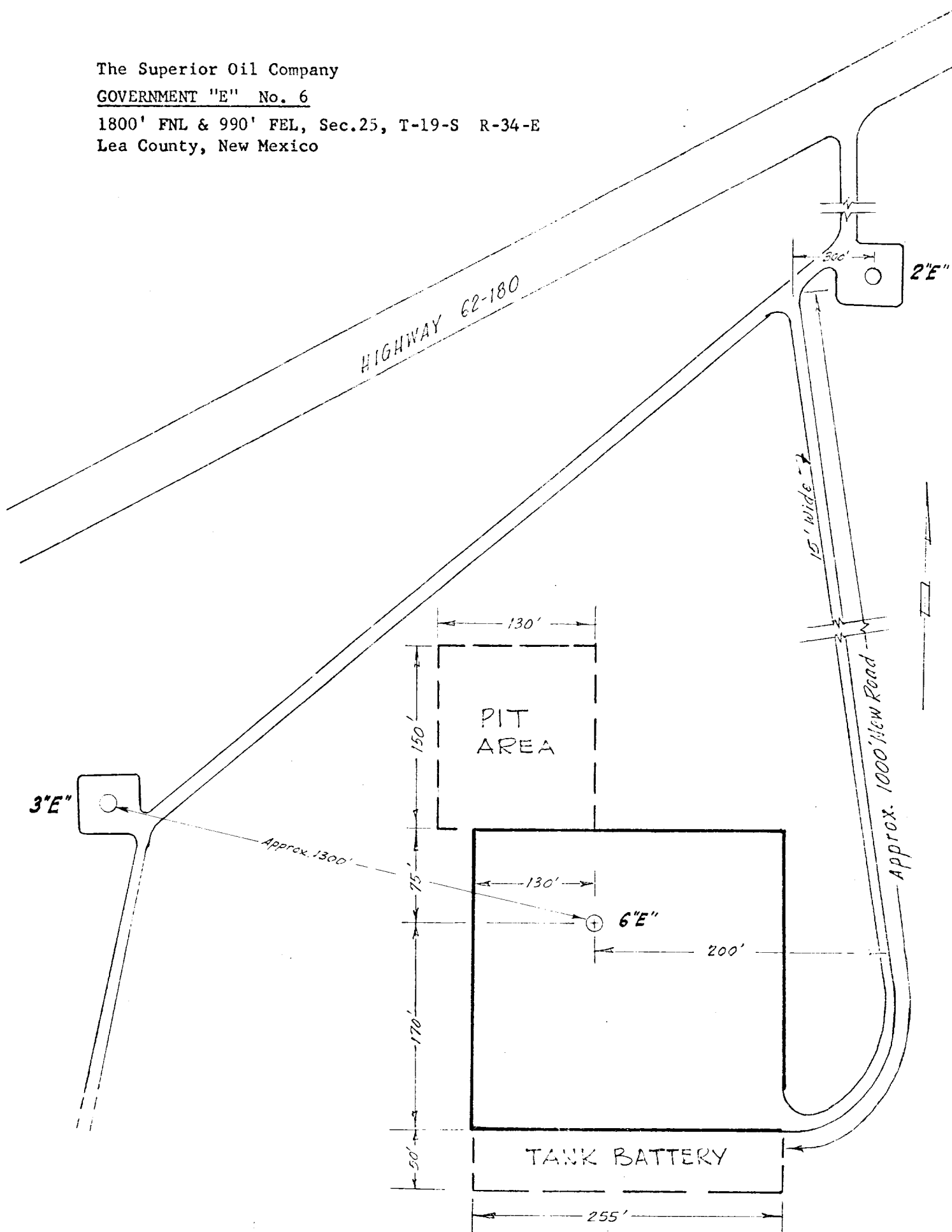
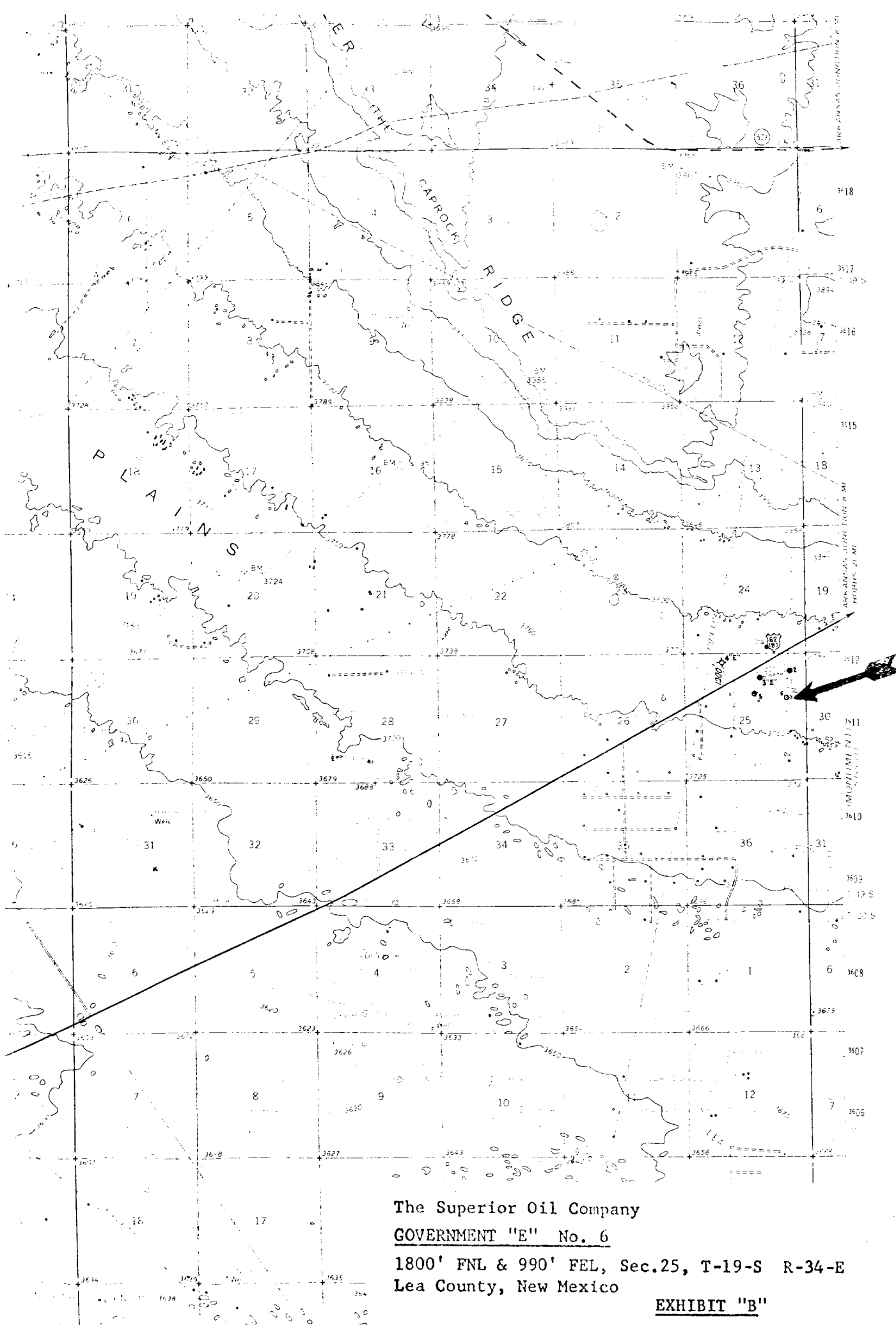

EXHIBIT "A"



The Superior Oil Company

GOVERNMENT "E" No. 6

1800' FNL & 990' FEL, Sec.25, T-19-S R-34-E
Lea County, New Mexico

EXHIBIT "B"

THE SUPERIOR OIL COMPANY

GOVERNMENT "E" NO. 6 WELL
1800' FNL & 990' FEL SECTION 25, T-19-S, R-34-E
LEA (SAN ANDRES) FIELD
LEA COUNTY, NEW MEXICO

0 to 400' or 8-5/8" Casing Shoe:

Drill 11" hole with fresh water with gel and lime added along with fiber and cottonseed hulls for possible fluid loss.

400' to 6200' or 5-1/2" Casing Shoe:

Drill with brine water to prevent abnormal leaching of salt and anhydrite section. Maintain viscosity at 30 - 35 cp for cleaning hole and water loss at 10 - 12 cc when drilling thru potential pay zones.