

STATE OF NEW MEXICO
ENERGY AND MINERALS DEPARTMENT

OIL CONSERVATION DIVISION
P. O. BOX 2088
SANTA FE, NEW MEXICO 87501

Form C-101
Revised 10-1-78

NO. OF COPIES RECEIVED	
DISTRIBUTION	
SANTA FE	
FILE	
U.S.G.S.	
LAND OFFICE	
OPERATOR	

5A. Indicate Type of Lease
STATE ☐ FEE ☒

5. State Oil & Gas Lease No.

APPLICATION FOR PERMIT TO DRILL, DEEPEN, OR PLUG BACK

1a. Type of Work DRILL <input checked="" type="checkbox"/> RE-ENTER <input type="checkbox"/> DEEPEN <input type="checkbox"/> PLUG BACK <input type="checkbox"/>		7. Unit Agreement Name
b. Type of Well OIL WELL <input checked="" type="checkbox"/> GAS WELL <input type="checkbox"/> OTHER <input type="checkbox"/> SINGLE ZONE <input checked="" type="checkbox"/> MULTIPLE ZONE <input type="checkbox"/>		8. Farm or Lease Name HIGHTOWER
2. Name of Operator TXO PRODUCTION CORP.		9. Well No. 1
3. Address of Operator 900 WILCO BUILDING, MIDLAND, TEXAS 79701		10. Field and Pool, or Wildcat SHIPP STRAWN
4. Location of Well UNIT LETTER A LOCATED 810 FEET FROM THE NORTH LINE AND 660 FEET FROM THE EAST LINE OF SEC. 4 TWP. 17-S RCE. 37-E NMPM		12. County LEA
11. Elevations (Show whether DF, KT, etc.) 3778.3' GL		19. Proposed Depth 11,400'
21A. Kind & Status Plug. Bond BLANKET		19A. Formation STRAWN
21B. Drilling Contractor NOT SELECTED		20. Rotary or C.T. ROTARY
22. Approx. Date Work will start UPON APPROVAL		

23.

PROPOSED CASING AND CEMENT PROGRAM

SIZE OF HOLE	SIZE OF CASING	WEIGHT PER FOOT	SETTING DEPTH	SACKS OF CEMENT	EST. TOP
17-1/2"	*13-3/8"	48#	375'	400	SURFACE
11"	* 8-5/8"	24# & 32#	4190'	400	1100'
7-7/8"	5-1/2"	17#	11,400'	300	9700'

*THIS CASING SET AND CEMENTED WHEN WELL DRILLED ORIGINALLY. HOWEVER, WHEN WELL WAS PLUGGED AND ABANDONED, 8-5/8" CASING WAS CUT AND PULLED FROM A DEPTH OF 1089 FEET.

PLANS ARE TO DRILL OUT PLUGS TO CASING STUB, EXTEND 8-5/8" CASING TO SURFACE, AND CEMENT TO SURFACE THROUGH PERFS AT ABOUT 1140 FEET. WILL THEN DRILL OUT REMAINING PLUGS TO TOTAL DEPTH AND DEEPEN FROM 8606 TO APPROXIMATELY 9600 FEET WHERE WELL BORE WILL BE DEFLECTED AND DRILLED IN A CONTROLLED NORTHERLY DIRECTION TO BOTTOM WELL AT A DEPTH OF APPROXIMATELY 11,400 FEET WITHIN 150 FEET OF THE CENTER OF LOT 1 (UNIT LETTER A), BEING A REGULAR OIL WELL LOCATION FOR THE SHIPP STRAWN POOL. THIS WELL WAS ORIGINALLY DRILLED BY MESA PETROLEUM COMPANY AS WELL NO.1 HIGHTOWER TO A TOTAL DEPTH OF 8606 FEET AND WAS PLUGGED AND ABANDONED 12-30-75.

NMOC ORDER R-8570 APPROVED DIRECTIONAL DRILLING AND COMPULSORY POOLING.

A BOP SKETCH IS ATTACHED.

IN ABOVE SPACE DESCRIBE PROPOSED PROGRAM; IF PROPOSAL IS TO DEEPEN OR PLUG BACK, GIVE DATA ON PRESENT PRODUCTIVE ZONE AND PROPOSED NEW PRODUCTIVE ZONE. GIVE BLOWOUT PREVENTER PROGRAM, IF ANY.

I hereby certify that the information above is true and complete to the best of my knowledge and belief.

Signed Arthur R. Brown Title Agent Date 1-11-88

(This space for State Use)

Eddie W. Seay

APPROVED BY Oil & Gas Inspector TITLE DATE

CONDITIONS OF APPROVAL, IF ANY:

JAN 13 1988

Permit Expires 6 Months From Approval
Date Unless Drilling Underway.

RECEIVED

JAN 12 1988

CLP
HOBBS OFFICE

OIL CONSERVATION DIVISION

STATE OF NEW MEXICO
ENERGY AND MINERALS DEPARTMENT

P. O. BOX 2088
SANTA FE, NEW MEXICO 87501

Form C-102
Revised 10-1-78

All distances must be from the outer boundaries of the Section.

Operator TXO PRODUCTION CORP.			Lease HIGHTOWER			Well No. 1		
Unit Letter A	Section 4	Township 17-S	Range 37-E	County LEA				
Actual Footage Location of Well: 810 feet from the NORTH line and 660 feet from the EAST line								
Ground Level Elev. 3778.3'	Producing Formation STRAWN-2			Pool SHIPP STRAWN			Dedicated Acreage: 80.95 Acres	

1. Outline the acreage dedicated to the subject well by colored pencil or hatchure marks on the plat below.
2. If more than one lease is dedicated to the well, outline each and identify the ownership thereof (both as to working interest and royalty).
3. If more than one lease of different ownership is dedicated to the well, have the interests of all owners been consolidated by communitization, unitization, force-pooling, etc?

☐ Yes ☐ No If answer is "yes," type of consolidation _____

If answer is "no," list the owners and tract descriptions which have actually been consolidated. (Use reverse side of this form if necessary.) _____

No allowable will be assigned to the well until all interests have been consolidated (by communitization, unitization, forced-pooling, or otherwise) or until a non-standard unit, eliminating such interests, has been approved by the Division.

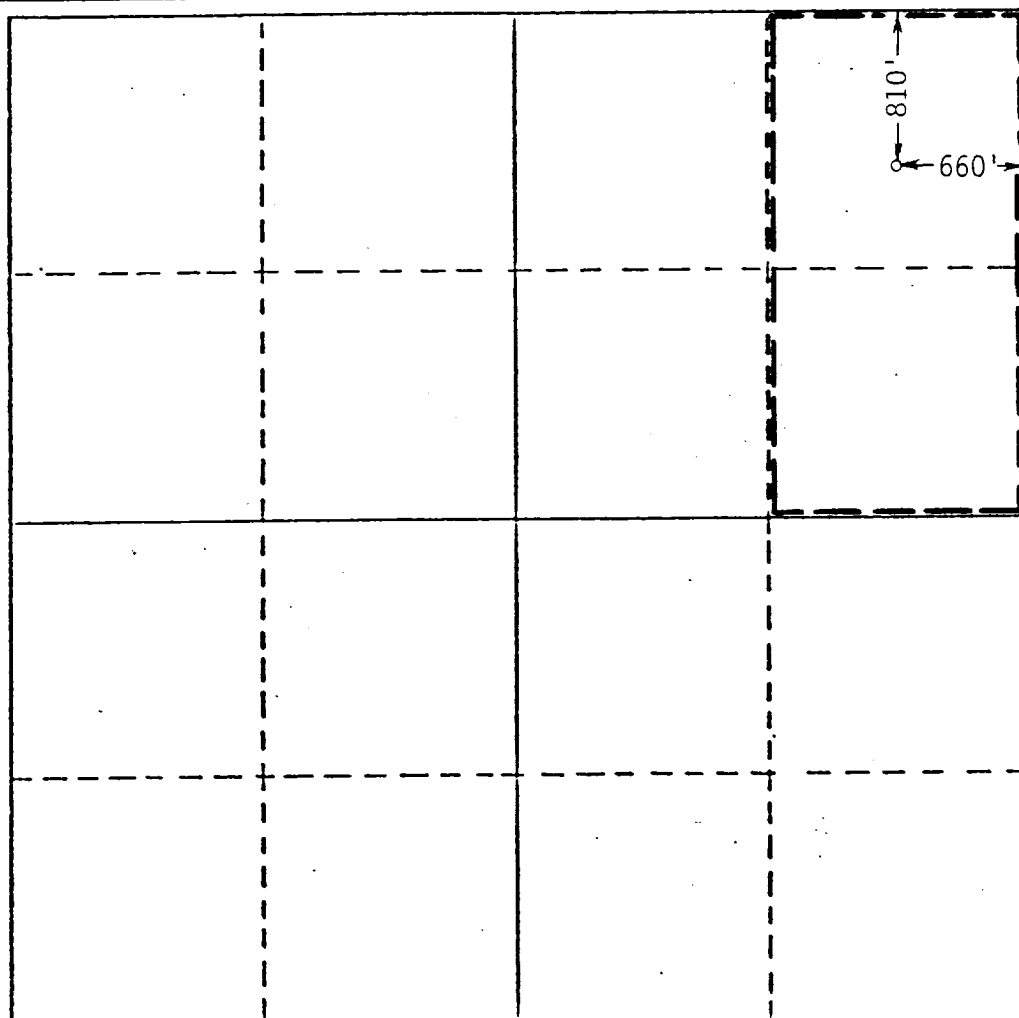

CERTIFICATION

I hereby certify that the information contained herein is true and complete to the best of my knowledge and belief.

Name Arthur R. Brown

Position
Agent

Company
TXO PRODUCTION CORP.

Date
JANUARY 11, 1988

I hereby certify that the well location shown on this plat was plotted from field notes of actual surveys made by me or under my supervision, and that the same is true and correct to the best of my knowledge and belief.

Date Surveyed
SEPTEMBER 18, 1975

Registered Professional Engineer and/or Land Surveyor

SEE ORIGINAL PLAT

Certificate No.

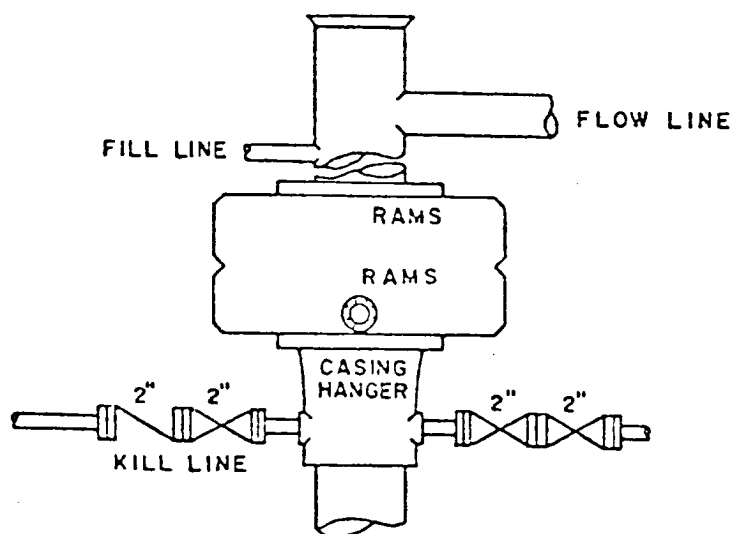

BOP STACK

3000 PSI WORKING PRESSURE

BOP ARRANGEMENT

RECEIVED

JAN 12 1988

CCD
HOBBS OFFICE