

NO. COPIES RECEIVED	
DISTRIBUTION	
SANTA FE	
FILE	
U.S.G.S.	
LAND OFFICE	
OPERATOR	

# NEW MEXICO OIL CONSERVATION COMMISSION

Form O-101  
Revised 1-1-66

5A. Indicate Type of Lease  
STATE ☒ FEE ☐  
6. Lease No. B-1497

## APPLICATION FOR PERMIT TO DRILL, DEEPEN, OR PLUG BACK

1. Type of Work a. Type of Well DRILL <input checked="" type="checkbox"/> DEEPEN <input type="checkbox"/> PLUG BACK <input type="checkbox"/> OIL WELL <input checked="" type="checkbox"/> GAS WELL <input type="checkbox"/> OTHER <input type="checkbox"/> SINGLE ZONE <input checked="" type="checkbox"/> MULTIPLE ZONE <input type="checkbox"/>		2. Lease Agreement Name East Vacuum Grayburg/ San Andres Unit 3. Lease Agreement No. East Vacuum Grayburg/ San Andres Unit, Tract
4. Operator Name Phillips Petroleum Company		5. Well No. 2622
6. Address of Operator Room 401, 4001 Penbrook, Odessa, Texas 79762		7. Field and Section of Well Vacuum Grayburg/San Andres
8. Location of Well UNIT LETTER E LOCATED 1460 FEET FROM THE North ANT 1310 FEET FROM THE West LINE OF SEC. 26 T.17-S R.35-E		9. County Lea
10. Proposed Depth 4900'		11. Foundation Grayburg/San Andres Rotary
12. Drilling Contractor Advise later		13. Approx. Date Work will start Upon approval
14. Ground (unprepared) 3914.6 blanket		

## PROPOSED CASING AND CEMENT PROGRAM

SIZE OF HOLE	SIZE OF CASING	WEIGHT PER FOOT	SETTING DEPTH	SACKS OF CEMENT	EST. TOP
17-1/2"	13-3/8"	48#-H-40	350' (675 sx C1 H w/2% CaCl <sub>2</sub> & 1/4#/sx. Flocele/sx in 1st 150/sx		&) circ to surface
12-1/4" x 7-5/8"	5 1/2"	23#, K-55	4900' (suff. TRLW w/12# salt/sx w/10% DD and 1/4#/sx. Flocele plus 3# Gilsonite/sx followed by 260 sx C1 H cement w/8# salt/sx to circ at surface).		

NOTE: If excessive waterflow is encountered in salt section, 8-5/8", 40#, N80 intermediate casing will be set at approx. 3040' cemented to surface w/cement of quality adequate to control waterflow & protect casing string.

(This well is in the same proration unit as Well No. 030)

\*Administrative approval requested as provided by Special Order R-5897, Section 4, Rule 8.  
All contiguous proration units are in subject unit; request waiver of waiting period and immediate action.

Use mud additives as Required for Control

BOP: Series 900,3000# WP, double w/one set pipe rams and one set blind rams.

IN ABOVE SPACE DESCRIBE PROPOSED PROGRAM; IF PROPOSAL IS TO DEEPEN OR PLUG BACK, GIVE DATA ON PRESENT PRODUCTIVE ZONE AND PROPOSED NEW PRODUCTIVE ZONE. GIVE BLOCKY PREVENTER PROGRAM, IF ANY.

I hereby certify that the information above is true and complete to the best of my knowledge and belief.

Signed W. J. Mueller Title Sr. Engineering Specialist Date July 5, 1979

(This space for State Use)

APPROVED BY [Signature] TITLE SUPERVISOR DISTRICT 1 DATE JUL 19 1979

CONDITIONS OF APPROVAL, IF ANY:

**NEW MEXICO OIL CONSERVATION COMMISSION  
WELL LOCATION AND ACREAGE DEDICATION PLAT**

Form C-102  
Supersedes C-128  
Effective 1-1-65

All distances must be from the outer boundaries of the Section.

Operator <b>PHILLIPS PETROLEUM COMPANY</b>			Lease <b>E.V.G.S.A.U. In 2622</b>		Well No. <b>2622-001</b>
Unit Letter <b>E</b>	Section <b>26</b>	Township <b>17 SOUTH</b>	Range <b>35 EAST</b>	County <b>LEA</b>	
Actual Footage Location of Well: <div style="display: flex; justify-content: space-between;"> <span><b>1460</b> feet from the <b>NORTH</b> line and</span> <span><b>1310</b> feet from the <b>WEST</b> line</span> </div>					
Ground Level Elev. <b>3914.6</b>	Producing Formation <b>Grayburg/San Andres</b>	Pool <b>Vacuum Grayburg/San Andres</b>		Dedicated Acreage: <b>40</b> Acres	

(unprepared)

1. Outline the acreage dedicated to the subject well by colored pencil or hachure marks on the plat below.
2. If more than one lease is dedicated to the well, outline each and identify the ownership thereof (both as to working interest and royalty).
3. If more than one lease of different ownership is dedicated to the well, have the interests of all owners been consolidated by communitization, unitization, force-pooling, etc?

☐ Yes   ☐ No   If answer is "yes," type of consolidation \_\_\_\_\_

If answer is "no," list the owners and tract descriptions which have actually been consolidated. (Use reverse side of this form if necessary.) \_\_\_\_\_

No allowable will be assigned to the well until all interests have been consolidated (by communitization, unitization, forced-pooling, or otherwise) or until a non-standard unit, eliminating such interests, has been approved by the Commission.

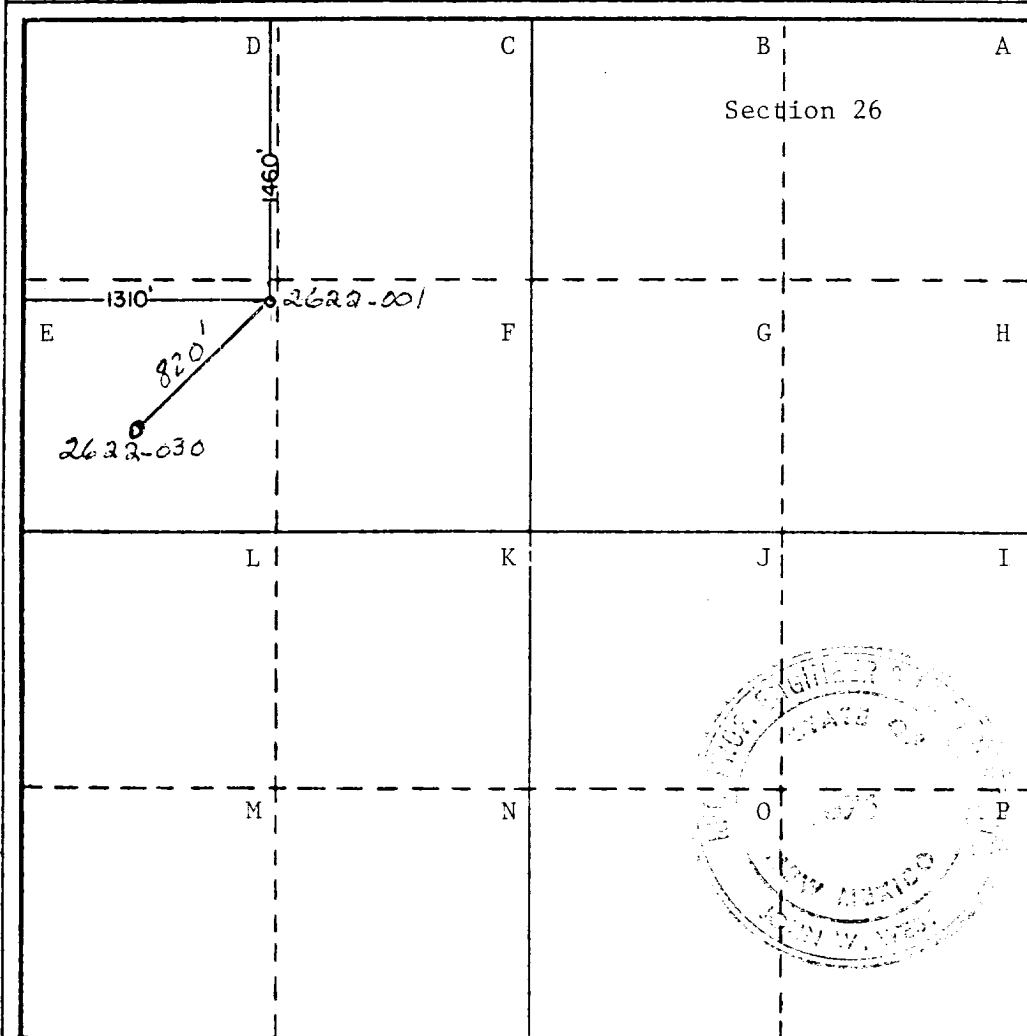

**CERTIFICATION**

I hereby certify that the information contained herein is true and complete to the best of my knowledge and belief.

*[Signature]*  
Name **W. J. Mueller**

Position **Senior Engineering Specialist**

Company **Phillips Petroleum Company**

Date **July 5, 1979**

I hereby certify that the well location shown on this plat was plotted from field notes of actual surveys made by me or under my supervision, and that the same is true and correct to the best of my knowledge and belief.

Date Surveyed **JUNE 11TH, 1979**

Registered Professional Engineer and/or Land Surveyor

*[Signature]*

Certificate No. **John W. West 676**  
**Ronald J. Eidson 3239**



# DOUBLE PREVENTER OPTION

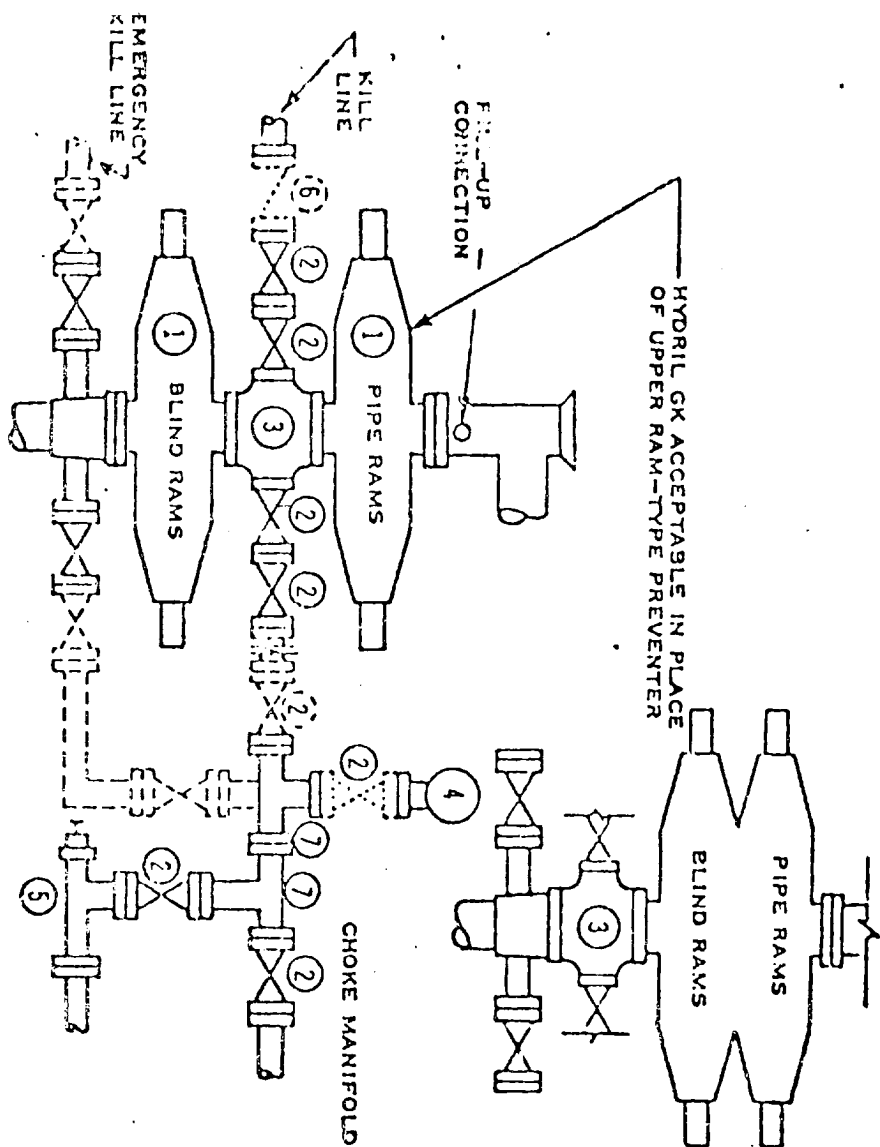

- ① SERIES 900 RAM-TYPE BOP
- ② 2" SERIES 900 VALVE
- ③ SERIES 900 DRILLING SPOOL
- ④ 2" MUD PRESSURE GAUGE
- ⑤ 2" SERIES 500 CHOKE
- ⑥ 2" SERIES 900 CHECK VALVE
- ⑦ 2" SERIES 900 STEEL TEE

## NOTES:

1. 3000 PSI WP CLAMP  
HUBS MAY BE SUBSTITUTED  
FOR FLANGES
2. VALVES MAY BE EITHER HAND OR POWER  
OPERATED BUT, IF POWER OPERATED,  
THE VALVES FLANGED TO THE BOP RUN  
MUST BE CAPABLE OF BEING OPENED AND  
CLOSED MANUALLY OR CLOSE ON POWER  
FAILURE AND BE CAPABLE OF BEING  
OPENED MANUALLY

## ..... OPTIONAL EQUIPMENT

PHILLIPS PETROLEUM COMPANY

3000 PSI WORKING PRESSURE  
BLOWOUT PREVENTER HOOK-UP  
(SERIES 900 FLANGES OR BETTER)