

NO. OF COPIES RECEIVED	
DISTRIBUTION	
SANTA FE	
FILE	
U.S.G.S.	
LAND OFFICE	
OPERATOR	

NEW MEXICO OIL CONSERVATION COMMISSION

APPROVAL VALID
FOR 90 DAYS UNLESS
DRILLING COMMENCED,EXPIRES 10/24/79Form O-101
Revised 12-65

1A. Permit Type: <input checked="" type="checkbox"/> Drill <input type="checkbox"/> Deepen <input type="checkbox"/> Plug Back
STATE <input checked="" type="checkbox"/> FILE <input type="checkbox"/>
1B. Permit No. <u>B-2433-12</u>

APPLICATION FOR PERMIT TO DRILL, DEEPEN, OR PLUG BACK

1. Type of Well a. <input checked="" type="checkbox"/> DRILL <input type="checkbox"/> DEEPEN <input type="checkbox"/> PLUG BACK <input type="checkbox"/> b. <input checked="" type="checkbox"/> SINGLE ZONE <input type="checkbox"/> MULTIPLE ZONE		2. Location a. <u>East Vacuum Grayburg/ San Andres Unit</u> b. <u>East Vacuum Grayburg/ San Andres Unit, Tract</u> c. <u>003</u> <u>2963</u> d. <u>Vacuum Grayburg/San Andres</u>	
3. Operator <u>Phillips Petroleum Company</u>		4. Well No. <u>003</u>	
5. Address <u>Room 401, 4001 Penbrook, Odessa, Texas 79762</u>		6. Well Name <u>Vacuum Grayburg/San Andres</u>	
7. Location a. <u>1175</u> <u>South</u> <u>29</u> <u>17-S</u> <u>35-E</u> b. <u>1430</u> <u>West</u> <u>LINE</u>		8. Well Depth <u>4900'</u>	
9. Well Status <u>3972.1' Ground (unprepared) Blanket</u>		10. Well Status <u>Grayburg/San Andres Rotary</u>	
11. Well Status <u>Advise later</u>		12. Well Status <u>Upon approval</u>	

PROPOSED CASING AND CEMENT PROGRAM

SIZE OF HOLE	SIZE OF CASING	WEIGHT PER FOOT	SETTING DEPTH	SACKS OF CEMENT	EST. TOP
17-1/2"	13-3/8"	48#-H-40	350' (675 sx Cl H w/2% CaCl ₂ & 1/4# Flocele/sx in 1st 150/sx)		
12-1/4" x 7-5/8"	5-1/2"	23# K-55	4900' (suff. TRLW w/12# salt/sx w/10% DD and 1/4# Flocele plus 3# Gilsonite/sx followed by 260 sx Cl H cement w/8# salt/sx to circ at surface).		

NOTE: If excessive waterflow is encountered in salt section, 8-5/8", 40#, N80 intermediate casing will be set at approx. 3040 cemented to surface w/cement of quality adequate to control waterflow & protect casing string.

(This well is in the same proration unit as Well No. 002)

*Administrative approval requested as provided by Special Order R-5897, Section 4, Rule 8.
All contiguous proration units are in subject unit; request waiver of waiting period and immediate action.

Use mud additives as Required for Control

BOP: Series 900, 3000# WP, double w/one set pipe rams and one set blind rams.

IN ABOVE SPACE DESCRIBE PROPOSED PROGRAM: IF PROPOSAL IS TO DEEPEN OR PLUG BACK, GIVE DATA ON PRESENT PRODUCTIVE ZONE AND PROPOSED NEW PRODUCTIVE ZONE. GIVE BLOCKOUT PREVENTER PROGRAM, IF ANY.

I hereby certify that the information above is true and complete to the best of my knowledge and belief.

Signature W. J. Mueller Title Sr. Engineering Specialist Date July 5, 1979

(This space for State Use)

APPROVED BY Orig. Signed by Los Clemente TITLE OH & GAS DATE JUL 25 1979

NEW MEXICO OIL CONSERVATION COMMISSION
WELL LOCATION AND ACREAGE DEDICATION PLAT

Form C-102
Supersedes C-128
Effective 1-1-65

All distances must be from the outer boundaries of the Section.

Operator PHILLIPS PETROLEUM COMPANY		Lease E.V.G.S.A.U. TRACT 2963		Well No. -003
Unit Letter N	Section 29	Township 17 SOUTH	Range 35 EAST	County LEA
Actual Footage Location of Well: 1430 feet from the WEST line and 1175 feet from the SOUTH line				
Ground Level Elev. 3972.1 (unprepared)	Producing Formation Grayburg/San Andres	Por. Vacuum Gb/San Andres	Dedicated Acreage: 40 Acres	

1. Outline the acreage dedicated to the subject well by colored pencil or hachure marks on the plat below.
2. If more than one lease is dedicated to the well, outline each and identify the ownership thereof (both as to working interest and royalty).
3. If more than one lease of different ownership is dedicated to the well, have the interests of all owners been consolidated by communitization, unitization, force-pooling, etc?

☐ Yes ☐ No If answer is "yes," type of consolidation _____

If answer is "no," list the owners and tract descriptions which have actually been consolidated. (Use reverse side of this form if necessary.) _____

No allowable will be assigned to the well until all interests have been consolidated (by communitization, unitization, forced-pooling, or otherwise) or until a non-standard unit, eliminating such interests, has been approved by the Commission.

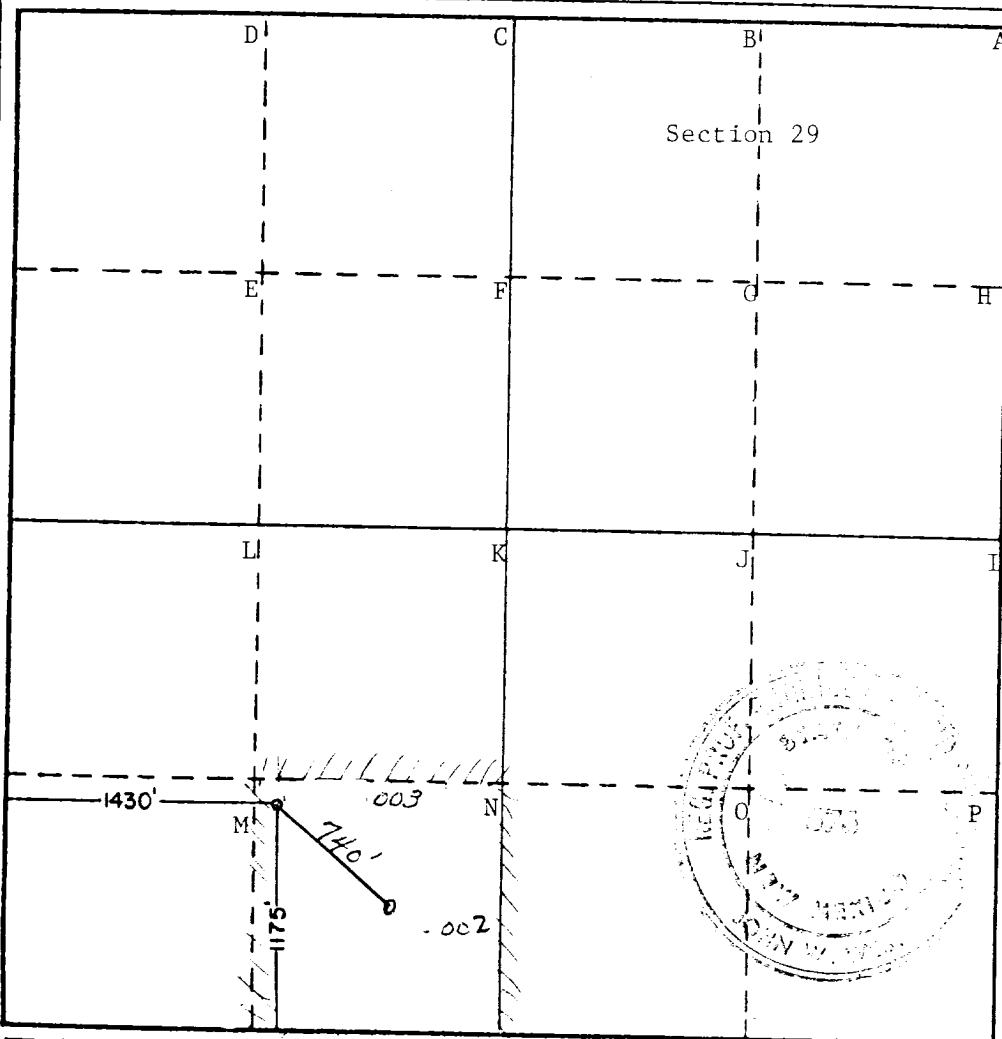

CERTIFICATION

I hereby certify that the information contained herein is true and complete to the best of my knowledge and belief.

W. J. Mueller
Name
W. J. Mueller

Position
Senior Engineering Specialist

Company
Phillips Petroleum Company

Date
July 5, 1979

I hereby certify that the well location shown on this plat was plotted from field notes of actual surveys made by me or under my supervision, and that the same is true and correct to the best of my knowledge and belief.

Date Surveyed
JUNE 4TH, 1979

Registered Professional Engineer
and/or Land Surveyor

John W. West

Certificate No. **John W. West 676**
Ronald J. Eidson 3239

