

30-025-26401

NO. OF COPIES RECEIVED	
DISTRIBUTION	
SANTA FE	
FILE	
U.S.G.S.	
LAND OFFICE	
OPERATOR	

NEW MEXICO OIL CONSERVATION COMMISSION

Form C-101
Revised 1-1-66

APPROVAL VALID
FOR 90 DAYS UNLESS
DRILLING COMMENCED,

EXPIRES 10/24/79

5A. Indicate Type of Lease
STATE <input checked="" type="checkbox"/> FEE <input type="checkbox"/>

5. State of Leasehold No.
B-1608

APPLICATION FOR PERMIT TO DRILL, DEEPEN, OR PLUG BACK

1a. Type of Work b. Type of Well OIL WELL <input checked="" type="checkbox"/> GAS WELL <input type="checkbox"/> OTHER <input type="checkbox"/> SINGLE ZONE <input checked="" type="checkbox"/> MULTIPLE ZONE <input type="checkbox"/>		2. Name of Operator Phillips Petroleum Company		3. Well No. 3332	
4. Location of Well UNIT LETTER <u>A</u> LOCATED <u>1310</u> FEET FROM THE <u>East</u> LINE AND <u>200</u> FEET FROM THE <u>North</u> LINE OF SEC. <u>33</u> TWP. <u>17-S</u> RGE. <u>35-E</u> NMPM		5. Field and Lease, or Well East Vacuum Grayburg/ San Andres Unit East Vacuum Grayburg/ San Andres Unit, Tract		6. Field and Lease, or Well Vacuum Grayburg/San Andres	
7. Address of Operator Room 401, 4001 Panbrook, Odessa, Texas 79762		8. County Lea		9. State of U.S.	
10. Proposed Depth 4900'		11A. Formation Grayburg/San Andres		12. Rotary or P.T.	
13. Kind & Status Plug. Bond 3943.7' Ground (unprepared) Blanket		14. Drilling Contractor Advise Later		15. Approx. Date Work will start Upon Approval	

PROPOSED CASING AND CEMENT PROGRAM

SIZE OF HOLE	SIZE OF CASING	WEIGHT PER FOOT	SETTING DEPTH	SACKS OF CEMENT	EST. TOP
17-1/2"	13-3/8"	48#-H-40	350' (675 sx Cl H w/2% CaCl ₂ & 1/4# Flocele/sx in 1st 150/sx)		circ to surface
12-1/4" x 7-5/8"	5-1/2"	23#, K-55	4900' (suff. TRLW w/12# salt/sx w/10% DD and 1/4#sx. Flocele plus 3# Gilsonite/sx followed by 260 sx Cl H cement w/8# salt/sx to circ at surface).		

NOTE: If excessive waterflow is encountered in salt section, 8-5/8", 40#, N80 intermediate casing will be set at approx. 3040 cemented to surface w/cement of quality adequate to control waterflow & protect casing string.

(This well is in the same proration unit as Well No. 021).

*Administrative approval requested as provided by Special Order R-5897, Section 4, Rule 8. All contiguous proration units are in subject unit; request waiver of waiting period and immediate action.
Use mud additives as Required for Control
BOP: Series 900,3000# WP, double w/one set pipe rams and one set blind rams.

IN ABOVE SPACE DESCRIBE PROPOSED PROGRAM: IF PROPOSAL IS TO DEEPEN OR PLUG BACK, GIVE DATA ON PRESENT PRODUCTIVE ZONE AND PROPOSED NEW PRODUCTIVE ZONE. GIVE BLOCKOUT PREVENTER PROGRAM, IF ANY.

I hereby certify that the information above is true and complete to the best of my knowledge and belief.

Signed W. J. Mueller W. J. Mueller Title Sr. Engineering Specialist Date July 5, 1979

(This space for State Use)

APPROVED BY Les Clements TITLE Oil & Gas Insp. DATE JUL 26 1979

NEW MEXICO OIL CONSERVATION COMMISSION
WELL LOCATION AND ACREAGE DEDICATION

Form C-102
 Supersedes C-128
 Effective 1-1-65

All distances must be from the outer boundaries of the Section.

Operator PHILLIPS PETROLEUM COMPANY			Lease E.V.G.S.A.U. , TRACT 3332		Well No. -001
Unit Letter A	Section 33	Township 17 SOUTH	Range 35 EAST	County LEA	
Actual Footage Location of Well: 1310 feet from the EAST line and 200 feet from the NORTH line					
Ground Level Elev. 3943.7 (Unprepared)	Producing Formation Grayburg/San Andres		Pool Vacuum Gb/San Andres		Dedicated Acreage: 40 Acres

1. Outline the acreage dedicated to the subject well by colored pencil or hachure marks on the plat below.
2. If more than one lease is dedicated to the well, outline each and identify the ownership thereof (both as to working interest and royalty).
3. If more than one lease of different ownership is dedicated to the well, have the interests of all owners been consolidated by communitization, unitization, force-pooling, etc?

☐ Yes ☐ No If answer is "yes," type of consolidation _____

If answer is "no," list the owners and tract descriptions which have actually been consolidated. (Use reverse side of this form if necessary.) _____

No allowable will be assigned to the well until all interests have been consolidated (by communitization, unitization, forced-pooling, or otherwise) or until a non-standard unit, eliminating such interests, has been approved by the Commission.

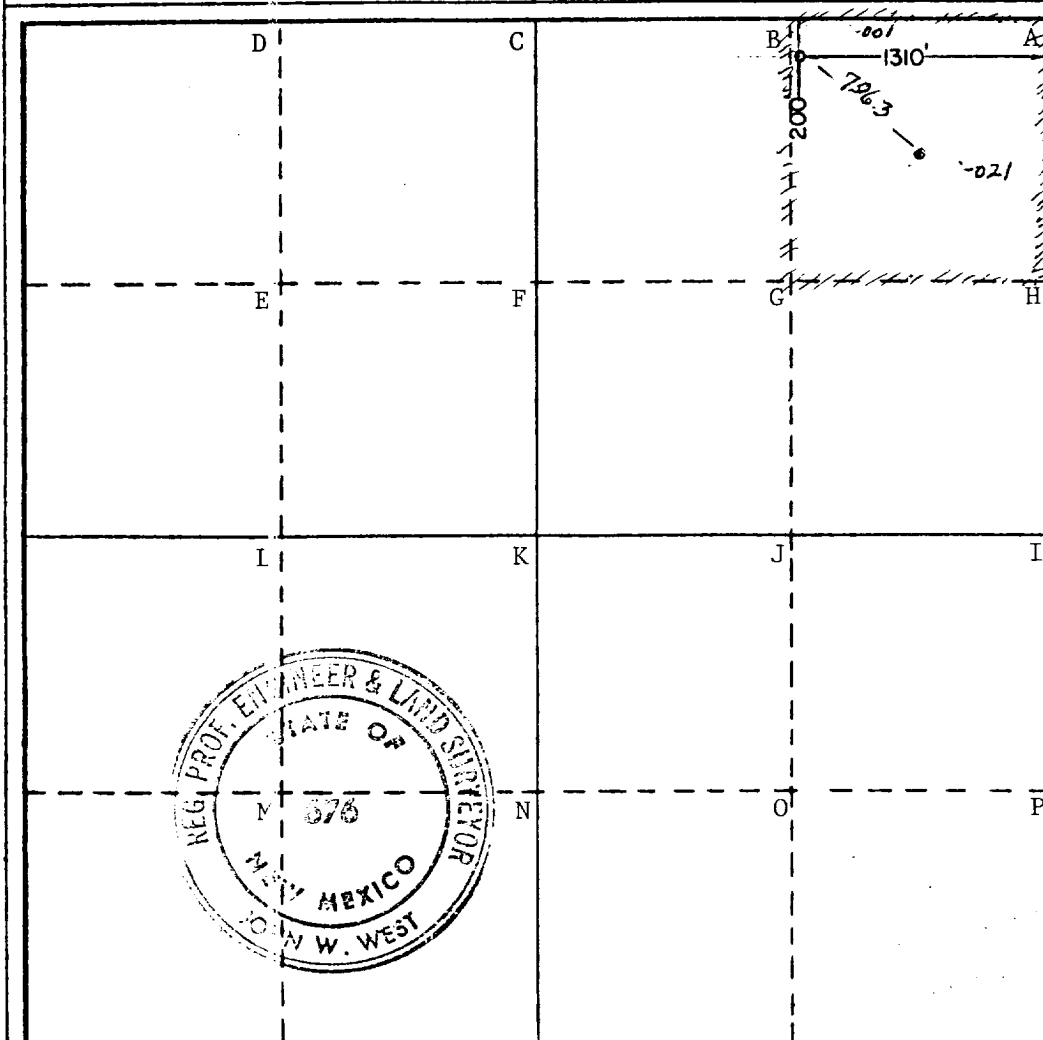

CERTIFICATION

I hereby certify that the information contained herein is true and complete to the best of my knowledge and belief.

[Signature]
 Name

W. J. Mueller

Position

Senior Engineering Specialist

Company

Phillips Petroleum Company

Date

July 5, 1979

I hereby certify that the well location shown on this plat was plotted from field notes of actual surveys made by me or under my supervision, and that the same is true and correct to the best of my knowledge and belief.

Date Surveyed

JUNE 6TH, 1979

Registered Professional Engineer and/or Land Surveyor

[Signature]

Certificate No. John W. West

676

Ronald J. Eldson

3239

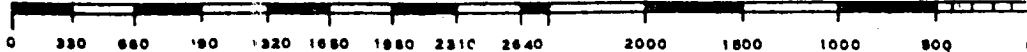

DOUBLE PREVENTER OPTION

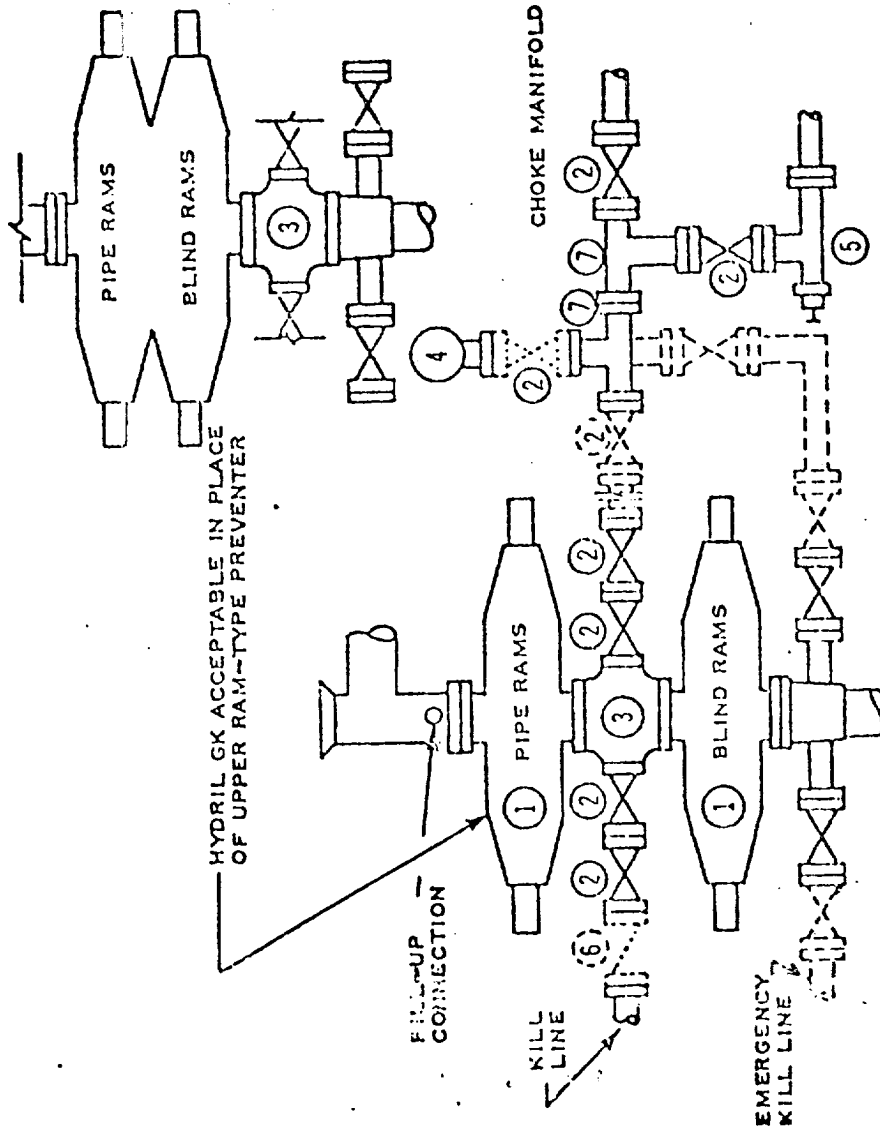

- ① SERIES 900 RAM-TYPE BOP
- ② 2" SERIES 900 VALVE
- ③ SERIES 900 DRILLING SPOOL
- ④ 2" MUD PRESSURE GAUGE
- ⑤ 2" SERIES 900 CHOKE
- ⑥ 2" SERIES 900 CHECK VALVE
- ⑦ 2" SERIES 900 STEEL TEE

NOTES:

1. 3000 PSI WP CLAMP HUBS MAY BE SUBSTITUTED FOR FLANGES
2. VALVES MAY BE EITHER HAND OR POWER OPERATED BUT, IF POWER OPERATED, THE VALVES FLANGED TO THE BOP RUN MUST BE CAPABLE OF BEING OPENED AND CLOSED MANUALLY OR CLOSE ON POWER FAILURE AND BE CAPABLE OF BEING OPENED MANUALLY

..... OPTIONAL EQUIPMENT

PHILLIPS PETROLEUM COMPANY

3000 PSI WORKING PRESSURE
BLOWOUT PREVENTER HOOK-UP
(SERIES 900 FLANGES OR BETTER)

RECEIVED
JUL 18 1973
O.C.D. HOBBS, OFFICE



Robert H. Hobbs