

NO. OF COPIES RECEIVED	
DISTRIBUTION	
SANTA FE	
FILE	
U.S.G.S.	
LAND OFFICE	
OPERATOR	

NEW MEX CO OIL CONSERVATION COMMISSION

*Administrative Approval Requested

30-125-26515

Form C-101
Revised 1-1-75

5A. Indicate Type of Lease	
STATE <input checked="" type="checkbox"/>	FREE <input type="checkbox"/>
5. State Oil & Gas Lease No.	
B-1497	

APPLICATION FOR PERMIT TO DRILL, DEEPEN, OR PLUG BACK

1a. Type of Work		1b. Type of Well		2. Well No.	
DRILL <input checked="" type="checkbox"/> DEEPEN <input type="checkbox"/> PLUG BACK <input type="checkbox"/>		OIL WELL <input checked="" type="checkbox"/> GAS WELL <input type="checkbox"/> OTHER <input type="checkbox"/>		003	
3. Name of Operator				4. State Oil & Gas Lease No.	
Phillips Petroleum Company				B-1497	
5. Address of Operator				6. State Oil & Gas Lease No.	
Room 401, 4001 Penbrook Street, Odessa, Texas 79762				Vacuum Grayburg/San Andres	
7. Location of Well				8. State Oil & Gas Lease No.	
UNIT LETTER <u>D</u> LOCATED <u>1310</u> FEET FROM THE <u>West</u> LINE				003	
AND <u>10</u> FEET FROM THE <u>North</u> LINE OF SEC. <u>26</u> TWP. <u>17-S</u> R. <u>35-E</u> N.M.P.M.				003	
9. Depth of Well				10. State Oil & Gas Lease No.	
4800'				Grayburg/San Andres	
11. Type of Well				12. Approx. Date Work will start	
Rotary				Upon Approval	
13. Type of Cement				14. Type of Cement	
Blanket				Advise later	

PROPOSED CASING AND CEMENT PROGRAM

SIZE OF HOLE	SIZE OF CASING	WEIGHT PER FOOT	SETTING DEPTH	SACKS OF CEMENT	EST. TOP
12-1/4"	8-5/8"	24#, K-55	350' (Suff. quantity of C1)	Circ to surface	
			(H w/2% CaCl ₂ & 1/4#)		
			(Flocele/sx in 1st 150/sx)		
7-5/8"	5-1/2"	14#, K-55	4800' (Suff. TRLW w/12# salt/sx w/10% DD and		
			(1/4#/sx. Flocele plus 3# Gilsonite/sx		
			(followed by 260 sxs C1 H cmt w/8# salt/		
			(sx to circ at surface.)		

(This well is in the same proration unit as Well No. 043.)

*Administrative approval, provided by Special Order No. R-5897, of unorthodox location has been requested by separate letter.

Use mud additives as Required for Control.

BOP: Series 900, 3000# WP, double w/one set pipe rams and one set blind rams.

EXPIRES

Feb. 3, 1980

NSL-1094

IN ABOVE SPACE DESCRIBE PROPOSED PROGRAM: IF PROPOSAL IS TO DEEPEN OR PLUG BACK, GIVE DATA ON PRESENT PRODUCTIVE ZONE AND PROPOSED NEW PRODUCTIVE ZONE. GIVE BLOWOUT PREVENTER PROGRAM, IF ANY.

I hereby certify that the information above is true and complete to the best of my knowledge and belief.

Signature W.J. Mueller Title Sr. Engineering Specialist Date October 23, 1979

(This space for State Use)

APPROVED BY John W. Ramsey TITLE Geologist DATE NOV 5 1979

CONDITIONS OF APPROVAL, IF ANY:

NEW MEXICO OIL CONSERVATION COMMISSION
WELL LOCATION AND ACREAGE DEDICATION PLAT

Form C-102
Supersedes C-128
Effective 1-4-65

All distances must be from the outer boundaries of the Section.

Operator PHILLIPS PETROLEUM COMPANY			Lease EVGSA Unit Tract 2622		Well No. -003
North Letter D	Section 26	Township 17 South	Range 35 East	County Lea	
Actual Footage Location of Well: 10 feet from the north line and 1310 feet from the west line					
Ground Level Elev. 3927.0	Producing Formation Grayburg/San Andres		Pool Vacuum Gb/SA	Dedicated Acreage: 40 Acres	

- (unprepared)
- Outline the acreage dedicated to the subject well by colored pencil or hatchure marks on the plat below.
 - If more than one lease is dedicated to the well, outline each and identify the ownership thereof (both as to working interest and royalty).
 - If more than one lease of different ownership is dedicated to the well, have the interests of all owners been consolidated by communitization, unitization, force-pooling, etc?

☐ Yes ☐ No If answer is "yes," type of consolidation _____

If answer is "no," list the owners and tract descriptions which have actually been consolidated. (Use reverse side of this form if necessary.) _____

No allowable will be assigned to the well until all interests have been consolidated (by communitization, unitization, forced-pooling, or otherwise) or until a non-standard unit, eliminating such interests, has been approved by the Commission.

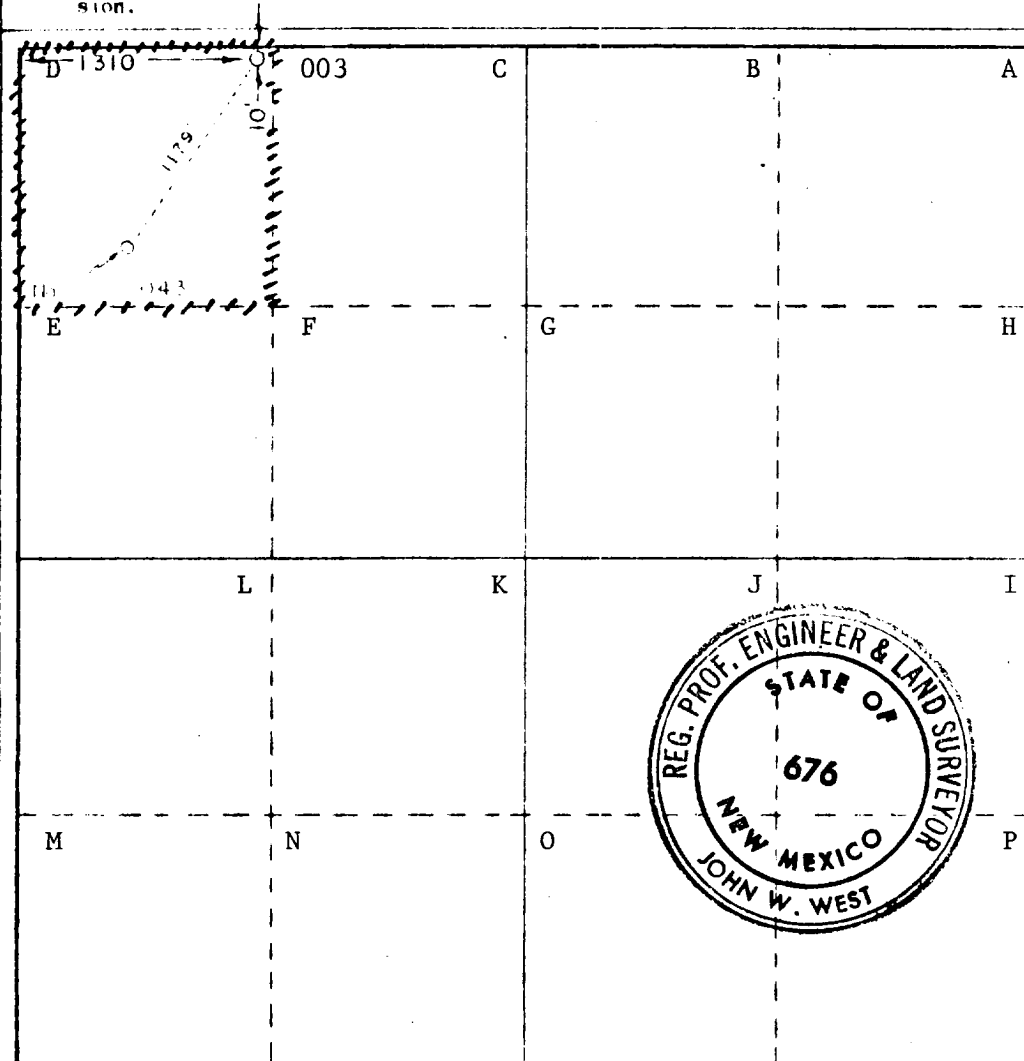

CERTIFICATION

I hereby certify that the information contained herein is true and complete to the best of my knowledge and belief.

W. J. Mueller
Name

W. J. Mueller

Position

Senior Engineering Specialist

Company

Phillips Petroleum Company

Date

October 19, 1979

I hereby certify that the well location shown on this plat was plotted from field notes of actual surveys made by me or under my supervision, and that the same is true and correct to the best of my knowledge and belief.

Date Surveyed

Oct. 10, 1979

Registered Professional Engineer and/or Land Surveyor

John W. West

Certificate No. John W. West

676

Ronald J. Eidson 3239

RECEIVED

OCT 24 1964

O.C.D. HOBBS, OFFICE

