

NO. COPIES RECEIVED	
DISTRIBUTION	
SANTA FE	
FILE	
U.S.G.S.	
LAND OFFICE	
OPERATOR	

NEW MEXICO OIL CONSERVATION COMMISSION

30-025-2652B

Form C-101
Revised 1-1-65

5A. In Route Type of Lease
STATE <input checked="" type="checkbox"/> FEL <input type="checkbox"/>
Section, T. & R. & Lot No.
B-2273-2

APPLICATION FOR PERMIT TO DRILL, DEEPEN, OR PLUG BACK

1a. Type of Work		7. Unit Agreement Name	
b. Type of Well DRILL <input checked="" type="checkbox"/> DEEPEN <input type="checkbox"/> PLUG BACK <input type="checkbox"/> OIL WELL <input checked="" type="checkbox"/> GAS WELL <input type="checkbox"/> OTHER <input type="checkbox"/> SINGLE ZONE <input checked="" type="checkbox"/> MULTIPLE ZONE <input type="checkbox"/>		East Vacuum Gb/SA Unit	
3. Name of Operator		4. Field or Lease Name	
Phillips Petroleum Company		East Vacuum Gb/SA Unit Tract 3456	
5. Address of Operator		6. Well No.	
Room 401, 4001 Penbrook, Odessa, Texas 79762		007	
4. Location of Well		10. Field and Field or Lease Name	
UNIT LETTER E LOCATED 2500 FEET FROM THE North LINE		Vacuum Gb/SA	
AND 1200 FEET FROM THE West LINE OF SEC. 34 T. 17-S R. 35-E N.M.P.M.			
11. County		12. Field and Field or Lease Name	
Lea			
13. Present Depth		14A. Formation	
4800'		Gb/SA	
15. Present Status (whether DI, RI, etc.)		16A. Drilling Contractor	
3931.7 Ground (unprepared) blanket		Advise later	
21A. Kind of Cement Plug Bond		22. Approx. Date Work will start	
		Upon approval	

PROPOSED CASING AND CEMENT PROGRAM

SIZE OF HOLE	SIZE OF CASING	WEIGHT PER FOOT	SETTING DEPTH	SACKS OF CEMENT	EST. TOP
12-1/4"	8-5/8"	24#, K-55	350'	(Sufficient quantity of C1 H w/2% CaCl ₂ (1/4# Flocele/sx in 1st 150/sx)	circ to surface
7-7/8"	5-1/2"	14#, K-55	4800' (Suff. TRLW w/12# salt/sx w/10% DD and (1/4#/sx Flocele plus 3# Gilsonite/sx followed (by 260 sxs C1 H cement w/8# salt/sx to circ at (surface.)		

APPROVAL VOID
FOR 10 DAYS AFTER
DRILLING COMMENCED,

EXPIRES FEB 3, 1980

(This well is in the same proration unit as Well No. 003)

Administrative approval, provided by Special Order R-5897, of unorthodox location has been requested by separate letter.

Use mud additives as Required for Control.

BOP: Series 900, 3000# WP, double w/one set pipe rams and one set blind rams.

IN ABOVE SPACE DESCRIBE PROPOSED PROGRAM: IF PROPOSAL IS TO DEEPEN OR PLUG BACK, GIVE DATA ON PRESENT PRODUCTIVE ZONE AND PROPOSED NEW PRODUCTIVE ZONE. GIVE BLOWOUT PREVENTER PROGRAM, IF ANY.

I hereby certify that the information above is true and complete to the best of my knowledge and belief.

Signed W. J. Mueller Title Senior Engineering Specialist Date 10-22-79

(This space for State Use)

APPROVED BY John W. Rumpfen TITLE Geologist DATE NOV 5 1979

CONDITIONS OF APPROVAL, IF ANY:

NEW MEXICO OIL CONSERVATION COMMISSION
WELL LOCATION AND ACREAGE DEDICATION PLAT

Form C-102
Supersedes C-128
Effective 1-1-65

All distances must be from the outer boundaries of the Section

Operator PHILLIPS PETROLEUM COMPANY		Lease EVGSA Unit Tract 3456		Well No. 007
Unit Letter E	Section 34	Township 17 South	Range 35 East	County Lea
Actual Footage Location of Well: 2500 feet from the north line and 1200 feet from the west line				
Ground Level Elev. 3931.7 (unprepared)	Producing Formation Grayburg/San Andres	Pool Vacuum Gb/SA	Dedicated Acreage: 40 Acres	

- Outline the acreage dedicated to the subject well by colored pencil or hachure marks on the plat below.
- If more than one lease is dedicated to the well, outline each and identify the ownership thereof (both as to working interest and royalty).
- If more than one lease of different ownership is dedicated to the well, have the interests of all owners been consolidated by communitization, unitization, force-pooling, etc?

☐ Yes ☐ No If answer is "yes," type of consolidation _____

If answer is "no," list the owners and tract descriptions which have actually been consolidated. (Use reverse side of this form if necessary.) _____

No allowable will be assigned to the well until all interests have been consolidated (by communitization, unitization, forced-pooling, or otherwise) or until a non-standard unit, eliminating such interests, has been approved by the Commission.

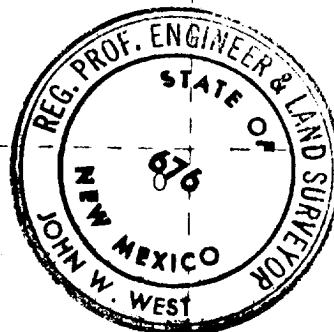
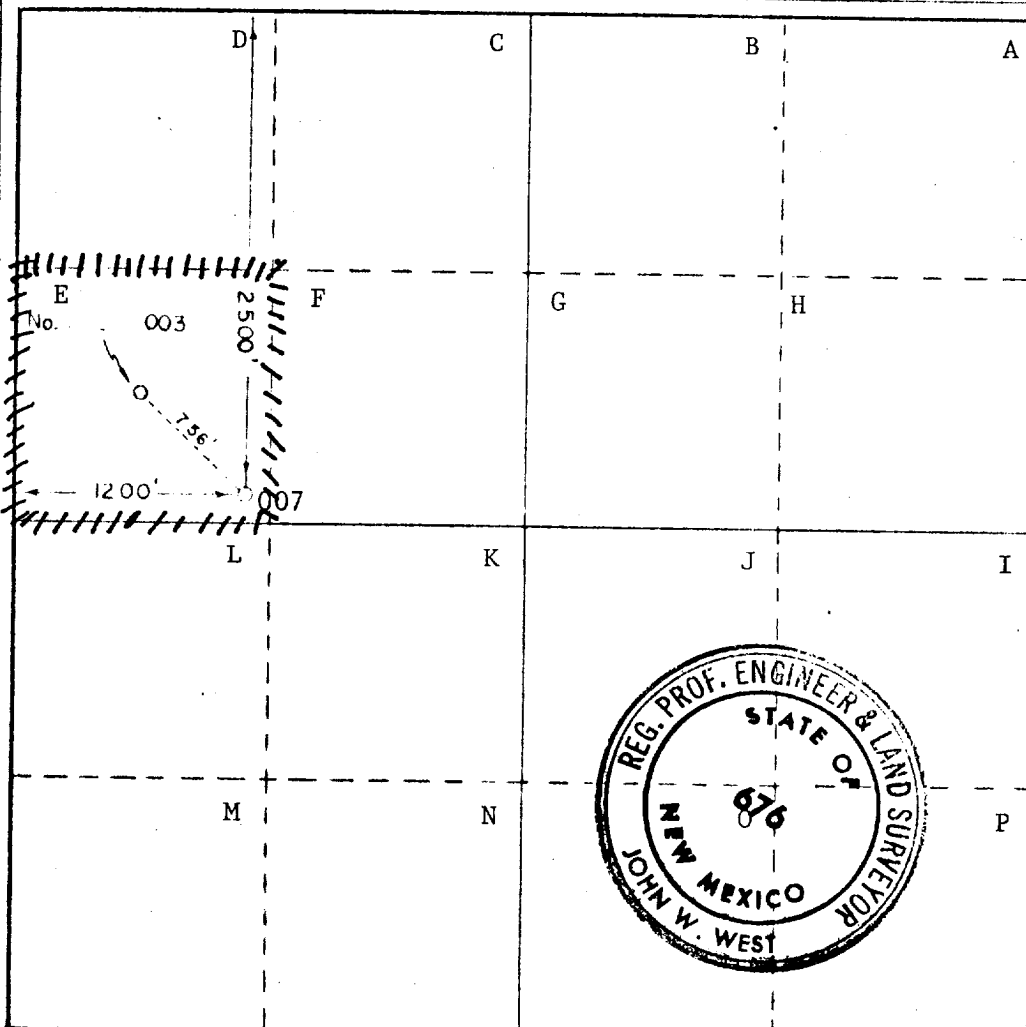

CERTIFICATION

I hereby certify that the information contained herein is true and complete to the best of my knowledge and belief.

W. J. Mueller

W. J. Mueller

Position

Senior Engineering Spec.

Company

Phillips Petroleum Company

Date

October 19, 1979

I hereby certify that the well location shown on this plat was plotted from field notes of actual surveys made by me or under my supervision, and that the same is true and correct to the best of my knowledge and belief.

Oct. 9, 1979

Date Surveyed

Registered Professional Engineer and/or Land Surveyor

John W. West

Certificate No. John W. West

676

Ronald J. Eidson 3239

RECEIVED

OCT 24 1977

O.C.D. HOBBS, OFFICE

Received from