

NO. OF COPIES RECEIVED	
DISTRIBUTION	
DATE RECEIVED	
FILE	
U.S.G.S.	
LAND OFFICE	
OPERATOR	

NEW MEXICO OIL CONSERVATION COMMISSION

Form C-103
Supersedes Old
C-102 and C-103
Effective 1-1-65

API No. 30-025-26574

SUNDRY NOTICES AND REPORTS ON WELLS

(DO NOT USE THIS FORM FOR PROPOSALS TO DRILL OR TO DEEPEN OR PLUG BACK TO A DIFFERENT RESERVOIR.
(SEE APPLICATION FOR PERMIT - (FORM C-101) FOR SUCH PROPOSALS.)

OIL WELL <input checked="" type="checkbox"/>	GAS WELL <input type="checkbox"/>	OTHER <input type="checkbox"/>	5a. Indicate Type of Lease State <input checked="" type="checkbox"/> Fee <input type="checkbox"/>
Name of Operator Phillips Petroleum Company			5. State Oil & Gas Lease No. B-1861
Address of Operator Room 401, 4001 Penbrook Street, Odessa, Texas 79762			7. Unit Agreement Name East Vacuum Gb/SA Unit
Location of Well UNIT LETTER H 1310 FEET FROM THE East LINE AND 2630 FEET FROM THE North LINE, SECTION 26 TOWNSHIP 17-S RANGE 35-E NMPM.			8. Farm or Lease Name East Vacuum Gb/SA Unit, Tract 2642
15. Elevation (Show whether DF, RT, GR, etc.) GR 3911 3921 DF			9. Well No. 001
			10. Field and Pool, or Wildcat Vacuum Gb/SA
			12. County Lea

Check Appropriate Box To Indicate Nature of Notice, Report or Other Data

NOTICE OF INTENTION TO:

PERFORM REMEDIAL WORK <input type="checkbox"/>	PLUG AND ABANDON <input type="checkbox"/>
TEMPORARILY ABANDON <input type="checkbox"/>	CHANGE PLANS <input type="checkbox"/>
PULL OR ALTER CASING <input type="checkbox"/>	OTHER <input type="checkbox"/>

SUBSEQUENT REPORT OF:

REMEDIAL WORK <input type="checkbox"/>	ALTERING CASING <input type="checkbox"/>
COMMENCE DRILLING OPNS. <input checked="" type="checkbox"/>	PLUG AND ABANDONMENT <input type="checkbox"/>
CASING TEST AND CEMENT JOB <input checked="" type="checkbox"/>	
OTHER <u>Total depth</u> <input checked="" type="checkbox"/>	

Describe Proposed or Completed Operations (Clearly state all pertinent details, and give pertinent dates, including estimated date of starting any proposed work) SEE RULE 1103.

- 12-18-79 -- MI Cactus Drllg. Spud w/11" bit. Run 9 jts 8-5/8" 24# K-55 ST&C csg. Cmt w/350 sxs Cl "H" w/2% CaCl. WOC 4-1/4 hrs. Cut 8-5/8" csg and weld on head. Csg set 350'-circ 148 sxs temp q cmt 65°, zone temp. 65°, estimate cmt strength 2500 PSI, cmt in place 16-1/2 hrs prior to test. NU BOP's.
- 12-19-79 -- Test csg and BOP's 600 PSI. Drld cmt and 10' formation. Drld ahead w/7-7/8" hole.
- 01-01-80 -- Reached TD 4800'. Ran 128 jts 5-1/2" 14# K-55 ST&C csg. Set at 4794'. Cmt w/855 sxs TLW w/12# salt 10% DD, 1/4# Flocele, 3# Gilsonite. 293 sxs Cl "H" w/5# salt. Did not circ. Pump 840 gal 10% MSA behind cmt.
- 01-03-80 -- Ran temp log cmt at 430' w/100 sxs Cl "H" w/2% CaCl. Bradenhead squeeze to surface. Released rig.

I hereby certify that the information above is true and complete to the best of my knowledge and belief.

W. J. Mueller	TITLE Sr. Engineering Specialist	DATE January 14, 1980
Orig. Signed by Jerry Sexton		
APPROVED BY Dist. 1, Supv.	TITLE	DATE
CONDITIONS OF APPROVAL, IF ANY:		

JAN 21 1980

NEW MEXICO OIL CONSERVATION COMMISSION
WELL LOCATION AND ACREAGE DEDICATION PL.

Form C-102
Supersedes C-128
Effective 1-1-65

All distances must be from the outer boundaries of the Section.

Operator PHILLIPS PETROLEUM COMPANY			Lease EVGSA Unit 2642		Well No. 001
Unit Letter H	Section 26	Township 17 South	Range 35 East	County Lea	
Actual Footage Location of Well: 1310 feet from the east line and 2630 feet from the north line					
Ground Level Elev. 3910.4	Producing Formation Grayburg/San Andres		Pool Vacuum Gb/San Andres		Dedicated Acreage: 40 Acres

1. Outline the acreage dedicated to the subject well by colored pencil or hachure marks on the plat below.
2. If more than one lease is dedicated to the well, outline each and identify the ownership thereof (both as to working interest and royalty).
3. If more than one lease of different ownership is dedicated to the well, have the interests of all owners been consolidated by communitization, unitization, force-pooling, etc?

☐ Yes ☐ No If answer is "yes," type of consolidation _____

If answer is "no," list the owners and tract descriptions which have actually been consolidated. (Use reverse side of this form if necessary.) _____

No allowable will be assigned to the well until all interests have been consolidated (by communitization, unitization, forced-pooling, or otherwise) or until a non-standard unit, eliminating such interests, has been approved by the Commission.

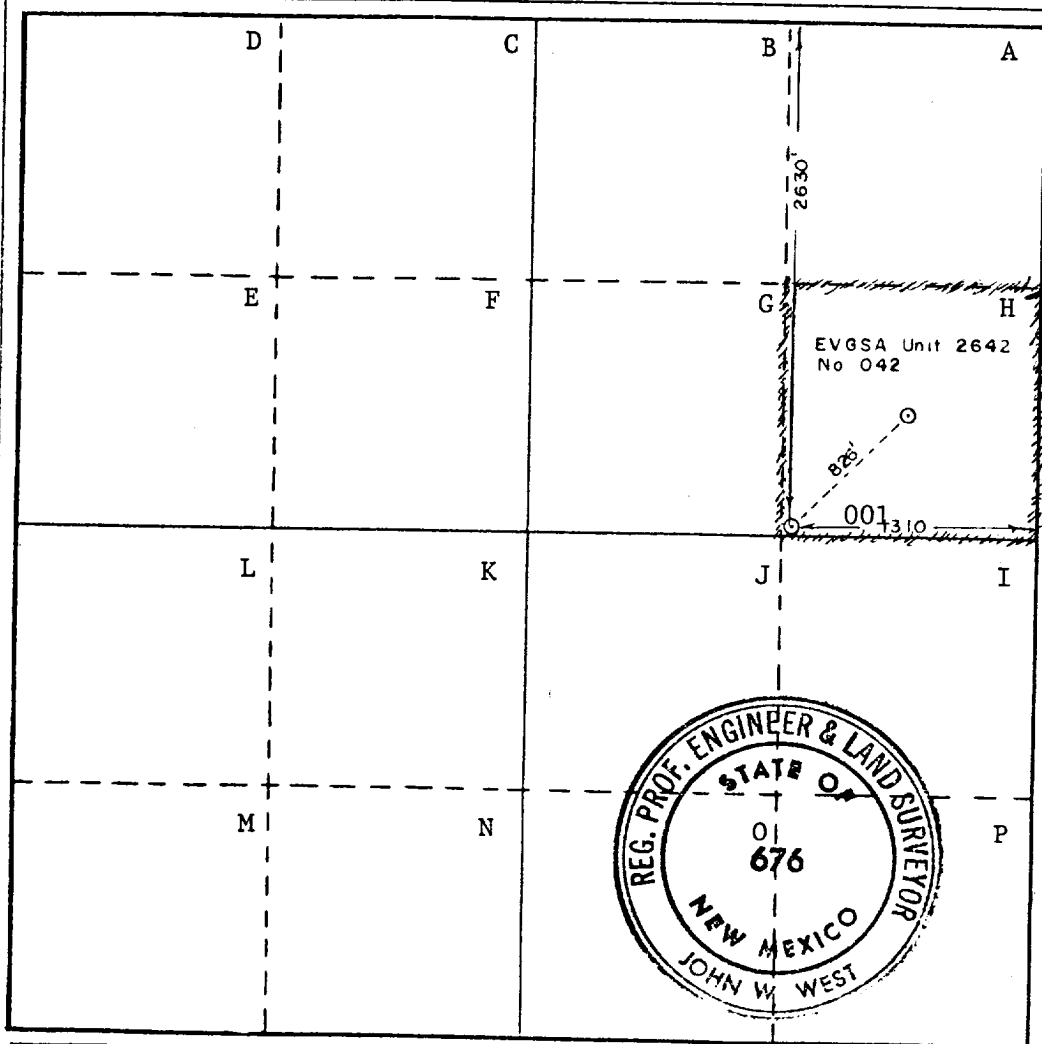

CERTIFICATION

I hereby certify that the information contained herein is true and complete to the best of my knowledge and belief.

W. J. Mueller
Name

W. J. Mueller

Position

Senior Engineering Specialist

Company

Phillips Petroleum Company

Date

November 16, 1979

I hereby certify that the well location shown on this plat was plotted from field notes of actual surveys made by me or under my supervision, and that the same is true and correct to the best of my knowledge and belief.

Date Surveyed

Oct. 10, 1979

Registered Professional Engineer and/or Land Surveyor

John W. West

Certificate No. **JOHN W. WEST 676**
PATRICK A. ROMERO 6665
Ronald J. Eldson 3239

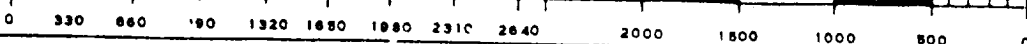

RECEIVED
NOV 19 1979
OIL CONSERVATION DIV.

ELF