

30-025-26683

NO. OF COPIES RECEIVED	
DISTRIBUTION	
SANTA FE	
FILE	
U.S.G.S.	
LAND OFFICE	
OPERATOR	

NEW MEXICO OIL CONSERVATION COMMISSION

Form C-101
Revised 1-1-65

5A. Indicate Type of Lease
STATE <input checked="" type="checkbox"/> FEE <input type="checkbox"/>
5. State Oil & Gas Lease No.
B-2862-3

APPLICATION FOR PERMIT TO DRILL, DEEPEN, OR PLUG BACK

1a. Type of Work		2. Name of Operator		7. Tract Agreement Name	
b. Type of Well OIL WELL <input checked="" type="checkbox"/> GAS WELL <input type="checkbox"/> OTHER <input type="checkbox"/>		Phillips Petroleum Company		East Vacuum Gb/SA Unit	
DRILL <input checked="" type="checkbox"/> DEEPEN <input type="checkbox"/> PLUG BACK <input type="checkbox"/>		3. Address of Operator Room 401, 4001 Penbrook, Odessa, Texas 79762		8. Firm or Lease Name East Vacuum Gb/SA Unit, Tract 3373	
4. Location of Well UNIT LETTER <u>K</u> LOCATED <u>2600</u> FEET FROM THE <u>West</u> LINE AND <u>1400</u> FEET FROM THE <u>South</u> LINE OF SEC. <u>33</u> TWP. <u>17-S</u> RSE. <u>35-E</u> NMPH		9. Well No. 001		10. Field and Pool, or Well Unit Vacuum Gb/SA	
11. Proposed Depth 4800'		12A. Formation Gb/SA		12B. Kind of C.T. Rotary	
21. Elevations (sketch whether DF, KI, etc.) 3943.3 Ground (unprepared)		21A. Kind & Status Plug. Bond blanket		21B. Drilling Contractor Advise later	
22. Approx. Date Work will start Upon approval					

PROPOSED CASING AND CEMENT PROGRAM

SIZE OF HOLE	SIZE OF CASING	WEIGHT PER FOOT	SETTING DEPTH	SACKS OF CEMENT	EST. TOP
12-1/4"	8-5/8"	24#, K-55	350' (Sufficient quantity of C1 H w/2% CaCl ₂ (& 1/4# Flocele/sx in 1st 150/sx) circ surface		
7-7/8"	5-1/2"	14#, K-55	4800' (Suff. TRLW w/12# salt/sx w/10% DD and (1/4#/sx Flocele plus 3# Gilsomite/sx followed (by 260 sxs C1 H cement w/8# salt/sx to circ (surface.)		

(This well is in the same proration unit as Well No. 028.)

Administrative approval, provided by Special Order R-5897, of unorthodox location has been received by Order NSL-1142.

Use mud additives as Required for Control.

BOP: Series 900, 3000# WP, double w/one set pipe rams and one set blind rams.

APPROVAL VALID
FOR 90 DAYS UNLESS
DRILLING COMMENCED,EXPIRES 5/6/80

IN ABOVE SPACE DESCRIBE PROPOSED PROGRAM: IF PROPOSAL IS TO DEEPEN OR PLUG BACK, GIVE DATA ON PRESENT PRODUCTIVE ZONE AND PROPOSED NEW PRODUCTIVE ZONE. GIVE BLOWOUT PREVENTER PROGRAM, IF ANY.

I hereby certify that the information above is true and complete to the best of my knowledge and belief.

Signed W. J. Mueller Title Senior Engineering Specialist Date February 7, 1980

(This space for State Use)

APPROVED BY Les Clements TITLE Off & Gas Insp. DATE FEB 12 1980

CONDITIONS OF APPROVAL

OIL CONSERVATION DIV.

FEB 11 '80

RECEIVED

DOUBLE PREVENTER OPTION

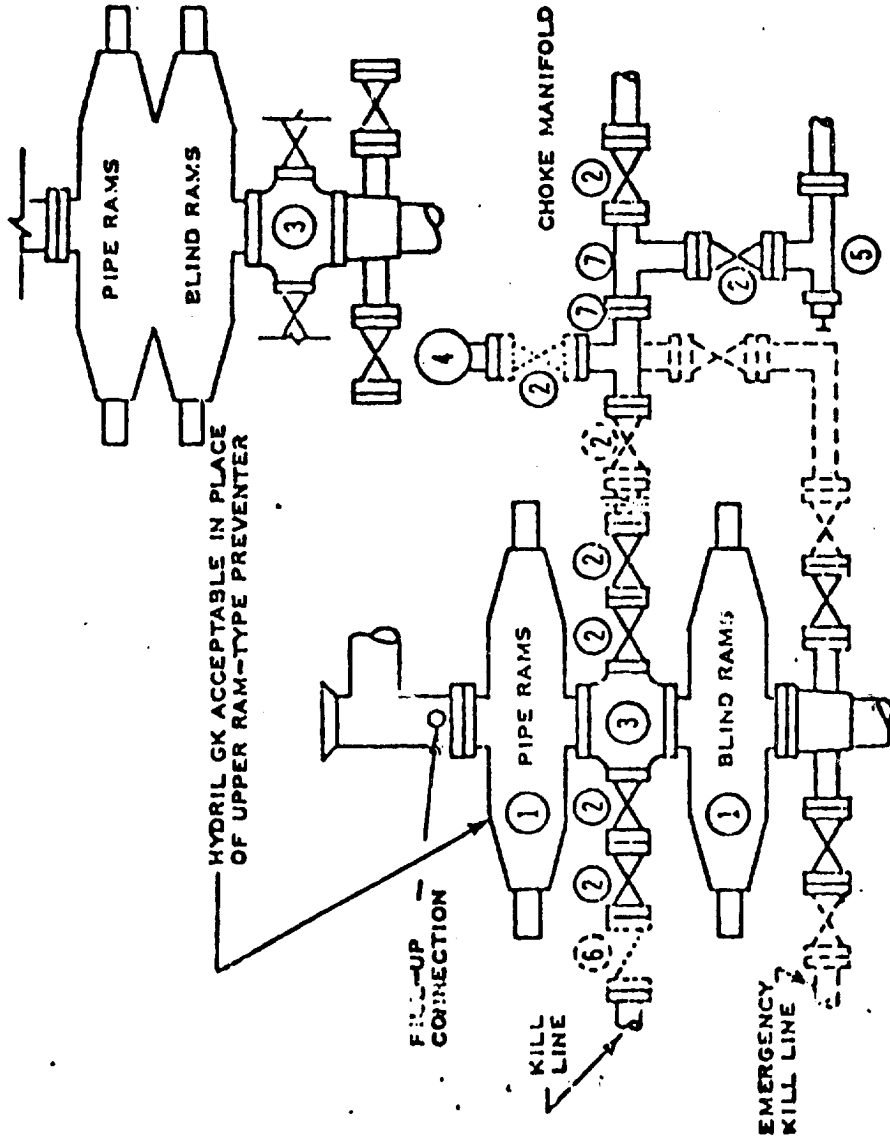

- ① SERIES 900 RAM-TYPE BOP
- ② 2" SERIES 900 VALVE
- ③ SERIES 900 DRILLING SPOOL
- ④ 2" MUD PRESSURE GAUGE
- ⑤ 2" SERIES 900 CHOKE
- ⑥ 2" SERIES 900 CHECK VALVE
- ⑦ 2" SERIES 900 STEEL TEE

NOTES:

1. 3000 PSI WP CLAMP
HUBS MAY BE SUBSTITUTED
FOR FLANGES
2. VALVES MAY BE EITHER HAND OR POWER
OPERATED BUT, IF POWER OPERATED,
THE VALVES FLANGED TO THE BOP RUN
MUST BE CAPABLE OF BEING OPENED AND
CLOSED MANUALLY OR CLOSE ON POWER
FAILURE AND BE CAPABLE OF BEING
OPENED MANUALLY

..... OPTIONAL EQUIPMENT

PHILLIPS PETROLEUM COMPANY

3000 PSI WORKING PRESSURE
BLOWOUT PREVENTER HOOK-UP
(SERIES 900 FLANGES OR BETTER)

OFF CONSERVATION DIV.

FEB 11 1960

RECEIVED

**NEW MEXICO OIL CONSERVATION COMMISSION
WELL LOCATION AND ACREAGE DEDICATION PLAT**

Form C-102
Supersedes C-128
Effective 1-1-65

All distances must be from the outer boundaries of the Section

Operator PHILLIPS PETROLEUM COMPANY			Lease EVGSA Unit 3373		Well No. 001
Unit Letter K	Section 33	Township 17 South	Range 35 East	County Lea	
Actual Footage Location of Well: 2600 feet from the west line and 1400 feet from the south line					
Ground Level Elev. 3943.3	Producing Formation Grayburg/San Andres		Pool Vacuum Gb/SA	Dedicated Acreage: 40 Acres	

(unprepared)

- Outline the acreage dedicated to the subject well by colored pencil or hachure marks on the plat below.
- If more than one lease is dedicated to the well, outline each and identify the ownership thereof (both as to working interest and royalty).
- If more than one lease of different ownership is dedicated to the well, have the interests of all owners been consolidated by communitization, unitization, force-pooling, etc?

☐ Yes ☐ No If answer is "yes," type of consolidation _____

If answer is "no," list the owners and tract descriptions which have actually been consolidated. (Use reverse side of this form if necessary.) _____

No allowable will be assigned to the well until all interests have been consolidated (by communitization, unitization, forced-pooling, or otherwise) or until a non-standard unit, eliminating such interests, has been approved by the Commission.

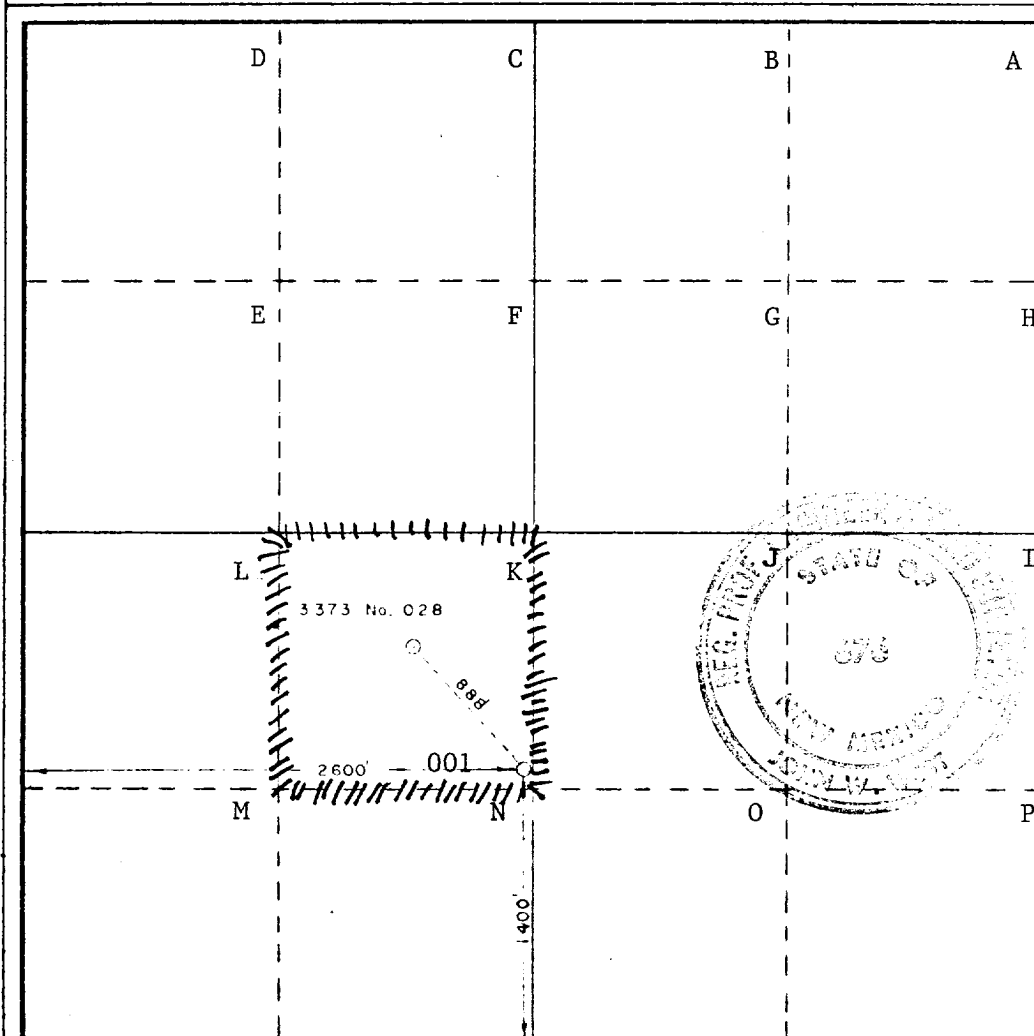

CERTIFICATION

I hereby certify that the information contained herein is true and complete to the best of my knowledge and belief.

Name
W. J. Mueller
Position
Senior Engineering Specialist
Company
Phillips Petroleum Company
Date
January 14, 1980

I hereby certify that the well location shown on this plat was plotted from field notes of actual surveys made by me or under my supervision, and that the same is true and correct to the best of my knowledge and belief.

Date Surveyed
Dec. 31, 1979
Registered Professional Engineer and/or Land Surveyor

Certificate No. **JOHN W. WEST 678**
PATRICK A. ROMERO 6863
Ronald J. Edson 3239

OIL CONSERVATION DIV.

FEB 11 '80

RECEIVED

