

30-025-26686

NO. OF COPIES RECEIVED	
DISTRIBUTION	
SANTA FE	
FILE	
U.S.G.S.	
LAND OFFICE	
OPERATOR	

NEW MEXICO OIL CONSERVATION COMMISSION

Form C-101
Revised 1-1-66

5A. Indicate Type of Lease
STATE <input checked="" type="checkbox"/> FEE <input type="checkbox"/>
5. State Oil & Gas Lease No.
B-2273-2

APPLICATION FOR PERMIT TO DRILL, DEEPEN, OR PLUG BACK

1a. Type of Work

b. Type of Well DRILL ☒ DEEPEN ☐ PLUG BACK ☐

c. Type of Well OIL WELL ☒ GAS WELL ☐ OTHER ☐

d. Name of Operator

Phillips Petroleum Company

e. Address of Operator

Room 401, 4001 Penbrook, Odessa, Texas 79762

f. Location of Well

UNIT LETTER F LOCATED 2450 FEET FROM THE West LINE

AND 2450 FEET FROM THE North LINE OF SEC. 34 TWP. 17-S RGE. 35-E NMPM

g. Proposed Depth

4800'

h. Formation

Gb/SA

i. Rotary or P.C.T.

Rotary

j. Elevations (Show whether D.P., R.T., etc.)

3926.3 Ground (unprepared)

k. Blanket & Status Plug. Pond

blanket

l. Drilling Contractor

Advise later

m. Approx. Date Work will start

Upon approval

7. Unit Agreement Name

East Vacuum Gb/SA Unit

8. Name of Lease Tract

East Vacuum Gb/SA Unit, Tract 3456

9. Well No.

010

10. Field and Pool, or Well Unit

Vacuum Gb/SA

11. County

Lea

PROPOSED CASING AND CEMENT PROGRAM					
SIZE OF HOLE	SIZE OF CASING	WEIGHT PER FOOT	SETTING DEPTH	SACKS OF CEMENT	EST. TOP
12-1/4"	9-5/8"	36#, K-55	350'	(Sufficient quantity of G1 H w/2% CaCl ₂ (& 1/4# Flocele/sx in 1st 150/sx) circ surface	
8-3/4"	7"	23#, K-55	4800'		
				(Suff. TRLW w/12# salt/sx w/10% DD and (1/4#/sx Flocele plus 3# Gilsontite/sx followed (by 260 sxs G1 H cement w/8# salt/sx to circ (surface.)	

(This well is in the same proration unit as Well No. 004.)

Administrative approval, provided by Special Order R-5897, of unorthodox location has been received by Order NSL-1142.

Use mud additives as Required for Control.

BOP: Series 900, 3000# WP, double w/one set pipe rams and one set blind rams.

APPROVAL VALID
FOR 90 DAYS UNLESS
DRILLING COMMENCED,

5/6/80

IN ABOVE SPACE DESCRIBE PROPOSED PROGRAM: IF PROPOSAL IS TO DEEPEN OR PLUG BACK, GIVE DATA ON PRESENT PRODUCTION ZONE, AND PROPOSED NEW PRODUCTION ZONE, GIVE BLOWOUT PREVENTER PROGRAM, IF ANY.

I hereby certify that the information above is true and complete to the best of my knowledge and belief.

Signed W. J. Mueller Title Senior Engineering Specialist Date February 7, 1980

(This space for State Use)

APPROVED BY _____ TITLE _____ DATE FEB 12 1980

CONDITIONS OF APPROVAL, IF ANY:

**NEW MEXICO OIL CONSERVATION COMMISSION
WELL LOCATION AND ACREAGE DEDICATION PLAT**

Form C-102
Supersedes C-128
Effective 1-1-65

All distances must be from the outer boundaries of the Section

Operator PHILLIPS PETROLEUM COMPANY			Lease EVGSA Unit 3456		Well No. 010
Unit Letter F	Section 34	Township 17 South	Range 35 East	County Lea	
Actual Footage Location of Well: 2450 feet from the west line and 2450 feet from the north line					
Ground Level Elev. 3926.3	Producing Formation Grayburg/San Andres		Pool Vacuum Gb/SA		Dedicated Acreage: 40 Acres

(unprepared)

1. Outline the acreage dedicated to the subject well by colored pencil or hachure marks on the plat below.
2. If more than one lease is dedicated to the well, outline each and identify the ownership thereof (both as to working interest and royalty).
3. If more than one lease of different ownership is dedicated to the well, have the interests of all owners been consolidated by communitization, unitization, force-pooling, etc?

☐ Yes ☐ No If answer is "yes;" type of consolidation _____

If answer is "no," list the owners and tract descriptions which have actually been consolidated. (Use reverse side of this form if necessary.) _____

No allowable will be assigned to the well until all interests have been consolidated (by communitization, unitization, forced-pooling, or otherwise) or until a non-standard unit, eliminating such interests, has been approved by the Commission.

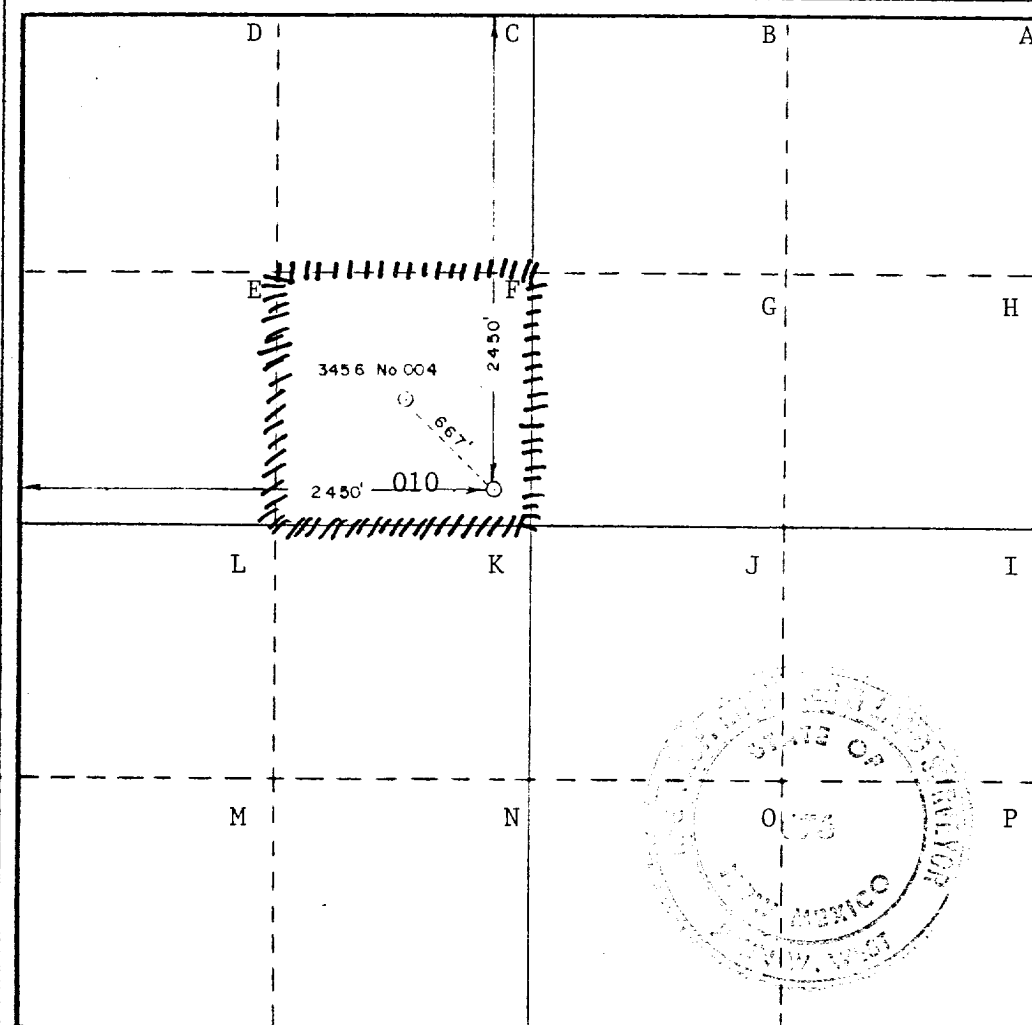

CERTIFICATION

I hereby certify that the information contained herein is true and complete to the best of my knowledge and belief.

[Signature]
Name

W. J. Mueller

Position

Senior Engineering Specialist

Company

Phillips Petroleum Company

Date

January 14, 1980

I hereby certify that the well location shown on this plat was plotted from field notes of actual surveys made by me or under my supervision, and that the same is true and correct to the best of my knowledge and belief.

Date Surveyed

Dec. 31, 1979

Registered Professional Engineer and/or Land Surveyor

[Signature]

Certificate No.	JOHN W. WEST	678
	PATRICK A. ROMERO	3063
	Ronald J. Eidson	3239

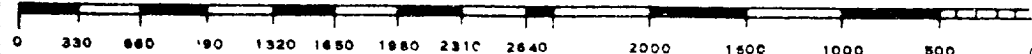



RECEIVED

FEB 11 '80

OIL CONSERVATION DIV.